

SEA DOO 4-STROKE • INTAKE

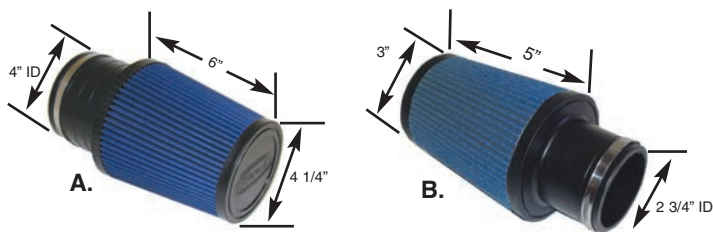

R&D POWER PLENUM FILTER KIT

The R&D RXP-X and RXT-X High Performance Power Plenum Air Filter Kit was designed and developed exclusively for the new Sea Doo RXP-X and RXT-X 255 H.P. 4-tecs new high flow intake system design. The R&D filter kit will unleash restricted low-end, mid-range and peak horsepower trapped in the O.E.M. air filtration system and intake ducting by relieving the air intakes main restriction. The new R&D Filter Kit installs in place of the O.E.M. main air box plenums restrictive air intake cover. Replacing the O.E.M. air box intake cover with the R&D Filter offers a very economical way to improve airflow CFM at a fraction of the cost compared to other aftermarket kits. Sounds good, looks great, saves cash and will install in minutes. The R&D Filter Kit is easy to remove for dealer maintenance visits.

Description	Part No.
A. RXP-X(255), RXT-X(255), RXP(215), RXT(185/215), GTX SuperCharged	203-00255
B. GTX 4-Tec N.A.(155)	203-95002



NEW



R&D COOL AIR VENT PLATE KIT

The R&D Cool Air Vent Plate Kit was developed to allow super heated hot air that builds up in the back of the hull from the water box, exhaust hoses, supercharger and coolant reservoir to be quickly and easily vented out of the hull. The R&D Kit allows two large 3" holes to be drilled into the plastic seat base mount. The R&D Kit supplies two Vent Plates that pop rivet securely in place that allows hot air to escape out while muffling sound. Rivets are not included. A cooler engine room with improved air ventilation will add to engine horsepower output.

Description	Part No.
RXP-X 260 (2012) Cool Air Vent Plate Kit	NEW 203-00270



R&D COOL 3" AIR FILTER KIT

The R&D Cool 3" Air Filter Kit is a system that utilizes the OEM intake hose.

Description	Part No.
RXP-X 260/GTR 215 (2012-13) Cool 3" Air Filter Kit	203-00260



R&D PRO SERIES 4" AIR FILTER KIT

The R&D Kit includes a huge 4" "snap on" rubber velocity stack that allows the large 4" Kanaflex flexible hose to be attached to the supercharger and cleanly run to the front of the hull to capture cooler air. The R&D Pro Series 4" Filter Kit has ZERO restriction to the supercharger through its oversized 5.5" x 8" filter, which results in quicker acceleration and more power.

Description	Part No.
RXP-X 260 (2012) Pro Series 4" Air Filter Kit	NEW 203-00264

R&D SEA DOO CRANKCASE BREATHER KIT

The R&D Crankcase Breather Kit eliminates power robbing crankcase fumes from the engines main air intake. Cleaner mass air equals more power!

Description	Part No.
R&D Crankcase Breather Kit RXP/RXT 215 HP, GTX 4-Tec	203-00216



RIVA RACING FLO-RITE AIR VENT

Flow-Rite™ Air Vents reduce underhood temperatures & improve performance by allowing hot air to escape engine compartment. These 2" water-repellent vents feature an integrated pre-filter that allows air to pass freely while keeping water out. Installs easily into engine cowling or deck of your watercraft.

Description	Part No.
RIVA Flo-Rite Air Vent (Sold individually)	RS-14-197



RIVA RXP/RXP-X/RXT/RXT-X/GTX-SC POWER FILTER KIT

Delivers greatly improved acceleration and a 1-2 mph (150-200 rpm) top speed increase by replacing the restrictive stock intake system. The Power Filter feeds your supercharger with a steady diet of cool air via a 3" diameter intake duct and oversized K&N filter element. Ducting is precision formed from a race proven composite that will not conduct heat to incoming air. Installs securely via a silicone coupler and sturdy bracket. Kit includes pre-filter element.

NOTE: It will be necessary to upgrade your stock pump impeller to a steeper pitch when using our Power Filter Kit. Sea Doo and RIVA both strongly recommend the use of premium octane (91+) pump fuel in your Supercharged watercraft.

Description	Part No.
RIVA Power Filter Kit, RXP/RXT (2005-10),	RS13050-06
RXP-X 255 (2008-11)/RXT-X 255 (2008-10), GTX-SC (2005-09)	
Power Filter Kit GTX-SC (2003) only	RS13050-03
Power Filter only for RS 13050-03/06	RS13050-2
Pre-Filter Only for RS13050-2	RS13050-PF-BLK



INTAKE MANIFOLD UPGRADE KIT 255/260

RIVA's Intake Manifold Upgrade Kit enables your engine to produce more horsepower through increased boost pressure (+1lb). Supplied hole cutting tool allows easy removal of restrictive screen element from inside of intake manifold. Special o-ringed, billet block-off plug with integrated fitting for aftermarket boost pressure gauge fills opening left after removal of screen element. Includes detailed installation instructions. NOTE: RIVA's testing has determined the stock ECU will compensate for the increased boost provided by RIVA's Intake Manifold Upgrade Kit.

Description	Part No.
RIVA Intake Manifold Kit, RXP-X/RXP-X 255/260	RS12080-IMUK



RIVA SEA DOO POWER FILTER KIT

RIVA's Power Filter Kit draws cold air from outside your engine compartment delivering awesome performance and eliminating power-robbing heat intake. Forward air intake is separated from hot engine compartment with rigid thermal bulkhead that installs between engine & fuel tank. Cold air is delivered to engine via large 4" smooth-bore ducting that is attached to supercharger with unique velocity stack and sturdy billet clamps. Requires use of RIVA Catch Can/Oil Breather System (part# RS19050-BCC). IJSBA legal for all classes.

Note: RXT-X260 2011 & newer models require Tank Strap Upgrade Kit (part # RS13100-TSUK).

Description	Part No.
RIVA RXT-X 260 (2010-11) (non iS/aS) Power Filter Kit	RS13100
RIVA RXP-X 260 (T3) 2012 Power Filter Kit	RS13110



RIVA SEA DOO RXT/GTX IS/AS POWER FILTER KIT WITH SUSPENSION MODEL

Delivers greatly improved acceleration and top speed increase by replacing the restrictive stock intake system. The Power Filter[®] dramatically increases air flow to your supercharger via a large 4" diameter intake duct and oversized K&N filter element. Ducting is precision formed from a race proven composite that will not conduct heat to incoming air. Installs securely to supercharger via a tapered velocity stack, silicone coupler and stainless steel clamps. Includes pre-filter element.

Description	Part No.
Sea Doo Power Filter RXT iS&aS, GTX iS&aS	RS13100-S



RXP/RXT CATCH CAN/OIL BREATHER SYSTEM

Easy to install catch can/oil breather eliminates power-robbing crankcase fumes and oil vapor from your engine's air intake. Increases horsepower by removing the engine's requirement to burn relatively non-combustible oil. Also improves intercooler efficiency by preventing the oil sludge coating that lowers thermal efficiency. Excess oil vapor is routed to our translucent catch can where it condenses and collects for occasional draining via integrated petcock valve. Kit includes K&N breather, Sea Doo mounting bracket, hardware & instructions.

Description	Part No.
RIVA Catch Can Breather Kit, RXP 215, RXT 215, RXP-X 255, RXT-X 255, GTX 4-TEC, RXP-X 260 (T3) All RXT & GTX Non-Suspension Models (S3 Fixed Deck), Does Not Fit Suspension Deck 3 Models	RS19050-BCC

SEA DOO 4 STROKE	SEA DOO 4 STROKE
SYSTEMS	INTAKE SYSTEMS
GASKETS	ENGINE/GASKETS
EXHAUST	EXHAUST
HANDLING	DRIVE LINE HANDLING
ELECTRICAL	ELECTRICAL
WATERLINE	WATERLINE /BILGE
STEERING & CONTROLS	STEERING & CONTROLS
BODY	BODY
ACCESSORIES	ACCESSORIES
SERVICE TOOLS	SERVICE TOOLS /HARDWARE
CHEMICAL	CHEMICAL

SEA DOO 4-STROKE • SUPERCHARGER

SEA DOO
4 STROKE

INTAKE
SYSTEMS

ENGINE/
GASKETS

EXHAUST

DRIVE LINE
HANDLING

ELECTRICAL

WATERLINE
/BILGE

STEERING
& CONTROLS

BODY

SERVICE TOOLS
ACCESSORIES

/HARDWARE

CHEMICAL



RIVA GEN-2 SUPERCHARGER IMPELLER 215HP

Presenting the ultimate (drop-in) performance supercharger impeller for the Sea Doo 215hp engine! Working closely with Vortech Engineers, RIVA developed the

next generation high-performance replacement impeller that delivers 9lbs of boost @ 8,100rpm in RIVA Stage II applications. Produces more horsepower and torque throughout the RPM range resulting in excellent acceleration & top speed. Investment cast from an extremely strong, lightweight proprietary aluminum and CNC machined to ensure exact tolerances. All new blade design is optimized aerodynamically and precision balanced to deliver smooth operation. Installs easily into stock supercharger housing with no additional modifications required. Includes replacement mounting nut and detailed installation instructions.

**Note: It will be necessary to upgrade your stock pump impeller to a steeper pitch when using the Gen-2 Supercharger Impeller. Sea Doo and RIVA both strongly recommend the use of premium octane (91+) fuel in your Supercharged PWC.*

Description	Part No.
RIVA SC Impeller, all RXP 215/RXT 215/GTX-SC	RS1750-001B
RIVA Supercharger Impeller Nut	RS1750-001A-N



RIVA SEA DOO 255/260 XX-CHARGER

RIVA's new XX-Charger delivers 14.5 psi of boost pressure at rpm producing arm wrenching acceleration and increased top speed. High performance impeller, spacer & front housing combo increase horsepower through superior Vortech impeller blade design and larger interior housing volume. Impeller features a sophisticated blade design that is precision balanced to deliver smooth operation. Housing, spacer & impeller install quickly and easily onto stock supercharger base plate. Includes detailed installation instructions.

Requires RIVA Pro-Series ECU, RIVA Pro-Series Fuel Injectors (50lb) & RIVA Fuel Pressure Regulator Kit for correct calibration.

SPECS: 137mm with .060 housing spacer.
 • 13.5psi @ 8,100rpm
 • 14.5psi @ 8,500rpm

Description	Part No.
RIVA Sea Doo 255/260 XX-Charger	RS17080-IH-137-060



RIVA SEA DOO 215/255/260 XXX-CHARGER

Presenting the ultimate performance supercharger for Sea Doo 215/255/260 engines! The all new RIVA XXX-Charger is a complete supercharger assembly featuring a sophisticated, lightweight 140mm Vortech impeller that is precision balanced to deliver smooth operation, a billet spacer, machined front & rear housings and RIVA Heavy Duty Clutch Washers. Increase interior volume produces huge performance gains delivering 15.5psi @ 8,500rpm.

Each RIVA XXX-Charger is hand assembled in-house using Genuine BRP shaft, bearings & hardware. Installs quickly in place of OEM supercharger. Includes detailed installation instructions.

Requires RIVA Pro-Series ECU, RIVA Pro-Series Fuel Injectors (50lb) & RIVA Fuel Pressure Regulator Kit for correct calibration.

SPECS: 140mm with .060 housing spacer.
 • 14psi @ 8,100rpm
 • 15.5psi @ 8,500rpm

Description	Part No.
RIVA Sea Doo 215/255/260	RS17050-SC-140-060



R&D SUPERCHARGER SLEEVE

The sleeving up of the diameter of the Supercharger enables a 3.5" or 4" intake filter system to be utilized. The larger intake increases cubic air volume as well as decreases air inlet restriction. A win win, supercharge your supercharger and give it more air! Available in 3.5" and 4" diameters. Fits all Supercharged 4-Tec Models.

Description	Part No.
R&D Supercharger Sleeve 3-1/2" Diameter	613-95035
R&D Supercharger Sleeve 4" Diameter	613-95040



NEW



SEA DOO 255/260 C3 MONSTER CHARGER WHEEL

More Boost and Horsepower is on its way with the new R&D Monster Power Supercharger Impeller Wheel Kits. The R&D engineering staff has been developing a complete line of supercharger impeller wheels that actually deliver the power and boost pressures we promise. Each Monster Impeller wheel will come complete with a statistical data sheet graphing the RPM/boost pressures that the wheel produces, eliminating the mystery behind the supercharger.

Balancing Information:

R&D Monster Compressor Wheels for 255 H.P. 4 Tec engines have been precision mass center balanced in the preliminary casting/machining operations process, and precision two plane balanced after the final machining processes. The balance tolerances on the R&D Monster Wheels are held to a much stricter and tighter tolerance over O.E.M. or aftermarket wheels. Your R&D compressor wheel may have small balancing grooves machined in the blade channels of the wheel in some areas. This procedure is part of the mass center balancing process. The small grooves do not in any way impede or hinder the compressor wheels ability to efficiently pump or compress air. The R&D precision two plane balanced compressor wheels will perform perfectly and smoothly at 180,000-200,000 rpm's as the wheels have been blueprinted and balanced to stringent turbocharger specifications, even though the wheel will only spin at 46-48,000 rpm's in the Rotax engine at 8,000 crankshaft rpm's. R&D has gone the extra mile in the balancing process of the Monster Wheels as higher balancing standards will add significantly to the service life and performance of Rotax's vulnerable and temperamental clutch system. Precision balancing will significantly increase bearing life, promote better clutch performance, extend clutch life through decreased clutch slippage, and increase horsepower performance.

- Better throttle response, increased horsepower
- Increased boost pressure
- Increased mass airflow
- Precision two plane balanced (less vibration)
- Balance specifications (turbo specs .012-.027 gram inches)
- Increased bearing life
- Increased clutch life
- Improved clutch performance

Description

R&D Sea Doo 255/260 C3
Monster Charger Wheel

Part No.

NEW 613-94014



NEW



SEA DOO 255/260 C15X MONSTER CHARGER WHEEL

R&D now offers the new C15X Monster Wheel Kit. The new Billet C15X Monster Compressor Wheel is specifically developed to pump more boost and CFM while utilizing the O.E.M. compressor housings, stock fuel injectors, stock in tank fuel pump, and still run on 91 octane pump gasoline. The R&D Wheel Kit will pump out a solid 15 pounds of boost, which when compared, is up 5 full pounds of boost over stock which will easily add on an additional 30-40 H.P. R&D has increased the exducer blade dimensions and deck area to pump as much air as possible and still be able to have a properly tuned Lambda or AFR, again, using stock fuel injectors and stock fuel pump system. The R&D Monster Wheel is precision 5 Axis CNC Machined for maximum strength while maintaining lighter than stock weight ratios (30 grams lighter than stock). The R&D C15X series compressor wheels will install directly into any 2009-2013 255/260 supercharger as a "Bolt On" parts kit using basic hand tools. For additional rpm and speed performance specification information and what the C15X can do for you, view the latest Stage 4 Kits for RXP-X 260 and RXT-X 260's. NOTE: R&D can machine 2005-2008 model rear compressor housings to accommodate later model (larger exducer) wheels, and supply the 2009-2013 Sea Doo X front housing to upgrade any older model Sea Doo supercharger to 2013 Specifications.

The C15X wheel kit will require a R&D R4 Series Reprogrammed ECU, and the use of an R&D Rising Rate Fuel Pressure Regulator Kit. The R&D R4 ECU programs will offer a choice in rev limiter settings, and has the properly calibrated fuel maps that work seamlessly with the R&D Rising Rate Fuel Pressure Regulator System.

- Improved throttle response, increased overall horsepower
- Increased boost pressure up to 15-16 pounds (boost will vary depending on cam spec data)
- Increased airflow (3-4 pound per minute gain over stock)
- 30-40 horsepower increase over stock (depending on cam spec data) (more with R&D Pro Cooler)
- R&D ECU R4 Series Reprogramming **REQUIRED** (specify rev limiter and fuel type)
- R&D Rising Rate Fuel Pressure Regulator **REQUIRED**
- 91 Octane Pump Gasoline Safe (R4-PG) (PG=Pump Gasoline)
- Race Fuel Safe (R4-RG) (RG=Race Gasoline) 100 Octane Sunoco Aviation Fuel/VP-MS109

Description

R&D Sea Doo 255/260 C15X
Monster Charger Wheel

Part No.

NEW 613-94015

SEA DOO 4 STROKE	NAI/KE SYSTEMS	ENGINE/ GASKETS	EXHAUST	DRIVE LINE HANDLING	ELECTRICAL	WATERLINE /BILGE	STEERING & CONTROLS	BODY	ACCESSORIES SERVICE TOOLS /HARDWARE	CHEMICAL
---------------------	-------------------	--------------------	---------	------------------------	------------	---------------------	------------------------	------	---	----------

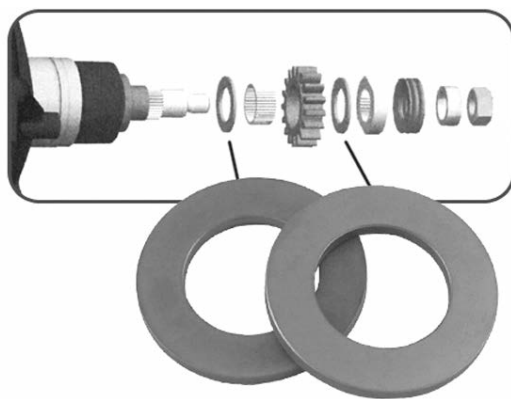

RIVA HEAVY-DUTY SUPERCHARGER CLUTCH WASHERS

These are direct replacements for the original clutch washers that are prone to fail on modified engines. Precision machined from tool grade steel to increase durability. Will not break up and damage engine at end of service life.

Description	Part No.
RIVA Clutch Washers (04-05) RXP, RXT, GTX SC	RS1751-HDW-945
RIVA Clutch Washers (06-07) RXP, RXT, GTX SC	RS1751-HDW-946*
<i>*NOTE: RS1751-HDW-946 must be used with 2006 style Sea Doo OEM Supercharger shaft Part #420881946</i>	

Description	Part No.
RIVA Clutch Washers (08 & Newer) 255HP RXP-X, RXT-X & 215HP RXP, RXT, GTX-SC, RXP-X 260, RXT-X 260	RS1751-HDW-948
<i>NOTE: BRP recommends that you replace the Supercharger shaft/clutch assembly when servicing your supercharger. Order part# 420881100 ('08 spec). Requires '08 spec Heavy-duty Clutch Washers (part# RS1751-HDW-948).</i>	

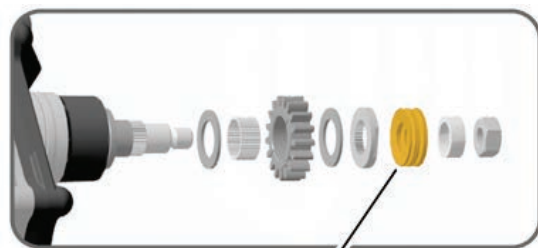

NEW



RIVA SD SUPERCHARGER SPRING WASHERS

These are direct replacements for the original spring washers that wear out on modified engines. Precision machined from high quality stainless steel to increase durability. Sold in set of five.

Description	Part No.
RIVA Replacement Spring Washers (2008 & newer models). Sold in set of five.	NEW RS1750-SWP-948



R&D SUPERCHARGER HIGH PERFORMANCE CLUTCH WASHER KIT

The R&D High Performance

Supercharger Clutch Washer Kit is a direct replacement upgrade for the very fragile factory BRP O.E.M. ceramic clutch washers that are and prone to fracture and disintegrate, which can resulting costly engine damages. The R&D High Performance Clutch Kit is manufactured from a high strength, wear resistant bronze alloy material that has a yield strength of 32,000 psi plus, and a Rockwell hardness of B95. The R&D Superclutch Washer Kit was designed to improve reliability without disintegrating under the Sea Doo superchargers high rpms, heat and is designed to not only but also increase boost by decreasing clutch slippage.

Description	Part No.
R&D Clutch Washer Kit (06-07) RXP/RXT 215*	613-95001
<i>*NOTE: (or any supercharger rebuilt or warranted with a BRP rebuild kit part #420881946 or #420881947) NOTE: BRP#420881946 is for 215 engines, and #420881947 is for 185 engines.</i>	
R&D Clutch Washer Kit (03-04) GTX 185 S/C, (04-05) RXP 215, (05) RXT 215	613-95002
<i>NOTE: BRP supercharger rebuilt kit installed, upgraded, or warranty updated with the BRP rebuild kits #420881947 (for 185) or #420881946 (for 215), these upgraded superchargers will require R&D PART # 613-95001</i>	
R&D Bronze Alloy Recreational Clutch Washer Kit (08) RXP/RXT 215HP, RXP-X/RXT-X 255HP/260HP	613-95006



R&D SUPERCHARGER ADJUSTABLE CLUTCH WASHER KIT

The R&D High Performance Racing Adjustable Clutch Washer Kit has been developed to offer precision calibration and tuning to the superchargers clutch system. Proper clutch torque slippage tuning will extend

clutch life. The Adjustable Clutch Kit offers three Clutch Washers and two Spring Washers, both in two different thicknesses that can be "performance specification" installed along with a strategic spring washer "stack" assembly specification to accommodate 8-18 Ft Pounds of torque or 96-216 inch pounds of torque. The wide range of adjustability will accommodate any manufacturers suggested clutch setting specification from old school 215 stock (7 P.S.I.) to 28 pounds of all out racing boost. R&D Clutch Washers are CNC machined from a billet high strength Steel Super Alloy, Heat Treated, and precision ground to final spec. The R&D Clutch Washers are designed to be able to properly slip and wear over time without failing under the stresses of the Sea Doo superchargers' high RPM's (42,000) and high heat. The R&D kit will directly replace and outperform all existing aftermarket kits. Improve performance and protect your investment with the R&D Racing Adjustable Clutch Washer Kit. Kit arrives complete with a specific setup chart diagram displaying how to set the clutch to achieve a specific torque slip setting. Kit also has a torque chart that displays a Foot pound conversion ranging from 6 to 20 pounds. Also, this Kit will retro back and fit all Supercharger models.

Description	Part No.
R&D SC Adjustable Clutch Washer Kit (2008-13) 215/255/260 Rotax Engine	613-95008

SEA DOO 4-STROKE • SUPERCHARGER

NEW

R&D RACING CLUTCH WASHER KIT



The R&D Racing Clutch Washer Kit is a direct replacement kit developed to offer precision calibration and tuning to the superchargers clutch system. R&D

Clutch Washers are CNC machined from a billet high strength Steel Super Alloy, Heat Treated, and precision ground to final spec. The clutch washers are made to OEM thickness, and will precisely reproduce Sea Doo's OEM recommended Factory clutch setting. Improve performance and protect your investment with the R&D Racing Clutch washer kit.

Description	Part No.
R&D Racing Steel Washer Kit (08 & Newer) RXP/RXT 215HP, RXP-X/RXT-X 255HP/260HP	NEW 613-95007

NEW

R&D REPLACEMENT SUPERCHARGER CLUTCH GEAR



The R&D 16 Tooth Clutch Gear is a direct replacement for worn or broken OEM clutch gears. Manufactured from billet steel alloy, CNC machined, heat treated, and precision ground to final specification.

Description	Part No.
Sea Doo (2004-13) 215/255/260 HP Supercharger 16 Tooth Replacement Clutch Gear	NEW 613-95016



R&D SUPERCHARGER REBUILD TOOL KIT

R&D has designed custom tools that are essential in the rebuilding process of a Sea Doo Supercharger. All tools are specific in application and are CNC machined to ensure a precision job.

Description	Part No.
A. Supercharger Holder Tool	613-96005
B. Bearing Puller/Installer Tool	613-96006
C. Seal/Bearing Retainer Torx Wrench	613-96008
D. 215HP 16 Tooth Drive Gear Tool	613-96016
D. 185HP 17 Tooth Drive Gear Tool	613-96017
E. 185HP Clutch drive / Lock Washer Tool	613-96018
E. 215HP Clutch drive / Lock Washer Tool	613-96019

SEA DOO OEM TYPE SPECIALTY TOOLS

For the removal, repair and installation of Sea Doo Superchargers.

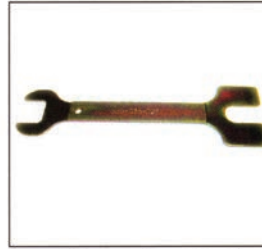

Super Charger Retaining Key
Part No. 950-110
O.E. No. 529-035-949
All 4 Tec's with Super Chargers



4-Pin Socket
Part No. 950-195
O.E. No. 529-035-948
Fits: 4-Tec Supercharged



Torx Adapter For All Super Charged 4-Tecs
Part No. 950-185
O.E. No. 529-035-938
Fits: 4-Tec Supercharged

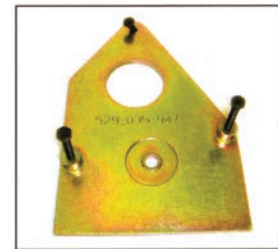

Support Plate 4-TEC Supercharged Engines
Part No. 950-190
O.E. No. 529-035-947
Fits: 4-Tec Supercharged



Ball Bearing Support Pusher
Part No. 950-200
O.E. No. 529-035-950
Fits: 4-Tec Supercharged



Camshaft Locking tool
Part No. 950-180
O.E. No. 529-035-839
Fits: 4-Tec Engines



RIVA SEA DOO SUPERCHARGER SHAFT HOLDER TOOL

Servicing your supercharger in a snap. Ergonomically designed billet handle, heat treated tool-grade steel to resist wear and to prevent flexing.

Description	Part No.
RIVA Sea Doo Supercharger Shaft Holder Tool	RS1750-ISH-949

SEA DOO
4 STROKE

INATKE
SYSTEMS

ENGINE/
GASKETS

EXHAUST

DRIVE LINE
HANDLING

ELECTRICAL

WATERLINE
/BILGE

STEERING
& CONTROLS

BODY

ACCESSORIES

SERVICE TOOLS
/HARDWARE

CHEMICAL

SEA DOO 4-STROKE • SUPERCHARGER



A.

B.

Sea Doo 215

Sea Doo 255

NEW



C.

Sea Doo 260

R&D RXP/RXP-X/RXT/RXT-X GTX-SC SUPERCHARGER SURGE PROTECTOR KIT

The R&D Surge Protector Kit will significantly improve supercharger clutch and compressor wheel performance and reliability by eliminating compressor surge. Compressor surge is defined as the negative charge of pressure that causes turbulence in the supercharger that occurs during aggressive of off-throttle operations. When the throttle valve is abruptly closed at high rpms, the engine decelerates quickly down from 8,000 rpms, however the supercharger is compressing air (creating boost) as the supercharger has to decelerate from 42,000 rpms. This turbulence is the primary cause of undue stress on the supercharger clutch system and its components. The R&D surge protection kit utilizes an automotive vacuum assisted Bosch pressure blow off valve that automatically releases the unwanted intake pressure between the closed throttle valve and the supercharger. As soon as the throttle valve is opened, the blow off valve immediately closes and the compressor can supply its full boost potentials to the engine.

Manufactured from high-temperature silicone hose with an integrated molded riser for the blow off valve to function without hindering intake flow or velocity. The R&D kit installs easily in place of the OEM rubber intake elbow joint. This kit is a very necessary and cost effective up-grade for all Sea Doo supercharged watercraft. Kit comes completely assembled with silicone elbow, blow off valve, R&D B.O.V. filter, mounting hardware and instructions.

Description	Part No.
A. R&D RXP 215, RXT 215, GTX-SC SC Surge Protector Kit	613-95003
B. R&D RXP-X 255, RXT-X 255 SC Surge Protector Kit	613-95255
C. R&D RXP-X 260, RXT-X 260, GTR 215 SC Surge Protector Kit	NEW 613-95258

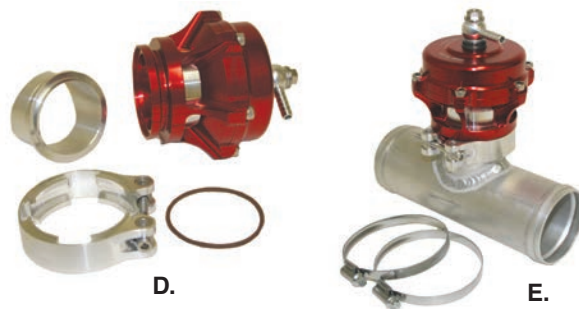

D.

E.

Valve only

BOV Kit

R&D/TIAL 50MM SURGE BLOW-OFF VALVE

Valve kit comes complete with R&D high temperature silicone hose, Tial 50mm blow-off valve, billet aluminum V-clamp, banjo style vacuum fitting, and 1/4" vacuum line.

- Aggressive throttle response, increased horsepower from a better seal
- Increased boost pressures over smaller valves that don't seal well
- Improved valve action with larger diaphragm and variable spring control
- Improved clutch performance from reduced off throttle back pressures
- Precision sequential valve operation
- Installs easy and clean to the O.E.M. intercooler inlet/outlet

Modification required for installation on Sea Doo PWC.

Description	Part No.
D. R&D/Tial 50mm BOV Valve only	613-95263
E. R&D/Tial 50mm BOV Kit	613-95259

NEW



R&D MULTI-PRESSURE PORT BOOST GAUGE/ SURGE/RRFPR ADAPTOR KIT

The R&D Sea Doo Multi-Pressure Port Adaptor Kit will allow quick and easy "BOLT ON" installations of Rising Rate Fuel Pressure Regulators, Tial/Greddy type surge valves, as well as digital or manual boost/vacuum gauges. The R&D Multi-Pressure Port Adaptor installs smartly between the OEM Map Sensor and the Sea Doo intake manifold as a "bolt on" part with no drilling modifications. The R&D adaptor has two large volume ports that allow for proper installation and operation of a vacuum/boost gauge, surge protection valve, and boost referenced fuel pressure regulator (RRFPR) all at the same time with one simple part. The R&D Pressure Port Adaptor Kit comes complete with all mounting hardware and instructions.

Description	Part No.
R&D Multi-Pressure Port Boost Gauge/ Surge/RRFPR Adaptor Kit	NEW 613-95270

SEA DOO 4-STROKE • SUPERCHARGER



Sea Doo 255
*Kit includes 2 clamps

R&D RXP-X/RXT-X 255 SILICONE INTAKE HOSE KIT

The R&D Supercharger High Performance Hose Kit was developed while testing the R&D Monster Compressor Wheel Kits. Higher boost pressures create higher intake air temperatures of up to 235 degrees. The O.E.M. standard black rubber hose and standard hose clamps just do not hold up to the pressures and heat like high quality, high temperature silicone hose and high strength stainless steel style hose clamps. The R&D "Blue Hose" is manufactured from high performance, turbo charger quality high temperature silicone.

Description	Part No.
R&D RXP-X/RXT-X 255 Silicone Intake Hose Kit	613-95256



NEW

R&D STRAIGHT SHOT INTAKE HOSE KIT FOR RXP-X 260

The R&D High Flow "Straight Shot" Intake kit is designed to offer

straight and direct flow of the intake air from the intercooler into the throttle body without turns or restriction. The direct air flow increases air speed to the throttle body and intake plenum promoting improved throttle response and acceleration performance throughout the entire RPM range.

Note: R&D Free Flow Exhaust Kit (Part #333-80258) required to install Straight Shot Intake Hose Kit.

Description	Part No.
R&D RXP-X 260 Straight Shot Intake Hose Kit	NEW 613-95257
R&D RXP-X 260 Free Flow Exhaust Kit	NEW 333-80258



RIVA SD 215 SUPERCHARGER BLOW-OFF VALVE KIT FOR OEM ELBOW JOINT INSTALLATION

RIVA's Blow-off Valve Kit improves supercharger reliability and performance by relieving unwanted pressure during off-throttle operation.

Reduces supercharger clutch wear and eliminates heat soak in the discharge tube. High-strength silicone hose with integrated blow-off valve installs easily in place of OEM elbow joint. Includes K&N filter to prevent debris from entering valve outlet. A simple and cost effective upgrade for both stock and modified supercharged engines. Includes all necessary mounting hardware and installation instructions.

Description	Part No.
Blow-Off Valve Kit SD 215 RXP/RXT/GTX-SC	RS1750-BV

RIVA PERFORMANCE BLOW-OFF VALVE KIT

Blow-off Valves help reduce wear and tear on clutch & drive gears of superchargers and eliminate heat soak in discharge tubes. See application chart below.

RIVA Kit Application Chart:

- 255hp Sea Doo Stage II & above: Pro-Series Blow-off Valve Kit (part# RS17081-BOV-SSQV)*
- 215hp Sea Doo Stage III & above: Pro-Series Blow-off Valve Kit (part# RS17081-BOV-SSQV)*
- 215hp Sea Doo Stage I & II applications: Performance Blow-off Valve Kit (part# RS17080-BV-PFV)**



HKS SSQV BLOW-OFF VALVE KIT

High quality HKS Blow-Off Valve reduces wear and tear on clutch & drive gears of supercharger and eliminates heat soak in the discharge tube. For use with RIVA Sea Doo Power Cooler Kits. HKS Super SQV (Super Sequential Blow Off Valve)

features unique sequential valve structure and a differential pressure control system, allowing for a broad operation boost range. Includes vacuum line fittings necessary for installation.

Description	Part No.
HKS SSQV Blow-Off Valve Kit	*RS17081-BOV-SSQV



RIVA PERFORMANCE BLOW-OFF VALVE KIT

For use with RS17080-ICUK or RS1751-PC-1 Kits installed on 215hp Sea Doo Stage I & II applications.

Description	Part No.
RIVA Performance Blow-Off Valve Kit	**RS17080-BV-PFV



RIVA SD 215/255 BLOCK-OFF KIT, SD BLOW-OFF VALVE

For use with RS17080-ICUK or RS1751-PC-1 Kits.

Description	Part No.
RIVA SD 215/255 Block-Off Kit, SD Blow-Off Valve	RS1750-BVBO

SEA DOO
4 STROKE

INTAKE
SYSTEMS

ENGINE/
GASKETS

EXHAUST

DRIVE LINE
HANDLING

ELECTRICAL

WATERLINE
/BLIGE

STEERING
& CONTROLS

BODY

ACCESSORIES
SERVICE TOOLS

/HARDWARE

CHEMICAL

SEA DOO 4-STROKE • INTERCOOLER

NEW



RIVA SEA DOO POWER COOLER KIT

Presenting the ultimate aftermarket intercooler system for the Sea Doo 215hp engine! The RIVA 'GEN-3' Power Cooler is the next generation intercooler system featuring a new "oversized" cooler element for maximum efficiency. Delivers an increase of 18 peak horsepower over original intercooler providing arm-wrenching results on the water. The 'GEN-3' Power Cooler features a new extruded cooler core design that delivers excellent thermal efficiency and minimal pressure. The cooling element is dramatically more efficient than the stock unit with exit temperatures averaging 50°F cooler than stock. This delivers cooler, denser air for increased performance throughout the RPM range. Precision machined billet water tanks hold up to high pressure cooling systems that can cause original coolers to fail. Includes integrated blow-off valve mount that will accept RIVA Blow-Off Valve kits (sold separately) for improved supercharger reliability and performance, dedicated flush point and sacrificial anode. Use of Blow-Off Valve also reduces supercharger clutch wear and eliminates heat soak in discharge tube. Power Cooler Kit contains all necessary mounting hardware and installation instructions.

Requires use of [RIVA Rear Exhaust Kit \(RS15050-1\)](#) and RIVA O.P.A.S. Block-off Kit [Performance \(RS29050-1\)](#) or [Pro-Series \(RS29950, RS29985\)](#). Fits 2004~2010 215hp non-iControl Models.

RIVA Blow-Off Valve Kit Application Chart:

- 215hp Sea Doo Stage I & II: [RIVA Performance Blow-Off Valve Kit \(RS17080-BV-PFV\)](#)
- 215hp Sea Doo Stage III & above: [RIVA Pro-Series Blow-Off Valve Kit \(RS17081-BOV-SSQV\)](#)
- [RIVA BLOW-Off Valve Block-off Kit \(RS17050-BVB0\)](#)

Description	Part No.
RIVA Gen-3 Power Cooler Kit SD215 NEW	RS1752-PC
(non iControl)	



GEN-III

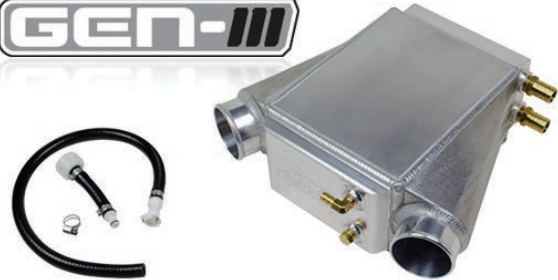

RIVA SEA DOO 'GEN-3' POWER COOLER CORE

RIVA's 'GEN-3' Power Cooler is the ultimate intercooler for high performance Sea Doo engines! All new extruded cooler core design delivers excellent thermal efficiency and minimal pressure drops. Perfect for use in high boost supercharged and turbo applications. Precision machined billet water tanks hold up to high pressure cooling systems that can cause original coolers to fail. This is a direct high performance replacement for all Sea Doo external intercoolers. [Requires use of RXP-X/RXT-X 260 intercooler tubing upgrade kit \(RS17090-TK\).](#)

Key Features Include:

- Cooler & denser air charge produces more horsepower.
- Large cooler element rated for 450HP.
- Replaceable sacrificial zinc anode protects cooler element from corrosion.
- Integrated flushing system keeps Power Cooler at peak performance.

APPLICATIONS:

- Direct replacement for smaller OEM 2011-12 external intercoolers.
- Direct replacement for all OEM 2010 and prior external intercoolers.
- Compatible upgrade for RIVA 'GEN-2' Power Cooler Kit (RS1751-PC).

Description	Part No.
RIVA SD 'Gen-3' Power Cooler Core 255/260	RS1752-PC-I
See next page for intercooler tubing upgrade tubing kit	

NEW



RIVA UNIVERSAL PWC FILTER KIT

RIVA's Universal Water Filter/Strainer Kit protects your intercooler from damage & reduced efficiency due to waterborne debris such as sand, seaweed, grass and pebbles that are sucked into the cooling system. Oversize "Super Strainer" mounts easily inline with cooling system and features clear filter cup for quick visual inspection. Kit includes large high quality marine strainer, stainless steel mounting bracket and a selection of adapter fittings to match Yamaha, Sea Doo & Kawasaki applications.

Description	Part No.
RIVA Water Filter/Strainer Kit NEW	RY1012-SDF-UK

SEA DOO 4-STROKE • INTERCOOLER



RIVA OEM INTERCOOLER UPGRADE KIT 255HP

RIVA intercooler Upgrade Kit for the new RXP-X & RXT-X relocates the original intercooler and significantly improves efficiency of the system with upgraded components.

Key benefits include:

- Relocation of original intercooler: By strategically moving original intercooler, we have greatly improved access to engine compartment. Relocation also allows installation of key performance parts including RIVA Rear Exhaust Kit (RS15050-1) & RIVA Pro-Series Power Filter Kit (RS13056).
- Precision formed aluminum tubing: The high strength aluminum tubes are shorter than original to minimize boost loss. Also, the rigid aluminum will not swell under pressure like original soft rubber hoses providing improved throttle response.
- Integrated blow-off valve mount: Intercooler tubing includes mount for RIVA Pro-Series Blow-Off Valve Kit (RS17081-BOV-SSQV) or RIVA Blow-Off Valve Block-off Kit (RS17050-BVBO); both sold separately. Kit includes sturdy aluminum intercooler mounting bracket, high strength mandrel bent aluminum tubing and all necessary mounting hardware & installation instructions. Requires installation of RIVA Rear Exhaust Kit (RS15050-1) and RIVA Performance OPAS Block-off Kit (RS29050-1).

Description	Part No.
RIVA RXP-X 255 (2008-11), RXT-X 255 (2008-10) Stock Intercooler Upgrade Kit	RS17080-ICUK



RIVA SEA DOO RXP-X/RXT-X 260 INTERCOOLER TUBING UPGRADE KIT

RIVA's Intercooler Tubing Upgrade Kit significantly improves the performance & reliability of your intercooler system. This is an essential upgrade for all racing and recreational performance craft.

Key features include:

- **Precision formed aluminum tubing:** High strength aluminum tubes are shorter than original to minimize boost loss. Rigid aluminum will not swell under pressure like original soft rubber hoses providing improved throttle response & reliability.
- **Integrated blow-off valve mount:** Intercooler tubing includes mount for HKS Blow-Off Valve Kit (RS17081-BOV-SSQV) or RIVA Blow-Off Valve Block-off Kit (RS1750-BVBO); both sold separately. Use of blow-off valve reduces wear and tear on clutch & drive gears of supercharger and eliminates heat soak in discharge tube.
- High quality silicone couplers & stainless steel clamps.

Fits all 09-12 Sea Doo craft with S3 hulls (RXT/GTX S3 models) along with 2012 RXP-X 260 T3 hull. Requires use of RIVA 'GEN-3' Power Cooler (part# RS1752-PC) or OEM '08-10 Sea Doo 255/260 intercooler. Not compatible with smaller 2011 and newer OEM intercoolers.

Description	Part No.
RIVA RXP-X 260, RXT-X 260 Intercooler Tubing Upgrade Kit (S3 & T3 Hull)	RS17090-TK



SEA DOO INTERCOOLER/SUPERCHARGER LUBRICATION KIT

This kit will allow you to spray a aerosol lubricant of your choice into the supercharger, intercooler and throttle body to prevent rust from the excess moisture in the system. Complete instructions, pictures and a diagram supplied for a simple installation.

Description	Part No.
Sea Doo Spray Nozzle Inlet for Lubrication	IWCS-SSU

SEA DOO 4 STROKE	NA/ATK SYSTEMS	ENGINE/ GASKETS	EXHAUST	DRIVE LINE HANDLING	ELECTRICAL	WATERLINE /BILGE	STEERING & CONTROLS	BODY	ACCESSORIES	SERVICE TOOLS /HARDWARE	CHEMICAL
------------------	----------------	-----------------	---------	---------------------	------------	------------------	---------------------	------	-------------	-------------------------	----------

SEA DOO 4-STROKE • INTERCOOLER

NEW



R&D ENGINE THERMOSTAT & INTERCOOLER COOLING KIT

The R&D Thermostat/Intercooler/Engine Cooling Kit is one stop shopping to solve several big issues with the O.E.M. cooling system. Engine temperatures on a RXP 260 engine with performance upgrades can reach 190-195 degrees with the stock cooling system. The R&D Kit changes out the stock thermostat for a new cooler 160 degree thermostat. The R&D Kit also separates and re-routes the "intercooler out" and "engine out" water lines to allow less restriction and more water to flow through both the engines exhaust system and the intercooler which will promote cooler exhaust temperatures as well as reduce intake air temperatures. The R&D Kit also includes two new 1/2 inch water bypass fittings for the intercooler in and out lines, one to be used with the kit included high pressure relief valve, and one for the new intercooler water out line. The R&D "high pressure" relief valve will protect the intercooler from being broken due to high water pressure spikes. Cooler engine temperatures, cooler intake air temperatures, and cooler exhaust temperatures all add up to a noticeable RPM and top speed gain.

Description R&D Thermostat & Intercooler Cooling Kit **Part No.** **NEW** 663-15000

NEW



R&D ENGINE THERMOSTAT KIT

The R&D Engine Thermostat Kit is designed to lower the engine operating temperature. Engine

temperatures on a Sea Doo 260 engine with performance upgrades can reach 190-195 degrees with the stock cooling system. The R&D Kit changes out the stock thermostat for a new cooler 160 degree thermostat. Cooler engine temperature adds up to a noticeable RPM and top speed gain. Kit comes complete with installation tool.

Description R&D Engine Thermostat Kit **Part No.** **NEW** 663-15010



RIVA SEA DOO BVIC INTAKE BLOCK-OFF

Made from billet aluminum, RIVA's block-off plate fills the opening in the 215 intake manifold left when the stock intercooler is removed. Integrated fitting allows for use of aftermarket boost gauge. Includes Viton o-ring and is anodized to prevent corrosion.

Description RIVA BVIC Intake Block-off **Part No.** RS1750-PC-ABBO

RIVA RXP/RXT/GTX THERMOSTAT KIT

RIVA's cool running Thermostat Kit reduces the operating temperature of your modified 4-Tec® engine by 30°F for maximum reliability and performance. Kit includes replacement thermostat, billet coolant inlet flange, stock thermostat removal tool, Oetiker® clamps, Oetiker® pliers and detailed installation instructions. *NOTE: Thermostat housing (shown above) not included.

Description RIVA Thermostat Kit, SD RXP/RXT/GTX **Part No.** RS1015

SEA DOO MODEL-HULL REFERENCE CHART

Model	Year	SC*	Hull	Notes
GTI 130	2006-10	N/A	GTI-1	Version 1 of 4-TEC GTI hull
GTI 130	2011-13	N/A	GTI-2	Version 2 of 4-TEC GTI hull
GTI LTD 155	2011-13	N/A	GTI-2	Version 2 of 4-TEC GTI hull
GTI SE 155	2007-10	N/A	GTI-1	Version 1 of 4-TEC GTI hull
GTI SE 155	2011-12	N/A	GTI-2	Version 2 of 4-TEC GTI hull
GTI SE 130	2006-10	N/A	GTI-1	Version 1 of 4-TEC GTI hull
GTI SE 130	2011-13	N/A	GTI-2	Version 2 of 4-TEC GTI hull
GTR 215	2012-13	SC	GTI-2	Version 2 of 4-TEC GTI hull Supercharged 215hp 1503 engine
GTS 130	2011-13	N/A	GTI-2	Version 2 of 4-TEC GTI hull
GTX 155	2005-09	N/A	GTX-1	Original 4-TEC GTX hull
GTX 155	2010-13	N/A	S3	S3 with iBR
GTX 4 TEC	2002-04	N/A	GTX-1	Original 4-TEC GTX hull
GTX 4-TEC SC	2003-04	SC	GTX-1	Original 4-TEC GTX hull
GTX 4-TEC TOW	2003-04	N/A	GTX-1	Original 4-TEC GTX hull
GTX SC 215	2005-06	SC	GTX-1	Original 4-TEC GTX hull
GTX 215	2008-10	SC	GTX-1	Original 4-TEC GTX hull
GTX 215	2011	SC	S3	S3 with iBR
GTX IS 215	2010-11	SC	S3	S3 with iBR
GTX 215	2012-13	SC	S3	S3 with iBR
GTX 255	2004	SC	GTX-1	Original 4-TEC GTX hull
GTX LTD 215	2005-08	SC	GTX-1	Original 4-TEC GTX hull
GTX IS 255	2009	SC	S3	S3 with iBR
GTX LTD 260	2010-13	SC	S3	S3 with iBR
GTX S 155	2012-13	N/A	S3	S3 with iBR
RXP 155	2007-08	SC	RXP-1	Original RXP hull short intake duct
RXP 215	2004-10	SC	RXP-1	Original RXP hull short intake duct
RXP-X 255	2008-11	SC	RXP-2	Original RXP hull longer intake duct
RXP-X 260	2012-13	SC	RXP-3	All new 260hp, T3 and iBR
RXT 215	2005-10	SC	GTX-1	Original 4-TEC GTX hull
RXT-X 255	2008-10	SC	GTX-1	S3 with iBR
RXT iS 255	2009	SC	S3	S3 with iBR
RXT iS 260	2010-12	SC	S3	S3 with iBR
RXT 260	2011-13	SC	S3	S3 with iBR
RXT-X aS 260	2011	SC	S3	S3 with iBR
RXT-X aS 260	2012-13	SC	S3	S3 with iBR NEW: bow stabilizers adjustable rear sponsons & adjustable trim tabs.
RXT-X 260	2011-13	SC	S3	S3 with iBR
WAKE 155	2005-09	N/A	GTX-1	Original 4-TEC GTX hull
WAKE 155	2010	N/A	GTI-1	Version 1 of 4-TEC GTI hull
WAKE 155	2011-13	N/A	GTI-2	Version 2 of 4-TEC GTI hull
WAKE 215	2007-10	SC	GTX-1	Original 4-TEC GTX hull
WAKE 215	2011-13	SC	S3	S3 with iBR

*SC = Supercharged, N/A = Naturally Aspirated
iBR = Intelligent Brake & Reverse. It's the system at the rear of the craft that works the brake bucket, reverse bucket and variable trim system.

SEA DOO 4-STROKE • EXHAUST



R&D 215HP RXP/RXT EXHAUST MANIFOLD X-TENDER KIT

The R&D Exhaust X-Tender Kit allows the exhaust to be extended 1.5 inches which will move the water muffler back 1.5 inches creating enough room to be able to change out a supercharger (Hot) in 5 minutes. No more hassling with extremely hot exhaust pipes, water

mufflers and V-band clamps! The X-TENDER kit installs easily using an additional V-band clamp. Install the R&D Exhaust X-TENDER kit in place and never hassle a supercharger change out again. The R&D kit will install directly to all RXT/RXP/GTX supercharged model Sea Doo's using O.E.M. BRP hardware.

Description	Part No.
R&D Manifold Exh X-Tender Kit RXP, RXT 215HP	613-95004



R&D RXP-X/RXT-X EXHAUST MANIFOLD X-TENDER / O2 SENSOR MOUNT KIT

The R&D Exhaust X-Tender Kit allows the exhaust to be extended 2 inches which will move the water

muffler back 2 inches creating enough room to be able to change out a supercharger (Hot) in 5 minutes. No more hassling with extremely hot exhaust pipes, water mufflers and V-band clamps! An additional bonus is the oxygen sensor mount incorporated into the X-Tender, allowing quick and easy installation of an AFR Gauge (Air/Fuel Ratio) for properly tuning the X power plant. The X-Tender kit installs easily using an additional OEM V-band clamp. The R&D kit will install directly to all Sea Doo X supercharged models using O.E.M. BRP hardware. You will need to purchase an extra OEM V band clamp. One is not provided.

Description	Part No.
R&D Exhaust Manifold X-Tender / O2 Sensor Mount Kit RXP-X, RXT-X	333-80155



R&D BILLET EXHAUST OUTLET

Description	Part No.
R&D 3" Diameter R&D Billet Exhaust Outlet	331-30000
R&D 2.75" Diameter R&D Billet Exhaust Outlet	331-32750



R&D HIGH TEMPERATURE SILICONE COUPLINGS

Description	Part No.
3" - 3" High Temp Silicone Couplings	061-30030
3" - 2" Reducer High Temp Silicone Couplings	061-32500
2.75" - 2.5" Reducer High Temp Silicone Couplings	061-32501
3" - 2.75" Reducer High Temp Silicone Couplings	061-32750



R&D RXP-X/RXT-X 255HP MODEL FREE-FLOW EXHAUST

The new R&D Free-Flow Exhaust Kit eliminates the power robbing sound suppression system allowing the exhaust to travel out of the water box with zero restriction and back pressure. Improves acceleration and top speed.

Description	Part No.
R&D RXP-X/RXT-X 255HP Model Free-Flow Exhaust	333-80255

NEW



R&D RXP-X 260 (2012) FREE-FLOW EXHAUST KIT



The new R&D Free-Flow Exhaust Kit eliminates the all plastic power robbing sound suppression system with a opened up and re-routed design allowing the exhaust to travel out of the water box with zero restriction and back pressure. Improves acceleration and top speed Performance averages. The R&D Free Flow Kit is manufactured from oversized CNC precision mandrel bent aluminum tubing and is coupled with High Temperature Silicone Hoses and performance clamps guaranteed to handle higher exhaust temperatures. The R&D kit gives your 260X the performance "Muscle Car" sound it deserves. The R&D kit removes ALL the unwanted plastic exhaust parts.

Description	Part No.
R&D RXP-X 260 Free Flow Exhaust Kit	NEW 333-80258

NEW



RIVA REAR STORAGE BUCKET FOR iS/aS MODELS USING RIVA REAR EXHAUST KIT PART # RS15100-2

The RIVA rear storage tub for Sea Doo S3 iS & aS models allows installation of RIVA Rear Exhaust Kit (RS15100-2 page 15) or RIVA Pro-Series Water Box (RS16091 page 14). Replaces OEM storage tub creating clearance for performance components while sealing craft from water intrusion.

- Required when installing RIVA Rear Exhaust Kit (RS15100-2) on Sea Doo S3 iS/aS suspension models.
- Required when installing RIVA Pro-Series Water Box (RS16091) on Sea Doo iS/aS suspension models hull outlet flange.

Description	Part No.
RIVA Rear Storage Bucket for iS/aS Models.	NEW RS15090-RSB

SEA DOO 4 STROKE	NA/ATKE SYSTEMS	ENGINE/ GASKETS	EXHAUST	DRIVE LINE HANDLING	ELECTRICAL	WATERLINE /BILGE	STEERING & CONTROLS	BODY	ACCESSORIES SERVICE TOOLS /HARDWARE	CHEMICAL
------------------	-----------------	-----------------	---------	---------------------	------------	------------------	---------------------	------	-------------------------------------	----------

SEA DOO
4 STROKE

INTAKE
SYSTEMS

ENGINE/
GASKETS

EXHAUST

DRIVE LINE
HANDLING

ELECTRICAL

WATERLINE
/BILGE

STEERING
& CONTROLS

BODY

ACCESSORIES

SERVICE TOOLS
/HARDWARE

CHEMICAL

NEW



RIVA PRO SERIES SEA DOO S3/T3 WATER BOX

Applications: 2012 & Newer Sea Doo RXP-X (T3) Models
2009 & Newer Sea Doo RXT/GTX iControl (S3) Models

Important: The following additional RIVA Exhaust Components are required to complete the installation.

- RXT/GTX (S3) iControl Models:
Aluminum Exhaust Tube RS16091-ET-100
- RXP-X (T3) iControl Models:
Aluminum Exhaust Tube RS16091-ET-110
- All S3 & T3 Models:
Billet Rear Exhaust Outlet RS15090-ET

Note: Water Box is not designed or intended to be used with stock rubber exhaust hose and/or stock exhaust outlet.

Note: RS15090-RSB is required for iS/aS SE models. Not required for RXP-X 260 (T3) as there are no storage compartments at rear of craft.

Description	Part No.
RIVA Sea Doo S3/T3 Models Water Box NEW	RS16091
RIVA Rear Storage Bucket	RS15090-RSB

NEW



RIVA PRO SERIES SEA DOO 08 & NEWER WATER BOX

Important Notes: Will directly replace and upgrade RIVA Rear Exhaust Kit (part # RS15050-1) utilizing existing rear exhaust outlet installation.

If rear exhaust has not been installed, order the RIVA Rear Exhaust Outlet Coupler Kit (part # RS116082-ECK) and RIVA Rear Exhaust Outlet Kit part # RS15050-ET) to complete the installation.

Requires use of RIVA O.P.A.S. Block-off Kit (Performance or Pro Series).

Description	Part No.
RIVA Sea Doo 08 & Newer 255/215hp (non iControl) Pro Series Waterbox NEW	RS16081



RIVA PRO SERIES SEA DOO 07 & OLDER WATER BOX

Important Notes: Will directly replace and upgrade RIVA Rear Exhaust Kit (part # RS15050-1) utilizing existing rear exhaust outlet installation.

If rear exhaust has not been installed, order the RIVA Rear Exhaust Outlet Coupler Kit (part # RS15050-ET) to complete the installation.

Requires use of RIVA O.P.A.S. Block-off Kit (Performance or Pro Series).

Description	Part No.
RIVA Sea Doo 07 & Older 215hp (non iControl) Pro Series Waterbox	RS16082

NEW



RIVA REAR EXHAUST STOCK OUTLET COUPLER KIT

Used when installing RIVA Pro Series Aluminum Water Boxes in Sea Doo RXP-X, RXT-X, RXP, RXT & GTX-SC models that have the stock exhaust outlet in place. High temperature silicone coupler and stainless steel hose clamps connect water box outlet tube with thru-hull outlet flange.

Description	Part No.
RIVA Rear Exhaust Outlet Coupler Stock Kit NEW	RS16082-ECK



RIVA REAR EXHAUST OUTLET KIT FOR AFTERMARKET INTERCOOLER OR WATERBOX

Kit allows you to relocate exhaust outlet to rear of craft when using aftermarket intercooler systems or water boxes. Includes billet through-hull exhaust outlet and OE exhaust outlet block-off along with all necessary mounting hardware.

Description	Part No.
RIVA Rear Exhaust Outlet Kit SD 215/255 Models NEW	RS15050-ET
RIVA Rear Exhaust Outlet Kit SD RXT/GTX (S3) and RXP-X (T3) iControl Models* NEW	RS15090-ET

**S3, T3 Models, Please Check Hull List page 12*

SEA DOO 4-STROKE • EXHAUST



RIVA EXHAUST TUBE FOR RS16091 WATER BOX

Mandrel bent aluminum exhaust tube with bead rolled end couples our Pro Series Water Box (part # RS16091) with our Billet Rear Exhaust Outlet (part # RS 15090-ET). Powder coated to prevent corrosion.

Description	Part No.
For use in 2009 & Newer Sea Doo RXT/GTX (S3) iControl Models	NEW RS16091-ET-100
For use in 2012 & Newer Sea Doo RXP-X (T3) Models	NEW RS16091-ET-110



RIVA FREE FLOW EXHAUST KITS FOR OEM INTERCOOLER AND OEM WATER BOX UTILIZING STOCK SIDE EXHAUST OUTLET

Replaces the restrictive sound suppression system located between the water box and hull exit on your watercraft. Improves engine performance by reducing back pressure and harmful detonation. Includes mandrel bent aluminum tubing that is powder coated to prevent corrosion, high-temp silicone replacement coupler and installation instructions.

Description	Part No.
RIVA Free-Flow Exhaust Kit all Sea Doo Models with All S3 & T3 Hulls including RXT-X 260, iS & aS units, RXP-X260	RS16090
RIVA Free-Flow Exhaust Kit RXP-X, RXT-X 255 (08-11)(non iControl)	RS16080



RIVA REAR EXHAUST KITS FOR OEM INTERCOOLER AND OEM WATER BOX UTILIZING STRAIGHT EXHAUST OUTLET

RIVA's rear exhaust kit delivers performance and cutting-edge style. Allows for removal of restrictive sound suppression system located between water box and hull exit. Improves engine performance by reducing back pressure and restriction. Includes mandrel bent aluminum exhaust tube that is powder coated to prevent corrosion, large billet through-hull exhaust outlet, billet OEM exhaust outlet block-off and high-temp silicone couplers along with all necessary mounting hardware & installation instructions.

- 2008-2011 RXP-X 255 non-iControl
- 2004-2009 RXP 215
- 2008-2009 RXT-X non iControl
- 2003-2010 RXT/GTX 215 non-iControl

Note: Removal of O.P.A.S. and installation of RIVA Performance O.P.A.S. Block-off Kit is necessary to accommodate installation of RIVA Rear Exhaust Kit for all models. RXP-X & RXT-X models require use of OEM Intercooler Upgrade Kit, along with O.P.A.S. Block-off Kit.

Description	Part No.
RIVA Rear Exhaust Kit 255/215hp (non iControl)	RS15050-1



RS15100-2

NEW



- Fits all RXT-X/RXT (S3) fixed deck models with no other modifications.
- RXT/GTX iS & aS (S3) suspension models require additional RIVA Rear Storage Bucket (part # RS15090-RSB, see page 13)

Description	Part No.
RIVA Rear Exhaust Kit Sea Doo S3 Models	RS15100-2



- Fits 2012 & Newer Sea Doo RXP-X 260

Description	Part No.
RIVA Rear Exhaust Kit RXP-X 260 (T3)	RS15110

SEA DOO 4 STROKE	NAKKE SYSTEMS	ENGINE/ GASKETS	EXHAUST	DRIVE LINE HANDLING	ELECTRICAL	WATERLINE /BILGE	STEERING & CONTROLS	BODY	ACCESSORIES	SERVICE TOOLS /HARDWARE	CHEMICAL
------------------	---------------	-----------------	---------	---------------------	------------	------------------	---------------------	------	-------------	-------------------------	----------



RIVA SEA DOO PRO-SERIES ECU

RIVA's Pro-Series Racing ECU delivers a huge performance advantage to the Sea Doo 255 & 215 Supercharged Intercooled engines. ECU is calibrated for Stage II & III applications and must be used with RIVA Pro-Series 50lb Fuel Injector Kit, RIVA Valve Train Upgrade Kit and 91+ octane pump fuel. Plugs directly into factory wiring harness in place of stock ECU.

Key Benefits Include:

- Performance Fuel Mapping: Delivers optimal fuel required for your specific level of modification (Stage II or III) based on boost pressure.
- Performance Timing Curves: Special racing curves produce more power throughout the RPM range. Timing is automatically adjusted based on sensor input.
- Rev Limiter Increase: Stock rev limit has been increased from 8,300 to 8,650 RPM. With the recommended pump combination, engine RPM can be run higher producing more boost pressure and horsepower.
- Practice Key: In addition to normal "full power" key, a 60 MPH "practice" key can be programmed by BRP dealer BUDS system to limit speed for racecourse practice. ECU does not support original "learning" key mode.
- Retains Engine Diagnostic & Primary Safety Functions:
 - 1) Provides diagnostic information displayed on dash instrumentation along with more detailed data through BRP dealer BUDS. system.
 - 2) Sensor input is monitored for abnormal readings and will react by triggering warnings and/or limp mode.

**NOTE: This product is for competition use only. Must be used with RIVA Pro-Series 50lb Fuel Injector Kit (part #RS12050-I-KIT-50) RIVA Valve Train Upgrade Kit (part #RS19050-VTU) and 91+ octane pump fuel. Unit must be activated in watercraft by an authorized BRP dealer using BUDS system. Activation by RIVA Racing available with customer supplied throttle body. Installation of this racing product will void BRP factory warranty.*

Description	Part No.
RIVA Pro-Series ECU 08 255 RXP-X, RXT-X, 07-08, 215 RXP/RXT	RS11850-01-C
RIVA Pro-Series 50lb Injector Kit SD 255/215	RS12050-I-KIT-50
RIVA Sea Doo 4-Tec (All) Valve Train Upgrade Kit	RS19050-VTU



TORX® SOCKET SET FOR SEA DOO ENGINES

Special Star Sockets for Sea Doo 4-TEC & DI engine bolts are made from heat-treated vanadium steel and black oxide coated for durability. Supplied in a convenient vinyl socket holder.

- Four 3/8" Drive Sockets (T10, T12, T14, T16)
- Three 1/4" Drive Sockets (T6, T7, T8)

Description	Part No.
Torx Socket Set	LS26750



RIVA SEA DOO SPEED CONTROL OVERRIDE MODULE

The RIVA Speed Control Override Module removes the restrictive GPS speed control function on Sea Doo iControl models delivering significant increases in top speed with stock ECU. Easy to install module allows system to start in "Sport Mode" for maximum performance. "Touring Mode" can be manually selected after start up.

Key Features:

- Removes GPS controlled speed limiter.
- Increases top speed utilizing stock ECU.
- Works on all 2010 & newer iControl models.
- U.S. models will gain 3mph with aftermarket pump impeller.

2012 RXP-X 260 models: Stock Pump Impeller

All 2011-12 RXT & GTX 260 models: SRX-CD-15/20R

All 2010 RXT & GTX 260 models: SRX-CD-15/22R

- Allows further top speed gains through aftermarket modifications.
- Allows system to start in "Sport Mode".
- All original dash functions are retained.
- Easy plug-in installation.

NOTE: Stock ECU limits peak RPM for first 5 hours of operation. Top speed increases should be measured after 5 hour break in period.

Description	Part No.
RIVA 2010 Speed Control Override Module	RS11090-SCOM-10
RIVA 2011-12 Speed Control Override Module	RS11090-SCOM-11

NEW



R&D SEA DOO SPEED CONTROL OVERRIDE MODULE

The R&D Boost Box for 2011-2013 Sea Doo 260 offers a plug and play way to quickly and easily disconnect the engine management systems internal GPS speed limiter to allow an incredible five mile per hour top speed gain!

The R&D Boost Box allows maximum boost pressure (10 PSI) to be reached by overriding the O.E.M. internal GPS speed control. With 3 pounds of boost pressure over stock settings this will allow the Sea Doo 260 engine to accelerate better and pull harder in the upper mid range and top end with up to 5 mph speed gain.

The R&D Boost Box is a vital and necessary key to unlocking and adding performance to the new Sea Doo 260 engine platform. Whether you are a recreational enthusiasts or an offshore racers who is interested in more performance, the Boost Box is an absolute "Must Doo" Upgrade. The R&D Boost Box installs easily in 5 minutes. Also fits on GTR 215 (2012-13).

Description	Part No.
R&D 2011-13 Sea Doo Boost Box/SCOM	NEW 803-01001

NEW



RIVA/ATHENA SERIES SEA DOO ICONTROL ECU

The RIVA/ATHENA Pro-Series iControl ECU provides a huge performance advantage to Sea Doo iControl models delivering over 40hp to the stock 4-TEC engine. ECU is fully programmable with either RIVA supplied mapping or user adjustable parameters. Most calibrations require use 91+ octane pump fuel. Plugs directly into factory wiring harness via waterproof connectors.

Key Features Include:

- 1) Easy loading of supplied calibrations/maps for various performance applications.
 - Performance Fuel Mapping: Delivers optimal fuel required for your specific level of modification based on boost pressure.
 - Performance Timing Curves: Special racing curves produce more power throughout the RPM range.
 - Rev Limiter Increase: Stock rev limit can be increased so engine RPM can be run higher producing more boost pressure and horsepower.
 - Boost Control for turbo applications. (Plug & play connector for wastegate solenoid).
- 2) Ability to customize RIVA calibrations for special applications. Using supplied software, user can adjust parameters such as Fuel, Timing, Rev Limiter & Boost Control.
- 3) Retains all iControl functions.
- 4) Retains all OEM dash display functions & Engine Safety Functions.
- 5) Provides diagnostic information that can be displayed via computer interface.
- 6) Includes plug & play connector for RIVA Dash/Logger unit (RY11841-LD-MD60)
- 7) Includes plug & play connector for optional lambda sensor kit (part# RY11540-LC1-6S5) for data logging air/fuel ratios & tuning functions.
- 8) Direct-Connect design eliminates need for auxiliary wiring harness.
- 9) Individual Cylinder Knock Control function protects engine. System Identifies which cylinder is detonating by tracking firing order OEM knock sensor.
- 10) User selectable dual calibration capacity.

NOTE: RIVA Pro-Series ECU is for competition use only.

Description	Part No.
RIVA Athena Series ECU Sea Doo 2010 & Newer iControl Models	NEW RS11891-ECU-DC



Check Out
Video

NEW



RIVA/VI-PEC V88R PRO SERIES ECU

The RIVA/Vi-Pec V88R Pro Series ECU provides a huge performance advantage to Sea Doo iControl models delivering over 40hp to the stock 4-TEC engine. ECU is fully programmable with either RIVA supplied mapping or user defined parameters. Most calibrations require use of RIVA Fuel Pressure Regulator Kit and 91+ octane pump fuel. Plugs directly into factory wiring harness via waterproof connectors.

Key Features Include:

- 1) Easy loading of supplied calibrations/maps for various performance applications.
 - Performance Fuel Mapping
 - Performance Timing Curves
 - Rev Limiter Increase
 - Boost Control for turbo applications. (Plug & play connector for wastegate solenoid).
- 2) Ability to customize RIVA calibrations for special applications. Using supplied software, user can adjust parameters such as Fuel, Timing, Rev Limiter & Boost Control.
- 3) Retains all iControl functions.
- 4) Retains all OEM dash display functions & Engine Safety Functions.
- 5) Internal Data logging functionality.
- 6) Provides diagnostic information that can be displayed via computer interface.
- 7) Includes plug & play connector for RIVA Dash/Logger unit (RY11840-LD-MD60)
- 8) Includes plug & play connector for optional Lambda sensor kit (part# RY11540-LC1-6S5) for data logging air/fuel ratios & tuning functions.
- 9) Direct-Connect design eliminates need for auxiliary wiring harness.
- 10) Individual Cylinder Knock Control function. Identifies which cylinder is detonating by tracking firing order utilizing OEM knock sensor.
- 11) User selectable dual calibration capacity for optional Dual Map Switch (part # RY11841-DMS-ECU-PC).
- 12) Expansion Port for additional user definable inputs & outputs.
- 13) User configurable software.

NOTE: RIVA Pro-Series ECU is for competition use only.

Description	Part No.
RIVA Vi-Pec V88R ECU Sea Doo 2012 & Newer Models	NEW RS11890-ECU-DC

SEA DOO 4 STROKE	SEA DOO 4 STROKE
NAKKE SYSTEMS	NAKKE SYSTEMS
ENGINE/ GASKETS	ENGINE/ GASKETS
EXHAUST	EXHAUST
DRIVE LINE HANDLING	DRIVE LINE HANDLING
ELECTRICAL	ELECTRICAL
WATERLINE /BILGE	WATERLINE /BILGE
STEERING & CONTROLS	STEERING & CONTROLS
BODY	BODY
ACCESSORIES	ACCESSORIES
SERVICE TOOLS /HARDWARE	SERVICE TOOLS /HARDWARE
CHEMICAL	CHEMICAL



RIVA RISING RATE FUEL PRESSURE REGULATOR KIT

RIVA's Fuel Pressure Regulator Kits provide the precision pressure control necessary to compliment a variety of performance applications. Kits are fully assembled & mount securely via sturdy stainless steel bracket. High quality billet pressure regulator can adjust base pressure from 25 to 80 PSI. Unit can also be set up as rising rate fuel pressure regulator at a 1 to 1 ratio providing one additional pound of fuel pressure for every pound of boost gain. Plugs directly into original fuel system with OEM connectors and features a large 3/8" fuel return line. Includes integrated liquid-filled pressure gauge and billet Fuel Pressure Regulator Block-off necessary for removal of stock fuel pressure regulator.

Key Features Include:

- Precision fuel pressure control with optional rising rate function.
- High quality stainless steel liquid-filled pressure gauge.
- Large 3/8 fuel return line.
- Billet Fuel Pressure Regulator Block-off.
- Easy bolt-on installation with OEM fuel connectors.
- Complete installation instructions & tuning guide.

Description	Part No.
RIVA Fuel Regulator Kit - 07 & Older 215	RS12050RRFPR07
RIVA Fuel Regulator Kit 08 & Newer 215/255/260 (except i-Control)	RS12050RRFPR08

NEW



R&D RRFPR FUEL PRESSURE REGULATOR

R&D offers a custom high performance fuel pressure regulator system designed to "bolt on" to the RXP-X/RXT-X 260. The R&D Regulator Kit comes completely assembled with all fuel lines, connectors, and fittings in place and ready to install. The R&D Kit also includes the necessary "Port Plug" to easily block off the stock in tank pressure regulator, and custom "plug on" return line fitting. The R&D regulator bracket will allow the regulator to be installed under the top deck cleanly and out of the way, yet allow fuel pressure tuning access easily accessible. Base fuel pressure is adjustable from 50 to 75 PSI with high pressure spring (installed), and can also be set up as a Rising Rate System (60-75). The R&D system is very easy to install, and all hardware can be removed and easily put back to stock at any time. Fuel rail and tank return line fittings are O.E.M. push on "snap lock" fitting connectors which will make the R&D Regulator System easy and hassle free to install.

Description	Part No.
R&D RRFPR Fuel Pressure Regulator RXP-X 260 (2012-13)	NEW 803-81000
R&D RRFPR Fuel Pressure Regulator RXT-X 260/Universal for other 2008+ Sea Doo Models	803-81001

NEW

Photo Shows
613-00190 &
900-02180



R&D INLINE FUEL PRESSURE GAUGE ADAPTOR

The R&D Fuel Pressure Gauge Adaptor Tool is designed to be a plug in fuel pressure gauge that needs no modifications to install and use. The adaptor installs inline between the O.E.M. fuel rail and the R&D RRFPR via the OEM connectors for easy connect and disconnect. Simply disconnect the O.E.M. locking fuel connector from the fuel rail and plug the gauge tool directly into the connector. Plug the locking connector supplied on the R&D tool onto the fuel rail and lock. Use the tool to verify fuel pressure and fuel pump condition. Use the tool to set and verify base fuel pressure settings on the R&D Rising Rate Fuel Pressure Regulator (RRFPR). When finished, disconnect the tool and reconnect the stock fuel line. The R&D Tool works on all Sea Doo fuel systems. Installation time is only 2 minutes. Liquid filled fuel pressure gauge sold separately.

Description	Part No.
R&D Inline Fuel Pressure Gauge Adaptor	NEW 613-00190
R&D Liquid Filled Fuel Pressure Gauge	NEW 900-02180



INNOVATE LC-1 WIDEBAND AIR/FUEL RATIO KIT

Description	Part No.
Innovate LC-1 Wideband Air/Fuel Ratio Kit	900-04378



NEW

ECU Bracket
Sold Separately
RS12050-BIM-ECK



RIVA/WILSON BILLET INTAKE MANIFOLD

RIVA's billet aluminum intake manifold delivers superior performance & reliability through improved flow characteristics and bulletproof construction. Engineered by Wilson Manifolds, the leader in racing intake manifold design, this part directly replaces the original plastic manifold that is prone to fail in high boost supercharged and turbo applications. Advanced runner and plenum design complements all performance engine configurations. Improved cylinder sealing flange utilizes OEM O-ring seals. Includes high volume fuel rail providing optimized cylinder to cylinder fuel distribution for more power and reliability. Accepts universal bracket for OEM & aftermarket ECU's. CNC machined and assembled in the USA by Wilson Manifolds exclusively for RIVA Racing.

NEW



RS12050-BIM-SIB

Manifold includes fuel rail brackets designed to fit RIVA 75lb & 100lb Pro Series Injectors. Optional Fuel Rail Bracket Kit (RS12050-BIM-SIB) sold separately for use of OEM length/style injectors.

Optional Universal ECU Bracket (RS12050-BIM-EMK) sold separately.

Description	Part No.
RIVA/Wilson Billet Intake Manifold All 215/255/260 4-Tec Engines	RS12050-BIM
RIVA Universal ECU Bracket	NEW RS12050-BIM-ECK
RIVA OEM Sea Doo Fuel Injector Bracket for RS12050-BIM (Sold as Set)	NEW RS12050-BIM-SIB



RS12050-340FP-08

RS12050-340FP-07

RIVA HIGH VOLUME FUEL PUMPS

RIVA's High Volume Fuel Pump Kits feature Aeromotive's state-of-the-art 340 "Stealth" Fuel Pump. This high output pump delivers 340LPH to support modified supercharged & turbocharged engine packages. Aeromotive pumps utilize a turbine pumping mechanism that increases durability and fuel delivery. Both kits include fuse protected marine grade wiring harness with waterproof relay system to allow activation by aftermarket ECU's. Kit for '08 & newer models (shown above) features billet fuel system adapter required for installation of Aeromotive pump. Detailed installation instructions and all hardware necessary for installation supplied with each kit.

Description	Part No.
2008 & Newer Models	NEW RS12050-340FP-08
2003-2007 Models	NEW RS12050-340FP-07



RS12050-I-KIT-50



RS12090-I-KIT-100

RIVA PRO-SERIES FUEL INJECTOR KITS

Description	Part No.
100lb p/hr - All iControl Models	RS12090-I-KIT-100
50lb p/hr - 255/215 non iControl Models	RS12050-I-KIT-50
42lb p/hr - 215 non iControl Models	RS12050-I-KIT-42-1



SEA DOO POWERSHOT ADJUSTABLE FUEL TUNER

The R&D Powershot fuel injection tuner will deliver increased horsepower, acceleration, and stronger mid-range performance by delivering a higher performing air to fuel ratio (A.F.R.) to the engine. Many of today's high

performance fuel injected four stroke muscle craft have a lean A.F.R. R&D Performance has tested, documented, and analyzed the O.E.M. fuel maps on every current fuel injected four stroke watercraft, and pre-programmed and coded the new R&D Powershot fuel injection control module to safely alter the O.E.M. fuel map to a higher performing and safer A.F.R. (richer). More horsepower, greater acceleration and stronger mid-range are the result when the proper A.F.R. is achieved and is tuned for optimum performance.

The R&D Powershot is fully adjustable on the fly (with the engine running, observed and tuned while riding), and will accommodate a wide range of adjustability to properly performance tune the A.F.R. for any combination of aftermarket parts. The R&D Powershot will add horsepower, reliability, and adjustability to any electronic fuel injected two or four stroke watercraft engine.

Description	Part No.
R&D RXP/RXT 215HP Powershot Adj. Fuel Tuner	803-95002
R&D RXP-X/RXT-X 255HP Powershot Adj. Fuel Tuner	803-95003
R&D RXP-X 2012/RXT-a/S	NEW 803-95004
Powershot Adjustable Fuel Tuner	

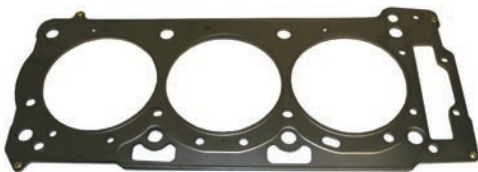

R&D HIGH PERFORMANCE HEAD GASKETS

R&D High Performance Racing Head Gaskets were developed to replace the OEM head gasket with a higher performing Multi Layer Steel Stack Design (MLS), utilizing state of the art materials proven to withstand extreme heat generated from high cylinder pressures in high boost performance packages. Each gasket is deep dual embossed (both sides) and Viton Coated to promote a positive seal. Use the R&D Head Gasket with confidence in standard replacement situations or Pro Race Engines. R&D's race proven design maintains a positive seal with up to 24 pounds of boost. Available in standard and over bore sizes.

NOTE: R&D also offers Custom R&D/CP High Performance pistons to fit any bore size R&D Head Gasket.

NOTE: Specify Bore Size when ordering.

Description	Part No.
R&D Sea Doo 4-Tec HP Head Gasket .040"/OEM Stock Thickness (Standard Bore)	080-01500
R&D Sea Doo 4-Tec HP Head Gasket .036" (-.006) Thickness / Raise Compression (Standard Bore)	080-01501
R&D Sea Doo 4-Tec HP Head Gasket .046" (+.006) Thickness / Lower Compression (Standard Bore)	080-01502



RIVA PRO-SERIES 4-STROKE CYLINDER HEAD GASKETS GASKETS

RIVA's Pro-Series Cylinder Head Gaskets were developed to withstand severe heat & pressure generated by high-boost and high horsepower applications delivering maximum reliability to your racing engine. Key Benefits Include:

- Three layer stainless construction for durability & corrosion resistance.
- Viton coated & embossed surfaces for maximum sealing.
- Unique design promotes even torque & requires no re-torque.

Description	Part No.
RIVA Sea Doo 260/255/215 Pro-Series Head Gasket (Standard Bore)	RS10050CHG1503



007-626



007-399-05

WSM SEA DOO 4-TEC COMPLETE GASKET KIT

WSM Sea Doo 4-Tec Gasket Kit includes outer oil seals and are an economical solution to OEM gasket kits.

Description	Part No.
WSM Sea Doo Complete Gasket Kit	007-626
WSM Sea Doo 4-Tec Head Gasket (Standard Bore)	007-399-05



No. 6980K	No. 6990K
4-TEC TOP KIT	4-TEC COMPLETE KIT WITH SEALS

GASKET TECHNOLOGY SEA DOO 4-TEC GASKETS & GASKET KITS

Description	OEM No	Part No.
Aluminum Washer Kit	----	6943K
4-Tec Top End Gasket Kit	----	6980K
4-Tec Complete Gasket Kit With Seals	----	6990K
Head (Standard Bore)	420950770	6900*
Valve Cover	420950820	6905*
Oil Pump Housing	420950970	6910*
Oil Separator Cover	420630540	6915*
Timing Drive Cover	420931130	6920*
Oil Seal	420650310	6956
Output Sleeve Seal	420630550	6958
Oil Pump O-Ring	420631480	6959
Intake O-Ring - 3 Required	420950740	6960
Intake O-Ring Kit	----	6961K
Seal Kit	----	6962K

** Denotes when the gasket is included in the Top End Gasket set.*



RIVA PRO-SERIES 4-STROKE CYLINDER HEAD STUD KITS

RIVA's ultra high strength cylinder head stud kit is essential equipment when upgrading internal components on your high boost Yamaha engine. Precision machined from premium grade 8740 alloy and heat treated to exacting tolerances, these studs dramatically increase reliability & ease of maintenance. Key Benefits Include:

- Superior material & heat treat process provides 10X better strength than OEM
- Studs provide improved alignment of cylinder head and gasket
- More accurate & consistent torque loading provides a more uniform clamping force on head gasket.
- Helps prevent blown head gaskets and assures optimum engine sealing.

Description	Part No.
RIVA Pro-Series Cylinder Head Stud Kits Sea Doo 260/255/215	RS10050-HSK

SEA DOO 4-STROKE • ENGINE



CP SEA DOO PISTON KITS

Description	Piston	Piston Pin	Locks	Rings
100mm standard bore (1494cc) 8.4:1	M9032	905-2250-19CP3C	905-073SWL	CPND30-3937
100mm standard bore (1494cc) 9.5:1	M9039	905-2250-19CP3C	905-073SWL	CPND30-3937
Oversize Pistons				
100.25mm +.25mm oversize (1501cc) 8.4:1	M9033	905-2250-19CP3C	905-073SWL	SWF20064-3
100.25mm +.25mm oversize (1501cc) 9.5:1	M9040	905-2250-19CP3C	905-073SWL	SWF20064-3

*Sold 3 piston kits per set.

**Piston sold complete with: rings, piston pin and locks



WISECO SEA DOO PISTON KITS 2004-2010 RXP/RXP-X/RXT/RXT-X

Features

- Dedicated forging
- Stock Compression
- Dome design
- Chrome plated piston pin
- Horizontal slot pin oiling
- Pressure seal groove
- ArmorGlide™ Skirt Coated
- Dedicated rings

Benefits

- Light weight, superior strength, optimized design
- Matches OEM compression ratio
- Improved flame travel to maximize air/fuel burn efficiency
- Reduced friction, improved scuff resistance
- Improved lubrication, better pin oiling, reduced friction
- Maximum ring seal
- Reduced friction, quieter operation, improved scuff resistance
- Optimized for each application, lightweight, high performance, better oil control

Sea Doo Model	Years	Bore Size (mm)	Piston Kit Number	Replacement Ring Set	Pins & Clips
RXP 215	2004-09	100.00	40038M10000	3937XS	Wrist Pin S626
RXP-X 255	2008-10	100.50	40038M10050	10050XS	Circlips W5860
RXT 255/260	2005-10	101.00	40038M10100	10100XS	
RXT-X 255/260	2008-10				

8.4:1 Stock Compression ratio ArmorGlide™ Skirt Coated
Piston sold complete with: rings, piston pins, and circlips

*Sold individually



JE PISTON KITS FOR SEA DOO

PISTON KIT #	DISP.	BORE SIZE	OVER SIZE	COMP. RATIO	RING #
308432	1493cc	100mm	STD	8.4:1	JG3701-3937
308433	1493cc	100mm	STD	9.5:1	JG3701-3937
308434	1493cc	100mm	STD	10.0:1	JG3701-3937
308435	1501cc	100.25mm	+.25mm	8.4:1	-----
308436	1501cc	100.25mm	+.25mm	9.5:1	-----
308437	1501cc	100.25mm	+.25mm	10.0:1	-----
308438	1508cc	100.5mm	+.5mm	8.4:1	-----
308439	1508cc	100.5mm	+.5mm	9.5:1	-----
308440	1508cc	100.5mm	+.5mm	10.0:1	-----

*Sold 3 piston kits per set.

**Piston sold complete with: rings, piston pin and locks



PRO-X OEM REPLACEMENT FOUR STROKE PISTONS

- 2004-09 RXP
- 2008-09 RXP-X 225
- 2010-12 RXP-X 255
- 2010-12 RXT-X 260 RS

Description	Part No.
Pro-X 4 Stroke Pistons Standard - 100.00mm	01.5594.000
Pro-X 4 Stroke Pistons 1st Over - 100.50mm	01.5594.050
Pro-X 4 Stroke Pistons 2nd Over - 101.00mm	01.5594.100

*PRO-X piston kits sold individually.



CARRILLO CONNECTING RODS

Description	Part No.
Carrillo Connecting Rod Set Sea Doo 255, 215 HP (Sold 3 rods per set)	RO-RXP>-8M4724S-03

SEA DOO
4 STROKE

NA/TKE
SYSTEMS

ENGINE/
GASKETS

EXHAUST

DRIVE LINE
HANDLING

ELECTRICAL

WATERLINE
/BILGE

STEERING
& CONTROLS

BODY

ACCESSORIES
SERVICE TOOLS

/HARDWARE

CHEMICAL



RIVA SEA DOO VALVE TRAIN UPGRADE KIT

RIVA's Valve Train Upgrade Kit increases the reliability of your modified engine by reducing the possibility of valve float at high rpm. Includes lightweight, precision-machined titanium valve retainers, racing valve springs, base washers and OE rocker arm shaft bolts that must be replaced during installation.

Description	Part No.
RXP/RXT/GTX Valve Train Upgrade Kit	RS19050-VTU

RIVA SEA DOO STOCK VALVE RETAINER KIT



RIVA's Valve Retainer Upgrade Kit increases the reliability of your engine by reducing the possibility of valve float at high rpm. Includes 12 lightweight, precision-machined titanium valve retainers and 6 OE rocker arm shaft bolts that must be replaced during installation. A must for IJSBA & APBA Stock Class race craft.

Description	Part No.
RIVA Stock Valve Retainer Kit SD RXP/RXT/GTX	RS19050-SRU

RIVA SEA DOO HIGH PERFORMANCE VALVE SET



RIVA High Performance Valve Kits are engineered to improve reliability and performance in high-boost supercharged & turbocharged engines. Intake valves are built from high grade EV-8 (24-4N) stainless that is extremely resistant to corrosion. Exhaust valves are built from inconel alloy (IN-751) that is

highly resistant to heat damage. Valve heads have been redesigned for increased air flow and durability. Valve stems feature hard-chrome plating for superior wear & lubricity. Kits include high strength valve locks, precision machined from 4130 chromoly.

Drop-In Valve Kits: Direct drop-in replacement valves require no machining of cylinder head.

Oversized Valve Kits: +1mm Intake & +2mm Exhaust valves deliver more air flow (requires machining of cylinder head).

Key Features:

- Stronger & lighter than stock valves.
- Redesigned valve heads for improved air flow & strength.
- High grade stainless intake valves resist corrosion.
- Inconel exhaust valves resist heat from high boost applications.
- Valve stems are hard-chrome plated for improved wear.
- Includes high strength valve locks.
- Sold in sets of 12 (6 Intake/6 Exhaust).

Description	Part No.
RIVA Sea Doo High Performance Valve Set (Standard/Drop-in)	RS19050-HPV-0
RIVA Sea Doo High Performance Valve Set (+1mm Intake / +2mm Exhaust)	RS19050-HPV-1:2



R&D HIGH PERFORMANCE TITANIUM RETAINERS

- Increased spring preload at seat and full lift
- Designed to work with stock valve springs for pro stock class racing
- Increased valve control
- 50 percent lighter than stock, much stronger
- Will work with camshaft specs up to .340 - .350 lift
- Installs using O.E.M. valve locks
- Installs on all 2005-2013 Sea Doo Rotax engines

Description	Part No.
R&D Titanium Retainer Kit Fits all SD 4-Tec Models	613-80014

R&D TITANIUM RETAINERS AND VALVE SPRINGS



- Increased spring preloads at seat and full lift
- Designed to work as a dual valve spring spec for Pro Limited class racing
- Increased valve control
- 50 percent lighter than stock, much stronger
- Will work with camshaft specs up to .400 lift
- Installs using O.E.M. valve locks
- Installs on all 2005-2013 Sea Doo Rotax engines

Description	Part No.
R&D Valve Spring Titanium Retainer Kit Fits all Sea Doo 4-Tec Models	613-80015



PRO-X SEA DOO OEM REPLACEMENT STEEL VALVES

Manufactured by the leading OEM factories in Japan. Made to exact OEM specs and tolerances. The steel valves are a direct and cost efficient OEM replacement.

Description	Part No.
Pro-X Sea Doo Exhaust Valves	28.5594-1
Pro-X Sea Doo Intake Valves	28.5594-2

*Pro-X Sea Doo Performance Valves are sold individually.

SEA DOO 4-STROKE • ENGINE

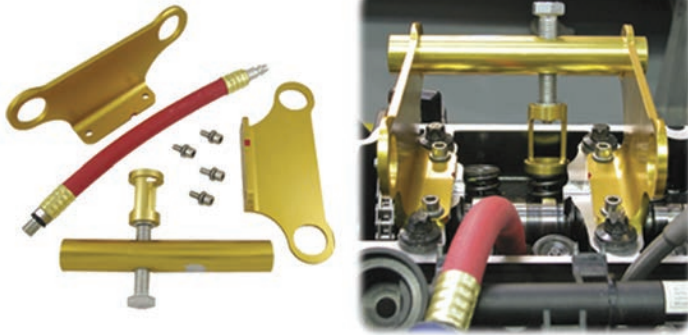

SEA DOO 4-TEC VALVE COMPRESSION TOOL

RIVA's overhead Valve Compression Tool allows easy removal of valve springs and keepers without removing cylinder head. Includes compression adapter to pressurize cylinder keeping valves in place during removal of stock springs and keepers.

Description	Part No.
RIVA 4-TEC Valve Compression Tool	RS19050-VCT



K&N REPLACEMENT AFTERMARKET OIL FILTERS

Description	OEM#	Part No.
K&N Filter - All Sea Doo 4-stroke	420950741	KN556



WSM OEM REPLACEMENT AFTERMARKET OIL FILTERS

Description	Part No.
A. WSM Filter - All Sea Doo 4-stroke	006-560
B. WSM Filter - All Sea Doo 4-stroke Oil Filter Cap	006-562



Description	Part No.
C. NGK Standard Plug for Sea Doo GTX 4-TEC (10 plugs per box)	DCPR-8E
D. NGK Iridium Spark Plugs (4 plugs per box)	DCPR8EIX
E. Nippon Denso Iridium Plug (4 plugs per box)	IXU24



MONKEY GRIP MOTOR MOUNTS

Part No. 57-1187 (Front - 1 required)	Year
Sea Doo GTI 4-TEC All Models	2006-09
Sea Doo GTX 4-TEC All Models	2002-09
Sea Doo RXP All Models	2004-09
Sea Doo RXT All Models	2005-09
Sea Doo Wake All Models	2008-09

Part No. 57-1188 (Rear - 2 required)	Year
Sea Doo GTI RFI, LE	2004
Sea Doo GTX 4-Tec	2004
Sea Doo GTI 135,155	2008-09
Sea Doo GTX 155,215	2008-09
Sea Doo RXP 155, 215, 255	2008-09
Sea Doo RXT 215, 255	2008-09
Sea Doo Wake 155, 215	2008-09

SEA DOO OEM TYPE SPECIALTY TOOLS

For the installation and removal of pistons, rocker arms, cam chain and cam gear.



Crankshaft Locking Tool
Part No. 950-125
O.E. No. 529-035-821
Fits: All 4 Tec's

Camshaft Locking tool
Part No. 950-180
O.E. No. 529-035-839
Fits: 4-Tec Engines

SEA DOO OEM TYPE SPECIALTY TOOLS

For the installation and alignment of Sea Doo engines.



Alignment Shaft
Part No. 950-140
O.E. No. 295-000-141
Fits: All Models

Alignment Adaptor
Part No. 950-150
O.E. No. 529-035-719
Fits: GTX 4-Tec Models

Alignment Support Plate kit
Part No. 950-135
O.E. No. 529-035-506
Fits: All Models

SEA DOO
4 STROKE

NAKKE
SYSTEMS

ENGINE/
GASKETS

EXHAUST

DRIVE LINE
HANDLING

ELECTRICAL

WATERLINE
/BILGE

STEERING
& CONTROLS

BODY

ACCESSORIES

SERVICE TOOLS
/HARDWARE

CHEMICAL



UMI TOP STOP BILLET STEERING

Top stop steering for positive control and extraordinary strength. Improved handling by shifting weight to correct point on watercraft.

Description	Part No.
GSX, GTX, GTI, GTS, GSI, GS 96+, RX, RXP155/215, RXP-X255, RXT215, RXT-X255 (08-11)	58-6321



NOTE: Prototype "Show Piece" shown. Production color not represented.



RXP-X 260 PRO-SERIES STEERING SYSTEM

Introducing the ultimate race proven steering system for your Sea Doo RXP-X 260. Steering shaft is constructed of aircraft grade aluminum tubing for maximum strength & rigidity. Directly replaces plastic system with a stronger unit that provides variable tilt positions. Delivers a precision feel and the confidence to push your craft to the limit with improved dependability and comfort. Bulletproof bar clamp will accept any 7/8" handlebar or 1-1/8" bulge bar. Includes all necessary installation hardware and instructions.

Key Features Include:

- Aluminum & Stainless Steel construction deliver superior strength & rigidity.
- Variable tilt adjustment.
- Accepts both 7/8" bars & 1-1/8" fat bars.
- Hollow steering shaft design accommodates OEM wiring harness.
- Billet aluminum steering arm features adjustable "quick turn" settings.
- Retains "Off Throttle Assisted Steering" system.
- Cutting-edge race styling.
- All aluminum parts anodized to prevent corrosion.



DO SPEED SPACER AND MOUNTING KIT FOR UMI RXP-X/RXT-X STEERING SYSTEMS

Do Speed has developed this spacer and mounting bracket specifically to be used in combination with a UMI steering system on a RXP-X or RXT-X. The spacer prevents water from entering the engine compartment and the bracket creates a clean and safe installation of the OEM Sea Doo warning system signal.



Description	Part No.
DO Speed Spacer and Mount Kit for UMI RXP-X and RXT-X Steering System	D-X-P



RIVA SEA DOO BILLET ICONTROL LEVERS

RIVA's billet lever set for Sea Doo iControl models provides superior control and comfort along with cutting edge styling. Directly replaces the OEM plastic parts with high quality CNC machined throttle and brake levers. Features more responsive stainless steel return spring for a precision feel. Gunmetal gray anodized coating prevents corrosion. Installs easily with included instructions.

Description	Part No.
RIVA Lever Kit, Throttle/Brake for iControl	RS24090-ICL



Description	Part No.
RXP-X 260 Pro-Series Steering System	RS20110
RXP-X 260 (T3) 2012, Black	
Sea Doo iControl Removal Tool	NEW RS24090-ICRT



SPEED MAGIC "X MOUNT" STEERING HEAD

Description	Part No.
Speed Magic Steering Head RXP-X 255, RXT-X 255	SE-027015

SEA DOO 4-STROKE • CONTROL



HOT PRODUCTS RUNABOUT HANDLEBARS

Models	Color	Pad Size	Part No.
Sea Doo GTS/GTX XP 97-98/RXP/RXT	Silver	Large	HJR-02
Sea Doo GTS/GTX XP 97-98/RXP/RXT	Black	Large	HJR-02BK

Handle Bar Specs: 30.5 width • 3" Rise • 1.5" Pull Back



HOT PRODUCTS RUNABOUT FAT BARS

Description	Color	Part No.
Hot Products Fat Runabout Bars	Silver	HJFT-01



PRE-DRILLED AND TAPPED FOR STOCK iCONTROL MOUNTS.

RIVA HANDLEBAR FOR iCONTROL SKIS

RIVA's Sea Doo iControl Handlebars are CNC constructed from lightweight aluminum and stronger than stock bars. Ends are knurled for better grip adhesion. Pre-drilled and tapped to accept stock iControl mounts. Includes bolt-on cross-bar that increases strength and impact protective foam pad. Available in 32" width in gun metal anodized finish (shown above).

To ease transfer of iControl housings we offer a special iControl Removal Tool (part # RS24090-ICRT).

Description	Part No.
RIVA RXP-X, RXT-X 255 (08-11) Bar Mount System non iControl	RS202GM-IC



RIVA RXP-X/RXT-X 255 BAR MOUNT SYSTEM

Key Features Include:

- Lowers handlebar mounting point 3-1/2".
- Superior strength & rigidity over OEM system.
- Compatible with OEM and Aftermarket Handlebars.
- Retains original tilt adjustment feature.
- Accepts both 7/8" bars & 1-1/8" fat bars.
- Integrated D.E.S.S. post mount & cable retention bracket.
- All aluminum parts anodized to prevent corrosion.
- Fits 2008-11 RXP-X & RXT-X 255HP models (non-iControl).

Description	Part No.
RIVA RXP-X, RXT-X 255 (08-11) Bar Mount System non iControl	RS20050-U



RIVA RACING BILLET FINGER THROTTLE FOR SEA DOO

Specifically designed to match throttle travel of Sea Doo 4-Stroke PWC. Direct replacement for bulky OEM throttle on X-Models and can be used with aftermarket bars on other 4-Tec applications. Adjustable throttle angle & unique trigger design keeps the trigger at the tip of your finger

throughout the throttle range for reduced arm pump & superb throttle control. Delrin bushings eliminate play common in OEM throttles and provide smooth actuation. All stainless hardware at hinge point eliminates corrosion and play. No "C" clips used. Use with OEM adapter on X-Models or use aftermarket adapter (sold separately) for RXP/RXT/RXP-X 4-Tec applications.

Description	Color	Part No.
RIVA Racing Billet Finger Throttle for SD	Silver	RS24010P
RIVA Racing Billet Finger Throttle for SD	Black	RS24010B

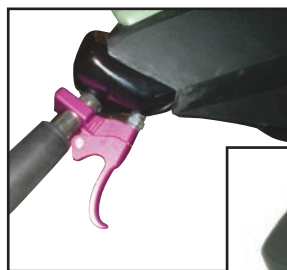

HANDLEBAR COVER CAP FOR SEA DOO 4-TEC RXP - RXT - GTX - GTI



Description	Part No.
Handlebar Cover Cap	FB001-SD



UMI RXP TRIM/SWITCH HOUSING

UMI's trim/switch housing is machined from 6061-T6 billet aluminum, replacing the stock plastic housing. Trim/switch housing uses the factory variable trim switch and start/stop switch. This housing must be used with the UMI GSX/RXP (Part # 58-6321) steering system, aftermarket bars and finger throttle.

Description	Part No.
UMI RXP Trim/Switch Housing	SD-01600-CLR



BILLET STOP SWITCH HOLDER

Description	Part No.
SD GTX, 4-TEC, RXP, RXT (One hole type)	58-2003

SEA DOO
4 STROKE

INTAKE
SYSTEMS

ENGINE/
GASKETS

EXHAUST

DRIVE LINE
HANDLING

ELECTRICAL

WATERLINE
/BILGE

STEERING
& CONTROLS

BODY

ACCESSORIES

SERVICE TOOLS
/HARDWARE

CHEMICAL



113-95001



113-95000



113-95003



113-95004



113-95006



NEW

113-95008



113-95007

R&D SEA DOO AQUAVEIN SCOOP GRATE

Description	Part No.
RXT 215, GTX 4-TEC All, GTX 951 DI (02-03)	113-95000
RXP 215,155	113-95001
GTI (06-09)	113-95003
GTX iS 255 (09), GTX Ltd. iS 260, RXT iS (10-12), RXT-X 260 (10-12), RXT RS 260 (11), RXT 260 (12)	113-95006
RXP-X 255, RXT-X 255 Aquavein Stock/Recreation	113-95004
RXP-X 255/RXT-X 255 Pro 2 Aquavein Deep Race Grate Closed Course	113-95007
RXP-X 260 (2012) (T3 Hull)	NEW 113-95008
GTR 215 (12-13), GTi SE 130 (12-13),	NEW 113-95010
GTS 130 (11-13)	<i>Available summer of 2013.</i>



R&D SEA DOO RXP AQUAVEIN GIRDLE KIT

The R&D RXP Aquavein Girdle Kit was designed and developed to add two extra 6mm bolts to the back end of either a R&D Aquavein or OEM grate for a much higher degree of security against pulling inserts out of the OEM PVC plastic pump shoe! A must for competition use!

Description	Part No.
R&D RXP Aquavein Girdle Kit	123-10010

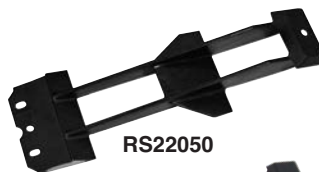

RS22050



RS22080



RS22055

RIVA TOP-LOADER INTAKE GRATES

Description	Part No.
RXP 215 (04-08)	RS22050
RXT 215 (05-08)/GTX-SC (03-04)	RS22055
RXP-X 255/RXT-X 255HP (non iControl Models)	RS22080



WR229

WORX MAXILOADER INTAKE GRATE

Description	Part No.
GTX 4Tec (02-05), GTX SC (03-04), RXT 215 (05-08) Worx Intake Grate	WR221
RXP 215 (04-08) Worx Intake Grate	WR223
RXP-X/RXT-X 255HP Worx Intake Grate	WR229
GTI (06), GTI SE	WR226
RXT iS 225 & GTX Ltd iS 255 (09), GTX 155 (10), RXT 215, Wake Pro 215, GTX 215 iS, RXT 260 iS, GTX Ltd 260 iS, RXT-X 260 RS	WR235



NEW

TBM RACING SEA DOO RXP-X/RXT-X TUNABLE SUPER SCOOP

This scoop grate will fit all year RXP-X 255 (08-11) and RXT-X 255 (08-10). This Super Scoop will give you outstanding hook up and drive through the chop with a reasonable gain in top speed. You have the option to tune the scoop for water conditions with the removable rear inlet wedge. With the wedge installed you gain the ultimate hook up and rough water handling.

Description	Part No.
TBM RXP-X/RXT-X Tunable Super Scoop	NEW TBM100-SD

SEA DOO 4-STROKE • CONTROL



RIVA SEA DOO 215/255HP 4-TEC PERFORMANCE RIDE PLATE

The RIVA Sea Doo Performance Ride Plate delivers the perfect balance of top speed and improved handling. Top speed is increased by 2-3 mph along with straight line stability. Deep channeled design provides improved traction in turns and faster lap times. This ride plate requires the use of RIVA Open Loop Cooling Kit (part# RS1013-50-1).

Key Benefits Include:

- 2-3 mph top speed increase.
- Improved straight line stability.
- Improved cornering.

Description	Part No.
RIVA SD 215/155 4-Tec Ride Plate (04-10) (non iControl)	RS21050
RIVA SD 255 4-Tec Ride Plate (08-11) (non iControl)	RS21080



RIVA SEA DOO 4-TEC OPEN LOOP COOLING KIT

RIVA Open Loop Cooling Kit dramatically reduces engine operating temperatures for improved performance & reliability. Also allows installation of RIVA Performance Ride Plate by eliminating need for heat exchanger. Original closed loop system becomes quickly heat soaked in high performance applications. Open loop system increases cooling efficiency via steady supply of cool external water.

Key Features Include:

- * Improved performance & reliability.
- * Allows installation of aftermarket rideplate.
- * Replaceable sacrificial zinc anode protects cooling system from corrosion.
- * Quick release flushing system flushes engine & exhaust cooling passages.
- * Billet aluminum pump cover with anodized finish.
- * Includes complete installation instructions.

FITS ALL SEA-DOO 4-STROKE PWC

Description	Part No.
RIVA 4-Tec Open Loop Cooling Kit	RS1013-50-1



R&D RIDE PLATE TRIM PADS

Improve the overall handling of the RXP-X 260 by adding the R&D extended Trim Pads. The extended length eliminates bow search and improves high speed stability in smooth or rough water conditions. The new Ride Plate Trim Pad design will promote smoother and quicker planning under aggressive 0-30mph acceleration, produce an overall more stable ride, offer improved cornering, and increase top speed averages. Manufactured from super strong cast aluminum and heat treated for superior strength. Kit installs in ten minutes and comes complete with all hardware and installation instructions.

Description	Part No.
R&D Ride Plate Trim Pads for RXP-X 260 (2012-13)	123-80622



ADJUSTABLE PERFORMANCE TRIM TAB KIT

RIVA's Adjustable Trim tab Kit allows you to tune the trim level of your craft for superior handling & performance in all water conditions. Tab position is adjusted with turnbuckles at rear of flap and by adjustable pivot point that

allows planing surface to retract into bracket. Fully adjustable tab system is precision machined from billet aluminum for maximum strength & durability. Directly replaces fixed plastic trim tabs with easy bolt-on installation. Includes all necessary mounting hardware & installation instructions.

Description	Part No.
RIVA Trim Tab Kit RXP-X 260 (T3) (2012)	RS27110-APT



SAND & DEBRIS FILTER .75IN

These Water Filters/Strainers protect your engine from damage due to water-borne debris such as seaweed, sand, grass and pebbles that are sucked into the cooling system. Filters mount inline with the inlet cooling hose to your watercraft's engine. Filter cup is clear to provide easy visual inspection, threaded for quick removal and seals with a durable rubber o-ring.

Description	Part No.
Sand & Debris Filter .75in	56-9004
#20 Mesh Replacement Screen	20420020
#40 Mesh Replacement Screen (#40 Mesh is finer than #20 Mesh)	20420040

SEA DOO 4 STROKE	NAI/KE SYSTEMS	ENGINE/GASKETS	EXHAUST	DRIVE LINE HANDLING	ELECTRICAL	WATERLINE /BILGE	STEERING & CONTROLS	BODY	ACCESSORIES SERVICE TOOLS /HARDWARE	CHEMICAL
------------------	----------------	----------------	---------	---------------------	------------	------------------	---------------------	------	-------------------------------------	----------

SEA DOO 4-STROKE
 INTAKE SYSTEMS
 ENGINE/GASKETS
 EXHAUST
 DRIVE LINE HANDLING
 ELECTRICAL
 WATERLINE /BILGE
 STEERING & CONTROLS
 BODY
 ACCESSORIES
 SERVICE TOOLS /HARDWARE
 CHEMICAL



EXCLUSIVE "ADJUSTABLE" STABILIZER WING

RIVA RACING RXP/RXP-X/RXT/RXT-X/GTX PRO-SERIES SPONSON KIT

Description	Part No.
A. Pro-Series Sponson Kit SD RXP/RXP-X/RXT/RXT-X/GTX (08-11)	RS26050
B. Pro-Series Sponson Kit RXP-X 260 (T3) (2012), RXT-X 260/RXT-X aS 260 (S3) (2012)	RS26110

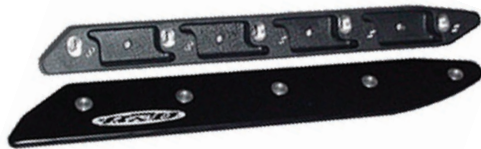

R&D RXP/RXP-X/RXT/RXT-X/GTX PRO SERIES SPONSON KIT

Description	Part No.
R&D GTX (03-04), RXP Sponson Kit	123-95100
R&D RXP-X, RXT-X, GTX (05+), GTI (06), RXP (05+) Sponson Kit	123-95101
R&D RXT iS/aS Sponson Kit	123-95110
R&D RXP-X (12-13) Sponson Kit	123-95111



WORX RACING SEA DOO SPONSONS

Description	Part No.
GTX All (02-04), RXP (04)	WR526
GTX (05+), RXP, RXT, GTI (06)	WR534
RXP-x (08), RXT-T	WR540
RXT iS 225 & GTX Ltd iS 255 (09), GTX 155 (10), RXT 215, Wake Pro 215, GTX 215 iS, RXT 260 iS, GTX Ltd 260 iS, RXT-X 260 RS	WR545



O.P.A.S. PERFORMANCE BLOCK-OFF KIT

Improves handling characteristics for competition use. Necessary to accommodate RIVA Rear Exhaust Kit (RS15050-1). Also designed to cleanly and easily cover the openings left when O.P.A.S. is removed preventing water from entering the hull. Made from billet aluminum utilizing o-ring seals. Anodized to prevent corrosion.

Description	Part No.
SD RXP/RXT/GTX (03 and newer) models	RS29050-1



RIVA PRO-SERIES OPAS BLOCK-OFF KIT

Optimizes the handling characteristics. Extensions fill voids dramatically improving handling and reducing porpoising. For competition use only.

Description	Part No.
RXP 215/RXP-X 255	RS29950
RXT 215/RXT-X 255	RS29985



R&D SEA DOO RXP/RXT 215/255 AUTO TRIM KIT

Developed to override the OEM VTS System with a fully adjustable and fully automatic trim system. The R&D Auto Trim automatically drops a rider preferred adjustable 2-8 degrees. For long straight rides install the

R&D VTS/Holeshot Driver Rod (Part #163-21503), which works in conjunction with the R&D Auto Trim to electronically override the Auto Trim back to the OEM VTS Nozzle angle trim settings! The combination allows the best for recreational and closed course riding!

Description	Part No.
R&D RXP 215 Auto Trim Kit	163-21502
R&D RXT 215/GTX 4-TEC Auto Trim Kit	163-95003
R&D RXP-X 255/RXT-X 255 Auto Trim Kit	163-25500



R&D RXP/RXT 215/255 HOLESHOT ROD

The R&D Holeshot Rod is designed to work in conjunction with the R&D Auto-Trim Kit. The

Holeshot Rod mounts to the VTS system and allows maximum nozzle drop when the nozzle is straight for improved holeshots.

Description	Part No.
R&D RXP/RXT/RXP-X 255/RXT-X 255 Holeshot Rod	163-21503



R&D RXP PRO STEERING NOZZLE

The R&D RXP 215/255 Pro Series Steering Nozzle was developed to replace the OEM steering nozzles oval and stepped inner design shape with a race proven high performance

round Venturi design. The new R&D RXP 215/255 Nozzle also incorporates a cast in boss for the R&D Auto Trim Kit Option.

Description	Part No.
R&D RXP 215/RXP-X 255/RXT 215/RXP-X 255 Pro Steering Nozzle (+15mm)	163-21500



R&D RXP-X/RXT-X 84MM REDUCTION NOZZLE KIT

The R&D RXP-X/RXT-X 84mm Pump Reduction cone will reduce the venturi size from a short O.E.M. 87mm large bore design to a plus .750

over stock venturi length with a final venturi size of 84mm. Increased hook up, stronger acceleration and mid range, improved top speed performance.

Description	Part No.
R&D RXP-X/RXT-X 84mm Reduction Nozzle Kit	173-25584



RIVA RXP/RXT PRO-SERIES REDUCTION NOZZLE

Ideal for tuning your Sea Doo pump combination for maximize performance.

The nozzle features a interchangeable ring system. Nozzle includes three stainless steel rings in 81, 82 and 83mm. Additional ring sizes available (RS23050-NR-SIZE) 80, 81.5, 82.5 and 84mm.

Description	Part No.
RIVA Venturi Nozzle w/3 Rings, RXP 215, RXP-X 255, RXT, GTX-SC (05-07)	RS23050-N

GTX 4-TEC



4-Tec doesn't have a trim system is a mystery. Extensive testing has led our development team to wedge the reduction nozzle up 2.5 degrees which will inexpensively give your 4-Tec better handling everywhere and provide a boost of 1 to 2 mph in top speed performance. The billet aluminum CNC machined 2.5 degree reduction nozzle wedge kit was designed to work with the OEM O.P.A.S. system and installs easily in 15 to 20 minutes with R&D's "easy install" directions.

Description	Part No.
R&D GTX 4-Tec SC (02-03), GTX 4-Tec N/A (03-05) 2.5 Degree Pump Wedge/Cable Extension Kit	143-95002
R&D RXP 215 2.5 Degree Pump Wedge/Cable Extender Kit	143-95003
R&D RXT 215/GTX 4-Tec (04-05) 2.5 Degree Pump Wedge/Cable Extender Kit	143-95004
R&D RXT-X 255 2.5 Degree Pump Wedge/Adjustable Trim Rod/Cable Extender Kit	143-95005
R&D RXP-X 255 1.0 Degree Pump Wedge/Adjustable Trim Rod/Cable Extender Kit	143-95006



RIVA RXP/RXP-X, RXT/RXT-X, GTX-SC BILLET PUMP WEDGE

2 Degree wedge trims up your pump nozzle raising the bow of your craft for less drag and more control.

Description	Part No.
RIVA RXP, RXP-X 255, RXT 255, RXT-X 255, GTX-SC 2-Degree Pump Wedge	RS23050



RIVA RXP/RXP-X/RXT-X VTS EXTENSION ROD

RIVA's precision-machined VTS Extension Rod allows maximum "nozzle down" adjustment after installation of RIVA Pump Wedge. Necessary on modified craft to keep bow down during initial acceleration while still providing maximum top speed advantage when trimmed up. Adjustable design comes preset for RIVA 2° Pump Wedge (part# RS23050).

Description	Part No.
RIVA RXP/RXP-X 255/RXT-X 255 VTS Extension Rod	RS23050-1-ER

SEA DOO
4 STROKE

WAKE
SYSTEMS

ENGINE/
GASKETS

EXHAUST

DRIVE LINE
HANDLING

ELECTRICAL

WATERLINE
/BLIGE

STEERING
& CONTROLS

BODY

ACCESSORIES

SERVICE TOOLS
/HARDWARE

CHEMICAL



WET WOLF PUMP CONE

The Adjust-A-Thrust has been shown to gain .5 to 1.5 more top end. Makes a noticeable difference in the low end and midrange as well.

Description	Part No.
Wet Wolf Pump Cone fits all 01-06 RXP, RXT, GTX and 4-Tec N/A and SC	SEA4
<i>*Note - This unit performs well on stock craft, and crafts with handling mods, or limited engine mods - We do not recommend this unit for modified craft.</i>	



R&D ANTI-CAVITATION CONE FOR SEA DOO

The unique patent pending design balances the bowl pressure in the last stage of the pump to eliminate detectable cavitation. Improve bottom end punch midrange pull and overall performance.

Description	Part No.
RXP 185/215, RXT 215, RXP-X 255, RXT-X 255, GTX	163-95001

SEA DOO OEM TYPE SPECIALTY TOOLS

For the repair and installation of Sea Doo 4-Tec drive shaft and the pump shaft.



Drive Shaft / Floating Ring
Part No. 950-100
O.E. No. 529-035-841
Fits: GTX 4 Tec Models



Drive Shaft / Floating Ring
Part No. 950-102
O.E. No. 529-035-987
Fits: Super Charged 4-Tecs



Drive Shaft Holder
Part No. 950-155
O.E. No. 529-035-986
Fits: GTX 4-Tec & RXP 4-Tec Models



Seal & Bearing Pusher
Part No. 950-165
O.E. No. 529-035-955
Fits: GTX 4-Tec Models



Shaft Pusher
Part No. 950-170
O.E. No. 529-035-819
Fits: GTX 4-Tec Models

NEW



R&D BILLET ADJUSTABLE ANTI-CAVITATION CONE KIT

The R&D RXP 260X Billet Adjustable Pump Cone Kit is a creative new bolt on part that adds 1 full inch of additional length over the OEM cone, and also allows an additional .400" of adjustable tuning range. The extended length allows custom rpm tuning, reduced cavitation and adds additional pump thrust. Precision tuning the pump cones length with the kit included cone spacers will add to top speed while keeping the engine rpm's stable and out of the rev limiter. Precision CNC machined from 6061 aluminum and o-ring sealed for leak free pump bearing protection. The R&D Billet Cone kit can be ordered in 3 specific cone sets that will allow an adjustment range based on horsepower output, rpm range, and prop pitch. O-ring sealed and anodized to prevent corrosion and allow years of trouble free adjustability. Call R&D for cone kit suggestions or performance recommendations for a base kit that will offer a tuning range for your application. There are many possible tuning combinations never before possible without this unique concept. For example, RPM's too high, add shims to reduce RPM's. At any time if needed, additional longer cones can be ordered to allow a wider range of tuning. The R&D Cone Kit will offer more precise prop/rpm/nozzle tuning and higher top speeds over nozzle rings guaranteed.

Description	Part No.
R&D Adjustable Cone Kit with Tuning Range for 81-83mm Nozzle (Short Cone Kit)	NEW 163-95012
R&D Adjustable Cone Kit with Tuning Range for 83-84mm Nozzle (Medium Cone Kit)	NEW 163-95013
R&D Adjustable Cone Kit with Tuning Range for 84-85mm Nozzle (Long Cone Kit)	NEW 163-95014
R&D Short Cone Parts Kit (Cone and Bolts Kit for Additional Tuning)	NEW 163-95012C
R&D Medium Cone Parts Kit (Cone and Bolts Kit for Additional Tuning)	NEW 163-95013C
R&D Long Cone Parts Kit (Cone and Bolts Kit for Additional Tuning)	NEW 163-95014C



RAD 4 RACING SEA DOO RXP THRU HULL FITTING

Replace the stock carbon seal with this RAD 4 Racing reliable bearing carrier. Includes drive shaft skim for perfect installation. For All RXP and RXP-X.

Description	Part No.
Rad 4 Racing RXP/RXP-X Thru Hull Fitting	R4RTHUHULL

SEA DOO 4-STROKE • PUMP



A.



B.

SOLAS STAINLESS STEEL REPLACEMENT WEAR RINGS FOR 4-TEC SEA DOO

Description	Part No.
A. 155mm SR Series Wear Ring	SR-HS-156-01
B. 159mm SRX Series Wear Ring	SRX-HS-159-02



RIVA STAINLESS STEEL REPLACEMENT WEAR RING FOR 4-TEC SEA DOO

RIVA's heavy-duty 100% stainless steel wear rings/impeller liners are the perfect replacement for your damaged original unit. Replaces original plastic liner with easy press in installation. Durable stainless steel resists debris damage and saltwater corrosion. Provides increased durability and performance due to precision machined clearance between wear ring and impeller.

Sea Doo PWC Application Chart:

- 155mm liner fits all 185 Supercharged and '03 and newer 155/130hp 4-Stroke models
- 159mm liner fits 255 & 215hp 4-Stroke units.

Description	Part No.
155mm SD SR Series	RS33-155-SR
159mm SD SRX Series	RS33-159-SRX



WSM REPLACEMENT PUMP WEAR RINGS FOR SEA DOO

Description	OEM#	Part No.
1998-12 including 4-Tec (N/A) (155.5mm)	271-000-653	003-503
4-Tec Supercharged 03-04 (155.8mm)	267-000-104	003-502
RXP/RXT (159mm) (exclude "iS" model)	267-000-105	003-499



WSM REPLACEMENT PUMP WEAR RINGS WITH STAINLESS STEEL LINER

Description	OEM#	Part No.
1998-12 including 4-Tec (N/A) (155.5mm)	271-000-653	003-503S
4-Tec Supercharged 03-04 (155.8mm)	267-000-104	003-502S
RXP/RXT (159mm) (exclude "iS" model)	267-000-105	003-499S

Skat-Trak^{USA} PERFORMANCE PRODUCTS

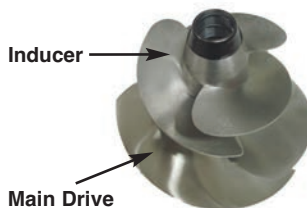

SKAT-TRAK TWIN IMPELLERS

The new Twin Prop design drives off the line much quicker than the traditional single prop, and offers substantial increase in rough water hookup.

SEA DOO RXP-X 255

	Engine Mods	Pitch	Part No.
Main Drive	Stock	13/17	SS598328SWM1317
Main Drive	Limited	13/18	SS598328SWM1318
Main Drive	Supermod	15/20	SS598328SWM1520
	Engine Mods	Pitch	Part No.
Inducer	Stock	13/17	SS440ID1317
Inducer	Limited	13/18	SS440ID1318
Inducer	Supermod	15/20	SS440ID1520

SEA DOO RXT-X 255

	Engine Mods	Pitch	Part No.
Main Drive	Stock	12/16	SS598328SWM1216
Main Drive	Limited	13/17	SS598328SWM1317
Main Drive	Supermod	15/18	SS598328SWM1518
	Engine Mods	Pitch	Part No.
Inducer	Stock	12/17	SS440ID1217
Inducer	Limited	12/17	SS440ID1217
Inducer	Supermod	15/18	SS440ID1518

AVAILABLE PARTS FOR RXP-X 260 FROM R&D

Check Report



Description	Part No.	Page No.
Cool Air Vent Plate Kit	203-00270	2
Power Plenum Air Filter Kit	203-00260	2
Pro Series 4" Air Filter Kit	203-00264	2
C15X Monster Supercharger Wheel Kit	613-94015	5
Multi-Port Adaptor Kit	613-95270	8
Straight Shot Intake Hose Kit	613-95257	9
Thermostat/Intercooler/ Engine Cooling Kit	663-15000	12
Free Flow Exhaust Kit	333-80258	13
Rising Rate Fuel Pressure Regulator Kit	803-81000	18
High Performance Titanium Retainer Kit	613-80014	22
Aquavein Intake Grate	113-95008	26
Ride Plate Trim Pad Kit	123-80622	27
Sponson Kit	123-95111	28
Billet Adjustable Anti-Cavitation Cone Kit (Short Cone)	163-95012	30

SEA DOO 4 STROKE

NAI/KE SYSTEMS

ENGINE/ GASKETS

EXHAUST

DRIVE LINE HANDLING

ELECTRICAL

WATERLINE /BILGE

STEERING & CONTROLS

BODY

ACCESSORIES

SERVICE TOOLS /HARDWARE

CHEMICAL

SEA DOO 4-STROKE • PUMP



Skat-Trak USA
PERFORMANCE PRODUCTS

SKAT TRAK IMPELLERS FOR SEA DOO PWC

3-Blade Swirl Super Pro Impeller 159-83-28

Skat Trak recommends:

Model	Year	Stock	Limited	Modified
RXT 215	05-10	13/17	13/18	-----
RXT 260	11-12	14/19	14/20	-----
RXT iS 255	09	13/18	14/19	-----
RXTaS 260	11	14/19	14/20	-----
RXTiS 260	10-12	13/18	14/19	-----
RXT-X 255	08-10	13/18	14/19	-----
RXT-X 260	11-12	14/19	14/20	-----
RXT-XaS 260	12	14/19	14/20	15/20
RXP 155	07-08	13/17.5	13/18	-----
RXP 215	04-10	13/18	14/19	-----
RXP-X 255	08-11	14/19	14/20	-----
RXP-X 260	10-12	14/19	14/20	-----

Skat Trak Impellers do not include a seal.

Hot Products recommends SLA012 sold separately.

OEM rubber shaft-impeller seal also fits.

159-83-28 3-Blade

Description	Swirl Super Pro	Part. No.
13/17	3-Blade Swirl Super Pro	SS598328SW31317
13/18	3-Blade Swirl Super Pro	SS598328SW31318
14/19	3-Blade Swirl Super Pro	SS598328SW31419
14/20	3-Blade Swirl Super Pro	SS598328SW31420
15/18	3-Blade Swirl Super Pro	SS598328SW31518
15/19	3-Blade Swirl Super Pro	SS598328SW31519
15/20	3-Blade Swirl Super Pro	SS598328SW31520
15.5/21.5	3-Blade Swirl Super Pro	SS598328SW3155215
Aluminum Billet Impeller Seal for 3-Blade Super Pro		SLA012

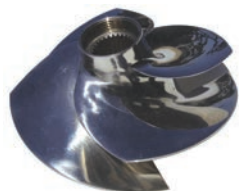

SOLAS[®]
Where speed begins

SOLAS IMPELLERS

Model	Year	Stock	Limited	Modified
RXT 215	05-08	SRX-CD-13/18	SRX-CD-14/19	SRX-CD15/20
RXT 215	09-10	SRZ-CD-13/18A	SRZ-CD-14/19A	SRZ-CD15/21A
RXTiS 260	10-12	SRZ-CD-15/21A	SRZ-CD-15/21A	-----
RXT-X 260	11-12	SRZ-CD-15/21A	SRZ-CD-15/21A	SRZ-CD-16/21A
RXP 215	04-08	SRX-CD-14/19	SRX-CD-14/19	SRX-CD15/20
RXP 215	09-10	SRZ-CD-14/19A	SRZ-CD-14/19A	SRZ-CD15/21A
RXP-X 255	08	SRX-CD-15/21	SRX-CD-15/21	-----
RXP-X 255	09-11	SRZ-CD-15/21A	SRZ-CD-15/21A	SRZ-CD-16/21A
RXP-X 260	12	SRZ-CD-15/21A	SRZ-CD-15/21A	SRZ-CD-16/21A

All SOLAS Impellers listed include an impeller seal.



RIVA R-SERIES PUMP IMPELLERS

NOTE: R-Series Impellers must be used with RIVA's Pro-Series Reduction Nozzle (Part# RS23050-N for RXP/RXP-X) or (Part# RS23051-N for RXT)

Description	Year	Part No.
13/19 R-Series	04-08	SRX-CD-13/19R
14/17 R-Series	04-08	SRX-CD-14/17R
14/19 R-Series	04-08	SRX-CD-14/19R
15/20 R-Series	04-08	SRX-CD-15/20R
15/22 R-Series	04-08	SRX-CD-15/22R
15/20 R-Series	09-12	SRZ-CD-15/20R
15/22 R-Series	09-12	SRZ-CD-15/22R

RIVA Performance Kit Pump Impellers Recommend Chart:

Model	Stock	Stage I	Stage II
RXP-X 255	N/A	SRX-CD-15/22R	TBA
RXT-X 255	N/A	SRX-CD-15/22R	TBA
RXP 215	SRX-CD-13/18R	SRX-CD-14/19R	SRX-CD-15/20R
RXT 215	SRX-CD-14/17R	SRX-CD-14/17R	SRX-CD-13/19R

All RIVA R-Series Impellers include an impeller seal.

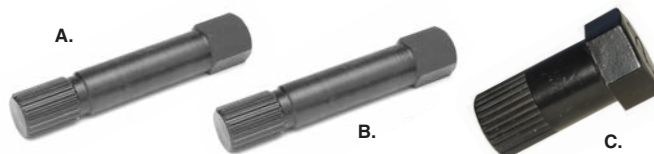

IMPELLER HOLDER TOOL

Description	Part No.
A. GTX 4-Tec Supercharged	DS#70
B. RXP/RXT 27mm	DS#71
C. Solas RXP/RXT 27mm	WR012-SRX



SOLAS BILLET IMPELLER SEAL

The new generation of the SOLAS Impeller seal is made with billet aluminum. They are very suitable for high power applications. Fits Solas Concord and Skat Trak 3-Blade Super Pro impellers.

Description	Part No.
Solas Aluminum Billet Impeller Seal	SLA012

SEA DOO 4-STROKE • SEAT COVER



JETTRIM CUSTOM ORDER SEAT COVER

Description	Part No.
RXP 215 (04-10), RXP 215 (04-10) Seat Cover	SDRXP101
RXP-X 255 (08-10) Seat Cover	SDRXPX101
RXP-X 255 (08-10) Retro Design Seat Cover	SDRXPX102
RXP-X 260 (2012) Seat Cover	SDRXPX103
RXT 215 (05-10) Seat Cover	SDRXT101
RXT-X 255 (08-10) Seat Cover	SDRXTX103
RXP-X 255 (08-10) Hump Seat Cover	SDRXPX101H
RXT-iS 255 (09), RXT iS 255 (10-12) New Design	SDRXTXIS101

PRE-COLORED HOT PRODUCTS RECOMMENDED JETTRIM SEAT COVERS

RXTiS 255 (09), RXTiS 260 (10-12)

RXT IS 101 Series



SDRXTXIS101-A

Front & Rear Top: *Medium Slip Yellow*
Front Collar: *Carbon Black LG*
Center Band: *Carbon Black LG*

Front & Rear Vest: *Smooth Grain Silver*
Side: *Carbon Black LG*



SDRXTXIS101-B

Front and Rear Top: *Non Slip Black*
Front Collar: *Carbon Black*
Center Band: *Carbon Black*

Front & Rear Backrest: *Fire Red Smooth Vinyl*
Side: *Ostrich Black Vinyl*
Stitch: *Orange Thread on Top*

RXP-X 260 (2012)

RXP 103 Series



SDRXPX103-A

Front & Rear Top: *Medium Slip Black*
Front Collar: *Carbon Black LG*
Center Band: *Carbon Black LG*

Front & Rear Vest: *Smooth Grain Silver*
Side: *Carbon Black LG*



HYDRO-TURF PREMIER CUSTOM ORDER SEAT COVER

Description	Part No.
RXP-215 (04-10) Custom Designed Seat Cover	AZ-SEW89
RXP-X (08-11) Custom Designed Seat Cover	AZ-SEW891
GTX (03-06), 4-Tec (02), Di (02), RXT, RXT-X Custom Designed Seat Cover	AZ-SEW88
RXT iS 255 (09), RXT iS 260 (11-12) Custom Designed Seat Cover	AZ-SEW882
RXP-X 260 (12) Custom Designed Seat Cover	AZ-SEW892



PRE-COLORED HOT PRODUCTS RECOMMENDED HYDRO-TURF SEAT COVERS

HT Premier custom PWC seat covers for Sea Doo RXP-X provide the best in looks and performance. Hydro-Turf adds a 3/8" layer of foam to increase comfort and durability. Check out the 3-D stitch detail. You choose the material and color for each panel on the seat. You can even choose the thread color. (shown in Black Suede, Carbon Fiber and Vinyl with Gold stitching) Each seat cover is custom made to order. There are no refunds or exchanges, so please request swatches of colors before placing your order.

SEA DOO 4 STROKE	NATKE SYSTEMS	ENGINE/ GASKETS	EXHAUST	DRIVE LINE HANDLING	ELECTRICAL	WATERLINE /BILGE	STEERING & CONTROLS	BODY	ACCESSORIES SERVICE TOOLS /HARDWARE	CHEMICAL
---------------------	------------------	--------------------	---------	------------------------	------------	---------------------	------------------------	------	---	----------