

Atlantis®

FLOATING WRIST LANYARDS



A. Wrist Color B. Lanyard Clr	Black Black	Black Neon Red	Purple Yellow	Yellow Purple	Black Silver	Blue Black	Purple Green	Green Black	Black Orange	Red White
KPTW*	A2137	A2136	A2141	A2133	A2126	-	A2131	A2149	-	A2125
Yamaha	A8147	A8146	A8151	A8143	A8136	A8139	-	-	A8156	A8155
Sea-Doo	A7467	A7466	-	-	-	-	-	-	-	-

*KPTW stands for: KAWASAKI, POLARIS, TIGERSHARK, WET JET

ULTRA VEST FLOATING LANYARDS



Description	Black	Red	Yellow	Purple	Silver	Blue	Green	White	Orange	Pink
KPTW*	A2109	A2103	A2097	A2106	A2096	A2107	A2101	A2108	A2105	A2100
Yamaha	A8130	A8123	A8133	A8128	A8134	A8129	-	A8124	A8127	A8120
Sea-Doo	A7459	A7453	A7447	-	-	A7457	-	-	-	-

*KPTW stands for: KAWASAKI, POLARIS, TIGERSHARK, WET JET

PRO FLOATING WRIST LANYARDS



Description	Black	Red	Orange	Silver
KPTW	A2109-PFW	A2103-PFW	A2105-PFW	A2096-PFW
Yamaha	A8130-PFW	A8123-PFW	A8127-PFW	A8134-PFW

*KPTW stands for: KAWASAKI, POLARIS, TIGERSHARK, WET JET

SEA-DOO DESS COMPATIBLE WRIST LANYARDS

Atlantis is proud to offer the only after market lanyards that are compatible with the Sea-Doo's DESS system. These lanyards fit all Sea-Doo watercrafts, Jet Boats, and Snowmobiles from 1996 to current (except '96 XP & GTI). Program with factory programmer.

A. Wrist Color B. Lanyard Color						
	Yellow Black	Orange White	Black Orange	Black Silver	Black White	Black Neon Yellow
Sea-Doo Dess	A7473-DSC	A7477-DSC	A7476-DSC	A7480-DSC	A7474-DSC	A7485-DSC

A. Wrist Color B. Lanyard Color						
	Black Black	Red Red	Yellow Yellow	Silver Silver	Blue Blue	Orange Orange
Sea-Doo Dess	A7459-DES	A7453-DES	A7447-DES	A7445-DES	A7457-DES	A7455-DES



PERFORMANCE LANYARDS

Atlantis has created the "Performance" lanyard from the suggestions and feedback from Pro Racers, Freestylers, and Freeriders. This lanyard features the float tube at the rear point of the lanyard next to the vest clip. This location modification keeps the area around the key almost weightless and free of any extra objects that may come in contact with water during aggressive riding which sometimes causes the key to pull out unwillingly.

Description	Part No.
KPTW*	A2103P
Yamaha	A8123P

*KPTW stands for: KAWASAKI, POLARIS, TIGERSHARK, WET JET



PRO FLOATING LANYARD WRIST BAND

Now available by itself, is our deluxe floating wristband made from marine grade webbing, neoprene, and Velcro. It attaches easily to any clip lanyard and gives the rider a sense of security he has been looking for.

Description	Black	Red	Yellow	Purple	Silver
Wristband	A2070	A2072	A2074	A2071	A2077



SHOP LANYARDS

Not legal for riding. For shop testing only. These can easily be attached to your belt while working on all PWC and jet boats.

Description	Part No.
KPTW, Yamaha, Sea-Doo	A3240
KPTW, Yamaha, Sea-Doo DESS	A3250

*KPTW stands for: KAWASAKI, POLARIS, TIGERSHARK, WET JET



CLIP ON SAFETY WHISTLE

Description	Black	Red	Yellow
Clip On Whistle	A2700C	A2701C	A2706C



JET LOGIC ULTIMATE PWC SAFETY LANYARDS

The Ultimate PWC safety lanyard has it all! 3 keys to fit ALL brands: Sea-Doo, Yamaha, Kawasaki, Polaris, Tiger Shark and Wet Jet.
*Excluding the Sea-Doo DESS System.

Description	Part No.
Yellow/Purple	UL-1
Black/Red	UL-2
Blue/Silver	UL-3



JET LOGIC SAFETY WHISTLE ON FLOATING LANYARD

An audible signal device is required on boats and personal watercraft in most states. A high pitch pealess whistle is a good choice. Clip it onto your life jacket or safety lanyard. Doubles as a floating key chain!

Description	Color	Part No.
Jet Logic Safety Whistle	Purple/Yellow	W-1
Jet Logic Safety Whistle	Red/Black	W-2



ECONOMY WRIST LANYARDS

Economy price lanyards.
ForSea-Doo (Non-DESS) only.

Description	Part No.
Sea-Doo Wrist Lanyard Purple/Green	WJ7094PU
Sea-Doo Wrist Lanyard Green/Purple	WJ7094GR
Sea-Doo Wrist Lanyard Blue/Green	WJ7094B



Clear*



Black



Silver



Tint

GOGGLE GRIP

- Aligns riders preferred goggle strap positioning on helmet
- Prevents strap from shifting or slipping off helmet
- Lift and Hold feature secures goggles under visor between rides
- Simply pinch and lift strap for easy removal
- Low-profile, concave design matches curvature of helmet
- Transparent VHB™ Peel & Stick application with alcohol prep pad

Description	Color	Part No.
Goggle Grip	Clear	70-4040
Goggle Grip	Black	70-4041
Goggle Grip	Silver	70-4042
Goggle Grip	Tint	70-4044

*Pink is back paper of adhesive. It does not show on actual products.



JETTRIBE GOGGLE DISPLAY STAND

Description	Part No.
Jettribe Goggle Display Stand	JTA11324*

*Goggles not included



JTA071301



JTA071303



JTA071304



JTA071305



JTA11301



JTA11302



JTA11303



JTA11311



JTA12301



JTA12302



JTA12303

JETTRIBE CLASSIC GOGGLES

Frame	Lens	Part No.
Red	Smoke	JTA071301
Blue	Smoke	JTA071303
Black	Amber	JTA071304
Black	Smoke	JTA071305
White	Smoke	JTA11301
Snow Camo	Smoke	JTA11302
Houndstooth	Smoke	JTA11303
Green	Smoke	JTA11311
Star Print	Smoke	JTA12301
Swirl	Smoke	JTA12302
Turquoise Print	Smoke	JTA12303



JTA11304



JTA11305



JTA12304



JTA12305

JETTRIBE EXPERT GOGGLES

Frame	Lens	Part No.
Carbon Fiber Look	Smoke	JTA11304
Gun Metal	Smoke	JTA11305
Skull Print	Smoke	JTA12304
Swirl Print	Smoke	JTA12305



JTA091301



JTA11312



JTA11313



JTA11314

JETTRIBE PRO GOGGLES

Frame	Lens	Part No.
Black Fade	Revo	JTA091301
Navy Fade	Revo	JTA11312
Red Fade	Revo	JTA11313
Green Fade	Revo	JTA11314



JTA11321



JTA11322

JETTRIBE HELMET GOGGLES

Frame	Lens	Part No.
Carbon Fiber Look	Revo	JTA11321
Clear	Revo	JTA11322

FOUR STROKE	INTAKE SYSTEMS	ENGINE/ GASKETS	EXHAUST	DRIVE LINE HANDLING	ELECTRICAL	WATERLINE /BILGE	STEERING & CONTROLS	BODY	ACCESSORIES /SERVICE TOOLS	CHEMICAL
----------------	-------------------	--------------------	---------	------------------------	------------	---------------------	------------------------	------	-------------------------------	----------



BT111

BT112

BT113

BUTTER BOMBS

Frame	Lens	Part No.
Matte Black	Smoke Polarized	BT111
Matte Tortoise	Brown Polarized	BT112
Glossy White	Smoke Polarized	BT113



NP101

NP102

NP105

NITRO BOMBS

Frame	Lens	Part No.
Matte Black	Smoke Polarized	NP101
Matte Tortoise	Brown Polarized	NP102
Glossy White	Smoke Polarized	NP105



N2111

N2112

N2113

NITRO2 BOMBS

Frame	Lens	Part No.
Matte Black	Smoke Polarized	N2111
Matte Tortoise	Brown Polarized	N2112
Glossy White	Smoke Polarized	N2113

BOMBER FLOATING EYEWEAR



GM101

GM101BM

GM102YM

GM103BM

GM111

GM112

GM113

GOMER BOMBS

Frame	Lens	Part No.
Matte Black	Smoke Polycarbonate	GM101
Matte Black	Blue Mirror Polycarbonate	GM101BM
Matte Tortoise	Yellow Mirror Polycarbonate	GM102YM
Glossy White	Blue Mirror Polycarbonate	GM103BM
Matte Black	Smoke Polarized	GM111
Matte Tortoise	Brown Polarized	GM112
Glossy White	Smoke Polarized	GM113



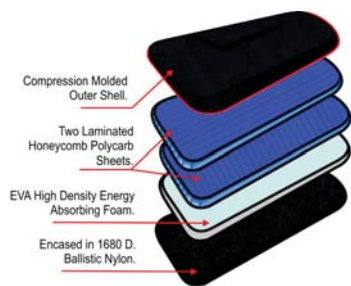

Jettribe



JETTRIBE LEG DEFLECTORS SET

- Lightweight, thanks to the neoprene and air mesh materials
- Built-in water drain holes keep water from bogging it down
- Reactive Leg Shield's front and side impact panels are made of 5 layers of energy dissipating materials
- Compression molded outer shell
- Two laminated honeycomb polycarbonate sheets
- EVA high density energy absorbing foam
- Wrapped in 1680D ballistic nylon
- Designed for sit-down riding

JETTRIBE LEG DEFLECTOR RIDING GEAR

- Injection molded polycarbonate outer shell
- Two laminated layers of neoprene and air mesh sheet
- EVA high density energy absorbing foam
- Dual 38mm "D" rings and elastic webbing
- Designed for stand-up riding

Description

Jettribe Leg Deflectors Set

Part No.

JTG11418

Description

Jettribe Leg Deflectors Riding Gear Set

Part No.

JTG11419



LEG DEFLECTOR

Made with polycarbonate.
Made in Italy



LEG DEFLECTOR

Made in England



ECONO TYPE BACK DEFLECTOR

Description

Leg Deflector

Part No.

1002RACE-02

Description

Leg Deflector

Part No.

70-4012

Description

Back Deflector
(available in Black only)

Part No.

70-4008



HYDRO-TURF BACK SUPPORT

Great for racing, recreational riding or just working around the house! Light weight. Will not absorb water. Available in Black only.

Description

Black S: 24-30
Black M: 29-36
Black L: 35-42
Black XL: 41-48

Part No.

B20-BLK-S
B20-BLK-M
B20-BLK-L
B20-BLK-XL

Jettribe



WRIST BRACE

- Ideal protection against wrist hyper extension
- Keeps wrist straight, channeling push/pull action directly to the PWC's handle bars
- Great support for riders recovering from wrist injuries
- Allows full wrist movement for thumb and throttle lever pull constructions
- Top protective layer of Rubber TPR
- Laminated with ultra high density EVA foam and air mesh for breathability

Description

Wrist Brace

Part No.

JTG11444

FOUR STROKE	INTAKE SYSTEMS	ENGINE/ GASKETS	EXHAUST	DRIVE LINE HANDLING	ELECTRICAL	WATERLINE /BILGE	STEERING & CONTROLS	BODY	ACCESSORIES	SERVICE TOOLS /HARDWARE	CHEMICAL
----------------	-------------------	--------------------	---------	------------------------	------------	---------------------	------------------------	------	-------------	----------------------------	----------



JETTRIBE G-FORCE RACE GLOVE

Size	Part No.
Small	JTG12436-S
Medium	JTG12436-M
Large	JTG12436-L
X-Large	JTG12436-XL



JTG12410-VR



JTG12410-VB



“Glove Palm”

JETTRIBE VERTIGO RACE GLOVE

Size	Color	Part No.
Small	Black/Red	JTG12410-VR-S
Medium	Black/Red	JTG12410-VR-M
Large	Black/Red	JTG12410-VR-L
X-Large	Black/Red	JTG12410-VR-XL
Small	Black/White	JTG12410-VB-S
Medium	Black/White	JTG12410-VB-M
Large	Black/White	JTG12410-VB-L
X-Large	Black/White	JTG12410-VB-XL



JETTRIBE “GECKO GRIP” RS-15 RACE BOOT

It took Jettribe two years to develop the Race Boot they are calling the Gecko Grip! A hybrid of wrestling split sole with 3 pivot points. But let's just say this might be the best boot released for the PWC rider as of yet, setting the standard for future gear.

Available in sizes: 7, 8, 9, 10, 11, 12, 13

Size	Part No.
Size 7	JTG091113-7
Size 8	JTG091113-8
Size 9	JTG091113-9
Size 10	JTG091113-10
Size 11	JTG091113-11
Size 12	JTG091113-12
Size 13	JTG091113-13

Jettribe



JETTRIBE RS-14 REC RIDER SHOE

Size	Part No.
Size 7	JTG10402-7
Size 8	JTG10402-8
Size 9	JTG10402-9
Size 10	JTG10402-10
Size 11	JTG10402-11
Size 12	JTG10402-12

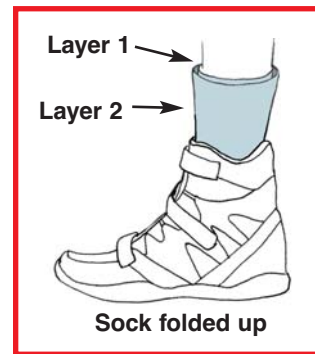
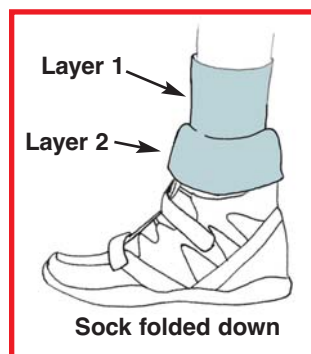

JETTRIBE LYCRA BOOT SOCKS

The Jettribe Lycra Boot Socks are built for pwc riding and are a perfect match for the Jettribe RS-15 Race Boots. With their exclusive dual layer design, the Jettribe socks are made to keep the sand and gravel out of your boot. Jettribe Lycra Boot Socks help prevent chafing and blistering.

Size	Shoe Size	Part No.
X-Small/Small	5-7	JTG10401-XS/S
Medium/Large	8-10	JTG10401-M/L
X-Large/2X-Large	11-13	JTG10401-XL/XXL

JETTRIBE MOTO TOUR JACKET

Made of extra-tough Sato 420D nylon with two coats of PU, and neoprene side panels for maximum flexibility. Mesh lining cuts down on irritation and heat loss. Also has removable zipped hoodie, adjustable vented top-center panels, and dual side neoprene pockets.



JETTRIBE MOTO TOUR JACKET BLACK

Size	Color	Part No.
Small	Black	JTG10405-S
Medium	Black	JTG10405-M
Large	Black	JTG10405-L
X-Large	Black	JTG10405-XL



JETTRIBE MOTO TOUR JACKET SKULL

Size	Part No.
Small	JTG11406-SL-S
Medium	JTG11406-SL-M
Large	JTG11406-SL-L
X-Large	JTG11406-SL-XL



JETTRIBE MOTO TOUR JACKET VERTIGO

Size	Part No.
Small	JTG11406-VB-S
Medium	JTG11406-VB-M
Large	JTG11406-VB-L
X-Large	JTG11406-VB-XL

Jettribe



JETTRIBE HEAVY DUTY HANGER

Description	Part No.
Heavy Duty Hanger	JTG10410



Hot Products is proud to announce our partnership with Pro Rider Magazine to assist in the distribution and sale of Pro Rider magazines.

Pro Rider is published 6 times per year and Hot Products has a supply of each issue available for sale at a special price and the magazines can be shipped with your Hot products parts order.

Pro Rider Watercraft Magazine tells the stories of the personal watercraft industry from a core and revolutionary "pro rider" perspective. As the sport's premier U.S. publication, Pro Rider Watercraft Magazine celebrates the unique variety of talent that continues to preserve, represent, and evolve the personal watercraft action sports experience. Whether you are a competitor, industry leader, or weekend warrior, Pro Rider Watercraft Magazine offers fresh insight and personal perspectives on what's happening in the most exciting and extreme water sport on the planet.

The personal watercraft industry is constantly redefining itself as it continues to grow and prosper. Pro Rider Watercraft Magazine establishes itself as the essential source of information and inspiration for our sport.

Description	Part No.
Pro Rider Magazine	PRORIDER

New for 2013 Pro Rider Digital Subscriptions
Receive 6 issues that you can read online or download to your tablet, smartphone, or laptop.
Visit <http://www.proridermag.com> for complete information

FOUR
STROKE

INTAKE
SYSTEMS

ENGINE/
GASKETS

EXHAUST

DRIVE LINE
HANDLING

ELECTRICAL

WATERLINE
/BILGE

STEERING
& CONTROLS

BODY

ACCESSORIES

SERVICE TOOLS
/HARDWARE

CHEMICAL



ATLANTIS ANCHOR BAG

Our newly redesigned bag anchor is strong as ever but with bright new colors, rope, float, and hook. Just fill with rocks and sand for your anchoring needs. Fits easily into any storage compartment.

Description	Part No.
Anchor Bag (regular)	A2381



ATLANTIS LARGE ANCHOR BAG

This new bag is twice as large as our standard bag. It has sewn-in handles for ease in moving and emptying. Designed for 3 & 4 passenger PWC or mini-jet boats.

Description	Part No.
Large Anchor Bag	A2394



PWC SAND ANCHOR & BUOY

A sand anchor is ideal for anchoring PWCs in shallow water to keep the impeller off the beach. Fill this super durable tri-laminate anchor bag with up to 35 pounds of rocks or sand. A buoy marks the anchor's location. Tie-ups are easy with the 6-foot long rope and the oversized finish-friendly acetyl snap hook.

Description	Part No.
Jet Logic Sand Anchor & Buoy	A-1



KWIK TEK COMPLETE FOLDING ANCHOR SYSTEM

3-1/3 Lb 4-fluke folding anchor and 25ft. long marine grade rope.

Description	Part No.
Complete Anchor System	A-2



ATLANTIS STAKE ANCHOR

Needing an easy way to keep your personal watercraft tied to a shore? Here it is, just screw the stake into the ground and you have 15' to tether your boat to shore. Easy to store and take with you.

Description	Part No.
Stake Anchor	A2384



GIANT SNAP HOOK

Perfect for attaching ski lines, dock lines, tow lines, or any rope up to 1/2 inch diameter.

Description	Part No.
Giant Snap Hook	SH-5



3" X 5" ROPE FLOAT

Need a way to mark an area? Need to float a rope for docking? Here is your answer, our easy to use rope floats. Fits up to a 1/2" diameter rope.

Description	Part No.
Red/White	A-1974
Blue/White	A-1975



KWIK TEK 20" DIAMETER BUOY

The affordable alternative! These durable 20" diameter inflatable buoys are perfect for marking anchors, moorings, hazards, swimming areas, or for setting up a personal watercraft or sailboat race course. They deflate quickly and easily for space efficient storage.

Description	Part No.
Yellow Buoy 20"	B-20Y
Red Buoy 20"	B-20R





PWC DOCK LINE

This dock line features a 10" loop on one end for securing a personal watercraft to dock cleats. The opposite end of the dock line features a strong plastic clip for easy connections or disconnection to the personal watercraft OEM hooks. The dock line total length is 7 feet. 2 dock lines per package.

Description

PWC Dock Line

Part No.

PWCP-2



BUNGEE DOCK LINES

Airhead Bungee Dock Lines absorb shock to boats, cleats, pylons and other hardware. The bungee cord is hidden inside the rope and acts as a built-in snubber. Two foam floats protect the boat from chafing. 4 feet, stretches to 5-1/2 feet.

Description

Bungee Dock Line

Part No.

AHDL-4

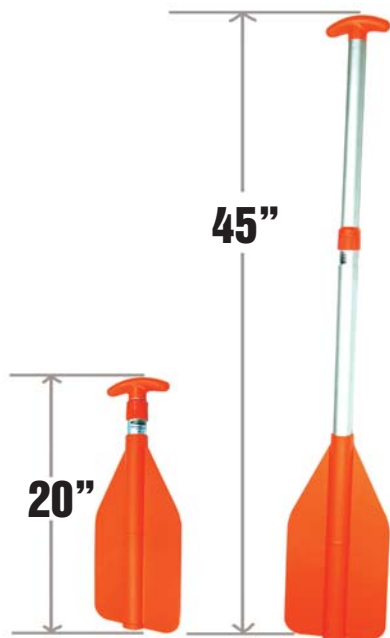

TELESCOPING PADDLES

Lightweight paddles adjust easily to variable lengths with a simple twist. A section of the aluminum shaft disappears inside the blade for the ultimate in compact storage under boat seats or in PWC storage compartments. 20-45 inch long.

Description

Telescoping Paddle

Part No.

P-1



DOC ALLEN'S VERSATOOL The Swiss Army Knife of Hand Tools!

- Lightweight • Compact
- Multi-Function • Stainless Steel
- Use in Tight Places

Description

Compact Tool Set

Part No.

VERSATOOL



HULL HUGR PWC FENDER

Docking a PWC has never been safer with the introduction of the HULL HUGR PWC Fender. Engineered specifically for PWCs, it hinges in the center to better protect PWC bodies from docks designed for bigger boats. It hooks under the rub rail with a molded acetyl hook integrated into the back of the fender. If your PWC has them, you'll want to connect the top of the fender to a cleat or ski eye with the adjustable strap and vinyl dipped steel hook provided. If not, simply thread the strap through the rubber block provided and place it inside the PWC's storage compartment, then shut it. The block anchors the fender strap perfectly and will not damage the body. We recommend 2 fenders per PWC. Fits all PWCs.

Description

Hull Huger PWC Fender

Part No.

HH-P1B



RESCUE STREAMER DISTRESS SIGNAL

Patented Design Approved for U.S. Military & Coast Guard

This bright orange Streamer, visible from 1.3 miles away at 1,500 ft. altitude, leads Search and Rescue teams right to you. The patented high-strength polyethylene Streamer design, tested and used by the U.S. Military and Coast Guard, is marked with the international distress symbol. It features sealed air-filled struts that keep *RescueStreamers*™ afloat on water and open on land to pinpoint your exact location to rescuers. *RescueStreamers*™ start at the size of a cellular phone when stored and unroll in seconds! Always ready for use anywhere—land, water and snow. Does not require chemicals, batteries or electronics to signal continuously.

Description

Rescue Streamer Distress Signal

Part No.

RSDS-01



4" x 6"

FRONT

BACK

DRY PAK CELL PHONE GPS MP3 CASE

Description

Dry Pak Case

Part No.

DP-46W

3.5" x 7.5"



DELFINO MP-IPHONE DRY CASE

Specifically Designed for the I-Phone and I-Pod and can be used with a ear piece.

Description

Delfino I-phone Dry Case

Part No.

IPWP-001



4" x 8"

DRY PAK MULTI-PURPOSE CASE

Description

Dry Pak Case

Part No.

DP-46W



5" x 8"

DRY PAK GPS/PDA GAME PLAYER

Description

GPS/PDA/Gameboy Dry Pak Case

Part No.

DP-58



9" x 12"

DRY PAK MULTI-PURPOSE CASE

Description

Dry Pak Case

Part No.

DPC-912



9" x 12"

DRY PAK TABLET CASE FOR IPAD

Listen to Music or Movies with the Included Ear Phone Jack!

Description

Dry Pak Tablet
Case for iPad

Part No.

DPT-912W



4" x 4"

DRY PAK "ALLIGATOR WALLET"

Description

Dry Pak Alligator Wallet

Part No.

DP-44



WB-1
WB-4
WB-7



WB-9



SPARK PLUG HOLDERS

Spark Plug Holder protects the electrode, maintaining the proper gap.

Description	Part No.
2 per blister pack	SPH-2
40 per countertop display	SPH-40

"DRY PAK" DRY BAGS

Versatile and durable, your gear will stay dry inside these round bottom dry bags, even in adverse conditions. Shut out water by rolling down the top a few times and snapping the side release buckles together. The yellow and blue bags are constructed of extra heavy-duty vinyl /polyester tri-laminate with RF-welded seams. It's quick and easy to find items inside the clear bags, made of durable waterproof 19 oz. vinyl with RF-welded seams.

Description	Color	Part No.
9.5" Diam. x 16"	Yellow	WB-1
11.5" Diam. x 19"	Yellow	WB-4
12.5" Diam. x 28"	Yellow	WB-7

Description	Color	Part No.
12.5" Diam. x 28"	Clear	WB-9



Made in the U.S.A



VIEWTAINER

Ideal to keep your registration papers safe & dry. They are great to carry small tools/supplies, etc.

Description	Part No.
2" x 6" Red	CC26-RED
2" x 6" Blue	CC26-BLU
2" x 6" Green	CC26-GRN
2" x 6" Orange	CC26-ONG
2" x 6" Yellow	CC26-YLW
2" x 6" Black	CC26-BLK

Description	Part No.
2.75" x 8" Blue	CC27508-BLU
2.75" x 8" Green	CC27508-GRN
2.75" x 8" Yellow	CC27508-YLW
2.75" x 8" Black	CC27508-BLK
2.75" x 8" Orange	CC27508-ONG



HYDRO-TURF DRY BOX

Keep your registration papers and small tools/supplies dry and safe. Actual product is black color only.

Description	Part No.
Dry Box 6" x 8.5"	BOX
<i>Color is Black</i>	



DRAWSTRING MESH BAG

Size 20" x 30"

Description	Part No.
Drawstring Mesh Bag	69-1003



2012 HOT PRODUCTS IJSBA
WORLD FINALS IN LAKE HAVASU CITY, ARIZONA

©2013 Hot Products. All rights reserved.



HEAVY DUTY TUBE ROPE

This heavy tournament quality 3/8" 16-strand braided tow rope is rated at 2375 lbs. tensile strength for 1 and 2 riders. 60 feet.

Description	Part No.
Deluxe Tube Rope	AHTR-60



4000LB TUBE ROPE

This heavy duty 9/16" x 60ft. tube rope is rated at over 4375 lbs. tensile strength for 3 and 4 riders.

Description	Part No.
4000lb Tube Rope	AHTR-4000



6000LB TUBE ROPE

This super strength 16 strand, 7/8 inch x 60 foot tube tow rope is rated at 6,000 pounds tensile strength! It's the strongest tube rope your money can buy, and is engineered to pull 5 or more riders.

Description	Part No.
6000 lb Tube Rope	AHTR-6000



WAKEBOARD ROPE

This wakeboard rope has a head turning 15 in. "Squid" patterned EVA grip wrapped around a floating aluminum core. The 5/16 inch, 16 strand, UV treated low stretch rope has 3 sections for wakeboarding at 45, 55 or 65 feet. Full length finger guards help create a comfortable split finger grip. A Rope Keeper is included for tangle-free storage.

Description	Part No.
Wakeboard Rope	AHWR-3



20' TOW ROPE

This 20 ft. tow rope has a heavy-duty carabiner at each end. The 12" long "soft hook" doubles as a rope wrap for neat storage. The 3/8" diameter rope is purple/yellow/red.

Description	Part No.
20' Tow-Rope	TR-20



WATER TOY TOW ROPE

This top quality 16 strand, 3/8" tow rope is 50 feet long.

Description	Part No.
Water Toy Tow Rope	WTR-50



AIRHEAD LINE WINDER

No more tangled lines with this classic styled floating line winder! It's easy to wind and neatly stow away anchor lines, mooring lines, ski ropes and tube ropes. Get a few for the garage too. Organize your extension cords, wires, clotheslines and Christmas lights once and for all. It's constructed of high impact polypropylene for extra long service. Color: Red. Ropes not included.

Description	Part No.
Airhead Rope Winder	AHLW-1

AIRHEAD® KWIK-CONNECT™

Conveniently attach and detach tube tow ropes to towables with AIRHEAD's KWIK-CONNECT. There's no need to thread 60 feet of rope through the tow strap each time you connect or disconnect a tow rope. The high impact KWIK-CONNECT has a 1 inch diameter hole to accept up to 6,000 lb. break strength tube ropes. Recommended for 1 to 4 rider towables that are not equipped with Kwik-Connects.



Description	Part No.
Kwik-Connect	AHKC-1



AIRHEAD HEAVY DUTY TOW HARNESS

This heavy duty tow harness is perfect for pulling skiers, wake boarders and up to 4 rider towables. Simply clip it onto your boat with the 5,000-pound tensile strength hooks, and attach your ski or tube rope to the heavy duty Kwik-Connect. A 6" float keeps the Kwik-Connect floating on top, away from your propeller. 12 feet long to fit larger boats and pontoons. Yellow / Red.

Description	Part No.
Airhead Tow Harness	AHTH-2



STIK-A-FLAG™ SKIER DOWN FLAG

The bright orange 420 denier nylon skier down flag is mounted to a 24" flag. PWC's with Kwik Tek's giant 3-1/4" suction cup. Required in AZ, CA, CO, ID, MO, NE, NM, OR, TX, UT & WA. Recommended everywhere for safety.

Description	Part No.
Skier Down Flag	SAF-1



IMPELLER PROTECTOR & KICK-BACK PROTECTOR

Specially designed for use on a personal watercraft, this Jet Logic protector reduces the possibility of the tow/ski rope of being sucked up inside the PWC's pump and impeller. This protector also protects PWC passengers from tow/ski rope kicking back when the rider falls.

Description	Part No.
24" long for PWC	IP-24



TRANSOM MOUNT SKI TOW HOOK

Our transom-mount ski tow is made from highly polished 304 stainless steel. A full stainless steel back plate distributes pressure evenly to prevent gel coat crazing. Tows are supplied with stainless steel nuts and star lock washers.

Description	Part No.
3/8" stock, 2-1/2" diam 4" legs, 2-1/2" transom	59-3437

AIRHEAD® 120 VOLT HI-PRESSURE AIR PUMP

You'll enjoy the performance of this 120 volt air pump. It inflates and deflates quickly and effectively. Peak pressure is 2.5 psi, plenty of pressure to get high end inflatable boats, rafts and reinforced backyard items nice and firm. You'll immediately notice how they perform better when properly inflated. A Pressure Release Valve is included to limit pressure to 1.4 psi for preventing over-inflating towables, pool toys and other vinyl and nylon covered inflatable items. The accordion-style hose locks onto the pump, eliminating annoying disconnection. Four universal valve fittings fit all popular valves and lock onto the hose. You'll love the screw-on Boston Valve adapter, an AIRHEAD exclusive. For added convenience, there's a carry handle and a 10 ft. long power cord. Draws 6.1 amps / 730 watts. Volume is 460 liters/minute.



Description	Part No.
Airhead Air Pump, 12 V	AHP-120HP

AIRHEAD® AIR PUMP, 12V

This high-volume (290 liters / minute) 12-volt portable air pump deflates towables, boats, pools, mattresses and beach toys quickly and effectively. Most pumps on the market, even those costing twice as much, don't put out this kind of air pressure and volume (9.6 cu.ft/min., .8 psi). The universal valve fittings fit all popular valves. For added convenience, the cigarette lighter plug is equipped with a 10 ft. long power cord.



Description	Part No.
Airhead Air Pump, 12 V	AHP-12H

AIRHEAD® DOUBLE ACTION PUMP

Perfect For Topping off Towables

This pump delivers a continuous stream of air on both the up and down strokes. It quickly inflates and deflates tubes, airbeds, boats, toys and other inflatables. Four universal valve fittings are included. The accordion-style hose stretches to 5 ft. long and interlocks to the pump, so that it doesn't fall off while you're pumping. Capacity is approximately 68 gallons / 60 strokes. Especially great for topping off towables, since peak pressure is 14 psi.



Description	Part No.
Airhead Double Action Pump	AHP-1

AIR DADDY™

AIR DADDY lets you get to the fun times more quickly! It allows you to inflate towables, swim toys, beach toys, inflatable boats, rafts, airbeds and sport balls with an air compressor at home or at a gas station. AIR DADDY is a universal adapter tapered to fit all valves found on inflatables, including all sizes of stem valves and Boston valves, Halkey-Roberts and Leaffield valves. The screw-on tip creates a high-pressure stream of air, perfect for workshops and garages. Soccer ball or football low on air? Stop by a gas station and use AIR DADDY's needle valve! Both the needle valve and high-pressure tip stow securely in the handle.



Description	Part No.
Air Daddy	AHAD-1

MULTI-VALVE

Inflate with Speed & Flexibility

The Airhead Multi-Valve consists of 2 Boston Valves with different thread patterns on the bottom of the Shrader Valve. One of the Boston Valves will fit your inflatable. Use the Shrader Valve to inflate quickly at a gas station or marina. Or, screw off the Shrader Valve and inflate the Boston Valve with a low pressure/high volume pump.



Description	Part No.
Multi-Valve	AHMOV-1

FOUR STROKE	INTAKE SYSTEMS	ENGINE/ GASKETS	EXHAUST	DRIVE LINE HANDLING	ELECTRICAL	WATERLINE /BILGE	STEERING & CONTROLS	BODY	ACCESSORIES	SERVICE TOOLS /HARDWARE	CHEMICAL
----------------	-------------------	--------------------	---------	------------------------	------------	---------------------	------------------------	------	-------------	----------------------------	----------

FOUR STROKE
INTAKE SYSTEMS
ENGINE/GASKETS
EXHAUST
DRIVE LINE HANDLING
ELECTRICAL
WATERLINE /BILGE
STEERING & CONTROLS
BODY
ACCESSORIES
SERVICE TOOLS /HARDWARE
CHEMICAL



PRO MODEL RESCUE SLED

US Utility Patent 5,354,222 and
other patents pending.

*Used by top watermen
and Rescue Professionals
for over 20 years!*



- Length: 63 inches (160cm) and 67 inches (170cm) with optional bumpers.
- Width: 37.50 inches +/- 0.50 inches (95.25cm +/-1.27cm)
- Thickness: 3.85 in. (10cm) at thickest point.
- Capacity: 397 lbs.(180 kg) or two adults.
- Weight: is approximately 42 lbs (19 kg) - sled dry weight, includes molded plastic hull and deck pad.

Recommended for three-seat pwcs for all types of waterborne rescue operations or recreational activities, including tow-in surfing and spear fishing. This model has been the standard for rescue operations around the world.



Tapered Tail

- The tail is tapered at 2.5 inches thick (6.75cm) so that the sled will not have too much flotation, and will sink a few inches under the water while the pwc is at idle. This feature in the Pro Model Sled allows rescue swimmers to easily place hypothermic or



unconscious victims upon the sled deck from the water level without having to lift the victim up as one would have to do with a sled that has too much buoyancy. The Pro Sled tail lifts back up on top of the water surface and planes efficiently while the PWC is moving forward.

- 8 Handgrips made from 5000lb test nylon webbing, overmolded with proprietary, flexible elastomers, very durable and resistant to the elements. Handgrips are anchored to the sled hull using 7000lb test brass mold-in inserts and stainless fasteners. Fasteners are secured from backing out using Lock-tite.

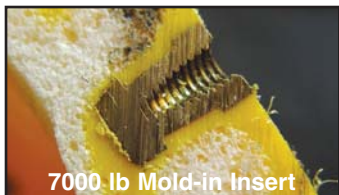

7000 lb Mold-in Insert

- Vibration Issues - The PRO Extraction Sled utilizes flexible linear low density polyethylene, flexible urethanes or EVA copolymers as bumpers at the connecting points, and a cushioning deck pad. All of these items have been used to reduce vibration caused from pwc motors. The Pro Sled, being a molded sled, transfers no more insignificant vibration than any other sled on the market.

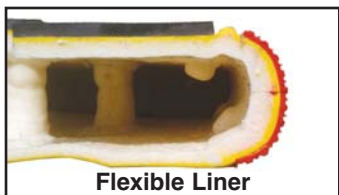

Flexible Liner

- 3/8" thick PVC Foam Deck Pad - Very Comfortable. Durable and provides the right amount of traction. Non-slippery like the polyethylene bodyboard foams or non textured PVC foams.

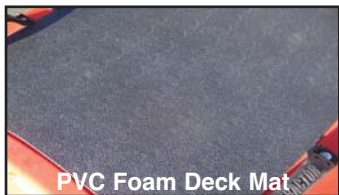

PVC Foam Deck Mat

- Basic Tie Down Version with nylon webbing/bungee cords/bumper. Utilizes universal convenient 3-point hook-up to all makes and models of pwc. The attachments are non-invasive as they are already molded into the sled as holes for rigging.

- Nylon webbing and stainless spring clips are used and attached to the center main holes in the sled for the center attachment point to the pwc, bungee cords and stainless spring clips are attached to the outboard holes for rigging.

- U-bolts to be installed on pwc hull for mounting sled to the pwc are included (all pwcs require at least one, and up to three of the U-bolts installed on all tie down sleds for a proper 3-point hookup (depending on pwc model). Nose of sled is protected by the use of a replaceable bumper.

Hand Grip Color: Black is standard. Red or Yellow are optional.

Hull Color: Orange is standard. Red, Yellow, Military Green, Battleship Grey or Black are optional.



Tie Down Version



3 Point Hookup

Description

Pro Model Rescue Sled
3 Point Tie Down Version

Part No.

XPROTD

***We do not stock inventory of these items
—special order only.***



LIFESLED FOR PWC RESCUE

Lifeguards and public safety agencies around the world are embracing an innovative rescue system that already has saved hundreds of lives, and promises to save thousands more in extreme rough water situations such as ocean storms, heavy surf, rip currents, flooding rivers and other life-threatening situations.

Non-Invasive hookup conveniently attaches LIFESLED to most any PWC without cumbersome rigging or drilling holes.

- ◆ LIFESLED is highly maneuverable. It barely affects low-speed motoring and increases the overall stability of the craft. There is no chance of windmilling or dumping of victim.
- ◆ Bullet-nose allows 45° fish-tail pivot off the PWC transom.
- ◆ 70/30 rails allow sufficient tracking for stability, and still allow the driver to 'break loose' for quick turns.
- ◆ Inexpensive, replaceable nose-guard protects the nose of the sled and the PWC transom.
- ◆ Overall size is sufficient for two adults yet still highly maneuverable. Weighs only 35 lbs.
- ◆ The Swallow-tail design enables easy victim centering when mounting in the water.
- ◆ Hook-up design allows the sled to be folded over the PWC when not in use.

Description

Lifesled

Part No.

W20018

We do not stock inventory of these items—special order only.

FOUR
STROKE

INTAKE
SYSTEMS

ENGINE/
GASKETS

EXHAUST

DRIVE LINE
HANDLING

ELECTRICAL

WATERLINE
/BILGE

STEERING
& CONTROLS

BODY

ACCESSORIES

SERVICE TOOLS
/HARDWARE

CHEMICAL



HONDA

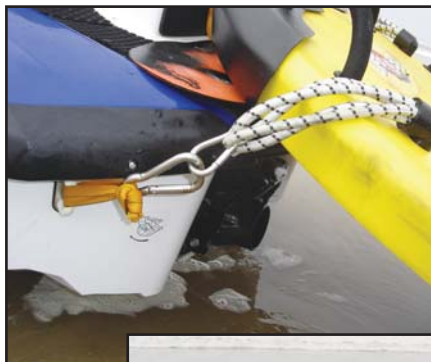

YAMAHA



SEA DOO





World Class Free Rider Taylor Curtis said:

"The Factory Zero Jet Launcher is so nice to use! It rolls across soft sand with ease, making it possible to launch by yourself. They are very well made, everything fits perfectly when assembling. It comes apart just as easy for traveling or storing. To top it off they look killer. I have had many kinds of totes over a 20 year riding career and Factory Zero tops them all! Thank you for making such an awesome product."

Photo courtesy of Mike Jones • AZHIAZIAM

FACTORY ZERO JET LAUNCHER COMPACT 2-WHEEL TOTE FOR STAND-UP PWC



Description

Factory Zero Compact 2-Wheel Tote Stand-Up

Part No.

J-130S

Due to the size of this product it is not covered by the Hot Products shipping policy.



Red indicates the items include in part #Z7007
Factory Zero Bearing Set

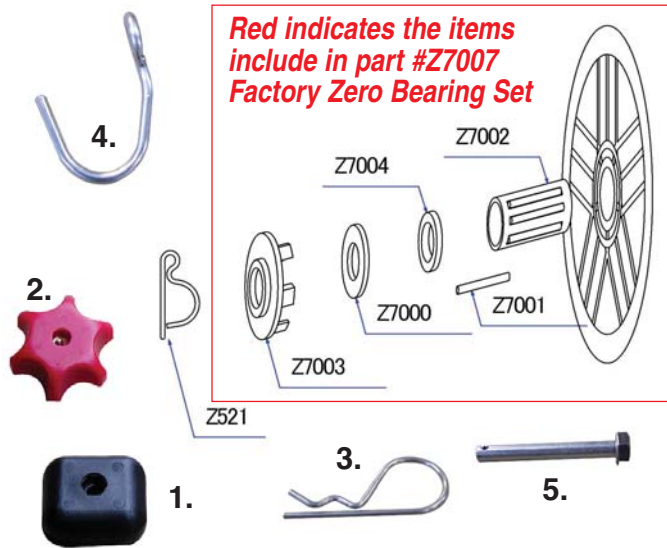

JET LAUNCHER (J-130S) REPAIR PARTS

Factory Zero offers the highest quality Jet Launchers for your Stand-up PWC and has repair/replacement parts available to allow you to utilize your Jet Launcher for many years to come.

Description

Part No.

Composite Fiber Washer	Z7000
Needle Only (10 needles)	Z7001
Bearing Cage Only	Z7002
Nylon Cap	Z7003
Nylon Washer	Z7004
"D" Ring	Z521
Bearing Complete Set	Z7007
1. Plastic Washer for Jet Launcher J-130S	Z6037
2. Plastic Knob for Jet Launcher J-130S	OS0015
3. "R" Pin For Legs of Jet Launcher J-130S	P13-130
4. Stainless Hook for Jet Launcher J-130S	JL100
5. Pin MS-55 for Legs of Jet Launcher J-130S	P17-16

FACTORY ZERO

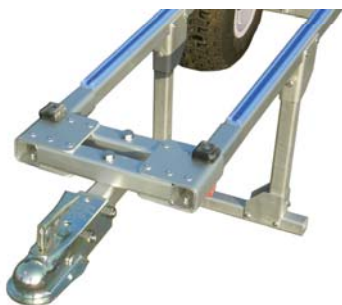

FACTORY ZERO ATV HITCH BRACKET FOR J-130S

Description

ATV Hitch Bracket for J-130S

Due to the size of this product it is not covered by the Hot Products shipping policy.

Part No.

JL258



R&D EZ-SLIDE BUNK GLIDES

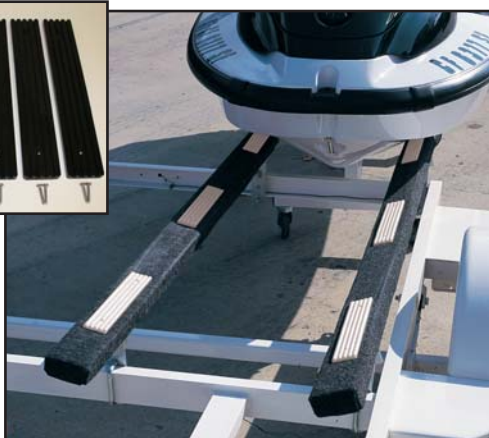

R&D EZ-Slide Bunk Glides are designed to mount directly on the top side of the trailer bunks creating a new low friction slippery surface that allows the watercraft to glide on or off the trailer, making loading and unloading a personal watercraft easy. Designed and molded from high density urethane to significantly support the hull surface for proper trailering. The EZ-Slides are black and come in a six piece set complete with stainless steel button head mounting hardware. One set needed per watercraft.

Description

EZ-Slide Bunk Glides (Set of 6)

Part No.

001-00122



RV TRAILER WIRING SOCKET ADAPTER

This adapter converts the large 7 prong RV style wiring plug to the standard universal flat 4 way trailer wiring. No cutting or splicing required.

Description

RV Trailer Wiring Adapter

Part No.

73012

FACTORY ZERO



FACTORY ZERO JET BUNK

Description

Factory Zero Jet Bunk

Due to the size of this product it is not covered by the Hot Products shipping policy.

Part No.

J-2260LSJ

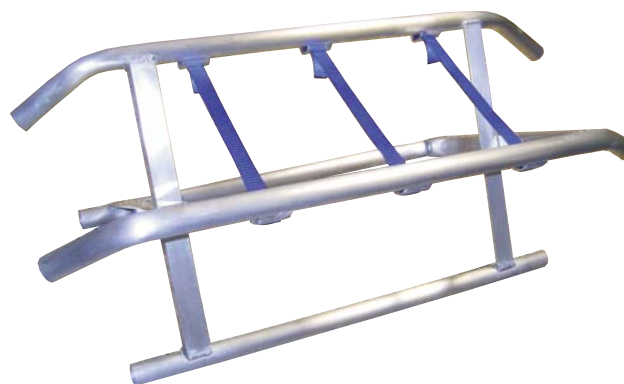

PWC BEACH STAND

Thick wall tubing and heavy gauge angle aluminum construction. Excellent durability. Not designed for use out of water.

Description

Stand-Up Personal Watercraft Beach Stand

Part No.

62-791001

Sit Down Personal Watercraft Beach Stand

62-792001

Due to the size of this product it is not covered by the Hot Products shipping policy.



RIVA DAVIT SLINGS

RIVA Davit Slings feature high strength nylon straps and stainless steel lift ring. Easily attaches to your watercraft via non-slip, non-scratch, rubber coated plates that securely lift the craft under the rub rails. Designed to use with a single davit.

Description

Lifting Sling, KAW, SD 3-seater PWC

Part No.

RS1027-IS

Lifting Sling, GTX, RXP, RXT

RS1027

Lifting Sling, 2-SEATER PWC

RY1027

Lifting Sling, SUV, XL, VNT

RY1027-20

FOUR STROKE	INTAKE SYSTEMS	ENGINE/ GASKETS	EXHAUST	DRIVE LINE HANDLING	ELECTRICAL	WATERLINE /BILGE	STEERING & CONTROLS	BODY	ACCESSORIES	SERVICE TOOLS /HARDWARE	CHEMICAL
-------------	----------------	-----------------	---------	---------------------	------------	------------------	---------------------	------	-------------	-------------------------	----------



HOOK-IT TIE DOWN MOUNT

Patented hook retainer eliminates unhooking. Provides a location to tie down your watercraft where you want it.

Description	Part No.
Hook-It Tie Down Mount	TS65



YAMAHA TIE DOWN PIN

The tie down pin can be used to which your boat on your trailer, attach a docking line, attach anchor, or tie down your Yamaha. Just drop the pin in your front or rear bow eye.

Description	Part No.
Yamaha Tie Down Pin	A8112



POWERTYE TIE DOWNS

Made from high quality 4500lb. test nylon strap with rubber coated hooks. Made in USA

Description	Part No.
Black	59-3425
Navy Blue	59-3428
Silver	59-3429



ANCRA WATERCRAFT TRAILER TIE DOWNS

Fits all PWC with 3/4" Bow Eyes.

Color	A. Double Hook Without Bow Eye Pin	B. Single Hook With Bow Eye Pin
Purple	59-3404-PPL	----
Pink	59-3404-PNK	59-3404-PNK-S
Lime Green	59-3404-GRN	59-3404-GRN-S



STOLTZ BOW STOP

For PWCs with a vertical hole. Fastens with "U" bolts. 3-1/2" Opening. Made in the USA.

Description	Part No.
PWC Bow Stop	PWC-5A



SKEEKEEPER BOW PIN

Fits any PWC trailer with a 5/8" bow coupler. Bow stop pictured is not included.

Description	Part No.
Bow Pin	TS67



SKEEKEEPER HITCH PIN

Fits any receiver-style hitch with a 2" insert. Trailer hitch receiver and ball pictured is not included.

Description	Part No.
Hitch Pin	TS68



LICENSE PLATE BRACKET

1/4" mounting holes on 2" centers.

Description	Part No.
Metal License Plate Bracket	WB-3213



HUNSAKER QUICK FILL JUGS

MADE IN THE U.S.A.

- Quick Fill jugs feature a 2 1/4" quick fill opening/fill tube
- The 1 1/2" side vent tube works as an air intake and relieves back pressure, allowing for a controlled flow rate and is adjustable for your flow rate application
- Secondary flip up vent cap for a slower pour if required
- Can be filled from the vent tube side and/or the pour side without having to take the hose off
- Smooth cornered, square style design offers stability, strength and ease of handling

Description	Part No.
A. 5 Gallon Jug (12"x12"x24")*	HUN3004-1
B. 8 Gallon Jug (12"x12"x27")*	HUN3006-1
C. 11 Gallon Jug (12"x12"x36")*	HUN3011-1
D. 1.50" Billet 6061/Aluminum Quick Fill Fueling System	HUN3113
E. 2.50" (Male) Red Head Dry Break	HUN3115
F. 2.50" (Female) Dry Break	HUN3123

*Supplied with hose and clamps for connection
Due to the size of this product it is not covered by the Hot Products shipping policy



RATIO RITE CUP & LID

The Ratio Rite measuring cup is specifically designed to help you premix gasoline for your two stroke engine. 16:1 to 70:1 mix ratios are molded into this cup, measure your two cycle oil in cc/milliliters, fluid ounces, and pints. Made from durable, long lasting plastic that is completely safe to use with fuel and oil.

*Ratio Rite lid sold separately

Description	Part No.
Ratio Rite Cup	59-0548
Ratio Rite Lid	59-0582



DELUXE SIPHON PUMP

Deluxe Siphon Pump made with a heavy duty marine grades siphon bulb and gas resistant hose. This is the easy way to get a siphon started to drain your bilge or to transfer fuel from one place to another.

Description	Part No.
Deluxe Siphon Pump	59-0440



SCEPTER FLEXIBLE FUNNEL

Scepter's flexible funnel is perfect for all your PWC uses and really helps perform those difficult maintenance and repair applications. Manufactured from quality, high density polymers: the funnel won't rust, dent, or crack. This means no drips and leaks for you to clean up after your done. The funnel length is 18".

Description	Part No.
Scepter 18" Flexible Funnel	MR03603



SAFETY SIPHON

"The Safe Solution To Fluid Transfer Problems".

A safe alternative to transferring dangerous fuels at or messy liquids by usual means. The hose with the patented self priming pump eliminates the risk of drawing hazardous or nasty fluids into your mouth when getting the siphon process started. The Safety Siphon is a great companion product to carry in your car or truck as insurance in case you run out of gasoline.

Never attempt to siphon gasoline by mouth!

Description	Part No.
Safety Siphon Pump 1/2" Hose	SS-4



2013 HOT PRODUCTS IJSBA
MARK HAHN MEMORIAL HAVASU 300

FOUR STROKE	INTAKE SYSTEMS	ENGINE/ GASKETS	EXHAUST	DRIVE LINE HANDLING	ELECTRICAL	WATERLINE /BILGE	STEERING & CONTROLS	BODY	ACCESSORIES	SERVICE TOOLS	CHEMICAL
-------------	----------------	-----------------	---------	---------------------	------------	------------------	---------------------	------	-------------	---------------	----------

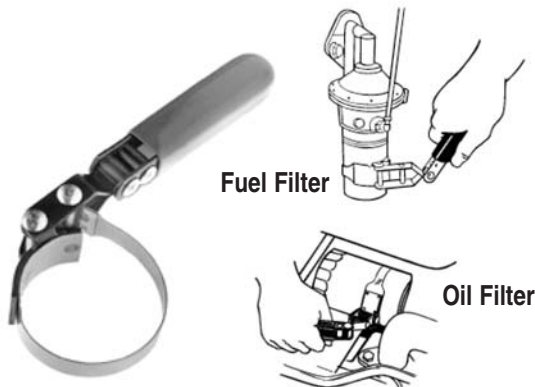

Fuel Filter

Oil Filter

"SWIVEL GRIP" OIL / FUEL FILTER WRENCH

For Smaller 2 3/8" to 2 5/8" Oil Filters. Also fits Fuel Filters.
For small oil and fuel filters. Tough stainless steel band with special "teeth" for extra gripping power...won't slip. Special narrow 1/2" band fits in tight spots. Handle swivels to clear obstructions and makes it easy to turn in hard to reach locations. Vinyl covered handle. Covers a range of 2 3/8" to 2 5/8" (60.3 - 66.7mm)

Description	Part No.
"Swivel Grip" Oil / Fuel Filter Wrench	LS54400

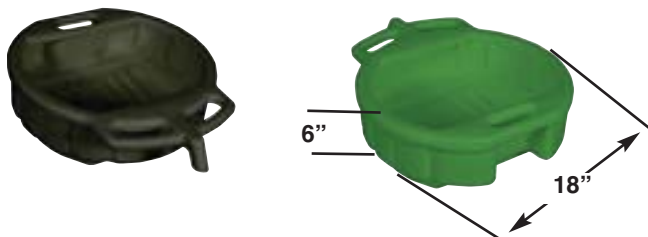

4.5 GALLON DRAIN PANS

Now with built-in-ribs for draining filters in the pan. For easy transfer of liquids. High-density polyethylene material is resistant to chemicals and solvents, and is easy to clean. 1" wide diameter spout for quick and easy pouring. The anti-splash lip and baffles help prevent spilling when carrying or pouring. Comes with large, easy-grip handles. Two colors: 17942 is black for oil and 17952 is green for anti-freeze.

Description	Color	Part No.
4.5 Gallon Oil Drain Pan	Black	LS17942
4.5 Gallon Oil Drain Pan	Green	LS17952



RULE FLAT TANK ELECTRIC OIL EXTRACTOR

Eliminate those costly yard service fees with the new quick, clean, compact electric oil extractor. Includes a 3-1/2 gallon compact self-priming diaphragm pump for extraction and an easy pour spout for oil transfer.

- 3.5 gallon (13 liter) leak proof container
- Designed for ease of carrying
- Complete with dipstick, suction tube & battery clamps
- Empties and stows easily

- Self-priming, dry running, 12 or 24 volt diaphragm pump

Description	Part No.
Electric Oil Extractor	17860-0012



HYDRO-TURF OIL EXTRACTOR

The unit uses a small vacuum system, which pumps fluid through a hose to the 6-liter reservoir. It also includes a pour spout to aid in emptying the reservoir. Pump is removable for easy storage.

Description	Part No.
Hydro-Turf Oil Extractor	OIL01



HT MOTO 15 LITER OIL EXTRACTOR

Ideal for bigger jobs and shops, this larger capacity oil/fluid extractor makes changing the oil on your 4 stroke PWC, snowmobile, ATV, boat, lawn mower, etc. clean and hassle free. Holds up to 15 liters (3.92 gal) in this sturdy portable container with built in pump.

Description	Part No.
HT Moto 15 Liter Oil Extractor	OIL03



Adapter Kit
Included!

FLUID EXTRACTOR

- Empties oil in 15 pumps or less
- Extracts warm or cold oil
- Pressure relief valve allows easy transportation and storage
- Single-hand-ease effortless operation
- Tethered cap
- Delivers gulp-free, mess-free performance
- Complete adapter kit is included featuring three extraction tubes

Description	Part No.
Fluid Extractor (6.5 Liter Fluid Extractor)	CJ-169-S
Fluid Extractor Tube Replacement Kit	72-13117A

**Note: Not for use with gasoline.*

HOT PRODUCTS DIE CUT DECALS



HOT PRODUCTS CORPORATE LOGO

Length	Color	Part No.
10.5" Length	Black	HOTPRODUCTS10.5-BLK
10.5" Length	Chrome	HOTPRODUCTS10.5-CHROME
10.5" Length	White	HOTPRODUCTS10.5-WHT
12" Length	Black	HOTPRODUCTS12-BLK
12" Length	White	HOTPRODUCTS12-WHT
16" Length	Black	HOTPRODUCTS16-BLK
16" Length	White	HOTPRODUCTS16-WHT



HOT PRODUCTS TUBE LOGO

Length	Color	Part No.
12" Length	Black	HP-TUBE-BLK-12
12" Length	Chrome	HP-TUBE-CHROME-12
12" Length	White	HP-TUBE-WHT-12
30" Length	Black	HP-TUBE-BLK-30
30" Length	Chrome	HP-TUBE-CHROME-30
30" Length	White	HP-TUBE-WHT-30

HOT PRODUCTS RACING OUTDOOR/EVENT BANNER



Hot Products Racing Banner. 10' wide by 3' tall. Outdoor vinyl with grommets to hang the Banner up. The Banner is orange with white lettering.

Description	Part No.
Hot Product Racing Banner	BANNER-ORANGE



HOT PRODUCTS RACING LOGO

Length	Color	Part No.
10.5" Length	Black	HOTRACING10.5-BLK
10.5" Length	Chrome	HOTRACING10.5-CHROME
10.5" Length	White	HOTRACING10.5-WHT
16" Length	Black	HOTRACING16-BLK
16" Length	White	HOTRACING16-WHT



HOT PRODUCTS DECAL SHEET

This sheet of Hot Products Decals has a total of 16 die cut stickers ready to peel off and install on your PWC.

Description	Part No.
Hot Products Decal Sheet 8" x 12 1/2"	70-9148



HOT PRODUCTS RACING IRON ON TRANSFER

Hot Products Racing Iron on logo. Create your own custom apparel with this easy to use iron on logo. Available in white and the logo is 7 1/2" wide by 2" tall.

Description	Part No.
Iron On Transfer	LOGO-TRANSFER



FOUR
STROKE
INTAKE
SYSTEMS
ENGINE/
GASKETS
EXHAUST
DRIVE LINE
HANDLING
ELECTRICAL
WATERLINE
/BILGE
STEERING
& CONTROLS
BODY
ACCESSORIES
SERVICE TOOLS
/HARDWARE
CHEMICAL



TAYLOR CURTIS T-SHIRT



EAGLE HP T-SHIRT

Description	Part No.
Taylor Curtis T-Shirt Small	70-8001-S
Taylor Curtis T-Shirt Medium	70-8001-M
Taylor Curtis T-Shirt Large	70-8001-L
Taylor Curtis T-Shirt X-Large	70-8001-XL

Description	Part No.
Eagle HP T-Shirt Small	70-8005-S
Eagle HP T-Shirt Medium	70-8005-M
Eagle HP T-Shirt Large	70-8005-L
Eagle HP T-Shirt X-Large	70-8005-XL

DVD



2004 LENZI DVD
70-0020



2006 WORLD FINALS
WFDVD2006



THE ADDICTION
70-0030



TWANGULATION DVD
70-0022

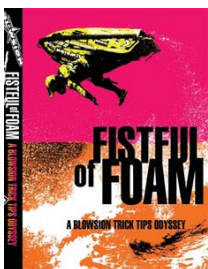

FISTFUL OF FOAM
BLOWSON TRICK
TIPS ODYSSEY
07-02-267



WORLD FINALS 2007
WFDVD2007



2008 LONG BEACH TO CATALINA DVD
OFFSH002

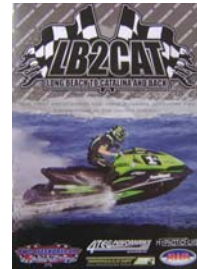

2009 LONG BEACH TO CATALINA DVD
LB2CAT009

SUPERJET FACTORY DECAL KIT

Description	Part No.
A. Star SuperJet Factory	STAR-RED
	STAR-BLUE
	STAR-GREEN
B. Stripe SuperJet Factory	STRIPE-RED
	STRIPE-BLUE
	STRIPE-GREEN
C. Logo SuperJet Factory	LOGO-RED
	LOGO-BLUE
	LOGO-GREEN

