

WSM REPLACEMENT STEERING CABLES



MODEL	YEAR	OE NO.	PART NO.
SEA-DOO			
580 GT	90-91	277-000-152	002-045
580 GTS	92	277-000-152	002-045
580 GTS	93	277-000-229	002-045
580 GTS	94	277-000-261	002-045-01
580 GTS	95-96	271-000-436	002-045-02
580 GTX	92	277-000-152	002-045
580 GTX	93	277-000-229	002-045
580 SP	92	277-000-151	002-045-06
580 SP	89-91	277-000-228	002-046
580 SP	94-96	277-000-289	002-048-01
580 SPI	93	277-000-228	002-046
580 SPI	94-96	277-000-289	002-048-01
580 SPX	93	277-000-228	002-046
580 XP	91	277-000-228	002-046
580 XP	92	277-000-151	002-045-06
650 GTX	94	277-000-261	002-045-01
650 GTX	95	271-000-436	002-045-02
650 SPX	94-95	277-000-289	002-048-01
650 XP	93	277-000-267	002-048-02
650 XP	94	277-000-289	002-048-01
650 XPI	94	277-000-289	002-048-01
720 GS	97-01	271-000-436	002-045-02
720 GSI	97	271-000-436	002-045-02
720 GTI	96	271-000-436	002-045-02
720 GTI	97-00	277-000-526	002-048-06
720 GTI	01-04	277-001-010	002-045-08
720 GTI LE	02-04	277-001-010	002-045-08
720 GTS	97-00	271-000-436	002-045-02
720 GTS	2001	277-001-010	002-045-08
720 SP	97	277-000-289	002-048-01
720 SPX	96-97	277-000-289	002-048-01
720 XP	95	277-000-467	002-048-03
800 GSX	96-97	271-000-436	002-045-02
800 GSX RFI	99	271-000-841	002-046-02
800 GSX RFI	2000	277-000-841	002-046-02
800 GTI RFI	2004	277-001-010	002-045-08
800 GTI LE RFI	03-04	277-001-010	002-045-08
800 GTX	96-97	277-000-526	002-045-06
800 GTX RFI	98	277-000-769	N/A
800 GTX RFI	99-00	277-000-842	002-046-03
800 GTX RFI	01-02	277-001-009	N/A
800 SPX	98-99	277-000-289	002-048-01
951 GSX LTD	98	271-000-436	002-045-02
951GSX LTD	99	271-000-841	N/A
951 GTX LTD	98	277-000-526	002-045-06
951 GTX	2000	277-000-843	002-046-04
951 GTX	01-02	277-001-010	002-045-08
951 GTX DI	2000	277-000-842	002-046-03
951 GTX DI	02-03	277-000-949	002-046-05
951 GTX DI	2001	277-001-009	N/A
951 GTX LTD	99	277-000-843	002-046-04
951 RX	01-02	277-001-011	002-045-05
951 RX	2000	277-001-841	002-046-02
951 RX DI	2000	277-000-841	002-046-02
951 RX DI	01-03	277-001-011	002-045-05
951 RX X	2001	289-100-070	N/A
951 XP	2000	277-000-889	N/A
951 XP	01-02	277-001-008	002-045-04
951 XP DI	03-04	277-001-008	002-045-04
951 XP LTD	98-99	277-000-773	002-046-01
4-TEC GTX	02-04	277-000-949	002-046-05
4-TEC GTX LTD SC	03-04	277-000-949	002-046-05
4-TEC GTX SC	03-04	277-000-949	002-046-05
4-TEC GTX WAKE BOARD	03-04	277-000-949	002-046-05

KAWASAKI

300 SX	86-88	59406-3001	002-069
400 SX	76-79	59406-3001	002-069
440 SX	77-92	59406-3001	002-069
550 SX	82-95	59406-3001	002-069
650 SC	91-95	59406-3724	002-074-03
650 SX	87-90	59406-3705	002-074
650 SX	91-93	59406-3720	002-043
650 TS	89-96	59406-3714	002-040
650 X2	88-95	59406-3711	002-074-01

MODEL YEAR OE NO. PART NO.

KAWASAKI CONTINUED...

650 X2	88-95	59406-3712	002-073
650 X2	86-87	59406-3723	002-070
750 SS	92-97	59406-3728	002-044-01
750 SSXI	93-97	59406-3732	002-044
750 ST	94-95	59406-3729	N/A
750 STS	95-97	59406-3736	002-042-01
750 STX	98	59406-3736	002-042-01
750 SX	92-95	59406-3726	002-041
750 SXI	95-96	59406-3726	002-041
750 SXI PRO	98-02	59406-3726	002-041
750 XI	98-99	59406-3728	002-044-01
750 XIR	94	59406-3738	N/A
750 ZXI	95	59406-3746	002-042-02
800 SX-R	03-06	59406-3776	N/A
900 STS	01-02	59406-3748	002-042-03
900 STX	97-98	59406-3736	002-042-01
900 STX	99-02	59406-3748	002-042-03
900 STX	03-06	59406-3778	002-040-02
900 ZXI	95	59406-3746	002-042-02
1100 STX	97-99	59406-3748	002-042-03
1100 STX D.I.	00-02	59406-3748	002-042-03
1100 STX D.I.	2003	59406-3778	002-040-02
1100 ULTRA 130	01-04	59406-3771	002-042-04
1100 ZXI	96-03	59406-3757	002-040-01
1200 STX	03-04	59406-3778	002-040-02
1200 STX-F	05-06	59406-3778	002-040-02
1200 STX-R	02-03	59406-3748	002-042-03
1200 STX-R	04-05	59406-3778	002-040-02
1200 ULTRA 150	99-05	594063-3771	002-042-04
1500 STX-F	04-06	59406-3778	002-040-02

YAMAHA

500 LX	93	EU0-U1481-00	002-051
500 WAVE JAMMER	89-90	EW3-61481-02	002-050
500 WAVE RUNNER	89, 92-93	EU0-U1481-00	002-051
650 SUPER JET	90-93	EW2-61481-00	002-059
650 WAVE RUNNER III	90-96	FJ0-61481-00	002-049
650 WAVE RUNNER VXR	91-95	FN8-U1481-00	002-042
701 FX	94-95	FX1-61481-00	N/A
701 RAIDER	94	GH1-61481-02	002-059-01
701 RAIDER	95-97	GH6-U1481-00	002-051-04
701 SUPER JET	94	EW2-61481-00	002-059
701 SUPER JET	95	EW2-U1481-00	N/A
701 SUPER JET	96-04	GM6-61481-00	002-059-03
701 VXR PRO	93-94	FN8-U1481-00	002-042
701 WAVE VENTURE	98	GP3-61480-00	N/A
701 WAVEBLASTER	93-96	GA7-61481-00	002-058
701 WAVE RUNNER III	97	FJ0-61481-00	002-049
701 WV	95-96	GJ3-U1481-00	002-059-02
701 XL	99-01	GU2-U1481-10	002-059-05
760 GP	99-00	GP7-U1481-00	002-051-05
760 RAIDER	96	GH6-U1481-00	002-051-04
760 WAVEBLASTER	96	GK5-61480-00	N/A
760 WAVE RUNNER	97-98	GP7-U1481-00	002-051-05
760 WAVE VENTURE	97	GP3-61480-00	N/A
760 XL	99	GU2-U1481-01	002-059-05
800 GP	98-00	GP7-U1481-00	002-051-05
800 GP	01-02	F0X-U1481-00	002-051-02
800 GP	2003	F0X-U1481-10	002-051-02
800 GP	2004	F0W-61481-01	N/A
800 XA	2004	F0D-U1481-10	002-051-01
800 XL	02-04	F0D-U1481-10	002-051-01
1000 FX/HIGH OUTPUT	2004	F1B-61481-02	N/A
1100 RAIDER	95-96	GJ1-U1481-00	002-058-01
1100 WAVE VENTURE	96-97	GH3-61480-00	002-051-03
1200 GP	97-99	GP8-U1481-00	002-059-04
1200 GP	00-02	F0X-U1481-00	002-051-02
1200 XA	2004	F0D-U1481-10	002-051-01
1200 XL	98	GU2-U1481-10	002-059-05
1200 XLT	03-04	F0D-U1481-10	002-051-01
1300 GP R	2004	F1G-61481-02	N/A
1400 FX	02-03	F1B-61481-01	N/A

FOUR STROKE	INTAKE SYSTEMS	ENGINE/ GASKETS	EXHAUST	DRIVE LINE HANDLING	ELECTRICAL	WATERLINE /BILGE	STEERING & CONTROLS	BODY	ACCESSORIES	SERVICE TOOLS /HARDWARE	CHEMICAL
-------------	----------------	-----------------	---------	---------------------	------------	------------------	---------------------	------	-------------	-------------------------	----------

Hot Products

FOUR
STROKE

INTAKE
SYSTEMS

ENGINE/
GASKETS

EXHAUST

DRIVE LINE
HANDLING

ELECTRICAL

WATERLINE
/BILGE

STEERING
& CONTROLS

BODY

ACCESSORIES

SERVICE TOOLS
/HARDWARE

CHEMICAL

- High grade aluminum, which Hot Products has extensively tested for the manufacturing of these handlebars.
- Lightweight, super-strength, durable and excellent vibration dampening for freestyle and rough surf riders.
- The handlebar surface has been shot peened to help assist in preventing fatigue or failure.

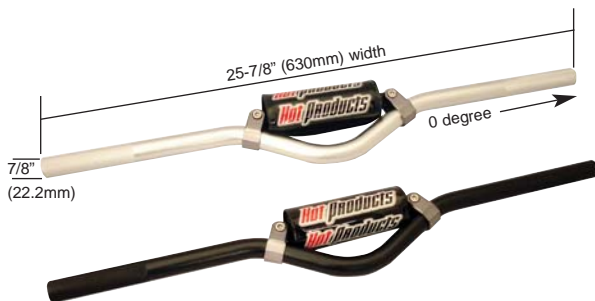

Stand-Up Performance Handlebars	Color	Part No.
Yamaha/Kawasaki Zero degree	Silver	HJF-00
Yamaha/Kawasaki Zero degree	Black	HJF-00BK

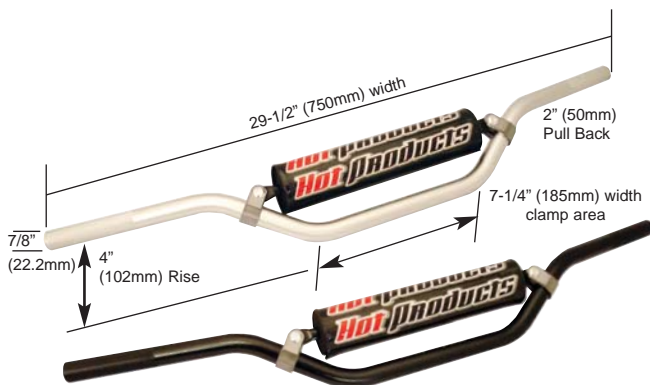

Runabout (750mm Width)	Color	Part No.
Runabout Handlebars	Silver	HJR-01
Runabout Handlebars	Black	HJR-01BK



UNIVERSAL FAT BAR ADAPTERS

Hot Products has designed these billet adapters to be compatible with UMI steering and other manufacturing steering systems and allows for use of "Fat Bars" for that added strength and clamping pressure needed for today's high performance applications. Both the one piece kit and two piece set come laser etched with the Hot Products logo.

Description	Part No.
One Piece Billet Adapter Kit	HJCL-01
Two Piece Billet Adapter Set	HJCL-02

- Knurling – Grip end only – increases bonding between the handlebars and the grips.
- Anodized finish forms an integral coating giving protection against corrosion.
- A Hot Products crossbar pad is included with every handlebar.

• All Hot Products Handlebars feature scale lines for easy installation and alignment to each riders specifications.

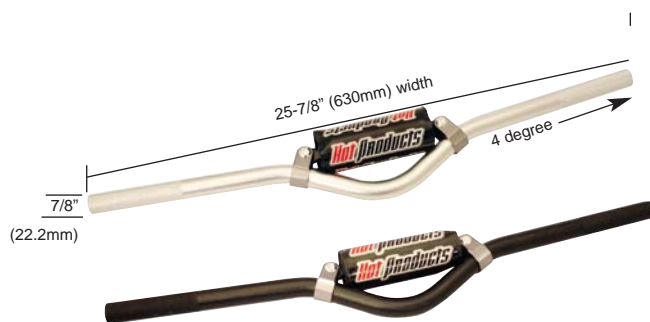

Stand-Up Performance Handlebars	Color	Part No.
Yamaha/Kawasaki 4 degree	Silver	HJF-04
Yamaha/Kawasaki 4 degree	Black	HJF-04BK

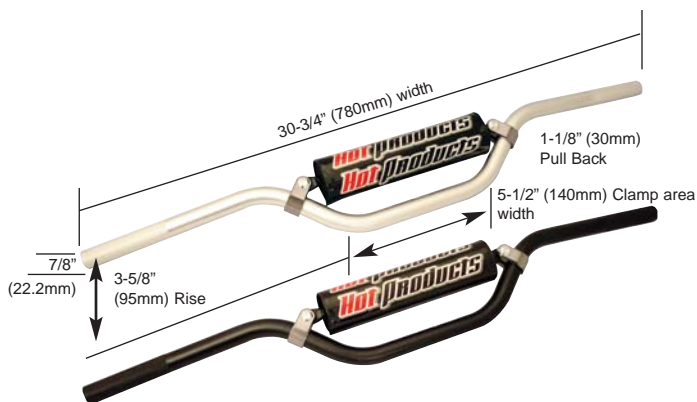

Runabout (780mm Width)	Color	Part No.
Runabout Handlebars	Silver	HJR-02
Runabout Handlebars	Black	HJR-02BK

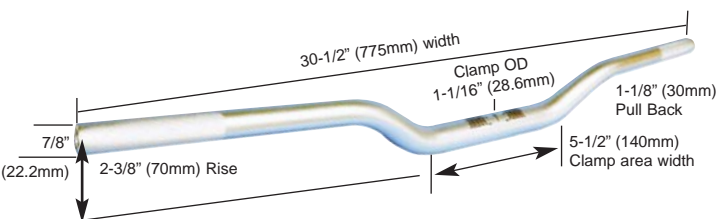

HOT PRODUCTS RUNABOUT FAT BARS

Runabout Fat Bars	Color	Part No.
Hot Products Fat Runabout Bars	Silver	HJFT-01



PRE-DRILLED AND TAPPED FOR STOCK iCONTROL MOUNTS.

RIVA HANDLEBAR FOR iCONTROL SKIS

See page 27 for information and details.

Description	Part No.
RIVA RXP-X, RXT-X 255 (08-11)	RS202B-IC
Bar Mount System non iControl	



MOTOINE ADJUSTABLE HANDLEBAR

Utilizing handlebar clamp holes, this Motorcycle Road Racing type handlebar allows you to adjust the handlebar position from -4 degrees to +16 degrees.

Kawasaki	Part No.
Adjustable Handlebar for 800SXR	MR-SXR-012

BLWISION KOMMAND HANDLEBARS



Stand-Up Handlebars	Color	Part No.
0-Degree W/Crossbar & Pad- Extended	Clear	03-05-141
0-Degree W/Crossbar & Pad- Extended	Black	03-05-142



Stand-Up Handlebars	Color	Part No.
4-Degree W/Crossbar & Pad- Extended	Clear	03-05-143
4-Degree W/Crossbar & Pad- Extended	Black	03-05-144

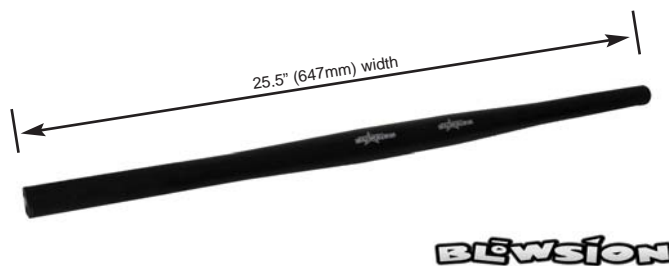

Stand-Up Handlebars	Width	Color	Part No.
Fat-Bar Straight	25.5"	Black	03-05-145



Stand-Up Handlebars	Width	Color	Part No.
Fat V Bar Riser	25.5"	Black	03-05-146



Sit-Down Handlebars	Width	Color	Part No.
Blaster/Sports Handlebars	28"	Black	03-05-150



Sit-Down Handlebars	Width	Color	Part No.
Runabout Handlebars	32"	Black	03-05-152
Runabout Handlebars	32"	Clear	03-05-153

FOUR STROKE	INTAKE SYSTEMS	ENGINE/ GASKETS	EXHAUST	DRIVE LINE HANDLING	ELECTRICAL	WATERLINE /BILGE	STEERING & CONTROLS	BODY	ACCESSORIES	SERVICE TOOLS /HARDWARE	CHEMICAL
-------------	----------------	-----------------	---------	---------------------	------------	------------------	---------------------	------	-------------	-------------------------	----------



Mounting System

UMI RACING SEALED BEARING POWER TURN PLATE STEERING SYSTEM

Description	Part No.
SuperJet/Kawasaki 800SXR* Mounting System	JS-04103
<i>This Steering System does not fit on a Kawasaki OEM Handlepole.</i>	

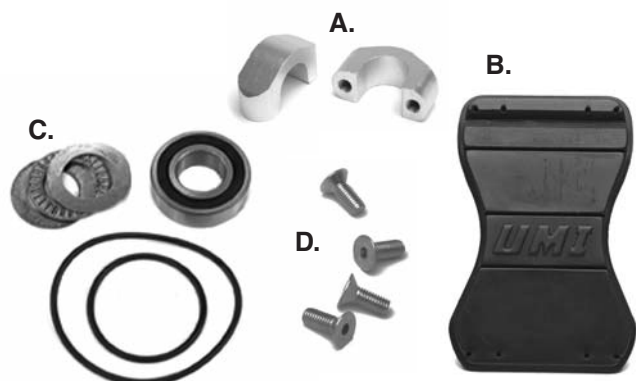

Replacement Bearing Kit

SJ 96+ Handlebar Pad Cover

Description	Part No.
A. Set of Clamps (silver) *Bolts not included.	JS-04400-CLR
B. Super Jet 96+ Handlebar pad cover	YA-04109
C. Replacement Bearing Kit	YA-04110
D. Handlebar Clamp Bolt Kit (8x20 Socket Flat Head) 4 bolts per kit	59-9129



BLOWSION BILLET STEERING SYSTEM SEALED BEARING WITH KROK LOCK NUT

Description	Part No.
Blowsion Billet Steering System - Yamaha SJ, Kawasaki Conversion, Octane	03-05-001
Blowsion Krok Collar	03-05-019



TBM RACING SEALED BEARING STEERING SYSTEM

Description	Part No.
E. TBM Racing Yam/Kaw/Pol Sealed Bearing Steering System	TBM126
TBM Racing Steering System Bearing Replacement Kit	TBM126-B
F. TBM Racing Steering System Lock Nut	TBM126-N



RRP UNIVERSAL STEERING SYSTEM

Designed to match and compliment the RRP Turn Plate, this steering system improves the steering feel, eliminates steering slop and is much stronger than the OEM steering systems on standup watercraft. This kit will fit most aftermarket turn plates. Handlebar clamps are standard 22.2mm and are black.

Description	Part No.
RRP Universal Steering System	STR-SYST-UNIV
RRP Bearing and O-ring Repair Kit	SS-B
RRP O-Ring Repair Kit	SS-O



RRP AST STEERING SYSTEM FOR 28.6MM FAT BARS

See page 92 for information and details.

Description	Color	Part No.
G. RRP AST Steering System	Black	STR-SYST-UNIV-F-BLK
H. RRP AST Steering System	Red	STR-SYST-UNIV-F-RD
RRP AST Steering System	Silver	STR-SYST-UNIV-SLV
RRP Bearing and O-ring Repair Kit		SS-B
RRP O-Ring Repair Kit		SS-O



BNJ BEARING STEERING SYSTEM FOR SXR/ZR

Designed by BNJ (Team BNJ Racing in Belgium) with European Women Class Champion, YUKI KURAHASHI. This bearing steering system make precise turn of Kawasaki 800SXR or Zapata Racing FZ. Kit include Handle Bar. Black anodized finish to prevent corrosion.

Description	Part No.
BNJ Bearing Steering System for SXR/ZR	BNJ-SXR

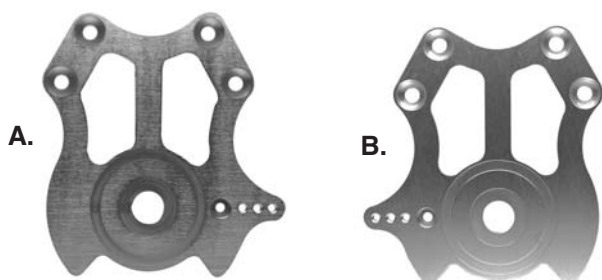

Yamaha Superjet

Kawasaki 800 SXR

UMI RACING TURN PLATE

Description	Part No.
A. UMI Yamaha Super Jet Turn Plate	YA-04104-CLR
B. UMI Kawasaki 800SXR Turn Plate*	JS-04105-CLR

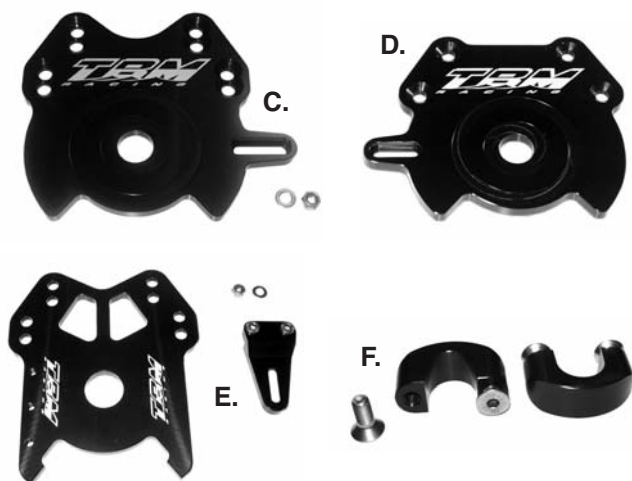

TBM RACING TURN PLATE & BILLET HANDLEBAR CLAMPS

Description	Part No.
C. TBM Racing Yamaha Turn Plate -1"	TBM102-YAM
D. TBM Racing Kawasaki Turn Plate -1"	TBM102
E. TBM Racing Kawasaki OEM Replacement Turn Plate	TBM102-OE
F. TBM Racing Billet Handle Clamps	TBM135
Color: Black (Sold as pair with 4 clamp bolts)	

BLOWSION

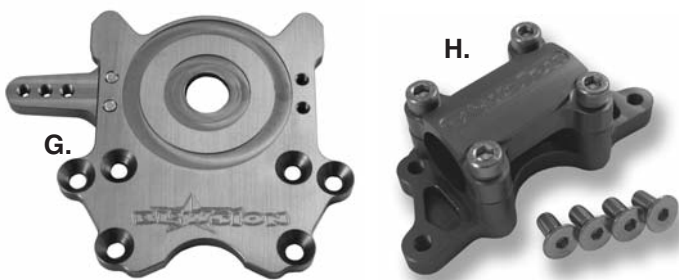

-1" TURN PLATE

Moves the normal rider position forward approximately 1 inch. Helps to reduce hull porpoising and dramatically improves handling. Fits both Yamaha SJ and Kawasaki 800SX-R applications.

Description	Part No.
G. Blowsion -1" Turn Plate	03-05-043
H. Blowsion Phat Clamp	03-05-018



RRP Turn plates integrate a grease fitting to maintain the optimum lubrication.



RRP PRECISION TURN PLATE

See page 93 for information and details.

Description	Part No.
RRP -1" Precision Turn Plate	TRN-PLT-UNIV



ADA BILLET STEERING PLATE FOR 1 1/8" FAT BARS

Billet steering plate for 1 1/8" fat bars. Steering cable mount can be mounted on either side of the plate. This plate will work with the UMI and Blowsion style sealed bearing systems. *This can also be used on the Kawasaki SXR by relocating the pivot post in the stock subplate to the forward hole.*

Description	Color	Part No.
ADA Fat Bar Billet Steering Plate	Silver	34-521090
ADA Fat Bar Billet Steering Plate	Black	34-521000

FOUR STROKE	INTAKE SYSTEMS	ENGINE/ GASKETS	EXHAUST	DRIVE LINE HANDLING	ELECTRICAL	WATERLINE /BILGE	STEERING & CONTROLS	BODY	ACCESSORIES	SERVICE TOOLS /HARDWARE	CHEMICAL
-------------	----------------	-----------------	---------	---------------------	------------	------------------	---------------------	------	-------------	-------------------------	----------



For Rick Roy Handlepoles and RRP Steering related items, please see pages 90-96 for information and details.

BLOWSION

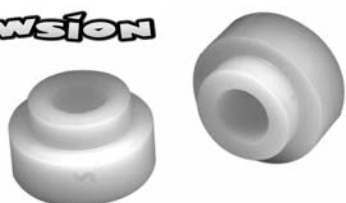

SXR PIVOT BOLT BUSHING FOR OEM BRACKET

UMI Handle Pole conversion for OEM SX-R bracket or AC Handlepole conversion for OEM SX-R Bracket.

Kawasaki SX-R	Part No.
For UMI Handlepole	03-04-101
For AC Handlepole	03-04-102

UMI Racing USA
 ...For The Uncommon®

BLOWSION



A.



B.

HANDLE POLE EXTENSION LIMITING ROPE

This pole limiting rope is to STOP pole from extending appx. 2-3" from total max extension. This prevents the forward motion of the pole. Fits all stand up Yamaha Super Jet, Polaris Octane, Kawasaki SXR 800, 750 SX & all JS models. A must for ocean or big wave riders

Description	Part No.
A. UMI Limiting Rope Kit	YA-09100
B. Blowision Limiting Rope Kit	03-04-151

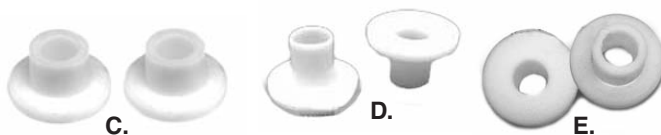

C.

D.

E.

OEM HANDLEPOLE REPAIR/REPLACEMENT BUSHINGS

Bushings are sold in sets of two.

Description	Part No.
C. OEM Kawasaki 440/550/550SX/650SX Handlepole*	31-660115
* These are oversized bushings and pivot bolt holes must be enlarged to fit bushings.	
D. OEM Kawasaki 750/800 Handlepole	03-04-103
E. Yamaha SuperJet (96+) Handlepole	03-04-104
E. Yamaha UMI Handlepole with OEM SuperJet Pole Bracket	03-04-104

BLOWSION



BLOWSION STEERING STOP

Blowision stainless Steering Stop and nut. Updated design allows for two mounting positions for riders wanting more steering throw. Fits all OEM, UMI, Factory Yamaha, RRP and AC aluminum Handlepoles.

Description	Part No.
Blowision Steering Stop with Nut	03-04-131



HANDLE POLE SPRINGS

Greatly reduces weight of stock handle pole up to 75% and reduces rider arm and shoulder fatigue.

Yamaha	Part No.
A. Super Jet Pre 95	03-04-011
B. Super Jet 96+	03-04-012

Kawasaki	Part No.
C. 750SX, 750 SXI, 800SXR	03-04-003
D. 300/440/550/550SX "Dual Coil Spring"	RM5500
E. 650SX	WCW-650SXSPRING

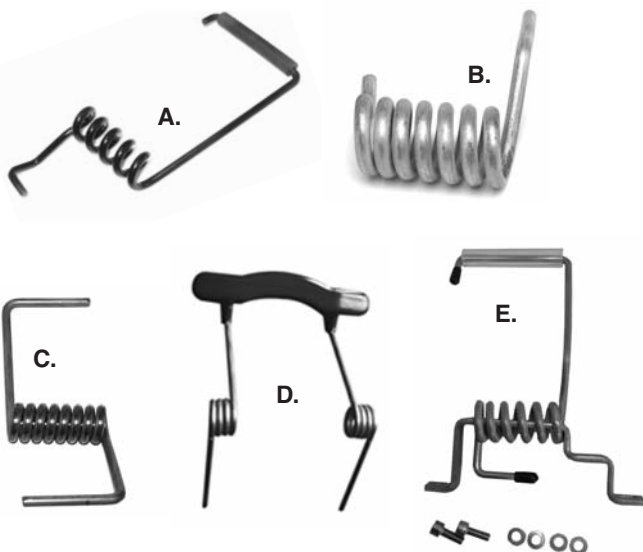

ADA RACING BILLET 800SXR TALL HANDLEPOLE SPRING TENSIONER

Kawasaki 800 SX-R handlepole spring tensioner. Includes billet black anodized bracket and stainless hardware.

Kawasaki	Height	Part No.
ADA Tensioner	25mm	KA800ST



KOMMANDER TENSIONER KAWASAKI 800 SXR

Kawasaki	Height	Part No.
G. 800 SXR Short	23mm	KOM104-SHORT
H. 800 SXR Tall	38mm	KOM104-TALL



WATERCRAFT WERKS KAWASAKI 750SX/SXI HANDLEPOLE SPRING TENSIONER

The Watercraft Werks Spring Tensioner adds preload to the handlepole which reduces the handlepole weight. The lighter handlepole reduces back, shoulder and arm fatigue. The stainless steel constructed shim installs in less than 5 minutes with basic tools.

Kawasaki	Part No.
Handlepole Spring Tensioner	WCW-75SXPST



TBM TENSIONER FOR KAWASAKI 800 SXR

Kawasaki	Part No.
800 SXR Short	TBM104-S
800 SXR Tall	TBM104-T



SXR BILLET HOOD BUMPER

Direct replacement for OEM bumper. Includes pre-cut foam and hardware. For Kawasaki 800SXR/750SXI.

Description	Part No.
Hood Bumper Clear	04-04-201
Hood Bumper Green	04-04-202
Hood Bumper Red	04-04-203

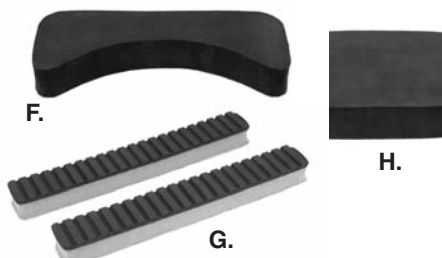

POLE SHOCK PADS

Protects engine hood from damage when handlepole is dropped. Color: Black only

Description	Part No.
F. Kaw 750SX/SXI/800SXR (1)	TS401
G. Kaw JS440/550/550SX (2)	TS411
H. Yamaha Super Jet (1)	TS421

FOUR STROKE	INTAKE SYSTEMS	ENGINE/GASKETS	EXHAUST	DRIVE LINE HANDLING	ELECTRICAL	WATERLINE /BILGE	STEERING & CONTROLS	BODY	ACCESSORIES	SERVICE TOOLS /HARDWARE	CHEMICAL
-------------	----------------	----------------	---------	---------------------	------------	------------------	---------------------	------	-------------	-------------------------	----------

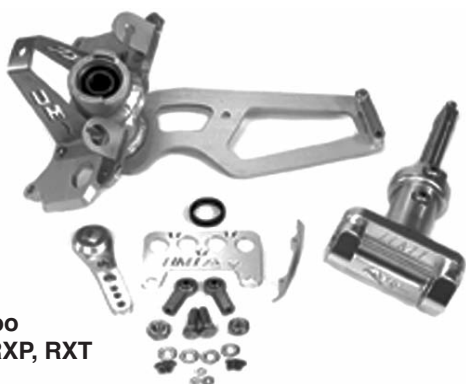

Sea-Doo
GSX, RXP, RXT

UMI TOP STOP BILLET STEERING

Sea-Doo **Part No.**
GSX, GTX, GTI, GTS, GSI, GS 96+, SD-04804-GSX
RX, RXP, RXP-X, RXT, RXT-X



UMI *Racing* USA
...For The Uncommon™

Yamaha **Part No.**
UMI Wave Blaster Billet Steering System YA-04700-TS



UMI *Racing* USA
...For The Uncommon™

Kawasaki **Part No.**
UMI X-2 Billet Steering System X2-04600-TS



REPLACEMENT BEARING KIT FOR UMI STEERING SYSTEMS

Description **Part No.**
Replacement Bearing Kit For all Steering Systems 58-6300
except XP97+ (requires 2 kits)



"DO SPEED" SPACER AND MOUNTING KIT FOR UMI RXP-X/RXT-X STEERING SYSTEMS

See page 26 for information and details.

Description **Part No.**
"DO Speed" Spacer and Mount Kit for UMI D-X-P
RXP-X and RXT-X Steering System

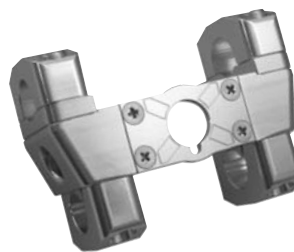

SPEED MAGIC "X MOUNT" STEERING HEAD

Description **Part No.**
Speed Magic Steering Head SE-027015



ULTRA 250/260/300 AFTERMARKET BILLET HANDLEBAR ADAPTER

See page 83 for information and details.

Description **Part No.**
Ultra 250/260/300 Billet Handlebar Adapter DC-HA-KU



R&D FX-SHO/FZR/FZS BILLET STEERING SYSTEM KITS

See page 64 for information and details.

Description **Part No.**
R&D FZR / FZS Billet Steering System 512-18000
R&D FX-SHO Billet Steering System 512-18001



NOTE: Prototype "Show Piece" shown. Production color not represented.



NEW



RS24090-ICRT

RXP-X 260 PRO-SERIES STEERING SYSTEM

See page 26 for information and details.

Description	Part No.
RXP-X 260 Pro-Series Steering System	RS20110
RXP-X 260 (T3) 2012, Black	
Sea-Doo iControl Removal Tool	NEW RS24090-ICRT



RIVA RXP-X/RXT-X 255 BAR MOUNT SYSTEM

See page 27 for information and details.

Description	Part No.
RIVA RXP-X, RXT-X 255 (08-11)	RS20050-U
Bar Mount System non iControl	



RIVA FZ PRO-SERIES STEERING SYSTEM

See page 64 for information and details.

Description	Part No.
RIVA FZ/FZS Steering System	RY20050-U-3.5
Tube Kit 5-1/2"	RY20050-RK-5.5
Tube Kit 7-1/2"	RY20050-RK-7.5



RIVA VXR/VXS PRO-SERIES STEERING SYSTEM

See page 64 for information and details.

Description	Part No.
RIVA VXR/VXS Pro-Series Steering System	RY20060-U



RIVA ULTRA PRO-SERIES STEERING SYSTEM

See page 82 for information and details.

Description	Part No.
RIVA Ultra 250/260/300 Steering System	RK20090-U-8.75
11.75" Tube Kit for RK20090	RK20090-RK-11.75



RIVA ULTRA PRO-SERIES STEERING LOWER

See page 82 for information and details.

Description	Part No.
RIVA Ultra Lower System Steering Assembly	RK20090-L

FOUR STROKE	INTAKE SYSTEMS	ENGINE/ GASKETS	EXHAUST	DRIVE LINE HANDLING	ELECTRICAL	WATERLINE /BILGE	STEERING & CONTROLS	BODY	ACCESSORIES	SERVICE TOOLS /HARDWARE	CHEMICAL
----------------	-------------------	--------------------	---------	------------------------	------------	---------------------	------------------------	------	-------------	----------------------------	----------

R&D AUTO DROP NOZZLE KITS



The R&D VTS/Auto Drop Nozzle is the first manually activated VTS nozzle with Auto Drop functions! When riding with the VTS adjusted in the neutral position the nozzle will drop 5 degrees in the turns allowing for a much smoother high speed turn to be made. When the steering reaches the straight position the nozzle returns back to the straight position. When riding with a full tank the best VTS setting is usually in the click up position and stays there.

With the R&D VTS Nozzle Kit you can ride 1 click up (5 degrees up) and when you turn the nozzle will drop 5 degrees which is back to zero or straight position. When steering returns back to straight the nozzle resumes the one click up (5 degrees up) position.



162-18010

Yamaha	Part No.
GP1200R VTS Auto Drop Nozzle Kit	162-12001
GP1300R VTS Auto Drop Nozzle Kit	162-13000
FX SHO/FZR/FZS VTS Auto Drop Nozzle Kit	162-18020
FX SHO/FZR/FZS VTS Quick Shift Cam Kit	162-18010



Sea-Doo RXP

The R&D RXP Auto Trim Kit was developed to override the OEM VTS System with a fully adjustable and fully automatic trim system! The R&D Auto Trim automatically drops a rider preferred adjustable 2-8 degrees. Drive from turn to turn never worrying whether the trim is in the best position for perfect turn negotiation! For long straight rides install the R&D VTS/Holeshot Driver Rod

(Pt.# 163-21503), which works in conjunction with the R&D Auto Trim to electronically override the Auto Trim back to the OEM VTS Nozzle angle trim settings!



162-21503

Sea-Doo	Part No.
RXP 215	163-21502
RXP Holeshot Rod for use with #163-21502	163-21503
GTX 4-Tech (03-07) RXT (03-07) Auto Trim Kit	163-95003
RXP-X 255/RXT-X 255 Auto Trim Kit	163-25500

R&D HYDRO FORCE STEERING NOZZLE



Kaw Ultra 150



Sea-Doo RXP



Yamaha
GP1200R/GP1300R

The new lengthened design delivers a full 1 MPH speed gain over stock. The pivot point position improves the turning radius allowing you to carve tighter turns with a more positive feel. Improved performance through speed, acceleration and handling.

Sea-Doo	Part No.
RXP/RXP-X/RXT/RXT-X (+15mm) Pro Style Ext. Nozzle	163-21500

Yamaha	Part No.
GP 1200R / 1300R	162-12000
FX140 / FX H.O./FX SHO/FZR/FZS	162-14000

Kawasaki	Part No.
Ultra 150	161-15000



BLOWSION BILLET ALUMINUM TRIM LEVER



Blowsion Trim Lever - Left hand operated trim lever for pump tilt or trim systems.

Description	Color	Part No.
Blowsion Trim Lever	Silver	03-05-230
Blowsion Trim Lever	Black	03-05-231



UMI RACING TRIM LEVER

Billet Aluminum Trim Lever for Trim Tab and Quick Trim Nozzles.



Description	Color	Part No.
UMI Trim Lever	Clear	KA-01525-CLR
UMI Trim Lever	Black	KA-01525-BLK



EZ-TRIM SYSTEM (THE ORIGINAL)



Easy-Trim System was designed to allow riders of all levels to get a fair amount of trim with a light pull on the lever. The system will give you 30-35 degrees of trim. The system is constructed of anodized billet aluminum for strength and light weight. It can be changed into the

straight pull with a few additional accessories. This system is available for Yamaha Superjet or similar pump setups.

Kit includes: trim ring, cable, lever, hardware, reduction nozzle and steering nozzle. It is recommended that you purchase a through hull tube if your PWC is not equipped for a clean and easy installation.

EZ-Trim System	Color	Part No.
144mm Trim System	Black	TI-EZ-TRIM-BLACK-144
144mm Trim System	Red	TI-EZ-TRIM-RED-144
144mm Trim System	Silver	TI-EZ-TRIM-SILVER-144
Thrust Universal Replacement Trim Cable		TI-EZ-TRIM-CABLE

**See pages 303-304 for New Release Thrust Innovation Trim Systems*



BLOWSION YAMAHA & KAWASAKI HEAVY DUTY STEERING CABLES

Description	Part No.
Blowsion Yamaha SJ (1996-13), All Rickters	02-05-302
Blowsion Kawasaki SXR (All Years)	02-05-303



TBM KAWASAKI SLOP FREE STEERING CABLE ENDS

For 9mm ball joints.

Description	Part No.
TBM Kawasaki Slop Free Steering Cable Ends	TBM112



BLOWSION IZZNELL TWISTER NOZZLE

Available for all years Yamaha SuperJets. Allows additional throw on steering nozzle and multiplies the turning radius exponentially. A surf and freeride necessity!

Description	Part No.
Izznell Twister Nozzle Bracket only	02-02-417



NEW



Check Out Video



RRP NINJA PUMP FLOW GUARD

This innovative Pump Flow Guard from RRP/Ninja helps to increase performance and to gain more height for aerial maneuvers. It allows for full functionality of the steering nozzle and trim system.

- Prevents the water flow from the outside of the pump entering between the restriction and steering nozzles, breaking the flow water inside the pump.
- Prevents back spray when turning the steering nozzle, and loss of internal pump pressure.
- Stops the pumps spraying into the exhaust, which causes engine bog on acceleration during turns and maneuvers.



2012 Freestyle World Champion
Rok Florjancic &
Hiro "Ninja" Ogino

Description	Model	Part No.
155 Yamaha	Carbon	FL-GD-NIN1-CB (155-YAM)
155 Yamaha	Black Fiber	FL-GD-NIN1-F-BLK (155-YAM)
144 Yamaha	Carbon	FL-GD-NIN1-CB (144-YAM)
144 Yamaha	Black Fiber	FL-GD-NIN1-F-BLK (144-YAM)
Thrust 144 Yam	Carbon	FL-GD-THRUST-CB (144-YAM)
Thrust 144 Yam	Black Fiber	FL-GD-THRUST-F-BLK (144-YAM)



RRP YAMAHA QUICK STEERING ADAPTER

This quick steering adapter fits the stock superjet nozzle. It will give you the option to play with the quickness of the steering from really aggressive to really smooth. It will also give you a lot more turning ratio for free style. RRP quick steering adapters are black

Description	Part No.
RRP Yamaha Quick Steering Adapter	QU-ST-YAM-BL

FOUR STROKE	INTAKE SYSTEMS	ENGINE/ GASKETS	EXHAUST	DRIVE LINE HANDLING	ELECTRICAL	WATERLINE /BILGE	STEERING & CONTROLS	BODY	ACCESSORIES	SERVICE TOOLS /HARDWARE	CHEMICAL
-------------	----------------	-----------------	---------	---------------------	------------	------------------	---------------------	------	-------------	-------------------------	----------

HOT PRODUCTS THROTTLE CABLE ADAPTERS

NEW



New improved design for 2013, aluminum and anodized silver

Description	Part No.
Cable Adapter for Kawasaki Pre-86, Yamaha & All Wet Jet 6mm Throttle Cable	58-0990
Kawasaki 440 (76-86), 550 (82-85), Yamaha All Models (87-00) Hydrospace S4	



Description	Part No.
Cable Adapter for Kawasaki 96+ 8mm Throttle Cable	58-0991
Kawasaki 750 SS-XI-SXI (96-00), 750 STS (95-97), ZXI (95-00), STX (97-00)	



Description	Part No.
Cable Adapter for All Sea-Doo	58-1996



HOT PRODUCTS ALUMINUM TRIGGER THROTTLE LEVERS

Fits 86-95 Kawasaki & Polaris.

10mm Throttle Cable Kawasaki 550 (86-95), 650 (86-95), 750 SX-SS-SXI (92-95), 750 ST (94-95).

An adapter is required for: Sea-Doo, Yamaha and Kawasaki Pre 86 & 96+.

Description	Part No.
Silver	58-0970
Black	58-0971

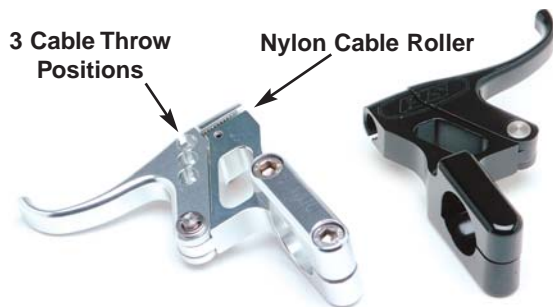

PJS BILLET THROTTLE LEVER

Billet constructed throttle features nylon cable roller, nylon bushing and thrust washers, 3 cable throw positions, 6mm stainless steel bolts. This lever is specially designed to contour around your index finger. The narrow lining allows you to gain quicker response on hole shots without your middle finger getting in the way of a full pull.

Description	Part No.
Silver	58-0981
Black	58-0982

UMI Racing USA
...For The Uncommon®



UMI BILLET FINGER THROTTLE

Lever perch is machined at an angle which makes the lever pull at a downward sloping angle. This motion keeps the lever at the tip of your finger throughout the throttle range greatly reducing arm pump and providing superb throttle control. Also available in traditional straight pull. Teflon bushings eliminate the play common in other throttles and provides a smoother throttle pull. Stainless steel pin and C-Clip eliminates corrosion at hinge point. Available for all models. Also available in anodized black. Some models require throttle cable adapter.



Straight



Regular

Straight Lever	Part No.
Silver	KA-01521-CLR
Black	KA-01521-BKA

Angled Lever	Part No.
Silver	KA-01520-CLR
Black	KA-01520-BKA



BLOWSION BILLET THROTTLE LEVER

Machined with the stand-up rider comfort at a premium, the new Blowision straight pull finger throttle levers are ergonomically designed for premium fit and feel whether you are on the waves or on the buoys. Lever angle is situated to reduce hand and arm fatigue. Delron bushings eliminate the play common in OEM throttle levers and provides a smooth throttle pull action. All stainless hardware at the hinge point eliminates corrosion and play 100%. No "C" clips are used in the throttle lever assembly.

Description	Part No.
Black	03-05-201
Blue	03-05-202
Green	03-05-204
Orange	03-05-205
Red	03-05-207
Clear	03-05-208



RIVA RACING SEA-DOO BILLET FINGER THROTTLE

Specifically designed to match throttle travel of Sea-Doo 4-Stroke PWC. Direct replacement for bulky OEM throttle on X-Models and can be used with aftermarket bars on other 4-tec applications. Adjustable throttle angle & unique trigger design keeps the trigger at the tip of your finger throughout the throttle range for reduced arm pump & superb throttle control. Delrin bushings eliminate

play common in OEM throttles and provide smooth actuation. All stainless hardware at hinge point eliminates corrosion and play. No "C" clips used. Use with OEM adapter on X-Models or use aftermarket adapter (sold separately) for other 4-Tec applications.

Description

Part No.

RIVA Racing Billet Finger Throttle for Sea-Doo **RS24010P**

*Available in clear finish only



RIVA RACING YAMAHA & KAWASAKI BILLET FINGER THROTTLE

Ergonomically designed for premium fit and feel whether you are on the waves or turning buoys. Lever angle is fully adjustable to reduce hand and arm fatigue. Delrin bushings eliminate play common in OEM throttles and provide smooth actuation. All stainless

hardware at hinge point eliminates corrosion and play. No 'C' clips used. Available in anodized Clear or Black. Throttle cable adapter sold separately.

Description

Part No.

Clear Billet Finger Throttle for Yam/Kaw **RY24010P**
Black Billet Finger Throttle for Yam/Kaw **RY24010B**



TBM RACING HI PERFORMANCE ADJUSTABLE FINGER THROTTLE

Precision machined from aircraft grade aluminum featuring a bushing pivot, fully adjustable perch and ergonomically correct to reduce hand fatigue. Fully rebuildable design allows you to replace the pivot bearing extending the life of the throttle lever. Also available with a needle bearing pivot for the ultimate in precision ergonomics.

Description

Model

Part No.

A. Clear	Bushing	TBM118B-CLR
B. Black	Bushing	TBM118B-BLK
A. Clear	Bearing	TBM118BB-CLR
B. Black	Bearing	TBM118BB-BLK

SD RXP/RXT/RXP-X & Hydrospace

Model

Part No.

C. Clear	Bushing	TBM118-SH-CLR
D. Black	Bushing	TBM118-SH-BLK



UMI RXP TRIM/SWITCH HOUSING

U.M.I.'s trim/switch housing is machined from 6061-T6 billet aluminum, replacing the stock plastic housing. Trim/switch housing uses the factory variable trim switch and start/stop switch. This housing must be used with the U.M.I. GSX/RXP (P/#58-6321) steering system, aftermarket bars and finger throttle.

Sea-Doo

Color

Part No.

RXP	Clear Anodized	SD-01600-CLR
-----	----------------	---------------------

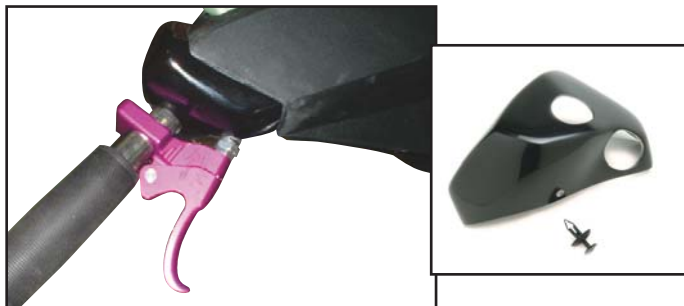

HANDLEBAR COVER CAP FOR SEA-DOO 4-TEC - RXP - RXT - GTX - GTI

Description

Handlebar Cover Cap

Part No.

FB001-SD



BILLET STOP SWITCH HOLDER FOR AFTERMARKET HANDLEBARS

Sea-Doo

Part No.

SD GTX, 4-Tec, RXP, RXT (One hole type)	58-2003
-----------------------------------------	----------------



BILLET 3 SWITCH HOLDER FOR AFTERMARKET HANDLEBARS

Description

Color

Part No.

Sea-Doo	Polished	58-2004
---------	----------	----------------

FOUR
STROKE

INTAKE
SYSTEMS

ENGINE/
GASKETS

EXHAUST

DRIVE LINE
HANDLING

ELECTRICAL

WATERLINE
/BILGE

STEERING
& CONTROLS

BODY

ACCESSORIES

SERVICE TOOLS
/HARDWARE

CHEMICAL



Easy Installation No Grip Glue Required

Revolutionary Non-Slip Technology for the Wettest Environments on Earth

- Lock-On Grip System eliminates grip twisting and slippage without the need for ties or glues.
- Replaceable aluminum Lock Jaw clamps lock grip onto bars like a vise to prevent slippage.
- New 3/4 Flange helps keep hands from slipping without interfering with thumb throttle systems.
- Fits on aftermarket handlebars such as UMI, etc.

Aluminum Lock Jaw clamps grips onto bars like a vise to prevent slipping.

Soft and tacky outer layer cushions hands and provides optimal traction.

New aluminum bar and snap cap.



Durable inner sleeve allows grip to easily slide onto bars.

ODI ROGUE LOCK-ON GRIPS

- Thick raised pads for maximum shock absorption
- Texture surface pattern for better control
- Elevated thread pattern channels water off the grip

ROGUE WATERCRAFT GRIPS

Soft



Description Rogue, Thumb Throttle, 120mm, with 3/4 Flange **Part No.** L30RGB-S

ROGUE WATERCRAFT GRIPS

Soft



Description Rogue, No Flange, 130mm **Part No.** L31RGB-S

BLOWSION LOCK RING CAP SET

Blowsion integrated the outside lock ring and the end cap into one piece for that special look. Each package contains two lock rings and two lock ring end caps.



Description	Color	Part No.
Grip Lock Ring End Caps set-Billet	Black	03-05-341
Grip Lock Ring End Caps set-Billet	Blue	03-05-342
Grip Lock Ring End Caps set-Billet	Clear	03-05-343
Grip Lock Ring End Caps set-Billet	Green	03-05-345
Grip Lock Ring End Caps set-Billet	Orange	03-05-346
Grip Lock Ring End Caps set-Billet	Purple	03-05-347
Grip Lock Ring End Caps set-Billet	Red	03-05-348
Grip Lock Ring End Caps set-Billet	Yellow	03-05-349

ODI RUFFIAN LOCK-ON GRIPS

- Extra narrow diameter
- Diamondized surface for excellent traction

RUFFIAN WATERCRAFT GRIPS

Hard Slim



Description Ruffian, Thumb Throttle, 120mm, with 3/4 Flange **Part No.** L30RFB-S

RUFFIAN MOUNTAIN BIKE GRIPS

Hard Slim



Description	Color	Part No.
Ruffian, No Flange, 130mm	Black	L31RFB-S
Ruffian, No Flange, 130mm	White	L31RFB-W



BLOWSION KUSTOM DESIGN



ANODIZED ALUMINUM LOCK RING

Anodized aluminum lock ring for ODI grips. Lock-on system grips package's contains 4 lock rings each.

Description	Color	Part No.
Griplock Lock Ring Anodized	Green	03-05-335
Griplock Lock Ring Anodized	Blue	03-05-332
Griplock Lock Ring Anodized	Orange	03-05-336



Experience the Ultimate in Watercraft Control

These grips features a raised diamond plate pattern that offers additional comfort as well as control across the length of the grip. ODI has also included our exclusive "pre-cut" style flange which is just large enough to easily reference your hand position, while also being small enough to stay out of the way when you are trying to access thumb-throttles or other handlebar components.

X-Treme Elements Lock-On Grip

Medium Soft



Graphite
L30XTH-G

Description	Color	Part No.
X-Treme Pre-Cut Flange, 130mm,	Graphite	L30XTH-G
X-Treme Pre-Cut Flange, 130mm,	Black	L30XTB-B



**RECOMMENDED
FOR FREESTYLE
RIDING**

Description	Part No.
White with Red Clamps	L30TLW-R
Black with Grey Clamps	L30TLB-G
Yellow with Purple Clamps	L30TLY-P
Red with Black Clamps	L30TLR-B
Orange with Black Clamps	L30TLO-B



ODI LOCK JAW CLAMPS AND CAPS

- Sturdy one-piece machined aluminum design
- Replacement set includes 2.5mm bolts

Description	Color	Part No.
Lock Jaw Clamps and Caps	Black	D70LJB
Lock Jaw Clamps and Caps	Silver	D70LJS
Lock Jaw Clamps and Caps	Red	D70LJR
Lock Jaw Clamps and Caps	Gray	D70LJG

ODI RUFFIAN MX LOCK-ON GRIPS

NEW! The Ruffian MX Grip combines an ultra narrow knurled Ruffian surface pattern combined with a motocross inspired half-waffle pattern for a great all around grip.

Medium Soft Slim



Description	Part No.
Ruffian MX, No Flange, 130mm	L32RFB-S

ODI CROSS TRAINER LOCK-ON GRIPS

Medium Soft Slim



Description	Part No.
Cross Trainer, No Flange, 130mm	L30CTB-B

BILLET ALUMINUM END PLUG



Protect your bars and grips with ODI Aluminum End Plugs. Constructed of sturdy 6061 aluminum, these plugs are

designed to take the brunt of whatever you can throw at them. Product Features: Sturdy 6061 Aluminum, Fits most sized bars, Triple-Core Design Holds Plugs Inside Bars, Sold in pairs

Description	Color	Part No.
Aluminum Bar End Plug	Black	L71APB
Aluminum Bar End Plug	Blue	L71APU
Aluminum Bar End Plug	Red	L71APR
Aluminum Bar End Plug	Silver	L71APS



ODI LOCK JAW REPLACEMENT BOLTS

These bolts are replacements for the specially designed allen bolts used with Lock Jaws and eliminates the need to buy an entire new set of clamps just to replace the bolts.

Description	Part No.
Lock Jaw Replacement Bolt Set (5 pcs/pk)	F70RSB

FOUR STROKE	INTAKE SYSTEMS	ENGINE/ GASKETS	EXHAUST	DRIVE LINE HANDLING	ELECTRICAL	WATERLINE /BILGE	STEERING & CONTROLS	BODY	ACCESSORIES	SERVICE TOOLS /HARDWARE	CHEMICAL
-------------	----------------	-----------------	---------	---------------------	------------	------------------	---------------------	------	-------------	-------------------------	----------

All Grip Kits Include Plastic End Caps



Plastic End Caps



Hot Product
Logo Rings



LOEDS100



LOEDS200



LOEDS400

Medium
Soft
Slim

EXPERT MACHINE GRIPS

Description	Grip Color	Ring Color	Part No.
Expert Machine Grips	Black	Black	LOEDS100
Expert Machine Grips	White	Black	LOEDS200
Expert Machine Grips	Blue	Black	LOEDS400



LOPDS100



LOPDS200



LOPDS300



LOPDS400

PEATY GRIPS

Medium
Soft
Slim

White grips come with anodized red and blue rings, graphite grips come with anodized red rings and black grips come with anodized graphite rings. Small diameter, 130mm.

Description	Grip Color	Ring Color	Part No.
Peaty Grips	Black	Graphite	LOPDS100
Peaty Grips	White	Red	LOPDS200
Peaty Grips	Graphite	Red	LOPDS300
Peaty Grips	Blue	Gold	LOPDS400



LOLDS100



LOLDS500



LOLDS700

Hard
Slim

LOGO GRIPS

Description	Grip Color	Ring Color	Part No.
Logo Grips	Black	Black	LOLDS100
Logo Grips	Red	Black	LOLDS500
Logo Grips	Green	Black	LOLDS700



LOCDS100



LOCDS200



LOCDS550



LOCDS700

Medium
Soft
Slim

CHARGER GRIPS

Your favorite grip now available as a lock-on grip. Small diameter, 130mm.

Description	Grip Color	Ring Color	Part No.
Charger Grips	Black	Black	LOCDS100
Charger Grips	White	Black	LOCDS200
Charger Grips	Pink	Black	LOCDS550
Charger Grips	Neon Green	Black	LOCDS700

All Grip Kits Include Plastic End Caps



LODDS100



LODDS200

BEARCLAW GRIPS

Description	Grip Color	Ring Color	Part No.
Bearclaw Grip	Black	Red	LODDS100
Bearclaw Grips	White	Red	LODDS200



LONDS010



LONDS030

Medium Soft

NORTHSHORE GRIPS

This grip is great for people with large hands.

Description	Grip Color	Ring Color	Part No.
Northshore Grips	Black	Black	LONDS010
Northshore Grips	Graphite	Black	LONDS030



LOMDS010



LOMDS040

MOAB GRIPS

Description	Grip Color	Ring Color	Part No.
Moab Grips	Black	Black	LOMDS010
Moab Grips	Black	Blue	LOMDS040



SUPPORTS





EUROPEAN FREESTYLE CHAMPIONSHIP 2013

**BE THE BEST
BEAT THE BEST**

ROUND 1

8. 6. 2013

ENGLAND

LONDON / DOCKLANDS
KING GEORGE V DOCK

ROUND 2

6. 7. 2013

FRANCE

SO' FUN VILLAGE
VILLENEUVE LA GUYARD

ROUND 3

17. 8. 2013

**EUROPEAN
FINALS**

JOINT EVENT WITH IJSBA CLOSED
COURSE CHAMPIONSHIP
ENGLAND / DONCASTER

SUPER FINAL

18. 8. 2013

**EUROPEAN
FINALS**

JOINT EVENT WITH IJSBA CLOSED
COURSE CHAMPIONSHIP
ENGLAND / DONCASTER





WWW.PWCFREESTYLE.EU
FACEBOOK.COM/PWCFREESTYLE