

SEA DOO RXP RXP-X RXT RXT-X • INTAKE

SEA DOO
4 STROKE
INTAKE
SYSTEMS
ENGINE/
GASKETS
EXHAUST
DRIVE LINE
HANDLING
ELECTRICAL
WATERLINE
/BILGE
STEERING
& CONTROLS
BODY
ACCESSORIES
SERVICE TOOLS
/HARDWARE
CHEMICAL



R&D RXT, GTX155/185/215 FILTER KIT

The R&D RXT high performance "supercharger" air intake/filter kit will eliminate power robbing air intake restriction caused by a long intake tube design and promote a noticeable bolt of low and mid range acceleration and boost top end performance 1 - 1.5 mph! The kit features are the short intake tube design and the huge (largest in the industry) filter element. The "supercharger" power plenum filter is coupled up to a rubber mounted, precision CNC formed 60/61 aluminum constructed short intake track runner tube. The new R&D "supercharger" filter kit will allow your 1500 cc Sea Doo 4Tec "supercharged" rev up an additional 100 plus RPM's. The filter kit installs very easily in 10-20 minutes, and has provisions in the filter to install the OEM crankcase ventilator.

eration and boost top end performance 1 - 1.5 mph! The kit features are the short intake tube design and the huge (largest in the industry) filter element. The "supercharger" power plenum filter is coupled up to a rubber mounted, precision CNC formed 60/61 aluminum constructed short intake track runner tube. The new R&D "supercharger" filter kit will allow your 1500 cc Sea Doo 4Tec "supercharged" rev up an additional 100 plus RPM's. The filter kit installs very easily in 10-20 minutes, and has provisions in the filter to install the OEM crankcase ventilator.

Sea Doo	Part No.
RXT (185 & 215 HP Engine)/GTX Supercharged	203-95003
GTX 4-TEC N.A. (155 HP Engine)	203-95002



R&D SEA DOO RXP 215 POWER PLENUM FILTER KIT

A hot rod should run and sound like a hot rod! The new R&D RXP Power Plenum Air Filter Kit will get the job done with definite noticeable increase in throttle response and acceleration, as well as increase RPM's between 50 and 100! R&D Power Plenum Filter Kits have been dyno tested and race proven to add 3 to 5 horsepower on stock four stroke 1500 cc engines! High performance four stroke guru's have dyno tested the R&D Power Plenum Air Filters to over 280 horsepower! The R&D RXP Power Plenum Filter Kit gives the RXP 215's engine a high performance racing look, sound, and performance without sacrificing an ounce of reliability!

Sea Doo	Part No.
Sea Doo RXP (215 HP Engine)	203-00215



R&D RXP-X/RXT-X 255 POWER PLENUM FILTER KIT

The R&D RXP-X and RXT-X High Performance Power Plenum Air Filter Kit was designed and developed exclusively for the new Sea Doo RXP-

X and RXT-X 255 H.P. 4Tecs new high flow intake system design. The R&D filter kit will unleash restricted low-end, mid-range and peak horsepower trapped in the O.E.M. air filtration system and intake ducting by relieving the air intakes main restriction. The new R&D Filter Kit installs in place of the O.E.M. main air box plenums restrictive air intake cover. Replacing the O.E.M. air box intake cover with the R&D Filter offers a very economical way to improve airflow CFM at a fraction of the cost compared to other aftermarket kits. Sounds good, looks great, saves cash and will install in minutes. The R&D Filter Kit is easy to remove for dealer maintenance visits.

Sea Doo	Part No.
R&D Power Plenum Filter Kit RXP-X/RXT-X 255	203-00255



RIVA RXP/RXP-X RXT/RXT-X/GTX-SC POWER FILTER KIT

Delivers greatly improved acceleration and a 1-2 mph (150-200 rpm) top speed increase by replacing the restrictive stock intake system. The Power Filter feeds your supercharger with a steady diet of cool air via a 3" diameter intake duct and oversized K&N filter element. Ducting is precision formed from a race proven composite that will not conduct heat to incoming air. Installs securely via a silicone coupler and sturdy bracket. Includes pre-filter element.

NOTE: It will be necessary to upgrade your stock pump impeller to a steeper pitch when using our Power Filter Kit. Sea Doo and RIVA both strongly recommend the use of premium octane (91+) pump fuel in your Supercharged watercraft.

Sea Doo	Part No.
Power Filter Kit, RXP/RXT (04-07), RXP-X/RXT-X 255, GTX-SC,	RS13050-06
Power Filter Kit, (03) GTX-SC only	RS13050-03
Power Filter only, for RS 13050-03/06	RS13050-2
Pre-Filter Only for RS13050-2	RS13050-PF-BLK



RIVA RXP PRO-SERIES POWER FILTER KIT

The Pro-Series Power Filter is

a race-bred air intake system that draws cool air from outside your engine compartment delivering incredible performance and eliminating power-robbing heat intake. Air enters the system under seat through a billet aluminum intake flange equipped with a water-repellent pre-filter. Precision formed ducting attaches to supercharger via a large 4" adapter. Kit includes a complete oil catch can/breather system that keeps hot oil vapor and crankcase fumes from entering your engine's air intake. Also contains two Flow-Rite® water-repellent vents for improved ventilation of engine compartment through engine cowling.

NOTE: This product is not designed for heavy surf use due to possibility of water ingestion. We recommend RIVA Power Filter part#RS13050-YEAR for this application.

Sea Doo	Part No.
Power Filter Kit, Pro-Series RXP 215/RXP-X 255*	RS13056
Pre-Filter Assembly only for RS13056	RS13056-PF
OEM Intercooler Upgrade Kit	RS17080-ICUK
RXP-X 255 HP/RXT-X 255 HP	

**NOTE: Relocation of the stock intercooler is required with Part #RS17080-ICUK (Page 9)*



RIVA INTAKE MANIFOLD UPGRADE KIT (255HP)

This Intake Manifold Upgrade Kit enables your engine to produce more horsepower through increased boost pressure (+1lb). Supplied hole

cutting tool allows easy removal of restrictive screen element from inside of intake manifold. Special o-ringed, billet block-off plug with integrated fitting for aftermarket boost pressure gauge fills opening left after removal of screen element. Includes detailed installation instructions.

Sea Doo	Part No.
RIVA Intake Manifold Kit RXP-X/RXT-X 255	RS12080-IMUK

SEA DOO RXP RXP-X RXT RXT-X • INTAKE



RIVA SEA-DOO RXT-X 260 POWER FILTER KIT

Our RXT-X 260 Power Filter Kit draws cold air from outside your engine compartment delivering awesome performance and eliminating power-robbing heat intake. Forward air intake is separated from hot engine compartment with rigid thermal bulkhead that installs between engine & fuel tank. Cold air is delivered to engine via large 4" smooth-bore ducting that is attached to supercharger with unique velocity stack and sturdy billet clamps. Requires use of RIVA Catch Can/Oil Breather System (part# RS19050-BCC). Fits 2010-2011 RXT-X 260 only (excludes iS/aS models).

Key Features:

- True "cold air" intake is separated from engine heat via thermal bulkhead.

- Delivers increased acceleration & top speed.
- Genuine screen type K&N flame arrestor.
- Large 4" smooth-bore ducting attaches to supercharger via flow-matched velocity stack.

Description	Part No.
RIVA RXT-X 260 Power Filter Kit	RS13100



RIVA RXP STAINLESS BRAIDED VENT HOSE KIT

Riva's custom Stainless Braided Vent Hoses directly replace the inferior plastic vent hoses that are prone to fading, cracking and distorting over time.

Sea Doo	Part No.
RIVA RXP 215/RXP-X 255 Stainless Braided Vent Hose Kit	RS5-0100



RIVA SEA DOO BVIC INTAKE BLOCK-OFF

Made from billet aluminum, our block-off plate fills the opening in the 215 intake manifold left when the stock intercooler is removed. Integrated fitting allows for use of aftermarket boost gauge. Includes Viton o-ring and is anodized to prevent corrosion.

Description	Part No.
RIVA BVIC Intake Block-off	RS1750-PC-ABBO



2006 & Newer Models



2005 & Older Models



RXP/RXT CATCH CAN/OIL BREATHER SYSTEM

Easy to install catch can/oil breather eliminates power-robbing crankcase fumes and oil vapor from your engine's air intake. Increases horsepower by removing the engine's requirement to burn relatively non-combustible oil. Also improves intercooler efficiency by preventing the oil sludge coating that lowers thermal efficiency. Excess oil vapor is routed to our translucent catch can where it condenses and collects for occasional draining via integrated petcock valve. Kit includes K&N breather, Sea Doo mounting bracket, hardware & instructions.

Sea Doo	Part No.
Breather, Catch Can Kit, RXP215, RXT 215/RXP-X 255/RXT-X 255 GTX 4-TEC	RS19050-BCC



R&D SEA DOO RXP CRANKCASE BREATHER KIT

The R&D Crankcase Breather Kit eliminates power-robbing crankcase fumes from the engines main air intake. Cleaner mass air equals more power!

Sea Doo	Part No.
RXP/RXT 215 HP, GTX 4-Tec Crankcase Breather Kit	203-00216



K&N RUBBER BASE CHROME TOP CRANKCASE VENT FILTERS

K&N Rubber Base Crankcase Vent Filters are designed to clamp directly to metal or plastic tubing. Ideal for engines, transmissions, oil or gas tanks on racing vehicles.

Sea Doo	Part No.
Flange I.D. 5/8" - 2" Diameter - 1 1/2" Height	62-1340
Flange I.D. 1 3/8" - 3" Diameter - 2 1/2" Height	62-1440



RIVA RACING FLO-RITE AIR VENT

Flow-Rite™ Air Vents reduce underhood temperatures & improve performance by allowing hot air to escape engine compartment. These 2" water-repellent vents feature an integrated pre-filter that allows air to pass freely while keeping water out. Installs easily into engine cowling or deck of your watercraft.

Sea Doo	Part No.
RIVA Flo-Rite Air Vent (1 piece)	RS-14-197

SEA DOO
4 STROKE

INTAKE
SYSTEMS

ENGINE/
GASKETS

EXHAUST

DRIVE LINE
HANDLING

ELECTRICAL

WATERLINE
/BLIGE

STEERING
& CONTROLS

BODY

ACCESSORIES

SERVICE TOOLS
/HARDWARE

CHEMICAL

SEA DOO RXP RXP-X RXT RXT-X • SUPERCHARGER

SEA DOO 4 STROKE
INTAKE SYSTEMS
ENGINE/ GASKETS
EXHAUST
DRIVE LINE HANDLING
ELECTRICAL
WATERLINE /BILGE
STEERING & CONTROLS
BODY
SERVICE TOOLS ACCESSORIES
/HARDWARE
CHEMICAL



RIVA GEN-2 SUPERCHARGER IMPELLER 215HP

Presenting the ultimate (drop-in) performance supercharger impeller for the Sea Doo 215hp engine! Working closely with Vortech Engineers, we devel-

oped the next generation high-performance replacement impeller that delivers 9lbs of boost @ 8,100rpm in RIVA Stage II applications. Produces more horsepower and torque throughout the RPM range resulting in excellent acceleration & top speed. Investment cast from an extremely strong, lightweight proprietary aluminum and CNC machined to ensure exact tolerances. All new blade design is optimized aerodynamically and precision balanced to deliver smooth operation. Installs easily into stock supercharger housing with no additional modifications required. Includes replacement mounting nut and detailed installation instructions.

**Note: It will be necessary to upgrade your stock pump impeller to a steeper pitch when using our Gen-2 Supercharger Impeller. Sea Doo and Riva both strongly recommend the use of premium octane (91+) fuel in your Supercharged PWC.*

Description	Part No.
SC Impeller, all RXP 215/RXT 215/GTX-SC	RS1750-001B
RIVA Supercharger Impeller Nut	RS1750-001A-N



RIVA SEA-DOO XX-CHARGER

Our new XX-Charger delivers 14.5 psi of boost pressure at 8,500rpm producing arm wrenching acceleration and increased top speed. High performance impeller, spacer & front housing combo increase horsepower through superior Vortech impeller blade design and larger interior housing volume. Impeller features a sophisticated blade design that is precision balanced to deliver smooth operation. Housing, spacer & impeller install quickly and easily onto stock supercharger base plate. Requires RIVA Pro-Series ECU, RIVA Pro-Series Fuel Injectors (50lb) & RIVA Fuel Pressure Regulator Kit for correct calibration. Includes detailed installation instructions.

Applications: 255/260 Sea-Doo Models

- 13.5psi @ 8,100rpm
- 14.5psi @ 8,500rpm

Description	Part No.
RIVA Sea-Doo XX-Charger	RS17080-IH-137-060



RIVA X-CHARGER PRO-SERIES IMPELLER AND HOUSING 255HP

Our X-Charger Impeller & Housing delivers a 20% increase in boost pressure at 8,000rpm producing arm

wrenching acceleration and increased top speed. High performance impeller & housing combo increase horsepower through superior impeller blade design and larger interior housing volume. Impeller features a sophisticated Vortech® blade design that is precision balanced to deliver smooth operation. Housing and impeller install easily onto stock supercharger base plate with no additional modifications required. Includes installation instructions.

**NOTE: Requires use of RIVA 50lb Fuel Injector Kit (part# RS12050-I-KIT-50 • page 12) with stock ECU or RIVA Racing ECU (page 13) FOR COMPETITION USE ONLY.*

Description	Part No.
Impeller and Housing, X-Charger, SD 255	RS17080-2M061



RIVA SEA-DOO XXX-CHARGER

Presenting the ultimate performance supercharger for Sea-Doo 215/255/260 engines! The all new RIVA XXX-Charger is a complete supercharger assembly featuring a sophisticated, lightweight 140mm Vortech impeller that is precision balanced to deliver smooth operation, a billet spacer, machined front & rear housings and RIVA Heavy Duty Clutch Washers. Increase interior volume produces huge performance gains delivering 15.5psi @ 8,500rpm.

Each XXX-Charger is hand assembled in-house using Genuine BRP shaft, bearings & hardware. Installs quickly in place of OEM supercharger. Requires RIVA Pro-Series ECU, RIVA Pro-Series Fuel Injectors (50lb) & RIVA Fuel Pressure Regulator Kit for correct calibration. Includes detailed installation instructions.

Applications: 215/255/260 Sea-Doo Models

- 14psi @ 8,100rpm
- 15.5psi @ 8,500rpm

Description	Part No.
RIVA Sea-Doo XXX-Charger	RS17050-SC-140-060

SEA DOO RXP RXP-X RXT RXT-X • SUPERCHARGER



RACE TECH RXP-X/RXT-X 255HP 137MM BILLET SC IMPELLER WITH 3MM SPACER

Engine-Tech supercharger impeller with spacer for the Sea Doo 255 hp X models. This CNC machined impeller makes 12.5+ lbs of boost at 8100 rpm and an incredible 13.5+ lbs at 8500 rpm! No other drop in impeller even comes close. It is made from heat treated 7075 aluminum and hard anodized for strength and corrosion resistance.

Description	Part No.
137MM+3 drop in SC Impeller with Spacer	ET137+3SCI



RACE TECH 68/140 EXTREME SUPERCHARGER

E-Tec 68/140 Supercharger. This is the most powerful supercharger available today. 15.5 to 16 lbs of boost @ 8700 rpm. This is a ready to use complete charger for all Sea Doo 4 tec supercharged watercraft. Includes billet 140mm E-Tec impeller with spacer, CNC machined housings, 2008 shaft kit with BT Tech 86000 rpm bearings and titanium carbonite coated clutch washers. Assembled with pre-set clutch slippage.

Description	Part No.
Race Tech 68/140 Extreme Supercharger	ET68/140SC



2011 APBA HOT PRODUCTS
MARK HAHN MEMORIAL HAVASU 300



613-95262

613-95261

R&D GREDDY BLOW OFF VALVE & 1" HOSE ADAPTER

R&D GReddy Blow Off Valve GReddy Blow Off Valves are easily adjustable to eliminate compressor surge and preventing premature boost

leakage, while increasing boost response. Each valve is made of durable cast and billet aluminum frame and the valve to diaphragm ratio provides performance that cheap piston types cannot offer. The spring stiffness adjustment screw and the three different sizes give the GReddy user the option to match vehicles with mild upgrades to heavily tuned engines. There are many factors in matching a blow-off valve to an application, valve location, turbocharger/supercharger size and pressure, but as a general rule of thumb, we recommend the Type RZ for 100-400hp. 1" Hose adapter sold separately.

Description	Part No.
R&D Greddy Blow Off Valve	613-95261
R&D 1" O.D. Hose Adapter	613-95262



RACE TECH 4" AIR INTAKE BILLET VELOCITY STACK

Race Tech's new billet velocity stack for the Sea Doo superchargers that allows the user to adapt a larger 4" air intake.

Description	Part No.
Race Tech 4" Air Intake Billet Velocity Stack	ET-VSS



R&D RXP SUPERCHARGER SLEEVE

The sleeving up of the diameter of the Supercharger enables a 3.5" or 4" intake filter system to be utilized. The larger intake increases cubic air volume as well as decreases air inlet restriction. A win win, supercharge your supercharger and give it more air! Available in 3.5" and 4" diameters.

Description	Part No.
RXP Supercharger Sleeve 3 1/2" Diameter	613-95035
RXP Supercharger Sleeve 4" Diameter	613-95040

SEA DOO 4 STROKE	INATKE SYSTEMS	ENGINE/ GASKETS	EXHAUST	DRIVE LINE HANDLING	ELECTRICAL	WATERLINE /BLIGE	STEERING & CONTROLS	BODY	ACCESSORIES	SERVICE TOOLS /HARDWARE	CHEMICAL
---------------------	-------------------	--------------------	---------	------------------------	------------	---------------------	------------------------	------	-------------	----------------------------	----------

SEA DOO RXP RXP-X RXT RXT-X • SUPERCHARGER

SEA DOO
4 STROKE

INTAKE
SYSTEMS

ENGINE/
GASKETS

EXHAUST

DRIVE LINE
HANDLING

ELECTRICAL

WATERLINE
/BILGE

STEERING
& CONTROLS

BODY

ACCESSORIES

SERVICE TOOLS
/HARDWARE

CHEMICAL

R&D's C1, C2 and C3 Monster Compressor Wheel for all Sea Doo 215 4 Tec engines will deliver "horsepower you can feel" with instant throttle response, improved mid range acceleration, and increased top end performance. The R&D Monster Wheel replaces the stock wheels inefficient long inducer, 6 blade design, with a modern low profile, high flow 8 blade w/splitter design.



R&D KIT/MODEL	STAGE C1	STAGE C2	STAGE C3
Part Number	613-94001	613-94002	613-94003
Description Application	C1 Monster Charger Wheel RXP/RXT/GTX 215	C2 Monster Charger Wheel RXP/RXT/GTX 215	C3 Monster Charger Wheel RXP/RXT/GTX 215
Compressor Housing Compressor Case Spacer	OEM, No modification None	OEM, No modification .040"	OEM, No modification .080"
Boost Pressure	2.5-3 over stock @8200rpm	2.5-3 over stock @8200rpm	3-4 over stock @8200rpm
Airflow	2 pound per minute gain	2.5 pounds per minute gain	2.5-3 pound per minute gain
Horse Power	20-25hp increase 2mph gain	25hp plus increase 2mph gain	25-30hp plus increase 2mph plus gain
Intercooler	Utilize OEM Intercooler	Utilize OEM Intercooler	Utilize OEM Intercooler
Gasoline	91 Octane Pump Gas	91 Octane Pump Gas	91 Octane Pump Gas

R&D's C4 & C5 Monster Compressor Wheel Kit for all Sea Doo 215 4 Tec engines will deliver 35-40 "X" type horsepower to the 2004-2008 RXT/RXP Sea Doo's to significantly increase overall performance. The R&D Monster Wheel Kit replaces the stock wheels inefficient long inducer, 6 blade design, with a modern low profile, high flow 8 blade w/splitter design with a 2mm larger inducer and increased blade tip height.



R&D KIT/MODEL	STAGE C4	STAGE C5
Part Number	613-94004	613-94005
Description Application	C4 Monster Charger Wheel & Housing RXP/RXT/GTX 215	C5 Monster Charger Wheel & Housing RXP/RXT/GTX 215
Compressor Housing Compressor Case Spacer	"X" OEM Front Compressor Housing .060"	"X" OEM Front Compressor Housing .080"
Boost Pressure	3-4 over stock @8200rpm	4-5 over stock @\$8200rpm
Airflow	3.5-3.75 pound per minute gain	4 pound per minute gain
Horse Power	35hp plus increase 3mph plus gain	40hp plus increase 3mph plus gain
Intercooler	Utilize OEM "X" or Aftermarket Intercooler Kit	Utilize OEM "X" or Aftermarket Intercooler Kit
Gasoline	91 Octane Pump Gas	91 Octane Pump Gas

*** For both the Stage C4 and Stage C5 kits:**

R&D suggests that the "X" or aftermarket intercooler kits be used as high boost pressures and high air volumes can dead head into the O.E.M. intercooler causing compressor surge. For closed course or endurance racing use using the rotax racing E.C.U. where rpms are between 8250 and 8500, R&D recommends the use of the X model or aftermarket intercooler system. Tests have proven the O.E.M. intercooler to have restrictions at 23.5 pounds of air, or 9.5 pounds of boost at sea level and 60-80 degrees.

SEA DOO RXP RXP-X RXT RXT-X • SUPERCHARGER

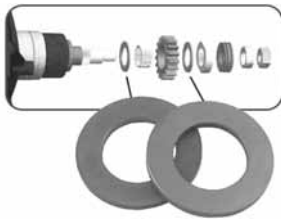

RIVA HEAVY-DUTY 04-07 RXP/RXT/GTX SC SUPERCHARGER CLUTCH WASHERS

These are direct replacements for the original clutch washers that are prone to fail on modified engines. Precision machined from tool grade steel to increase durability. Will not break up and damage engine at end of service life.

Description	Part No.
Riva Clutch Washers 04-05 RXP/RXT/GTX SC	RS1751-HDW-945
Riva Clutch Washers 06-07 RXP/RXT/GTX SC	RS1751-HDW-946*

**Note: RS1751-HDW-946 must be used with 2006 style Sea Doo OEM Supercharger shaft Part #420881946*



RIVA HEAVY-DUTY 08 RXP-X/RXT-X 255HP 08 RXP/RXT/GTX-SC 215HP SUPERCHARGER CLUTCH WASHERS

These are direct replacements for the original clutch washers that are prone to fail on modified engines. Precision machined from tool grade steel to increase durability. Will not break up and damage engine at end of service life.

NOTE: BRP recommends that you replace the Supercharger shaft/clutch assembly when servicing your supercharger.
Order part# 420881100 (08 spec). Requires 08 spec Heavy-duty Clutch Washers (part# RS1751-HDW-948).

Description	Part No.
Riva Clutch Washers 08 255hp RXP-X/RXT-X & 215hp RXP/RXT/GTX-SC	RS1751-HDW-948



R&D SUPERCHARGER HIGH PERFORMANCE CLUTCH WASHER KIT

The R&D High Performance Supercharger Clutch Washer Kit is a direct replacement upgrade for the very fragile factory BRP O.E.M. ceramic clutch washers that are and prone to fracture and disintegrate, which can result in costly engine damages. The R&D High Performance Clutch Kit is manufactured from a high strength, wear resistant bronze alloy material that has a yield strength of 32,000 psi plus, and a Rockwell hardness of B95. The R&D Superclutch was designed to improve reliability without disintegrating under the Sea Doo superchargers high rpms, heat and is designed to not only but also increase boost by decreasing clutch slippage.

Description	Part No.
R&D Clutch Washer Kit 06-07 RXP/RXT 215*	613-95001

**NOTE: (or any supercharger rebuilt or warranted with a BRP rebuild kit part #420881946 or #420881947) NOTE: BRP#420881946 is for 215 engines, and #420881947 is for 185 engines.*

R&D Clutch Washer Kit 03-04 GTX 185 S/C 04-05 RXP 215, 05 RXT 215	613-95002
--	-----------

**NOTE: BRP supercharger rebuilt kit installed, upgraded, or warranty updated with the BRP rebuild kits #420881947 (for 185) or #420881946 (for 215), these upgraded superchargers will require R&D PART # 613-95001*

R&D Clutch Washer Kit 08 RXP/RXT 215HP & RXP-X/RXT-X 255HP	613-95006
---	-----------



R&D SUPERCHARGER REBUILD TOOL KIT

R&D has designed a custom tool kit that is essential in the rebuilding process of the Sea Doo Supercharger. All tools are specific in application and are cnc machined to ensure a precision job.

Description	Part No.
185 Horsepower Tool Kit*	613-96001
215 Horsepower Tool Kit*	613-96002
A. Supercharger Holder Tool	613-96005
B. Bearing Puller/Installer Tool	613-96006
C. 4-Pin Socket	613-96007
D. Seal/Bearing Retainer Torx Wrench	613-96008
E. 215HP 16 Tooth Drive Gear Tool	613-96016
E. 185HP 17 Tooth Drive Gear Tool	613-96017
F. 185HP Clutch drive / Lock Washer Tool	613-96018
F. 215HP Clutch drive / Lock Washer Tool	613-96019

**NOTE: Kit comes with a S/C holder, bearing puller/installer tool, drive gear tool and clutch drive/lock washer tool.*



RIVA SEA DOO SUPERCHARGER SHAFT HOLDER TOOL

Servicing your supercharger in a snap. Ergonomically designed billet handle, heat treated tool-grade steel to resist wear and to prevent flexing.

Description	Part No.
RIVA Sea Doo Supercharger Shaft Holder Tool	RS1750-ISH-949

SEA DOO OEM TYPE SPECIALTY TOOLS

For the Removal, repair and installation of Sea Doo Superchargers.



Super Charger Retaining Key
Part No. 950-110
O.E. No. 529-035-949
All 4 Tec's with Super Chargers



4-Pin Socket
Part No. 950-195
O.E. No. 529-035-948
Fits: 4-Tec Supercharged



Torx Adapter For All Super Charged 4-Tecs
Part No. 950-185
O.E. No. 529-035-938
Fits: 4-Tec Supercharged



Support Plate 4-TEC Supercharged Engines
Part No. 950-190
O.E. No. 529-035-947
Fits: 4-Tec Supercharged



Ball Bearing Support Pusher
Part No. 950-200
O.E. No. 529-035-950
Fits: 4-Tec Supercharged



Camshaft Locking tool
Part No. 950-180
O.E. No. 529-035-939
Fits: 4-Tec Engines



SEA DOO
4 STROKE

INATKE
SYSTEMS

ENGINE/
GASKETS

EXHAUST

DRIVE LINE
HANDLING

ELECTRICAL

WATERLINE
/BLIGE

STEERING
& CONTROLS

BODY

ACCESSORIES

SERVICE TOOLS
/HARDWARE

CHEMICAL

SEA DOO RXP RXP-X RXT RXT-X • SUPERCHARGER



R&D RXP/RXP-X/RXT/RXT-X GTX-SC SUPERCHARGER SURGE PROTECTOR KIT

The R&D Surge Protector Kit will significantly improve supercharger clutch and compressor wheel performance and reliability by eliminating compressor surge. Compressor surge is defined as the negative charge of pressure that causes turbulence in the supercharger that occurs during aggressive or off-throttle operations. When the throttle valve is abruptly closed at high rpms, however the engine decelerates quickly down from 8,000 rpms, however the supercharger is compressing air (creating boost) as the supercharger has to decelerate from 42,000 rpms. This turbulence is the primary cause of undue stress on the supercharger clutch system and its components. The R&D surge protection kit utilizes an automotive vacuum assisted Bosch pressure blow off valve that automatically releases the unwanted intake pressure between the closed throttle valve and the supercharger. As soon as the throttle valve is opened, the blow off valve immediately closes and the compressor can supply its full boost potentials to the engine.

Manufactured from high-temperature silicone hose with an integrated molded riser for the blow off valve to function without hindering intake flow or velocity. The R&D kit installs easily in place of the OEM rubber intake elbow joint. This kit is a very necessary and cost effective up-grade for all Sea Doo supercharged watercraft. Kit comes completely assembled with silicone elbow, blow off valve, R&D B.O.V. filter, mounting hardware and instructions.

Description	Part No.
A. R&D RXP 215/RXT 215, GTX-SC SC Surge Protector Kit	613-95003
B. R&D RXP-X 255/RXT-X 255 SC Surge Protector Kit	613-95255



R&D RXP-X/RXT-X 255 SILICONE INTAKE HOSE KIT

The R&D Supercharger High Performance Hose Kit was developed while testing the R&D Monster Compressor Wheel Kits. Higher boost pressures create higher intake air temperatures of up to 235 degrees. The O.E.M. standard black rubber hose and standard hose clamps just do not hold up to the pressures and heat like high quality, high temperature silicone hose and high strength stainless steel style hose clamps. The R&D "Blue Hose" is manufactured from high performance, turbo charger quality high-temperature silicone.

Sea Doo	Part No.
R&D RXP-X/RXT-X 255 Silicone Intake Hose Kit	613-95256



RIVA PRO-SERIES BLOW-OFF VALVE KIT

For use with RS17080-ICUK or RS1751-PC Kits installed on 255hp Sea Doo Stage I & above or 215hp Sea Doo Stage III & above.

Description	Part No.
Riva Pro-Series Blow-Off Valve Kit	RS17080-BV-PS



RIVA PERFORMANCE BLOW-OFF VALVE KIT

For use with RS17080-ICUK or RS1751-PC Kits installed on 215hp Sea Doo Stage I & II

Description	Part No.
RIVA Performance Blow-Off Valve Kit	RS17080-BV-PF



RIVA SD 215/255 BLOCK-OFF KIT, SD BLOW-OFF VALVE

For use with RS17080-ICUK or RS1751-PC Kits.

Description	Part No.
Riva SD 215/255 Block-off Kit, SD Blow-off Valve	RS1750-BVBO



RIVA SD SUPERCHARGER BLOW-OFF VALVE KIT

Our Blow-off Valve Kit improves supercharger reliability and performance

by relieving unwanted pressure during off-throttle operation. Reduces supercharger clutch wear and eliminates heat soak in discharge tube. High-strength silicone hose with integrated blow-off valve installs easily in place of OEM elbow joint. Includes K&N filter to prevent debris from entering valve outlet. A simple and cost effective upgrade for both stock and modified supercharged engines. Includes all necessary mounting hardware and installation instructions.

Description	Part No.
Blow-off Valve Kit S/C, RXP/RXT/GTX-SC	RS1750-BV

SEA DOO RXP RXP-X RXT RXT-X • INTERCOOLER



RIVA POWER COOLER KIT 215HP

Presenting the ultimate aftermarket intercooler system for the Sea Doo 215hp engine! The RIVA 'GEN-2' Power Cooler is our next generation intercooler system featuring a new "double wide" cooler element for maximum efficiency. Delivers an increase of 18 peak horsepower over original intercooler providing arm-wrenching results on the water. The 'GEN-2' Power Cooler features a large, unrestricted core that exhibits minimal pressure loss. The cooling element is dramatically more efficient than the stock unit with exit temperatures averaging 50°F cooler than stock. This delivers cooler, denser air for increased performance throughout the RPM range. Includes integrated blow-off valve mount that will accept RIVA Blow-Off Valve kits (sold separately) for improved supercharger reliability and performance. Use of Blow-Off Valve also reduces supercharger clutch wear and eliminates heat soak in discharge tube or the buyer has the choice to purchase the RIVA Blow-Off Valve Block-off kit. Power Cooler Kit contains all necessary mounting hardware and installation instructions.

Requires use of RIVA Rear Exhaust Kit (RS15050-ET, RS15050-1) and RIVA O.P.A.S. Block-off Kit (Performance or Pro-Series • RS29950, RS29985, RS29050-1).

RIVA Blow-off Valve Kit Application Chart:

- 215hp Sea Doo Stage I & II: RIVA Performance Blow-Off Valve Kit (RS17080-BV-PF)
- 215hp Sea Doo Stage III & above: RIVA Pro-Series Blow-Off Valve Kit (RS17080-BV-PS)
- RIVA Blow-Off Valve Block-off Kit (RS1750-BVBO)

Description	Part No.
RIVA GEN-II Power Cooler Kit	RS1751-PC

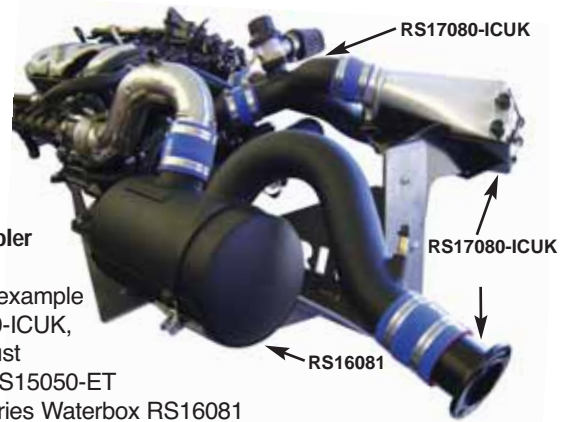

OEM Intercooler Upgrade Kit
Installation example of RS17080-ICUK, Rear Exhaust Outlet Kit RS15050-ET and Pro-Series Waterbox RS16081



RIVA OEM INTERCOOLER UPGRADE KIT (255HP)

Riva intercooler Upgrade Kit for the new RXP-X & RXT-X relocates the original intercooler and significantly improves efficiency of the system with upgraded components. Key benefits include:

- Relocation of original intercooler: By strategically moving original intercooler, we have greatly improved access to engine compartment. Relocation also allows installation of key performance parts including RIVA Rear Exhaust Kit (RS15050-1) & RIVA Pro-Series Power Filter Kit (RS13056).
- Precision formed aluminum tubing: Our high strength aluminum tubes are shorter than original to minimize boost loss. Also, the rigid aluminum will not swell under pressure like original soft rubber hoses providing improved throttle response.
- Integrated blow-off valve mount: Intercooler tubing includes mount for RIVA Pro-Series Blow-Off Valve Kit (RS17080-BV-PS) or RIVA Blow-Off Valve Block-off Kit (RS17050-BVBO); both sold separately. Kit includes sturdy aluminum intercooler mounting bracket, high strength mandrel bent aluminum tubing and all necessary mounting hardware & installation instructions. Requires installation of RIVA Rear Exhaust Kit (RS15050-1) and RIVA Performance OPAS Block-off Kit (RS29050-1).

Description	Part No.
RXP-X/RXT-X Stock Intercooler Upgrade Kit	RS17080-ICUK

SEA DOO 4 STROKE	INATKE SYSTEMS	ENGINE/ GASKETS	EXHAUST	DRIVE LINE HANDLING	ELECTRICAL	WATERLINE /BILGE	STEERING & CONTROLS	BODY	ACCESSORIES	SERVICE TOOLS /HARDWARE	CHEMICAL
------------------	----------------	-----------------	---------	---------------------	------------	------------------	---------------------	------	-------------	-------------------------	----------

SEA DOO RXP RXP-X RXT RXT-X • EXHAUST



RIVA RXP / RXT REAR EXHAUST KIT WITH STOCK INTERCOOLER SYSTEM

Kit allows removal of restrictive suppression system located between waterbox and hull exit. Improves engine performance by reducing back pressure and restriction. Strategically placed fitting injects water just before exhaust exit to suppress sound level. Includes custom molded exhaust tube, billet through-hull exhaust outlet and OE exhaust block-off along with all necessary mounting hardware and installation instructions. **Removal of O.P.A.S. and installation of RIVA Performance O.P.A.S. Block-off Kit (part # RS29050-1) is necessary to accommodate installation of RIVA Rear Exhaust Kit for all models.**

Description	Part No.
Rear Exhaust Kit RXP/RXT 215, GTX-SC (04-07), RXP-X/RXT-X 255*	RS15050-1
Performance Kit, OPAS Removal RXP/RXT 215, GTX, RXT 215/RXT-X 255	RS29050-1
OEM Intercooler Upgrade Kit RXP-X/RXT-X 255 HP	RS17080-ICUK

**NOTE: RXP-X/RXT-X 255 models require use of OEM Intercooler Upgrade Kit (RS17080-ICUK • page 9) along with OPAS Block-off kit (RS29050-1 • page 18).*



OEM Intercooler Upgrade Kit
Installation example of RS17080-ICUK, Rear Exhaust Outlet Kit RS15050-ET and Pro-Series Waterbox RS16081



RIVA PRO-SERIES SEA DOO 215/255 HP WATER BOX

Riva's Pro-Series Sea Doo Water Boxes deliver increased horsepower and performance by reducing exhaust restriction and back pressure.

Developed on a flow bench, our water boxes feature radiused exhaust tubes and end caps for optimum exhaust flow. Innovative short design allows easy servicing of supercharger without removal of exhaust system. High strength aluminum construction & precision welds will survive backfires & overheating. Powder coated to prevent corrosion. Includes detailed installation instructions.

Note: Requires use of RIVA O.P.A.S. Block-off Kit (Performance RS209050-1 • page 18 or Pro-Series RS29950/RS29985 • page 18) as well as RIVA Rear Exhaust Outlet Kit (part# RS15050-ET). Will directly replace and upgrade RIVA Rear Exhaust Kit (part# RS15050-1) utilizing existing rear exhaust outlet installation.

Description	Part No.
Waterbox Sea Doo 215/255HP '08 & newer except IS models	RS16081
Waterbox Sea Doo 215HP '07 and older models	RS16082
Rear Exhaust Outlet Kit Sea Doo 215 & 255 Models for aftermarket intercooler systems or waterbox	RS15050-ET
Pro-Series O.P.A.S. Block off RXP, RXP-X	RS29950
Pro-Series O.P.A.S. Block off RXT, RXT-X	RS29985
RXP/RXT Performance Block off	RS29050-1



RIVA SEA-DOO RXT-X 260 REAR EXHAUST KIT

Our rear exhaust kit for Sea-Doo RXT-X 260 delivers performance and cutting-edge style. Allows for removal of restrictive sound suppression system located between water box and hull exit. Improves engine performance by reducing back pressure and restriction. Includes mandrel bent aluminum exhaust tube that is powder coated to prevent corrosion, large billet through-hull exhaust outlet, billet OEM exhaust outlet block-off and high-temp silicone couplers along with all necessary mounting hardware & installation instructions. Fits 2010-2011 RXT-X 260 only (does not fit iS & aS models).

Description	Part No.
RIVA Sea-Doo RXT-X 260 Rear Exhaust Kit	RS15100

RIVA REAR EXHAUST OUTLET KIT FOR AFTERMARKET INTERCOOLER OR WATERBOX

Kit allows you to relocate exhaust outlet to rear of craft when using aftermarket intercooler systems or water boxes. Includes billet through-hull exhaust outlet and OE exhaust outlet block-off along with all necessary mounting hardware. Fits all RXP/RXT/GTX/RXP-X/RXT-X Supercharged models.

Description	Part No.
Rear Exhaust Outlet Kit SD 215/255 Models	RS15050-ET



R&D BILLET EXHAUST OUTLET

The new R&D Billet Exhaust Outlet.

Description	Part No.
3" Diameter R&D Billet Exhaust Outlet	331-30000
2.75" Diameter R&D Billet Exhaust Outlet	331-32750



R&D HIGH TEMPERATURE SILICON COUPLINGS

Description	Part No.
3" - 3" High Temp Silicon Couplings	061-30030
3" - 2" Reducer High Temp Silicon Couplings	061-32500
2.75" - 2.5" Reducer High Temp Silicon Couplings	061-32501
3" - 2.75" Reducer High Temp Silicon Couplings	061-32750

SEA DOO RXP RXP-X RXT RXT-X • EXHAUST



RS16050-01-04/07, RXP
RS16055-01-05/07, RXT



RS16080
RXP-X/RXT-X

RIVA FREE FLOW EXHAUST KITS

Replaces the restrictive sound suppression system located between the water box and hull exit on your watercraft. Improves engine performance by reducing back pressure and harmful detonation. Includes mandrel bent aluminum tubing that is powder coated to prevent corrosion, high-temp silicone replacement coupler and installation instructions.

Description	Part No.
Free-Flow Exhaust Kit RXP-X/RXT-X	RS16080
Free-Flow Exhaust Kit RXP 04-06	RS16050-01-04
Free-Flow Exhaust Kit RXP 07-08	RS16050-01-07
Free-Flow Exhaust Kit RXT 05-06	RS16055-01-05
Free-Flow Exhaust Kit RXT 07-08	RS16055-01-07



RIVA SEA-DOO S3 FREE FLOW EXHAUST KIT

Replaces the restrictive sound suppression system located between the water box and hull exit on your watercraft. Improves engine performance by reducing back pressure and harmful detonation. Includes mandrel bent aluminum tubing that is powder coated to prevent corrosion, high-temp silicone replacement coupler and installation instructions. Fits all Sea-Doo models with S3 hulls including iS & aS units.

Description	Part No.
RIVA Sea-Doo S3 Free Flow Exhaust Kit	RS16090



R&D RXP-X/RXT-X 255HP MODEL FREE-FLOW EXHAUST

The new R&D Free-Flow Exhaust Kit eliminates the power robbing sound suppression system allowing the exhaust to travel out of the water box with zero restriction and back pressure. Improves acceleration and top speed.

Description	Part No.
R&D RXP-X/RXT-X 255HP Model Free-Flow Exhaust	333-80255



R&D EXHAUST MANIFOLD X-TENDER KIT

The R&D Exhaust X-Tender Kit allows the exhaust to be extended 1.5 inches which will move the water muffler back 1.5 inches creating enough room to be able to change out a supercharger (Hot) in 5 minutes. No more hassling with extremely hot exhaust pipes, water mufflers and V-band clamps! The X-TENDER kit installs easily using an additional V-band clamp. Install the R&D Exhaust X-TENDER kit in place and never hassle a supercharger change out again. Once installed and used you will wonder why the factory didn't build it this way! The R&D kit will install directly to all RXT/RXP/GTX supercharged model Sea Doo's using O.E.M. BRP hardware.

Description	Part No.
Exhaust Manifold X-Tender Kit RXP, RXT 215HP	613-95004



R&D RXP-X EXHAUST MANIFOLD X-TENDER / O2 SENSOR MOUNT KIT

The R&D High Performance Exhaust Manifold X-Tender with O2 Sensor Mount Kit is a creative and unique product that was designed and developed while testing the R&D Superclutch and new R&D High Performance Compressor Wheels. The Sea Doo supercharger and exhaust systems parts and "J" pipe are extremely difficult to get to and handle when they are extremely hot, and the exhaust systems "J" pipe that must be removed can be tricky on a cold engine. R&D needed to be able to remove and replace the supercharger in five minutes to be able to test products back to back in a timely manner, as well as the same day for accurate testing data. The R&D Exhaust X-Tender Kit allows the exhaust to be extended 2 inches which will move the water muffler back 2 inches creating enough room to be able to change out a supercharger (Hot) in 5 minutes. No more hassling with extremely hot exhaust pipes, water mufflers and V-band clamps! An additional bonus is the oxygen sensor mount incorporated into the X-Tender, allowing quick and easy installation of an AFR Gauge (Air/Fuel Ratio) for properly tuning the X power plant. The X-Tender kit installs easily using an additional OEM V-band clamp. Install the R&D Exhaust X-Tender kit in place and never hassle a supercharger change out again. Once installed and used you will wonder why the factory didn't build it this way! The R&D X-Tender is manufactured from the highest grade stainless steel exhaust material available. The R&D kit will install directly to all Sea Doo X supercharged models using O.E.M. BRP hardware. You will need to purchase an extra OEM V band clamp. One is not provided.

Description	Part No.
R&D Exhaust Manifold X-Tender / O2 Sensor Mount Kit	333-80155

SEA DOO 4 STROKE	INAKE SYSTEMS	ENGINE/ GASKETS	EXHAUST	DRIVE LINE HANDLING	ELECTRICAL	WATERLINE /BILGE	STEERING & CONTROLS	BODY	ACCESSORIES SERVICE TOOLS /HARDWARE	CHEMICAL
---------------------	------------------	--------------------	---------	------------------------	------------	---------------------	------------------------	------	---	----------

SEA DOO 4 STROKE
INTAKE SYSTEMS
ENGINE/GASKETS
EXHAUST
DRIVE LINE HANDLING
ELECTRICAL
WATERLINE /BILGE
STEERING & CONTROLS
BODY
SERVICE TOOLS ACCESSORIES
HARDWARE
CHEMICAL



RXT-X RRFPR FUEL PRESSURE REGULATOR

Universal bypass rising rate fuel pressure regulator for EFI fuel systems applications. Base fuel pressure is adjustable from 20 to 60 PSI with high pressure spring (installed). Ideal for EFI bypass applications where more flow and superior pressure control are desired. R&D offers high performance Coast Guard approved fuel hose that can be purchased by the foot (PT#611-27502), as well as the Otekier style clamps (Pt#611-27518).

The universal type bypass style regulator is capable of handling any fuel pump up to 250 GPH. Replace "Deadhead" regulator performance and experience the full flow volume and rock steady fuel pressure that only a dynamic R&D fuel pressure regulator kit can produce. Available for Sea-Doo, Yamaha, and Kawasaki watercraft.

Sea Doo	Part No.
RXT-X RRFPR Fuel Pressure Regulator	803-81000



RIVA RISING RATE FUEL PRESSURE REGULATOR KIT

Riva's Fuel Pressure Regulator Kits provide the precision pressure control necessary to compliment a variety of performance applications. Kits are fully assembled & mount securely via sturdy stainless steel bracket. High quality billet pressure regulator can adjust base pressure from 25 to 80 PSI. Unit can also be set up as rising rate fuel pressure regulator at a 1 to 1 ratio providing one additional pound of fuel pressure for every pound of boost gain. Plugs directly into original fuel system with OEM connectors and features a large 3/8" fuel return line. Includes integrated liquid-filled pressure gauge and billet Fuel Pressure Regulator Block-off necessary for removal of stock fuel pressure regulator. Key Features Include:

- Precision fuel pressure control with optional rising rate function.
- High quality stainless steel liquid-filled pressure gauge.
- Large 3/8 fuel return line.
- Billet Fuel Pressure Regulator Block-off.
- Easy bolt-on installation with OEM fuel connectors.
- Complete installation instructions & tuning guide.

Description	Part No.
RIVA Fuel Regulator Kit - 07 & Older 215	RS12050RRFPR07
RIVA Fuel Regulator Kit 08 & Newer 215/255 (except i-Control)	RS12050RRFPR08



SEA DOO POWERSHOT ADJUSTABLE FUEL TUNER

The R&D Powershot fuel injection tuner will deliver increased horsepower, acceleration, and stronger mid-range performance by delivering a higher performing air to fuel ratio (A.F.R.) to the engine. Many of today's high performance fuel injected four stroke muscle craft have a lean A.F.R. R&D Performance has tested, documented, and analyzed the O.E.M. fuel maps on every current fuel injected four stroke watercraft, and pre-programmed and coded the new R&D Powershot fuel injection control module to safely alter the O.E.M. fuel map to a higher performing and safer A.F.R. (richer). More horsepower, greater acceleration and stronger mid-range are the result when the proper A.F.R. is achieved and is tuned for optimum performance.

The R&D Powershot is fully adjustable on the fly (with the engine running, observed and tuned while riding), and will accommodate a wide range of adjustability to properly performance tune the A.F.R. for any combination of aftermarket parts. The R&D Powershot will add horsepower, reliability, and adjustability to any electronic fuel injected two or four stroke watercraft engine.

Description	Part No.
R&D RXP/RXT 215HP Powershot Adj. Fuel Tuner	803-95002
R&D RXP-X/RXT-X 255HP Powershot Adj. Fuel Tuner	803-95003



INNOVATE LC-1 WIDEBAND AIR/FUEL RATIO KIT

Professionally tune your engine with complete confidence. The LC-1 is more accurate than conventional designs costing many times as much, and its self-calibrating circuitry can compensate for changes in temperature, altitude and sensor condition. The LC-1 is ideal for applications such as Dynos, Data Acquisition, Standalone ECUs, piggyback fuel controllers, OBD-II software or chip programmers and gauges. This Innovate kit comes complete with the patented award-winning LC-1 Wideband Controller with a sealed cable, DB-Blue digital Gauge, Bosch 5-wire Wideband O2 Sensor, Bung/Plug Kit, Software CD, and quick start guide. Take the guess work out of tuning, recommend by R&D to tune all high performance 4-stroke watercraft.

Sea Doo	Part No.
Innovate LC-1 Wideband Air/Fuel Ratio Kit	900-04378



RIVA PRO-SERIES SEA DOO FUEL INJECTORS

Riva's high performance fuel injectors supply modified Sea Doo engines with additional fuel.

50lb injectors are for use with RIVA Racing ECU for correct calibration. Available in three piece kit.

Description	Part No.
RIVA Pro-Series SD Fuel Injectors (3-pc kit)	RS12050-I-KIT-5
215HP RXP/RXT/05-08 GTX-SC Ltd., RXP-X/RXT-X 255HP	

SEA DOO RXP RXP-X RXT RXT-X • FUEL • ENGINE



RIVA SEA DOO PRO-SERIES ECU

Our Pro-Series Racing ECU delivers a huge performance advantage to the Sea Doo 255 & 215 Supercharged Intercooled engines. ECU is calibrated for Stage II & III applications and must be used with RIVA Pro-Series 50lb Fuel Injector Kit, RIVA Valve Train Upgrade Kit and 91+ octane pump fuel. Plugs directly into factory wiring harness in place of stock ECU. Key benefits include:

* **Performance Fuel Mapping:** Delivers optimal fuel required for your specific level of modification (Stage II or III) based on boost pressure.

* **Performance Timing Curves:** Special racing curves produce more power throughout the RPM range. Timing is automatically adjusted based on sensor input.

* **Rev Limiter Increase:** Stock rev limit has been increased from 8,300 to 8,650 RPM. With our recommended pump combination, engine RPM can be run higher producing more boost pressure and horsepower.

* **Practice Key:** In addition to normal "full power" key, a 60 MPH "practice" key can be programmed by BRP dealer BUDS system to limit speed for race-course practice. ECU does not support original "learning" key mode.

* Retains Engine Diagnostic & Primary Safety Functions:

- 1) Provides diagnostic information displayed on dash instrumentation along with more detailed data through BRP dealer B.U.D.S. system.
- 2) Sensor input is monitored for abnormal readings and will react by triggering warnings and/or limp mode.

**NOTE: This product is for competition use only. Must be used with RIVA Pro-Series 50lb Fuel Injector Kit (part #RS12050-I-KIT-50 • page 18), RIVA Valve Train Upgrade Kit and 91+ octane pump fuel. Unit must be activated in watercraft by an authorized BRP dealer using BUDS system. Activation by RIVA Racing available with customer supplied throttle body. Installation of this racing product will void BRP factory warranty.*

Description	Part No.
Pro-Series ECU 06 RXP/RXT	RS11850-01-B
Pro-Series ECU 08 255 RXP-X	RS11850-01-C
RXT-X, 07-08 215 RXP/RXT	
Injector Kit, Pro-Series, 50lb, SD 255/215	RS12050-I-KIT-50
Valve Train Upgrade Kit SD 4-TEC all	RS19050-VTU



RIVA PRO-SERIES SEA DOO I-CONTROL ECU

Riva has developed new ECU's for the new Sea Doo i-Control watercraft. Both units plug directly into factory wiring harness in place of the stock ECU.

i-Control RACE ECU: Delivers huge performance advantage to modified craft. Programmed with new fuel, timing & rev limit to accept high boost engine modifications. Requires use of Riva Valve Train Upgrade Kit & replacement fuel injectors. **FOR COMPETITION USE ONLY.**

i-Control PERFORMANCE ECU: Eliminates the OEM GPS controlled speed limiter function opening the door to increased speed & performance. Increases top speed by 3+ mph (US models) with no additional modifications. Absolutely essential for all i-Control performance upgrades.

(Available August 2011)

Description	Part No.
Riva i-Control 260/255 ECU Race Series	RS11890-01-A
Riva i-Control 260/255 ECU Performance Series	RS11890-01-B



RIVA SEA DOO SPEED CONTROL OVERRIDE MODULE

The RIVA Speed Control Override Module removes

the restrictive GPS speed control function on Sea-Doo iControl models delivering significant increases in top speed with stock ECU. Easy to install module allows system to start in "Sport Mode" for maximum performance. "Touring Mode" can be manually selected after start up.

Key Features:

- Removes GPS controlled speed limiter.
- Increases top speed utilizing stock ECU.
- Works on all 2010~11 255/260hp iControl models.
- U.S. models will gain 3mph with no other modifications.
- Allows further top speed gains through aftermarket modifications.
- Allows system to start in "Sport Mode".
- Easy plug-in installation into the diagnostic port on the stock wiring harness.

Description	Part No.
2010i Speed Control Override Module	RS11090-SCOM-10
2011i Speed Control Override Module	RS11090-SCOM-11



RIVA RXP/RXT/GTX THERMOSTAT KIT

Our cool running Thermostat Kit reduces the operating temperature of your modified 4-Tec® engine by 30°F for maximum reliability and performance. Kit includes replacement thermostat, billet coolant inlet flange, stock thermostat removal tool, Oetiker® clamps, Oetiker® pliers and detailed installation instructions.

**NOTE: Thermostat housing (shown above) not included.*

Description	Part No.
Thermostat Kit, SD RXP/RXT/GTX	RS1015



RIVA PRO-SERIES 4-STROKE CYLINDER HEAD STUD KITS

Riva's ultra high strength cylinder head stud kit is essential equipment when upgrading internal components on your high boost Yamaha engine. Precision machined from premium grade 8740 alloy and heat treated to exacting tolerances, these studs dramatically increase reliability & ease of maintenance. Key Benefits Include:

- Superior material & heat treat process provides 10X better strength than OEM
- Studs provide improved alignment of cylinder head and gasket
- More accurate & consistent torque loading provides a more uniform clamping force on head gasket.
- Helps prevent blown head gaskets and assures optimum engine sealing.

Description	Part No.
RIVA Pro-Series Cylinder Head Stud Kits	RS10050-HSK
Sea Doo 260/255/215	

SEA DOO
4 STROKE

INATKE
SYSTEMS

ENGINE/
GASKETS

EXHAUST

DRIVE LINE
HANDLING

ELECTRICAL

WATERLINE
/BILGE

STEERING
& CONTROLS

BODY

ACCESSORIES

SERVICE TOOLS
/HARDWARE

CHEMICAL

SEA DOO RXP RXP-X RXT RXT-X • ENGINE

SEA DOO
4 STROKE
INTAKE
SYSTEMS
ENGINE/
GASKETS
EXHAUST
DRIVE LINE
HANDLING
ELECTRICAL
WATERLINE
/BILGE
STEERING
& CONTROLS
BODY
ACCESSORIES
SERVICE TOOLS
/HARDWARE
CHEMICAL



PRO-X OEM REPLACEMENT FOUR STROKE PISTONS

Sea Doo	Part No.
SD RXP 04-09/RXT 05-09/RXP-X 08-09 Standard	01.5594.000
SD RXP 04-09/RXT 05-09/RXP-X 08-09 .50mm	01.5594.050
SD RXP 04-09/RXT 05-09/RXP-X 08-09 1.0mm	01.5594.100



RIVA PRO-SERIES 4-STROKE RACING PISTONS

Riva's forged racing pistons deliver maximum reliability and performance in high boost & turbo applications. High strength piston kits include premium ring package, tool steel wrist pin & carbon steel wire locks.

Key Features Include:

- CNC machined from high strength/lightweight forgings.
- Optimized dome design for efficient combustion.
- Improved lubrication hole placement for reduced friction.
- Premium low friction ring package.
- High-strength tool steel wrist pins machined from special tool steel bar stock & heat treated.
- Carbon steel wire locks.
- Direct replacement diameter plus 2 oversizes available.

8.4 to 1 Compression	Size	Part No.
260/255/215 (8.4:1/STD)*	99.94mm	RS1001-1503-8.4
260/255/215 (8.4:1/.010)*	100.19mm	RS1001-1503-8.4-010
260/255/215 (8.4:1/.020)*	100.44mm	RS1001-1503-8.4-020

**IJSBA/APBA Stock Class Legal*

9.5 to 1 Compression	Size	Part No.
260/255/215 (9.5:1/STD)	99.94mm	RS1001-1503-9.5
260/255/215 (9.5:1/.010)	100.19mm	RS1001-1503-9.5-010
260/255/215 (9.5:1/.020)	100.44mm	RS1001-1503-9.5-020



RIVA SEA DOO VALVE TRAIN UPGRADE KIT

Riva's Valve Train Upgrade Kit increases the reliability of your modified engine by reducing the possibility of valve float at high rpm. Includes lightweight, precision-machined titanium valve retainers, racing valve springs, base washers and OE rocker arm shaft bolts that must be replaced during installation.

Description	Part No.
RXP/RXT/GTX Valve Train Upgrade Kit	RS19050-VTU



PRO-X SEA DOO OEM REPLACEMENT STEEL VALVES

Manufactured by the leading OEM factories in Japan. Made to exact OEM specs and tolerances. The steel valves are a direct and cost efficient OEM replacement.

Sea Doo	Part No.
Pro-X Sea Doo Exhaust Valves	28.5594-1
Pro-X Sea Doo Intake Valves	28.5594-2

**Pro-X Sea Doo Performance Valves are sold piece.*



RIVA SEA-DOO HIGH PERFORMANCE VALVE SET

Replaces the restrictive sound suppression system located between the water box and hull exit on your watercraft. Improves engine performance by reducing back pressure and harmful detonation. Includes mandrel bent aluminum tubing that is powder coated to prevent corrosion, high-temp silicone replacement coupler and installation instructions. Fits all Sea-Do models with S3 hulls including iS & aS units.

Description	Part No.
RIVA Sea-Do High Performance Valve Set (Standard/Drop-in)	RS19050-HPV-0
RIVA Sea-Do High Performance Valve Set (+1mm Intake / +2mm Exhaust)	RS19050-HPV-1:2



VALVE COMPRESSION, TOOL SD 4-TEC

Our overhead Valve Compression Tool allows easy removal of valve springs and keepers without removing cylinder head. Includes compression adapter to pressurize cylinder keeping valves in place during removal of stock springs and keepers.

Description	Part No.
4-TEC Valve Compression Tool	RS19050-VCT



RIVA SEA DOO STOCK VALVE RETAINER KIT

Riva's Valve Retainer Upgrade Kit increases the reliability of your engine by reducing the possibility of valve float at high rpm. Includes 12 lightweight, precision-machined titanium valve retainers and 6 OE rocker arm shaft bolts that must be replaced during installation. A must for IJSBA & APBA Stock Class race craft.

Description	Part No.
Riva Stock Valve Retainer Kit SD RXP/RXT/GTX	RS19050-SRU

SEA DOO RXP RXP-X RXT RXT-X • ENGINE



RIVA/CARRILLO CONNECTING RODS

Riva's lightweight connecting rods improve the reliability and performance of turbocharged and supercharged water-craft engines. Manufactured to our specifications by Carrillo Industries, these rods

are forged from an ultra high-strength alloy and rated to 500+ horsepower. Unique H-beam design is substantially stronger and lighter than OEM equipment, allowing your engine to rev quicker and hold up to the punishing demands of high boost applications. Includes high-strength silicon-bronze wrist pin bushing & race spec fasteners.

Stock Rod Weight 622gr - Riva/Carrillo Rod weight 454gr

Description	Part No.
Riva/Carrillo Connecting Rod Set	RS19050-8M4724S
Sea Doo 255/215 HP (Sold 3 per set)	



RIVA PRO-SERIES 4-STROKE CYLINDER HEAD GASKETS

Riva's Pro-Series Cylinder Head Gaskets were developed to

withstand severe heat & pressure generated by high-boost and high horsepower applications delivering maximum reliability to your racing engine.

Key Benefits Include:

- Three layer stainless construction for durability & corrosion resistance.
- Viton coated & embossed surfaces for maximum sealing.
- Unique design promotes even torque & requires no re-torque.

Description	Part No.
Riva Pro-Series Head Gasket Standard	RS10050CHG1503
Sea Doo 260/255/215	

GASKET TECHNOLOGY SEA DOO 4-TEC GASKETS & GASKET KITS

Description	OEM No	Part No.
Aluminum Washer Kit	----	6943K
4-Tec Top Kit	----	6980K
4-Tec Complete Kit With Seals	----	6990K
Head	420950770	6900*
Valve Cover	420950820	6905*
Oil Pump Housing	420950970	6910*
Oil Separator Cover	420630540	6915*
Timing Drive Cover	420931130	6920*
Oil Seal	420650310	6956
Output Sleeve Seal	420630550	6958
Oil Pump O-Ring	420631480	6959
Intake O-Ring - 3 Required	420950740	6960
Intake O-Ring Kit	----	6961K
Seal Kit	----	6962K

* Denotes when the gasket is included in the Top End Gasket set.

SEA DOO OEM TYPE SPECIALTY TOOLS

For the installation and removal of pistons, rocker arms, cam chain and cam gear.



Crankshaft Locking Tool
Part No. 950-125
O.E. No. 529-035-821
Fits: All 4 Tec



Camshaft Locking tool
Part No. 950-180
O.E. No. 529-035-839
Fits: 4-Tec Engines

MONKEY GRIP MOTOR MOUNTS

57-1187



57-1188



Part No. 57-1187 (Front - 1 required)

Sea Doo GTX 4-TEC	02-07
Sea Doo GTX 4-TEC WAKE	04-07
Sea Doo GTX 4-TEC SC	03-06
Sea Doo GTX 4-TEC LTD SC	03-04
Sea Doo GTX 4-TEC LTD	06
Sea Doo GTX 4-TEC LTD SCIC	05
Sea Doo GTX LTD & WAKE BVIC	07
Sea Doo RXP	05-07
Sea Doo RXP SC	04-06
Sea Doo RXP BVIC	07
Sea Doo RXT	05-06
Sea Doo RXT BVIC	07

Part No. 57-1188 (Rear - 2 required)

Sea Doo GTI	06-07
Sea Doo GTI RENTAL	06-07
Sea Doo GTI RFI	04-05
Sea Doo GTI LE RFI	04-05
Sea Doo GTI SE	06-07
Sea Doo GTI 4-TEC SE NA	07
Sea Doo GTX 4-TEC	02-07
Sea Doo GTX 4-TEC SC	03-06
Sea Doo GTX 4-TEC SCIC	05
Sea Doo GTX 4-TEC LTD SC	06
Sea Doo GTX 4-TEC LTD SC	03-04
Sea Doo GTX LTD BVIC	07
Sea Doo GTX 4-TEC WAKE	03-07
Sea Doo RXP	05-07
Sea Doo RXP BVIC	07
Sea Doo RXP SC	05
Sea Doo RXT	05-06
Sea Doo BVIC	07

SEA DOO OEM TYPE SPECIALTY TOOLS

For the installation and alignment of Sea Doo engines.



Alignment Shaft
Part No. 950-140
O.E. No. 295-000-141
Fits: All Models



Alignment Adaptor
Part No. 950-150
O.E. No. 529-035-719
Fits: GTX 4-Tec Models



Alignment Support Plate kit
Part No. 950-135
O.E. No. 529-035-506
Fits: All Models

SEA DOO
4 STROKE

INATKE
SYSTEMS

ENGINE/
GASKETS

EXHAUST

DRIVE LINE
HANDLING

ELECTRICAL

WATERLINE
/BILGE

STEERING
& CONTROLS

BODY

ACCESSORIES
SERVICE TOOLS

HARDWARE

CHEMICAL

SEA DOO
4 STROKE

INTAKE
SYSTEMS

ENGINE/
GASKETS

EXHAUST

DRIVE LINE
HANDLING

ELECTRICAL

WATERLINE
/BILGE

STEERING
& CONTROLS

BODY

ACCESSORIES

SERVICE TOOLS
/HARDWARE

CHEMICAL



**OEM REPLACEMENT
AFTERMARKET OIL FILTERS**

Description	OEM#	Part No.
K&N Filter - All Sea Doo 4-stroke	420950741	KN556
A. WSM Filter - All Sea Doo 4-stroke		006-560
B. WSM Filter - All Sea Doo 4-stroke Oil Filter Cap		006-562



**NGK
SPARK PLUG**

Sold per 10 spark plugs per box.

Description	Part No.
NGK Standard Plug for Sea Doo GTX 4-TEC (10 plugs per box)	DCPR-8E



NGK IRIDIUM IX SPARK PLUGS

Four spark plugs per box.

Description	Part No.
NGK Iridium Spark Plugs for Sea Doo 4-Tec	DCPR8EIX



**TORX® SOCKET SET FOR
SEA DOO ENGINES**

Special Star Sockets for Sea Doo 4-TEC& DI engine bolts are made from heat-treated vanadium steel and black oxide coated for durability. Supplied in a convenient vinyl holder.

- Four 3/8" Drive Sockets (T10, T12, T14, T16)
- Three 1/4" Drive Sockets (T6, T7, T8)

Description	Part No.
Torx Socket Set	LS26750



UMI TOP STOP BILLET STEERING

Top stop steering for positive control and extraordinary strength. Improved handling by shifting weight to correct point on watercraft. Available for most sport and runabout models.

Description	Part No.
GSX/GTX/GTI/GTS/GSI/GS 96+, RX, RXP, RXP-X, RXT, RXT-X	58-6321



**DO SPEED SPACER AND
MOUNTING KIT FOR UMI
RXP-X/RXT-X
STEERING SYSTEMS**

Do Speed has developed this spacer and mounting bracket specifically to be used in combination with a UMI steering system on a RXP-X or RXT-X. The spacer prevents water from entering the engine compartment and the bracket creates a clean and safe installation of the OEM Sea Doo warning system signal.



Description	Part No.
DO Speed Spacer and Mount Kit for UMI RXP-X/RXT-X Steering System	D-X-P



**SPEED MAGIC
"X MOUNT"
STEERING HEAD**

The Speed Magic "X-Mount" for the RXP-X and RXT-X improves handling by lowering the steering head 85mm lower than the stock position and moves the rider forward for a more aggressive position.



Description	Part No.
Speed Magic Steering Head (Standard Handlebars)	SE-027015

SEA DOO RXP RXP-X RXT RXT-X • CONTROL



HOT PRODUCTS HANDLE BARS

Models	Surface	Pad Size	Part No.
Sea Doo GTS/GTX XP 97-98/RXP/RXT	Silver	Large	HJR-02

Handle Bar Specs: 30.5 width • 3" Rise • 1.5" Pull Back



RUNABOUT FAT BARS

Handlebar Type	Part No.
Hot Products Fat Runabout Bars	HJFT-01

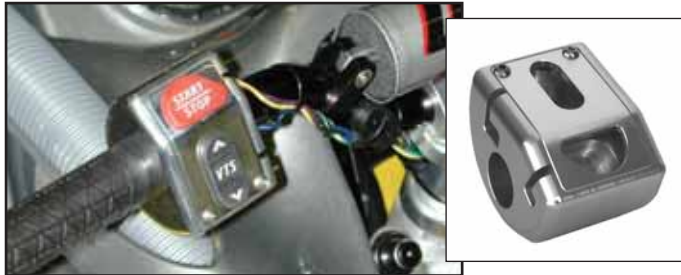

UMI RXP TRIM/SWITCH HOUSING

U.M.I.'s trim/switch housing is machined from 6061-T6 billet aluminum, replacing the stock plastic housing. Trim/switch housing uses the factory variable trim switch and start/stop switch. This housing must be used with the U.M.I. GSX/RXP (P/#58-6321) steering system, aftermarket bars and finger throttle.

Sea Doo	Part No.
RXP Silver	SD-01600-CLR



RIVA RXP-X & RXT-X BAR MOUNT SYSTEM

Key Features:

- Superior strength & rigidity over OEM system.
- Billet stainless steel steering shaft, much stronger than OEM aluminum shaft.
- Cutting edge race styling.
- Variable tilt adjustment.
- Accepts both 7/8" bars & 1-1/8" bulge bars.
- Billet steering arm features adjustable "quick turn" settings.
- Retains Off Throttle Steering system.
- Integrated throttle cable retention bracket.
- All aluminum parts anodized to prevent corrosion.

Description	Part No.
255 X-models (non iControl) Bar Mount Steering Kit	RS20050-U



THROTTLE CONVERSION KIT, ALL 4-TEC 4-STROKE RXP - RXT - GTX - GTI

Quickly and easily transform your Sea Doo thumb throttle into a more natural finger throttle with our Throttle Conversion Kit. Aluminum extensions insert directly into bar ends adding 1-3/4" to each side providing more turning leverage and a more natural riding position. Molded steering pad end cap mates to finger throttle for a clean factory look.



No modifications to existing handlebars necessary and minimal downtime.

Description	Part No.
For stock grips. All 4-TEC 4 stroke 02-07 RXP/RXT/GTX/All GTI 4-TEC	RS2455



RIVA RACING BILLET FINGER THROTTLE FOR SEA DOO

Specifically designed to match throttle travel of Sea Doo 4-Stroke PWC. Direct replacement for bulky OEM throttle on X-Models and can be used with aftermarket bars on other 4-tec applications. Adjustable throttle angle & unique trigger design keeps the trigger at the tip of your finger throughout the throttle range for reduced arm pump & superb throttle control. Delrin

bushings eliminate play common in OEM throttles and provide smooth actuation. All stainless hardware at hinge point eliminates corrosion and play. No "C" clips used. Use with OEM adapter on X-Models or use aftermarket adapter (sold separately) for other 4-Tec applications.

Description	Part No.
Riva Racing Billet Finger Throttle for Sea Doo	RS24010P
*Available in clear polished finish only	



HANDLEBAR COVER CAP FOR SEA DOO 4-TEC - RXP RXT - GTX - GTI

Description	Part No.
Handlebar Cover Cap	FB001-SD

SEA DOO 4 STROKE	INAKE SYSTEMS	ENGINE/GASKETS	EXHAUST	DRIVE LINE HANDLING	ELECTRICAL	WATERLINE /BLIGE	STEERING & CONTROLS	BODY	ACCESSORIES SERVICE TOOLS /HARDWARE	CHEMICAL
------------------	---------------	----------------	---------	---------------------	------------	------------------	---------------------	------	-------------------------------------	----------



RIVA TOP-LOADER INTAKE GRATES

The Riva top-loader intake grate features a unique tapered wing design that eliminates prop spin and cavitation while delivering enhanced acceleration and 2mph additional top-speed. Deep side rails improve stability and handling. Durable black race coating protects from corrosion. Race Legal.



RS22050



RS22055



RS22080

Description	Part No.
RXP 215 (04-08)	RS22050
RXT 215 (05-08)/GTX-SC (03-04)	RS22055
RXP-X 255/RXT-X 255HP	RS22080
GTX 4-Tec (06 & Newer)	RS22060



O.P.A.S. PERFORMANCE BLOCK-OFF KIT

Improves handling characteristics for competition use. Necessary to accommodate Riva Rear Exhaust Kit (RS15050-1, see page 4). Also designed to cleanly and easily cover the openings left when O.P.A.S. is removed preventing water from entering the hull. Made from billet aluminum utilizing o-ring seals. Anodized to prevent corrosion.

Description	Part No.
SD RXP/RXT/GTX (03 and newer) models	RS29050-1



RIVA PRO-SERIES OPAS BLOCK-OFF KIT

Optimizes the handling characteristics. Extensions fill voids dramatically improving handling and reducing porpoising. For competition use only.

Description	Part No.
RXP 215/RXP-X 255	RS29950
RXT 215/RXT-X 255	RS29985

R&D SEA DOO AQUAVEIN SCOOP GRATE



R&D's new Aquavein Scoop Grate kit that is now available for Sea Doo's new supercharged model is an absolute necessity to tame the cavitation that is created by Sea Doo's new supercharged 1500cc 185hp beast of an engine! Zero cavitation and quicker acceleration from 0-30mph is what you can expect from R&D's new 2 bar, full winged design. Improved low and high speed cornering, greater straight line stability, and an increase of .50mph in the speed department! The new R&D 4TEC Aquavein Grate installs easily in minutes and has been tested extensively with both the OEM impeller and the new R&D/Skat-Trak 16/21 3 blade impeller. The R&D/Skat-Trak impeller and Aquavein combination nets a bolt on performance boost of a full 1.5mph gain in top speed!

Description	Part No.
RXT Aquavein Scoop Grate	113-95000
RXP 215	113-95001
RXP 215 Pro 2 Aquavein & Girdle Kit	113-95002
GTI (06-07)	113-95003
GTX is, GTX Limited 260 (09-11),	113-95006
RXT is 260, RXT-X 260 (10-11), RXT-X as 260	

R&D SEA DOO RXP AQUAVEIN GIRDLE KIT



The R&D RXP Aquavein Girdle Kit was designed and developed to add two extra 6mm bolts to the back end

of either and R&D Aquavein or OEM grate for a much higher degree of security against pulling inserts out of the OEM PVC plastic pump shoe! A must for competition use!

Description	Part No.
RXP Aquavein Girdle Kit	123-10010

R&D RXP-X, RXT-X AQUAVEIN INTAKE GRATE



R&D's exclusive dual patented technology that's incorporated into the revolutionary Aquavein will enhance the X beast. Blow through low and high-speed turns with confidence and chew up rough water conditions with a new found 3 mph top speed gain. Quicker acceleration and straight-line stability are also maximized. The new X Sea Doo, equipped with an R&D Aquavein cracks the glass on the fun meter!

Description	Part No.
R&D RXP-X/RXT-X Aquavein Stock/Recreation	113-95004
R&D RXP-X/RXT-X Pro 2 Aquavein Deep Race Grate Closed Course	113-95007

WORX MAXILOADER INTAKE GRATE



WR229

The WORX Maxiloader is the first mod anyone should do to their PWC. Among the benefits you'll

receive are; reduced porpoising, no or minimal top speed loss (up to 3mph gain in choppy conditions!) and greater control & turning capability.

Description	Part No.
GTX 4Tec (02-05)/GTX SC (03-04),	WR221
RXT 215 (05-08) Intake Grate	
RXP 215 (04-08) Intake Grate	WR223
RXP-X/RXT-X 255HP Intake Grate	WR229

SEA DOO
4 STROKE

INTAKE
SYSTEMS

ENGINE/
GASKETS

EXHAUST

DRIVE LINE
HANDLING

ELECTRICAL

WATERLINE
/BILGE

STEERING
& CONTROLS

BODY

ACCESSORIES

SERVICE TOOLS
/HARDWARE

CHEMICAL

SEA DOO RXP RXP-X RXT RXT-X • CONTROL



RIVA SEA DOO 215/255HP 4-TEC PERFORMANCE RIDE PLATE

The RIVA Sea-Doo Performance Ride Plate delivers the perfect balance of top speed and improved handling. Top speed is increased by 2-3 mph along with straight line stability. Deep channeled design provides improved traction in turns and faster lap times. This ride plate requires the use of RIVA Open Loop Cooling Kit (part# RS1013-50).

Key Benefits Include:

- 2-3 mph top speed increase.
- Improved straight line stability.
- Improved cornering.

Description	Part No.
SD 215/155 4-Tec Ride Plate	RS21050
SD 255 4-Tec Ride Plate (except i-Control)	RS21080



RIVA SEA DOO 4-TEC OPEN LOOP COOLING KIT

RIVA Open Loop Cooling Kit dramatically reduces engine operating temperatures for improved performance & reliability. Also allows installation of RIVA Performance Ride Plate by eliminating need for heat exchanger. Original closed loop system becomes quickly heat soaked in high performance applications. Open loop system increases cooling efficiency via steady supply of cool external water.

Key Features Include:

- * Improved performance & reliability.
- * Allows installation of aftermarket rideplate.
- * Replaceable sacrificial zinc anode protects cooling system from corrosion.
- * Quick release flushing system flushes engine & exhaust cooling passages.
- * Billet aluminum pump cover with anodized finish.
- * Includes complete installation instructions.

FITS ALL SEA-DOO 4-STROKE PWC except i-Control

Description	Part No.
Riva 4-Tec Open Loop Cooling Kit (except i-Control)	RS1013-50



R&D RXP/RXP-X RXT/RXT-X/GTX PRO SERIES SPONSON KIT

The new R&D Sea Doo Pro Series Sponson Kit was designed and developed to deliver lots of handling performance with adjustability options, which allows you to setup your Sea Doo "your way" with 2-position backing plate and 3-position sponson blade adjustability. The R&D Sponson Kit will deliver a much smoother ride and low speed and high-speed turns are a breeze with new found control! There is also a higher end recreational/race setting with enough grip for the best of pro's!

Description	Part No.
RXP/RXP-X/RXT/RXT-X/GTX Pro Series Sponson Kit	123-95101



RIVA RACING RXP/RXP-X RXT/RXT-X/GTX PRO-SERIES SPONSON KIT

Riva's race proven Pro-Series Sponsons will dramatically improve the handling of your craft with their superior blade & backing plate design. Includes a bulletproof mounting system that features a solid backing plate and five anchor points with billet inserts in sponson fins. Sponson depth is adjustable to control the amount of influence they have on the craft.

Description	Part No.
Pro-Series Sponson Kit	RS26050
SD RXP/RXP-X/RXT/RXT-X/GTX	



WORX RACING SEA DOO SPONSONS

Unbelievable cornering, better control in the rough and predictable inline tracking while towing wakeboards or waterskiers. WORX sponsons are easy to fit, look great and bolt right into stock mounting holes.

Description	Part No.
05+ all GTX/RXP/RXT, 06+ GTI	WR534
02 thru 04 all GTX, 04 only RXP	WR526
RXP-X/RXT-X	WR540



RIVA COMPETITION O.P.A.S. KIT

Provides more predictable handling characteristics while retaining the benefits of the off-throttle O.P.A.S. system. Precision-machined composite collars prevent the O.P.A.S. fins from dropping when pump is out of the water in choppy conditions. Installs quickly and easily without tools.

Description	Part No.
SD RXP 215/RXP-X 255/RXT 215	RS-29055
RXT-X 255/GTX Competition O.P.A.S. Kit	

SEA DOO
4 STROKE

INAKE
SYSTEMS

ENGINE/
GASKETS

EXHAUST

DRIVE LINE
HANDLING

ELECTRICAL

WATERLINE
/BILGE

STEERING
& CONTROLS

BODY

ACCESSORIES

SERVICE TOOLS
/HARDWARE

CHEMICAL

SEA DOO
4 STROKE

INTAKE
SYSTEMS

ENGINE/
GASKETS

EXHAUST

DRIVE LINE
HANDLING

ELECTRICAL

WATERLINE
/BILGE

STEERING
& CONTROLS

BODY

ACCESSORIES

SERVICE TOOLS
/HARDWARE

CHEMICAL



R&D SEA DOO RXP/RXT 215/255 AUTO TRIM KIT

Developed to override the OEM VTS System with a fully adjustable and fully automatic trim system. The R&D Auto Trim automatically drops a rider preferred adjustable 2-8 degrees. For long straight rides install the R&D VTS/Holeshot Driver Rod (Pt. #163-

21503), which works in conjunction with the R&D Auto Trim to electronically override the Auto Trim back to the OEM VTS Nozzle angle trim settings! The combination allows the best for recreational and closed course riding!

Description	Part No.
RXP 215 Auto Trim Kit	163-21502
RXT 215/GTX 4-TEC Auto Trim Kit	163-95003
RXP-X 255/RXT-X 255 Auto Trim Kit	163-25500



R&D RXP/RXT 215/255 HOLESHOT ROD

The R&D Holeshot Rod is designed to work in conjunction with the R&D Auto-Trim Kit. The Holeshot Rod mounts to the VTS system and allows maximum nozzle drop when the nozzle is straight for improved holeshots.

Description	Part No.
R&D RXP/RXT/RXP-X/RXT-X Holeshot Rod	163-21503



RXP PRO STEERING NOZZLE

The R&D RXP 215/255 Pro Series Steering Nozzle was developed to replace the OEM steering nozzles oval and stepped inner design shape with a race proven high performance

round Venturi design. The new R&D RXP 215/255 Nozzle also incorporates a cast in boss for the R&D Auto Trim Kit Option.

Description	Part No.
RXP 215/RXP-X 255/RXT 215/RXP-X 255 Pro Steering Nozzle (+15mm)	163-21500



R&D RXP-X/RXT-X 84MM REDUCTION NOZZLE KIT

The R&D RXP-X/RXT-X 84mm Pump Reduction cone will reduce the venturi size from a short O.E.M. 87mm large bore design to a plus .750

over stock venturi length with a final venturi size of 84mm. Increased hook up, stronger acceleration and mid range, improved top speed performance.

Description	Part No.
R&D RXP-X/RXT-X 84mm Reduction Nozzle Kit	173-25584



RXP/RXT PRO-SERIES REDUCTION NOZZLE

Ideal for tuning your Sea Doo pump combination for maximize performance. The nozzle features a interchangeable ring system.

Nozzle includes three stainless steel rings in 81, 82 and 83mm. Additional ring sizes available (RS23050-NR-SIZE) 80, 81.5, 82.5 and 84mm.

Description	Part No.
Venturi Nozzle w/3 Rings, RXP 215, RXP-X 255, RXT, GTX-SC (05-07)	RS23050-N

GTX 4-TEC



SEA DOO RXT 2.5 DEGREE NOZZLE WEDGE KIT

The R&D 2.5 degree reduction nozzle wedge kit for the new Sea Doo 4-TEC was designed, developed and tested extensively in all types of flat and rough water conditions to ensure that there would be no handling performance compromises. Most brands of watercraft have some form of V.T.S. (variable trim system) including other model Sea Doo's. Why the

4-TEC doesn't have a trim system is a mystery. Extensive testing has led our development team to wedge the reduction nozzle up 2.5 degrees which will inexpensively give your 4-TEC better handling everywhere and provide a boost of 1 to 2 mph in top speed performance. The billet aluminum CNC machined 2.5 degree reduction nozzle wedge kit was designed to work with the OEM O.P.A.S. system and installs easily in 15 to 20 minutes with R&D's "easy install" directions.

Description	Part No.
02-03 GTX 4-TEC SC / 03-05 GTX 4-TEC NA	143-95002
2.5 Degree Pump Wedge/Cable Extension Kit	
RXP 215	143-95003
2.5 Degree Pump Wedge/Cable Extender Kit	
RXT 215/(04-05) GTX 4-TEC	143-95004
2.5 Degree Pump Wedge/Cable Extender Kit	
RXT-X 255 2.5 Degree Pump Wedge/Adjustable Trim Rod/Cable Extender Kit	143-95005
RXP-X 255 1.0 Degree Pump Wedge/Adjustable Trim Rod/Cable Extender Kit	143-95006



RIVA RXP/RXP-X, RXT/RXT-X, GTX-SC BILLET PUMP WEDGE

2 Degree wedge trims up your pump nozzle raising the bow of your craft for less drag and more control.

Description	Part No.
RXP, RXP-X, RXT, RXT-X, GTX-SC 2-Degree Pump Wedge	RS23050



RIVA RXP/RXP-X/RXT-X VTS EXTENSION ROD

Our precision-machined VTS Extension Rod allows maximum "nozzle down" adjustment after installation of RIVA Pump Wedge. Necessary on modified craft to keep bow down during initial acceleration while still providing maximum top speed advantage when trimmed up. Adjustable design comes preset for RIVA 2° Pump Wedge (part# RS23050).

Description	Part No.
RXP/RXP-X/RXT-X VTS Extension Rod	RS23050-1-ER

SEA DOO RXP RXP-X RXT RXT-X • PUMP



WET WOLF PUMP CONE

The Adjust-A-Thrust has been shown to gain .5 to 1.5 more top end. Makes a noticeable difference in the low end and midrange as well.

Description
Wet Wolf Pump Cone fits all 01-06 RXP, RXT and GTX
**Note - This unit performs well on stock craft, and crafts with handling mods, or lite engine mods - We do not recommend this unit for modified craft.*

Part No.
SEA4



163-95350
Sea Doo Pump Cone Spacer

R&D ANTI-CAVITATION CONE FOR SEA DOO

The unique patent pending design balances the bowl pressure in the last stage of the pump to eliminate detectable cavitation. Improve bottom and punch midrange pull and overall performance.

Sea Doo	Part No.
RXP 215/RXT 215/RXP-X 255/RXT-X 255/GTX	163-95001
RXP 215/RXT 215/RXP-X 255/RXT-X 255	163-95200
GTX 4-TEC Anti-Cavitation Pump Cone Spacer .200 (02-05)	
RXP 215/RXT 215/RXP-X 255/RXT-X 255	163-95350
GTX 4-TEC Anti-Cavitation Pump Cone Spacer .350 (02-05)	



RAD 4 RACING SEA DOO RXP THRU HULL FITTING

Replace the stock carbon seal with this RAD 4 Racing reliable bearing carrier. Includes drive shaft skim for perfect installation. For All RXP and RXP-X.

Sea Doo
Rad 4 Racing SD RXP Thru Hull Fitting

Part No.
R4RTHUHULL



SAND & DEBRIS FILTER .75IN

Our Water Filters/Strainers protect your engine from damage due to waterborne debris such as seaweed, sand, grass and pebbles that are sucked into the cooling system. Filters mount inline with the inlet cooling hose to your watercraft's engine. Filter cup is clear to provide easy visual inspection, threaded for quick removal and seals with a durable rubber o-ring.

Description
Sand & Debris Filter .75in

Part No.
56-9004



RIVA STAINLESS STEEL REPLACEMENT WEAR RING FOR 4-TEC SEA DOO

Riva heavy-duty, 100% stainless steel wear rings/impeller liners are the perfect replacement for your damaged original unit. Replaces original plastic liner with easy press in installation. Durable stainless steel resists debris damage and saltwater corrosion. Provides increased durability and performance due to precision machined clearance between wear ring and impeller.

Sea Doo PWC Application Chart:

155mm liner fits 185, 155 & 130hp 4-Stroke units.
159mm liner fits 255 & 215hp 4-Stroke units.

Description	Part No.
155mm SD SR Series	RS33-155-SR
159mm SD SRX Series	RS33-159-SRX



WSM REPLACEMENT PUMP WEAR RINGS FOR SEA DOO

Description	OEM#	Part No.
1998 Up including 4-Tec (Non-SC)	271-000-653	003-503
4-Tec Supercharged 03-04	267-000-104	003-502
RXP/RXT (159mm) (exclude "is" model)	267-000-105	003-499



WSM REPLACEMENT PUMP WEAR RINGS WITH STAINLESS STEEL LINER

Description	OEM#	Part No.
1998 Up including 4-Tec (Non-SC)	271-000-653	003-503S
4-Tec Supercharged 03-04	267-000-104	003-502S
RXP/RXT (159mm) (exclude "is" model)	267-000-105	003-499S

SEA DOO OEM TYPE SPECIALTY TOOLS

For the repair and installation of Sea Doo 4-Tec drive shaft and the pump shaft.



Drive Shaft / Floating Ring
Part No. 950-100
O.E. No. 529-035-841
Fits: GTX 4 Tec Models



Drive Shaft / Floating Ring
Part No. 950-102
O.E. No. 529-035-987
Fits: Super Charged 4-Tecs



Drive Shaft Holder
Part No. 950-155
O.E. No. 529-035-986
Fits: GTX 4-Tec & RXP 4-Tec Models



Shaft Pusher
Part No. 950-165
O.E. No. 529-035-955
Fits: GTX 4-Tec Models



Seal & Bearing Pusher
Part No. 950-170
O.E. No. 529-035-819
Fits: GTX 4-Tec Models

SEA DOO 4 STROKE
INATKE SYSTEMS
ENGINE/ GASKETS
EXHAUST
DRIVE LINE HANDLING
ELECTRICAL
WATERLINE /BLIGE
STEERING & CONTROLS
BODY
ACCESSORIES
SERVICE TOOLS /HARDWARE
CHEMICAL

SEA DOO FOUR STROKE • PERFORMANCE PART KITS & RPM KITS



Skat-Trak P.O.C.
PERFORMANCE PRODUCTS

SKAT TRAK IMPELLERS FOR SEA DOO PWC

Increased acceleration and top speed gains are only a few of the advantages of upgrading to a Skat-Trak impeller.

On the New 3-Blade Swirl Super Pro Impeller

Skat Trak recommends:

- 13/17 for a Stock RXT application
- 13/17 for a RXT Stock Stage 1 application
- 13/18 for a RXT-X Stock Stage 1 application
- 13/18 for a RXT Stage 2 application
- 13/18 for a RXP Stock Stage 1 application
- 14/19 for a RXP-X Stock Stage 1 application
- 14/19 for a RXP Stage 2 application
- 14/20 for a RXP Stage 3 application
- 15/20 for a RXP 300hp and up application
- 15.5/21.5 for a RXP 315hp and up application

Skat Trak Impellers do not include a seal, Hot Products recommends SLA012 sold separately.

159-83-28 3-Blade

Description	Swirl Super Pro	Part. No.
13/17	3-Blade Swirl Super Pro	SS598328SW31317
13/18	3-Blade Swirl Super Pro	SS598328SW31318
14/19	3-Blade Swirl Super Pro	SS598328SW31419
14/20	3-Blade Swirl Super Pro	SS598328SW31420
15/18	3-Blade Swirl Super Pro	SS598328SW31518
15/19	3-Blade Swirl Super Pro	SS598328SW31519
15/20	3-Blade Swirl Super Pro	SS598328SW31520
15.5/21.5	3-Blade Swirl Super Pro	SS598328SW3155215
Aluminum Billet Impeller Seal for 3-Blade Super Pro		SLA012

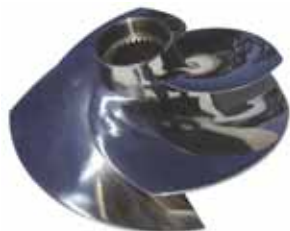

SOLAS
Where speed begins

SOLAS IMPELLERS

Increased acceleration and top speed gains are only a few of the advantages of upgrading to a Solas impeller.

Description	2004-2008	2009 and up
RXP Stock/Limited	SRX-CD-14/19	SRZ-CD-14/19
RXP Modified	SRX-CD-15/21	SRZ-CD-15/21
RXP-X Stock	SRX-CD-15/21	SRZ-CD-15/21
RXT Stock/Limited	SRX-CD-13/18	SRZ-CD-13/18
RXT Modified	SRX-CD-15/21	SRZ-CD-15/21

SOLAS BILLET IMPELLER SEAL

The new generation of the SOLAS Impeller seal is made with billet aluminum. They are very suitable for high power applications. Fits Solas Concord and Skat Trak 3-Blade Super Pro impellers.

Description	Part No.
Aluminum Billet Impeller Seal for Concord Impellers	SLA012



RIVA R-SERIES PUMP IMPELLERS

NOTE: R-Series Impellers must be used with Riva's Pro-Series Reduction Nozzle (Part# RS23050-N for RXP/RXP-X) or (Part# RS23051-N for RXT)

Description	Part No.
13/19 R-Series Solas Concord Impeller	SRX-CD-13/19R
14/17 R-Series Solas Concord Impeller	SRX-CD-14/17R
14/19 R-Series Solas Concord Impeller	SRX-CD-14/19R
15/20 R-Series Solas Concord Impeller	SRX-CD-15/20R
15/22 R-Series Solas Concord Impeller	SRX-CD-15/22R

Riva Performance Kit Pump Impellers Recommend Chart:

Model	Stock	Stage I	Stage II
RXP-X	N/A	SRX-CD-15/22R	TBA
RXT-X	N/A	SRX-CD-15/22R	TBA
RXP	SRX-CD-13/18R	SRX-CD-14/19R	SRX-CD-15/20R
RXT	SRX-CD-14/17R	SRX-CD-14/17R	SRX-CD-13/19R



IMPELLER HOLDER TOOL

Description	Part No.
A. GTX 4Tec Super Charged	DS#70
B. RXP/RXT 27mm	DS#71
C. Solas RXP/RXT 27mm	WR012-SRX

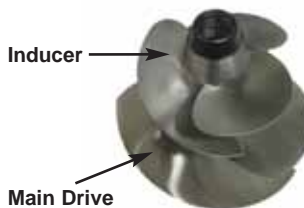

SKAT-TRAK TWIN IMPELLERS

The new Twin Prop design drives of the line much quicker than the traditional single prop, and offers substantial increase in rough water hookup.

SEA DOO RXP-X

	Engine Mods	Pitch	Part No.
Main Drive	Stock	13/17	SS598328SWM1317
Main Drive	Limited	13/18	SS598328SWM1318
Main Drive	Supermod	15/20	SS598328SWM1520
	Engine Mods	Pitch	Part No.
Inducer	Stock	13/17	SS440ID1317
Inducer	Limited	13/18	SS440ID1318
Inducer	Supermod	15/20	SS440ID1520

SEA DOO RXT-X

	Engine Mods	Pitch	Part No.
Main Drive	Stock	12/16	SS598328SWM1216
Main Drive	Limited	13/17	SS598328SWM1317
Main Drive	Supermod	15/18	SS598328SWM1518
	Engine Mods	Pitch	Part No.
Inducer	Stock	12/17	SS440ID1217
Inducer	Limited	12/17	SS440ID1217
Inducer	Supermod	15/18	SS440ID1518

SEA DOO PERFORMANCE RECOMMENDATION PARTS LIST

RXT-X 260 10-11 RXT 260 11 - STAGE 1

PERFORMANCE DATA

Stock (U.S. Model) 67 MPH @ 7,900 – 8,000 RPM
 Stock (International Model) 69 MPH @ 7,900 – 8,000 RPM

Stage 1 72 MPH @ 7,900 – 8,000 RPM

Note: All testing performed with 1/3 tank of fuel; trim neutral.

Stage Performance Parts

Description	Quantity	Part No.
Performance Power Filter Kit	1	RS13100
Speed Control Override Module	1	RS11090-SCOM- YEAR
Catch Can/Engine Breather Upgrade Kit	1	RS19050-BCC
R-Series Concord Impeller	1	SRX-CD-15/22R

RXP-X 255 - STAGE 1

PERFORMANCE DATA

Stock 68 MPH @ 8,000 RPM

Stage 1 72 MPH @ 7,900 – 8,000 RPM

Note: All testing performed with 1/3 tank of fuel; trim neutral.

Stage Performance Parts

Description	Quantity	Part No.
Performance Power Filter Kit	1	RS13050-06
Top-Loader Intake Grate	1	RS22080
R-Series Concord Impeller	1	SRX-CD-15/22R
2° Pump Wedge	1	RS23050
VTS Extension Rod	1	RS23050-1-ER
Pro-Series Reduction Nozzle	1	RS23050-N

RXT-X 255 08-09 - STAGE 1

PERFORMANCE DATA

Stock (U.S. Model) 67 MPH @ 8,000 RPM

Stage 1 73 MPH @ 8,000 RPM

Note: All testing performed with 1/3 tank of fuel; trim neutral.

Stage Performance Parts

Description	Quantity	Part No.
Performance Power Filter Kit	1	RS13050-06
Top-Loader Intake Grate	1	RS22080
R-Series Concord Impeller	1	SRX-CD-15/22R
2° Pump Wedge	1	RS23050
VTS Extension Rod	1	RS23050-1-ER
Pro-Series Reduction Nozzle	1	RS23050-N
O.P.A.S Competition Kit	1	RS29055

RXP-X 215 - STAGE 1

PERFORMANCE DATA

Stock 67-68 MPH @ 8,100 PRM

Stage 1 72 MPH @ 8,100 RPM

Note: All testing performed with 1/3 tank of fuel; trim neutral.

Stage Performance Parts

Description	Quantity	Part No.
Performance Power Filter Kit	1	RS13050-06
Top-Loader Intake Grate	1	RS22050
R-Series Concord Impeller	1	SRX-CD-14/19R
2° Pump Wedge	1	RS23050

RXT 215 05-09 GTX-SCIC 215 05-08 - STAGE 1

PERFORMANCE DATA

Stock (U.S. Model) 64-65 MPH @ 7,950 rpm

Stage 1 68-69 MPH @ 8,000 RPM

Note: All testing performed with 1/3 tank of fuel.

Stage Performance Parts

Description	Quantity	Part No.
Performance Power Filter Kit	1	RS13050-06
Top-Loader Intake Grate	1	RS22055
R-Series Concord Impeller	1	SRX-CD-14/17R
Pump Wedge	1	RS23050
O.P.A.S Competition Kit	1	RS29055

GTX-SC 03-06 185 NON-INTERCOOLED - STAGE 1

PERFORMANCE DATA

Stock (U.S. Model) 61-62MPH @ 7,600 RPM

Stage 1 67 MPH @ 7,600 RPM

Note: All testing performed with 1/3 tank of fuel.

Stage Performance Parts

Description	Quantity	Part No.
Performance Power Filter Kit	1	RS13050-06*
Top-Loader Intake Grate	1	RS22055
R-Series Concord Impeller	1	SR-CD-13/20R
Pump Wedge	1	RS23050
O.P.A.S Competition Kit	1	RS29055

SEA DOO
4 STROKE

INATKE
SYSTEMS

ENGINE/
GASKETS

EXHAUST

DRIVE LINE
HANDLING

ELECTRICAL

WATERLINE
/BLIGE

STEERING
& CONTROLS

BODY

ACCESSORIES
/HARDWARE

SERVICE TOOLS

CHEMICAL

SEA DOO PERFORMANCE RECOMMENDATION PARTS LIST

SEA DOO
4 STROKE

INTAKE
SYSTEMS

ENGINE/
GASKETS

EXHAUST

DRIVE LINE
HANDLING

ELECTRICAL

WATERLINE
/BILGE

STEERING
& CONTROLS

BODY

SERVICE TOOLS
ACCESSORIES

SERVICE TOOLS
/HARDWARE

CHEMICAL

RXT 215 05-09 GTX-SCIC 215 05-08 - STAGE 2

PERFORMANCE DATA

Stock (U.S. Model)	64-65 MPH @7,950 RPM
Stage1	68-69 MPH @ 8,100 RPM Stock
Stage 2	71-72 MPH @ 8,100 RPM
Stage 3	74-75 MPH @ 8,400 RPM

Note: All testing performed with 1/3 tank of fuel.

Stage 2 Performance Parts

Description	Quantity	Part No.
Performance Power Filter Kit	1	RS13050-06
Vortech `GEN-2' Supercharger Impeller	1	RS1750-001B
GEN-2' Power Cooler Kit	1	RS1751-PC
Performance Blow-off Valve Kit	1	RS17080-BV-PFV
Rear Exhaust Kit	1	RS15050-1
Performance Blow-off Valve Kit	1	RS17080-BV-PFV
Top-Loader Intake Grate	1	RS22055
R-Series Concord Impeller	1	SRX-CD-13/19R
Pump Wedge	1	RS23050
Pro-Series Sponson Kit	1	RS26050
O.P.A.S Performance Block-off Kit	1	RS29050-1

RXT 215 - STAGE 2

PERFORMANCE DATA

Stock (U.S. Model)	67-68 MPH @8,100 RPM
Stage1	72 MPH @ 8,100 RPM Stock
Stage 2	75 MPH @ 8,100 RPM
Stage 3	80+ MPH @ 8,400 RPM

Note: All testing performed with 1/3 tank of fuel.

Stage 2 Performance Parts

Description	Quantity	Part No.
Performance Power Filter Kit	1	RS13050-06
Vortech GEN-2' Supercharger Impeller	1	RS1750-001B
GEN-2' Power Cooler Kit	1	RS1751-PC
Performance Blow-off Valve Kit	1	RS17080-BV-PFV
Rear Exhaust Kit	1	RS15050-1
Performance Blow-off Valve Kit	1	RS17080-BV-PFV
Top-Loader Intake Grate	1	RS22055
R-Series Concord Impeller	1	SRX-CD-15/20R
Pump Wedge	1	RS23050
Pro-Series Sponson Kit	1	RS26050
O.P.A.S Performance Block-off Kit	1	RS29050-1

RXT 215 05-09 GTX-SCIC 215 05-08 - STAGE 3

PERFORMANCE DATA

Stock (U.S. Model)	64-65 MPH @7,950 RPM
Stage1	68-69 MPH @ 8,100 RPM
Stage 2	71-72 MPH @ 8,100 RPM
Stage 3	74-75 MPH @ 8,400 RPM

Note: All testing performed with 1/3 tank of fuel.

Stage 3 Performance Parts

Description	Quantity	Part No.
Performance Power Filter Kit	1	RS13050-06
X-Model Supercharger	1	420881992
GEN-2' Power Cooler Kit	1	RS1751-PC
Pro-Series Blow-off Valve Kit	1	RS17081-BOV-SSQV
Pro-Series Fuel Injector Kit	1	RS12050-I-KIT-50
Rear Exhaust Kit	1	RS15050-1
Pro-Series ECU (2006 =B) (2007-09 =C)	1	RS11850-01- YEAR
Thermostat Kit	1	RS1015
Valve Train Upgrade Kit	1	RS19050-VTU
Top-Loader Intake Grate	1	RS22055
R-Series Swirl Impeller	1	SP-IMP-159-15/18R
Pro-Series Reduction Nozzle	1	RS23050-N
Pro-Series Sponson Kit	1	RS26050
O.P.A.S Performance Block-off Kit	1	RS29985

RXT 215 - STAGE 3

PERFORMANCE DATA

Stock (U.S. Model)	67-68 MPH @8,100 RPM
Stage1	70-71 MPH @ 8,100 RPM
Stage 2	75 MPH @ 8,100 RPM
Stage 3	80+ MPH @ 8,400 RPM

Note: All testing performed with 1/3 tank of fuel; trim neutral.

Stage 3 Performance Parts

Description	Quantity	Part No.
Performance Power Filter Kit	1	RS13050-06
X-Model Supercharger	1	420881992
GEN-2' Power Cooler Kit	1	RS1751-PC
Pro-Series Blow-off Valve Kit	1	RS17081-BOV-SSQV
Pro-Series Fuel Injector Kit	1	RS12050-I-KIT-50
Rear Exhaust Kit	1	RS15050-1
Pro-Series ECU (2006 =B) (2007-09 =C)	1	RS11850-01- YEAR
Thermostat Kit	1	RS1015
Valve Train Upgrade Kit	1	RS19050-VTU
Top-Loader Intake Grate	1	RS22055
R-Series Swirl Impeller	1	SP-IMP-159-15/19R
Pump Wedge	1	RS23050
VTS Extension Rod	1	RS23050-ER
Pro-Series Reduction Nozzle	1	RS23050-N
Pro-Series Sponson Kit	1	RS26050
O.P.A.S Performance Block-off Kit	1	RS29950

SEA DOO RXP RXP-X RXT RXT-X • SEAT COVERS

JETTRIM CUSTOM ORDER SEAT COVER

Description	Part No.
RXP Custom Designed Seat Cover	SDRXP101
RXP-X Custom Designed Seat Cover	SDRXPX101
RXP-X Retro Designed Seat Cover	SDRXPX102
RXT Custom Designed Seat Cover	SDRXT101
RXT-X Custom Designed Seat Cover	SDRXTX103
RXP-X Custom Designed Hump Seat Cover	SDRXPX101H
RXT-iS New Design Seat Cover	SDRXTXIS101

The upholstery outline for your custom designed seat cover is available in the Hot Products Price List.

PRE-COLORED HOT PRODUCTS RECOMMENDED JETTRIM SEAT COVERS

RXP-X 101 Series



SDRXPX101-A

Top: Medium Slip Black
Side: Carbon Dark Silver
Spike: Disco Light Orange
Rear: Small Carbon Light Silver



SDRXPX101-B

Top: Medium Slip Silver
Side: Carbon Black
Spike: Rx Orange
Rear: Carbon Black
Stitch: Orange Thread on Top



SDRXPX101-C

Top: Medium Slip Silver
Side: Carbon Black
Spike: Smooth Grain Vinyl Fire Red
Rear: Carbon Black
Stitch: Orange Thread on Top

RXP-X 102 Series



SDRXPX102-A

Top: Carbon Silver
Top Rear: Rx Orange
Front Collar: Carbon Black
Side: Carbon Black
Stitch: Orange Thread on Top



SDRXPX102-B

Top: Carbon Silver
Top Rear: Fire Red
Front Collar: Carbon Black
Side: Carbon Black
Stitch: Orange Thread on Top



SDRXPX102-C

Top: Medium Slip Black
Top Rear: Medium Slip Black
Front Collar: Carbon Black
Side: Carbon Black
Stitch: Silver Thread on Top

RXP 101 Series



SDRXP101-A

Top: Medium Slip Black
Top Rear: Medium Slip Silver
Side: Kevlar Black
Rear: Carbon Dark Silver

RXT IS 101 Series



SDRXTXIS101-A

Front & Rear Top: Medium Slip Yellow
Front Collar: Carbon Black LG
Center Band: Carbon Black LG
Front & Rear Vest:
Smooth Grain Silver
Side: Carbon Black LG



SDRXTXIS101-B

Front and Rear Top: Non Slip Black
Front Collar: Carbon Black
Center Band: Carbon Black
Front & Rear Backrest:
Fire Red Smooth Vinyl
Side: Ostrich Black Vinyl
Stitch: Orange Thread on Top

RXT 2 RXT-X 103 Series



SDRXTX103-B

Front & Rear Top: Medium Silver Slip
Front Collar: Fire Red Smooth Vinyl
Center Band: Fire Red Smooth Vinyl
Front & Rear Backrest:
Fire Red Smooth Vinyl
Front Side: Carbon Black LG
Rear Side: Ostrich Black
Stitch: Black Thread on Top



SDRXTX103-C

Front and Rear Top: Non Slip Black
Front Collar: Carbon Silver
Center Band: Carbon Silver
Rear Tail: Carbon Silver
Front Side: Carbon Black LG
Rear Side: Ostrich Black
Stitch: Black Thread on Top

PRE-COLORED HOT PRODUCTS RECOMMENDED AP SEAT COVERS



RXP

Description	Color	Part No.
Ultra Grip Top	Black/Silver/Black	USDRXP-BK/SL/BK



4Tec GTX & RXT

Description	Color	Part No.
Ultra Grip Top	Black/Silver/Black	USDGTX-BK/SL/BK

SEA DOO
4 STROKE

INATKE
SYSTEMS

ENGINE/
GASKETS

EXHAUST

DRIVE LINE
HANDLING

ELECTRICAL

WATERLINE
/BILGE

STEERING
& CONTROLS

BODY

ACCESSORIES
SERVICE TOOLS

/HARDWARE

CHEMICAL