

MSD™ POWERSPORTS

*Part # 42351
Multi Channel
Ignition Unit
Only

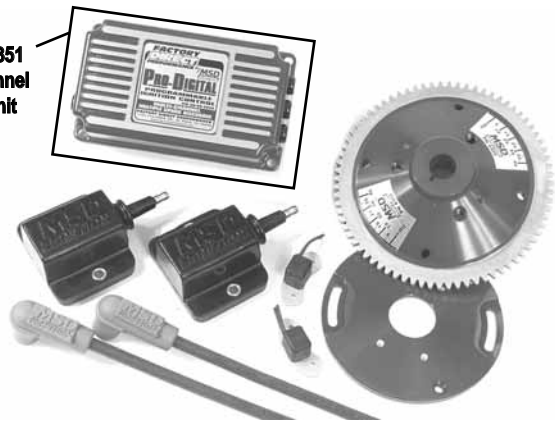

MULTI-CHANNEL RACING IGNITION SYSTEMS FOR YAMAHA 650/701/760

Precise ignition timing is essential to produce maximum horsepower. However, one timing setting is not ideal for an engine's entire rpm range. The dynamics of air and fuel flow into the engine as well as the speed that the piston travels through the combustion stroke all affect the ideal timing setting. Fortunately, the Programmable MSD Ignition lets you tune in a custom timing curve to match your engine's requirements.

point to begin the curve, followed by the amount you want it to retard (up to 30°) through the high rpm limit. All the adjustments are made with dip switches built into the ignition.

There are three settings that you program to create a timing curve. First you set where you want the initial timing, or idle timing. Next you set the rpm

This Ignition delivers a powerful capacitive discharge spark from idle to top end. This improved output results in complete combustion for performance through the entire rpm range of your engine.

Kit Part No.	Description	Ignition Unit	Trigger Plates	Trigger(s)	Coil (w/Bracket)	Wire Set	Flywheel/Magnet Wheels
42380	Yamaha 650/701/760 Total Loss	42351	4311	(2) 4316	(2) 42921	31009	43032
*42351 Multi Channel Ignition Unit only (Replacement Ignition Kit)							

1-REV CONTROL

The MSD's adjustable rev limiter allows you to program an rpm limit that the engine will not rev past. This is a great feature that will save your engine from over rev damage caused by parts failure or if the craft's drive mechanism comes out of the water. When your limit is reached, the ignitions adjusts the spark output quickly to stay below the rpm. This produces a smooth rev limiting action.

2-HOLESHOT

Thanks to the rev limiting circuit of the Ignition, MSD engineers developed a feature that will give you great holeshots. By installing a handlebar operated switch, you can activate a lower rpm limit that will hold an engine under 3,000 rpm. This way you can hold the throttle wide open and concentrate on the rubberband snapping. When it does, you release the button, the engine revs to full power and you launch out in front! (See page 107. Hole shot control switch)

3-EASY STARTS

When you increase the compression ratio of your engine, it also puts more presume on your starter to crank the engine over. The MSD Programmable Ignition has two features that can help ease cranking pressure and improve the start up of our watercraft.

Retard: When activated, this feature retards the timing 20° to ease cranking. When the engine starts, the timing returns to the initial setting.

Delay for Electric Starters: When activated, this mode will not produce a spark for the first several rotations of the engine. This helps build momentum in the engine, resulting in easier starting.

MSD™ POWERSPORTS



One of the advantages of the MSD Multi-Channel Ignition system is the individual trigger pickups for each cylinder. This way you can make up for the variations in fuel flow dynamics to each cylinder, exhaust characteristics or carb synchronization by altering the timing of each cylinder,

MSD TRIGGER PICKUP PLATE

Description	Part No.
Yamaha 650/701/760	4311
Yamaha 1200 Powervalve	43115
Kawasaki 650/750	43122

MSD™ POWERSPORTS



MSD TOTAL LOSS PICK UP

Description	Part No.
Pick Up Total Loss Universal	4316
Pick Up Yamaha 800/1100/1200	43161
Timing Tape, Sea Doo	LAB17344
Timing Tape, Yamaha 1200/800	LAB19722
Magnets, Round 2 pcs/set	4309

MSD™ POWERSPORTS



MSD COILS

Description	Part No.
A. Single Tower Pro Coil	42921
B. Stock Improved Coil for start-up	4294

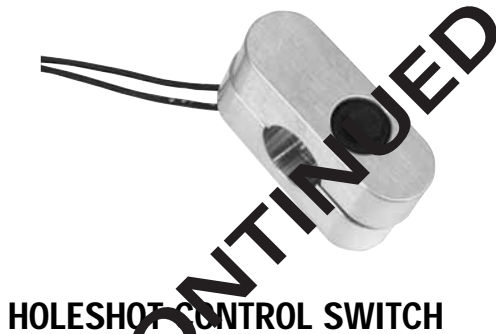

HOLESHOT CONTROL SWITCH

This is a momentary push-button switch encased in a CNC machined aluminum housing that clamps around the handle bar. It comes with a 6-foot wire harness that should reach almost anywhere on your watercraft. Use this switch to activate any MSD feature.

Description	Part No.
Holeshot Control Switch	4372



DUAL WIRE SEPARATORS

These handy separators will secure two wires and keep them away from the exhaust or moving parts. Each wire can be moved easily and clipped right back in! Sold in a pack of 16.

Description	Part No.
Dual Wire Separator (pack of 16)	8841

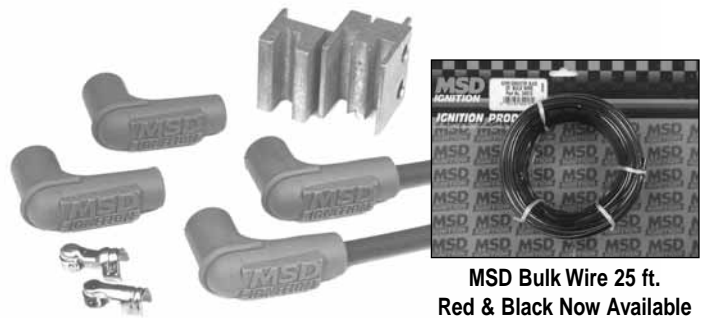

MSD Bulk Wire 25 ft.
Red & Black Now Available

8.5MM SUPER CONDUCTOR SPARK PLUG WIRE

Spark plug wires have two main objectives; transfer the spark energy and suppress the Electro Magnetic interference (EMI) that the spark voltage creates. The MSD 8.5mm Super conductor delivers the best of both worlds. MSD uses a special copper conductor keeping resistance under 50 ohms per foot! Even with this low resistance, the wire retains high EMI suppression capabilities. By wrapping the conductor tightly around a ferro-magnetic impregnated center core and EMI choke is created, keeping any interference inside the wire.

Description	Part No.
Two Cylinder Wire Set	31009
One Cylinder Wire Set	31019
Three Cylinder Wire Set	31039
Bulk Wire 25 feet - Red	34019
Bulk Wire 25 feet - Black	34013



MSD SPARK PLUG BOOT RETAINERS

There's no excuse for losing a race due to a plug wire popping off when you run MSD's Boot Retainers. These handy clamps are molded from heat resistant nylon material and will lock the boot to the spark plug.

Description	Part No.
A. Boot Retainer, 90° Spark Plug Boots & Terminal	3340
B. 90° Spark Plug Boots & Terminal Only (2 pcs.)	3311



Mini Stripper-Crimper

Designed to be in a vise and with a single-edge razor blade to strip spark plug wires without damaging the core and to crimp a terminal. Inexpensive tool!

Description	Part No.
Mini Stripper-Crimper	3503

FOUR
STROKE

INTAKE
SYSTEMS

ENGINE/
GASKETS

EXHAUST

DRIVE LINE
HANDLING

ELECTRICAL

WATERLINE
/BILGE

STEERING
& CONTROLS

BODY

ACCESSORIES
/HARDWARE

SERVICE TOOLS

CHEMICAL



SEA-DOO 800 ENHANCER

The Enhance Ignition for the Sea Doo® 800 (also the '95, '96, XP and GSX) uses a high speed RISC microprocessor to control all of the timer and rev limiter functions. This opens the door for programming, giving you the ability to set two rev limits and a timing curve through a series of dip switches built into the Enhancer. Being able to control the ignition curve lets you match the timing specifically to your engine and its modifications. The Digital Enhancer produces a series of sparks through 3,000 rpm rather than just a single spark. This feature delivers incredible throttle response, acceleration and keeps the idle clean and smooth. Note: This modification will eliminate the factory DSS security system and the handlebar kill feature.

Description	Part No.
Sea Doo 800 '95-96, 97-98 SPX, GTX	4255



MSD EXTERNAL STARTER RELAY

This 12 volt relay is a heavy duty unit designed to mount outside the electrical box. It's made with material that locks out moisture and chemicals. The large copper terminals assure good solid contact with your wiring. The stainless steel base plate allows the relay to be mounted in any position. Rated at 65 amps.

Description	Part No.
MSD External Starter Relay	M4390



MSD TIMING LIGHT

MSD offers a heavy duty top quality timing light. This timing light is supplied in a heavy duty metal housing and features a high output Linear Xenon strobe with a focused fresnel lens that produces a light that's bright enough to use outdoors. It is equipped with a 6 foot lead and uses a metal inductive pickup that clamps to the spark plug wire.

Description	Part No.
MSD Timing Light	8990

Each Enhancer is a direct plug in unit and is designed to fit in the stock location. The Enhancer Ignition gives the racer an edge due to the powerful spark energy and adjustable rev-limiter. The Enhancer Ignitions produce a much more powerful spark, as much as four times more spark energy, to insure complete combustion of the fuel mixture. This complete combustion results in improved performance including quick throttle response, improved pulling power and top end, plus will reduce spark plug fouling. Whether your watercraft is stock or if you've added other modifications such as a better flowing intake or exhaust modifications, the Enhance ignitions will improve the performance.



4253

YAMAHA 650/701 ENHANCER

At lower rpm you'll notice incredible acceleration and throttle response due to advancing the timing. Then as the rpm increases, the timing is retarded to the factory setting to prevent detonation and engine damage. For racers, there is also a lower rpm limit that you can activate for quick and consistent holeshots. By activating a switch (Part# 4372 see page 144) mounted on the handle bar the rpm will limit at approximately 3,000 rpm. The instant the button is released, the rpm revs up just as normal and you rocket off. Everything you need to install the Yamaha Enhancer is supplied along with factory connectors for a direct plug-in installation!

Not compatible with Yamaha 760 engine applications.

Description	Part No.
Yamaha 650/701	4253



4251

KAWASAKI 750 ENHANCER

The Kawasaki 750 Enhancer features the increased spark energy you expect from MSD plus they have an adjustable rev limiter and holeshot rpm limit. The rev limit is adjusted with a potential on the back of the ignition housing. The holeshot feature lets you activate a lower rpm limit that is best to use for quick starts at the beginning of a race. Also, these ignitions can be connected to the factory overheat sensor. With this feature, if the water temperature gets too high, the Enhancer will limit the rpm to a safe value to avoid any engine damage.

Note: Enhancer will not work on 1996Zxi.

Description	Part No.
Kawasaki 750 SX/SXI/95ZXI	4251



POWERSHOT ADJUSTABLE FUEL TUNER

The all new R&D Powershot fuel injection tuner will deliver increased horsepower, acceleration, and stronger mid-range performance by delivering a higher performing air to fuel ration (A.F.R.) to the engine. Many of today's high performance fuel injected four stroke muscle craft have a conservative A.R.R., which allows manufacturers to meet C.A.R.B.'s O.E.M emission standards and regulations. R&D Performance has tested, documented, and analyzed the O.E.M. fuel map or curve, on every current fuel injected four stroke watercraft. The pre-programmed and coded R&D Powershot fuel injection control module safely alters the O.E.M. fuel map to a higher performing and safer A.F.R. (richer). More horsepower, greater acceleration and stronger mid-range are the result when the proper A.F.R. is achieved and is tuned for optimum performance. The R&D Powershot is pre-coded, pre-tuned, preset and ready to install easily in minutes with R&D's comprehensive installation and tuning instruction.

The R&D Powershot is fully adjustable on the fly (with the engine running, observed and tuned while riding), and will accommodate a wide range of adjustability to properly performance tune the A.F.R. for any combination of aftermarket parts, i.e. aftermarket supercharger modifications, camshafts or valve train modifications, head modifications, exhaust system modifications, and high compression piston kits. The R&D Powershot will add horsepower, reliability, and adjustability to any electronic fuel injected two or four stroke watercraft engine.

Description	Part No.
KAW 12F/15F Powershot Fuel Tuner	801-15000
KAW Ultra 250X/250LX Powershot Fuel Tuner	801-25000
YAM VX110 Powershot Fuel Tuner	802-00110
YAM FX H.O. Powershot Fuel Tuner	802-16000
YAM FX SHO/FZR/FZS Powershot Fuel Tuner	802-18000
YAM GP 1300R Powershot Fuel Tuner	802-13001
S-D GTX/GTI 4-TEC N.A. Powershot Fuel Tuner	803-95000
S-D GTX 4-TEC SC (185 HP) Powershot Fuel Tuner	803-95001
S-D RXP/RXT/GTX 4-TEC (215 HP) Powershot Fuel Tuner	803-95002
S-D RXP-X/RXT-X (255HP) Powershot Fuel Tuner	803-95003
Hydrospace Powershot Fuel Tuner	806-10000



IGNI-PRO PROGRAMMABLE IGNITION 800 SX-R

Igni-Pro Programmable Ignition 800 SX-R (all years) - Best is getting better! NEW UPDATED , ignition does not require power when the engine is not running eliminating the battery draw down in the past units. 2008 Igni-Pro is a high power ignition only for racing, which can be adjusted fully online with your PC at home or with Laptop directly on the water. (USB) . This allows you to react at changes at your Kawasaki SX-R 800 configuration. The conversion from the OEM ignition system to Igni-Pro is very simple. Programming software is supplied for Windows 2000 and XP. Operates as a total loss system on all Superstock and GP engines. The unit fits perfectly in the OEM Kawasaki sealed ignition box protecting the unit from possible water damage!

Description	Part No.
Igni-Pro Programmable Ignition 800 SX-R	IGNI800SXR



RIVA PRO-SERIES E.F.I. CONTROL UNIT

If you plan to modify your Yamaha GP1300R our Pro-Series EFI Control Unit is a must. This easy-to-use control unit plugs directly into the OEM wiring harness between the ignition and fuel injection system providing control of the engines fuel management system. Key benefits include:

- Allows addition of fuel required with engine modifications without upsetting stock fuel map.
- Integrated dials provide easy adjustment and fine-tuning of fuel delivery curve without external programming devices.
- LED lights indicate fuel delivery settings while tuning.
- Won't interfere with craft's stock sensors and inputs.

Yamaha	Part No.
Control Unit, EFI GP1300R (60T), Plug-in	RY11913



MICRO TOUCH MICROPROCESSOR BASED IGNITION CONTROLLERS FOR SEA DOO

Features Include:

- 25% More Spark Energy
- 4 Rev Limits from 7500 to 8250 RPM
- 4 Timing Curves
- Initial Timing Correction Adjustment
- 4 Timing Retard Rates
- On-board Output Water Injection Controller
- Compatible with OEM Throttle Position sensor

Description	Part No.
785-951 RAVE w/Single Coil 96-98	MT-IGN-REV96-98

MICRO TOUCH REV-LIMITER FOR SEA DOO

Description	Part No.
785 RAVE 96 2Rev (7500&7900rpm)	MT-REV-SDRAVE96

FOUR STROKE

INTAKE SYSTEMS

ENGINE/GASKETS

EXHAUST

DRIVE LINE HANDLING

ELECTRICAL

WATERLINE /BILGE

STEERING & CONTROLS

BODY

ACCESSORIES

SERVICE TOOLS /HARDWARE

CHEMICAL

FOUR STROKE
INTAKE SYSTEMS
ENGINE/GASKETS
EXHAUST
DRIVE LINE HANDLING
ELECTRICAL
WATERLINE /BILGE
STEERING & CONTROLS
BODY
ACCESSORIES
SERVICE TOOLS /HARDWARE
CHEMICAL

Grey Deutsch



Weathertight



MSD GREY DEUTSCH CONNECTORS

Description	Part No.
6 Pin Connectors	8170
4 Pin Connectors	8171
3 Pin Connectors	8172
2 Pin Connectors	8173

Description	Part No.
8 Pin Connectors	8185
6 Pin Connectors	8180
4 Pin Connectors	8181
2 Pin Connectors	8183



WATERPROOF TERMINAL KIT

Japanese OEM type connector Kit.

Description	Part No.
2-Pin Terminal Kit	55-2050
3-Pin Terminal Kit	55-2051
4-Pin Terminal Kit	55-2052

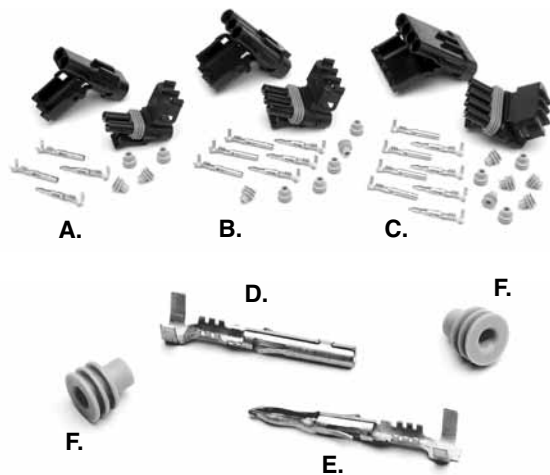

HOT PRODUCTS WEATHER PACK CONNECTORS

Ideal for use in harsh environments. Positive snap-action locking. Secondary locking helps terminal retention and provides access to the terminals for service.

Description	Part No.
A. 2 Way Housing Kit	55-2060
B. 3 Way Housing Kit	55-2061
C. 4 Way Housing Kit	55-2062
D. Female Terminal Only 100 pcs/pk	55-2070
E. Male Terminal Only 100 pcs/pk	55-2071
F. Cavity Seals Only 100 pcs.	55-2072



PERMA-SEAL CONNECTION KIT

Maximum ignition reliability can only be obtained by using high quality connectors and the Perma-Seal Connector Kit fits the bill! The tin coated copper terminals prevent corrosion and increase the connector's strength. To seal the connection, each connector has a special heat shrinkable outer sleeve that bonds and seals to the wire when heat is applied to it.

Description	Part No.
MSD Perma-Seal Connector Kit	4377



ADHESIVE LINED HEAT SHRINK BUTT CONNECTORS

Best used where moisture and corrosion is a problem. After crimping these terminals to wire, heat is applied enabling the adhesive within each shrunk tube terminal to melt and flow evenly to seal the connection against the harshest environment.

Description	Wire Range	Part No.
10pcs/pk Pink	22-18 (0.3-0.8mm)	55-2040
100pcs/pk Pink	22-18 (0.3-0.8mm)	55-2041
10pcs/pk Blue	16-14 (1-2mm)	55-2042
100pcs/pk Blue	16-14 (1-2mm)	55-2043



59-0254

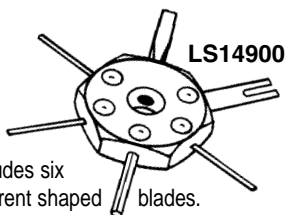

LS14900

Includes six different shaped blades.

TERMINAL DETENT TOOL

The hollow barrel allows you to depress the tab on the terminal end and to remove the wire from the connector without damaging its ends.

Description	Part No.
Terminal Detent Tool	59-0254
Terminal Removal Tool	LS14900



JAPANESE OEM STYLE CONNECTOR

Description	Part No.
OEM Style Electric Connector Kit 5pcs/pk	55-2035
Dealer Kit 20pcs/pk	55-2037

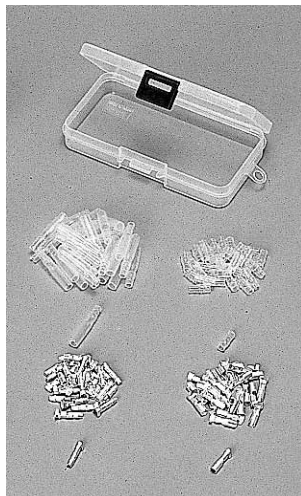

MALE/FEMALE TERMINAL KIT

This kit includes 30 of both the male and female terminals and plastic sleeves/covers. The terminals are tin plated to prevent corrosion. The terminal kit is provided in a handy plastic case.

Description	Part No.
Male/Female Terminal Kit	16-601



IGNITION SYSTEM SPARK TESTER

This ignition system tester checks the integrity and strength of your system by gauging your systems spark.

Description	Part No.
Ignition System Spark Tester	59-0253

HOUR/TACH METER

Has same features as hour meter plus tachometer feature. Works on any gas engine up to 2 cylinders and 9000 RPM.

- Firing pattern 1 spark = 1 RPM
- Resolution 10 RPMs
- Maximum RPMs 9000
- Suitable for all single and twin, two or four cycle gasoline engines operating within specified tachometer firing pattern.



Description	Part No.
Hour/Tach Meter	HR-8061



WATERPROOF DELUXE TACHOMETER

Features include: Tachometer with RPM memory, Hour meter, Stopwatch with 10-data memory, clock, Power save off switch, and over-run (red line) alarm, *For 2 stroke engines 1 to 6 cylinder applications.* *For 4 stroke engines 1 to 12 cylinder applications.* Made in Japan.

Description	Part No.
PET-2500 Deluxe Tachometer	PET-2500



OPPAMA



PET-2100DX TACHOMETERS

This measures engine rpm, maximum rpm, total cumulative operating time, resettable cumulative operating time. This has a dual display system for either current rpm alone or current & maximum rpm, and also has two maximum rpm memories for comparison.

- For 2 stroke engines 1 to 4 cylinder applications.*
- For 4 stroke engines 1 to 6 and 8 cylinder applications.*

*This unit is not compatible with diesel engine and direct ignition applications. Made in Japan.

Description	Part No.
PET-2100DX Tachometer	PET-2100DX



TINY DIGITAL TACH & HOURMETER

Tachometer and resettable Hourmeter powered by internal battery. Sealed for moisture resistance. *For 2 stroke engines 2 or 3 cylinder applications.*

Description	Part No.
Digital Tiny Tach (2 & 3-Cylinder)*	59-0552

*Resettable hourmeter

FOUR STROKE
INTAKE SYSTEMS
ENGINE/GASKETS
EXHAUST
DRIVE LINE HANDLING
ELECTRICAL
WATERLINE /BILGE
STEERING & CONTROLS
BODY
ACCESSORIES
SERVICE TOOLS /HARDWARE
CHEMICAL

JETINETICS

The Science of Racing

FOUR STROKE
INTAKE SYSTEMS
ENGINE/GASKETS
EXHAUST
DRIVE LINE HANDLING
ELECTRICAL
WATERLINE /BILGE
STEERING & CONTROLS
BODY
SERVICE TOOLS ACCESSORIES
SERVICE TOOLS /HARDWARE
CHEMICAL



J305



J315 - Outside of Flywheel



J315 - Inside of Flywheel

JETINETICS CHARGING FLYWHEEL

Jetinetics is the originator of the charging aluminum flywheel, and proudly retains the manufacturing right to its patented design. The patented Jetinetics Charging Flywheel is significantly lighter, 50% in some cases, which greatly reduces the energy used to overcome flywheel mass and allow the engine to increase rpms rapidly. A significant benefit is the fact that the engine will produce horsepower only after it has reached its powerband, which usually begins about 3800 rpm. By using a Jetinetics Charging Flywheel, the engine is able to reach its powerband much more quickly and create usable power much sooner. Further, during rapid cornering such as course racing or slalom runs, this becomes a significant factor for acceleration.

- CAD/CAM Designed and Dyno Tested • All Billet Aluminum Construction • 40% to 60% Lighter than Stock
- Manufactured by Jetinetics on our Own CNC Machinery • Deep Purple Anodized Finish All Over
- Precision Dynamically Balanced • Sealed/Invisible Embedded Magnets (Can Never Come Loose or Rust)
- Tuff Heat Treated Alloy Ring Gear, Heat Treated to 65 Rockwell C • Accepts Factory Puller for Removal
- Ring Gear Teeth Chamfered for Better Starter Bendix Engagement • Each Flywheel is Coded and Serialized
- 400 Times More Corrosion Resistant than Double Hard Chrome • Most Models Can be Repaired or Rebuilt if Necessary
- Some Models Utilize Steel Center Hubs to Prevent Bore Failures/Extend Flywheel and Crankshaft Life
- No Modifications Needed to Install (Just Standard Tools Needed)

Description	Part No.
Kawasaki 750/800	J305

Description	Part No.
Yamaha 701 (62T/64X)	J315



MACC RACING KAWASAKI ULTRA 250X TIMING ADVANCE COVER

Macc Racing and Speed Magic have developed this billet timing advance cover to allow the timing to be advanced up to 6 degrees on the Ultra 250X.

Description	Part No.
Macc Racing Ultra 250X Timing Advance Cover	MR-0085



FLYWHEEL PULLER

Sea Doo	Part No.
800/951 38mm x 1.5	MP#42
Kawasaki	Part No.
900/1100 35mm x 1.5	DS#29



MAGNETO FLYWHEEL PULLER

Sea Doo	Part No.
580/650/720	DS#37
12 Hole Disc 8mm Bolts	

Polaris	Part No.
Polaris All & Universal	DS#37
Universal 12 Hole Disc 8mm Bolts	

Yamaha	Part No.
580/650/Pre 94 701	DS#37
12 Hole Disc 8mm Bolts	
701/760/800/1100/1200	DS#37
12 Hole Disc 8mm Bolts	

Kawasaki	Part No.
300/440/550/650	DS#37
12 Hole Disc 8mm Bolts	
750/800	MP#18
Special 18mm x 1.5 Right Hand Bolt	

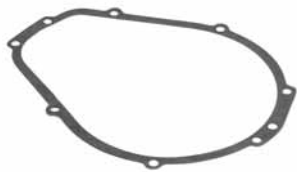

FLYWHEEL COVER & HOUSING GASKETS, O-RINGS & OIL SEALS

	Sea Doo OEM#	Part No.
Flywheel Cover O-Rings		
580 (88-91)	290-950-130	6280
580/650/720 (92-98)	290-831-555	6278
800 (95-99)	420-950-360	6632
950 (98-99)	290-931-690	6795
Flywheel Housing Gaskets		
580/650/720	290-850-605	6130
800	290-931-470	6045
Yamaha		
	OEM#	
650/701/760	6M6-81365	2360
1100/1200	63M-81365	4505
1200XLL/GP1200R/1300R (Oil Seal)	93102-35M57	3710
Kawasaki		
	OEM#	
440/550 (O-Ring)	92055-521	008-417
650/750 (O-Ring)	92055-3712	008-418
Ultra 150	11060-3803	7790



010-480



010-481

SEA DOO FLYWHEEL NUT & WOODRUFF KEY

Sea Doo	OEM#	Part No.
Flywheel Nut Sea Doo All	420-842-230	010-480
Woodruff Key Sea Doo All	420-246-055	010-481

FLYWHEEL BOLTS & KEY

Kawasaki	OEM Number	Part No.
Flywheel Bolts All Models	92150-381	010-491
Flywheel Key All Models	92038-001	010-481-01
Yamaha	OEM Number	Part No.
Flywheel Key All Models	90280-16053-00	010-481-02



2011 JET SKI WORLD CUP GRAND PRIX • KING'S CUP THAILAND



R&D KAWASAKI 750 & 800 SX-R TIMING ADVANCE KIT

The R&D SX-R 800 Timing kit produces a substantial performance gain with the OEM ignition system. By relocating the pickup trigger on the ignition cover a full six degrees of ignition timing is available. Initial ignition timing from 0-2000 rpm boosted from 14 to 20 degrees, mid 3000-5000 rpm from 20 to 26 degrees and overall 6500 rpm + from 12 to 18 degrees.

Description	Part No.
R&D 750/800 Timing Advance Kit	441-75001
Replacement Timing Cover Gasket Only	8050



ADA RACING TIMING ADVANCE PLATE KAWASAKI 12F AND 15F

This is a stock timing trigger plate that is machined with additional locations for timing advance. Has the stock position, +3, +4, and +5 degrees. This fits the Kawasaki STX-15F and STX-12F four stroke watercraft.

Description	Part No.
ADA Racing Timing Advance Plate	31-250100

FOUR STROKE	INTAKE SYSTEMS	ENGINE/GASKETS	EXHAUST	DRIVE LINE HANDLING	ELECTRICAL	WATERLINE /BILGE	STEERING & CONTROLS	BODY	ACCESSORIES	SERVICE TOOLS /HARDWARE	CHEMICAL
-------------	----------------	----------------	---------	---------------------	------------	------------------	---------------------	------	-------------	-------------------------	----------



NEW MES AQUA TORQUE STARTERS AND STARTER DRIVES



MES "High Torque" models and OEM equivalent models.
All starters meet or exceed OEM specification.



S1090MHT
S1090M



S1091MHT • S1091M
*Complete as shown with mounting bracket



S1096MHT-9
S1096M-9
*9 Tooth Bendix



S1098MHT
S1098M



S1102M

Sea Doo Model	OEM#	High Torque Starter	OEM Replacement Starter	Drive Gear Idle Gear
GT, SP, XP580 89-91	278-000-316	S1090MHT	S1090M	3275M/3276M
SP, SPL, SPX580 91-94	278-000-316	S1090MHT	S1090M	3275M/3276M
XP650 91-94(all)	278-000-316	S1090MHT	S1090M	3275M/3276M
580/650/720 94-00(all)	278-000-485	S1091MHT	S1091M	3275M/3276M
XP800 95, XP/GSX/GTX96	278-000-577	S1096MHT-9	S1096M-9	3275M/3276M
951(all)	278-000-98Z	S1098MHT	S1098M	3270M
4 Tec (4Stroke)	290-888-999		S1102M	Not Required
97-2003 GSX, SPX, GTX RFI, GSX RFI & 2003 GTI RFI	278-001-497/278-001-038 278-001-301	S1096MHT-8	S1096M-8	Not Required



S1095MHT
S1095M



S1099MHT
S1099M



S1103M



S1101M



S1097MHT

Yamaha				
500 88-89				3274M
650/701 (all)	6M6-81800-10-00	S1095MHT	S1095M	3270M
760	64X-81800-00-00	S1105MHT	S1105M	3270M
800/1100/1200 (all)	63M-81800-00-00	S1099MHT	S1099M	3270M
FX140 (4Stroke)	60E-81800-00-00	S1103MHT	S1103M	Not Required
VX1100	6D3-81800-00	S1107MHT	S1107	

Honda				
F12/F12X 1200cc Aqua Trax	31200-HW1-671		S1101M	Not Required

Tigershark				
640/650/770/900/1000 (92-99)	3008/093/327/536	S1097MHT		3270M



S1094MHT
S1094M



S1092MHT
S1092M



S1100M



S1093MHT
S1093M

Kawasaki				
440/550/550SX (all)	21163-3710	S1094MHT	S1094M	3273M
650/750/900/1100 (all)	21163-3712	S1092MHT	S1092M	3270M
ULTRA150, STX-R	21163-3715		S1100M	Not Required

Polaris				
650/750/785/900/1050 (all)	324-01100	S1093MHT	S1093M	3270M



3270M
(19 tooth)



3273M
(9 tooth)



3274M
(11 tooth)



3275M
9 Tooth
(OEM 9 Tooth)



3276M
8 Tooth
(High Torque Unit)

Manufacturer's Warranty Policy: All MES products (excluding MES Economy Starters), when properly installed, are warranted by MES against defects in materials and workmanship for a period of one year from the date of sale to the original purchaser. For MES to accurately inspect defective items for warranty consideration, we ask that all returns reach our facility within the warranty period with an RA#, along with a copy of the original invoice and a brief explanation of the product's alleged malfunction.

Non-Covered Warranty Issues: Our warranty is limited to the replacement of defective units only and does not cover labor or any other expenses. This warranty extends to the application under normal use, and does not apply to any of the following: submersion, deliberate abuse, broken drive-gears, that are broken or tampered with during installation, or involved in attempted improper installations. Any tampering or dismantling, grinding, drilling, removing or addition of parts, or any action that alters the original design of the unit, will immediately render this warranty null and void.

MES ECONOMY STARTERS



Sea Doo Model	OEM#	Economy Starter	Drive Gear/Idle Gear
GT, SP, XP580 89-91	278-000-316	C1090-NA	3275M/3276M
SP, SPL, SPX580 91-94	278-000-316	C1090-NA	3275M/3276M
XP650 91-94(all)	278-000-316	C1090-NA	3275M/3276M
580/650/720 94-00(all)	278-000-485	C1091-NA	3275M/3276M
XP800 95, XP/GSX/GTX96	278-000-577	C1096-9-NA	3275M/3276M
951(all)	278-000-98Z	C1098-NA	3270M
4 Tec (4Stroke)	290-888-999	C1102-NA	Not Required
97-2003 GSX, SPX, GTX RFI, GSX RFI & 2003 GTI RFI	278-001-497/278-001-038 278-001-301	C1096-8-NA	Not Required



Yamaha Model	OEM#	Economy Starter	Drive Gear/Idle Gear
650/701 (all)	6M6-81800-10-00	C1095-NA	3270M
800/1100/1200 (all)	63M-81800-00-00	C1099-NA	3270M

Tigershark Model	OEM#	Economy Starter	Drive Gear/Idle Gear
640/650/770/900/1000 (92-99)	3008/093/327/536	C1097-NA	3270M



Kawasaki Model	OEM#	Economy Starter	Drive Gear/Idle Gear
650/750/900/1100 (all)	21163-3712	C1092-NA	3270M
ULTRA150, STX-R	21163-3715	C1100-NA	Not Required

Manufacturer's Warranty Policy: All MES Economy Starters, when properly installed, are warranted by MES against defects in materials and workmanship for a period of 90 days from the date of sale to the original purchaser. For MES to accurately inspect defective items for warranty consideration, we ask that all returns reach our facility within the warranty period with an RA#, along with a copy of the original invoice and a brief explanation of the product's alleged malfunction.

Non-Covered Warranty Issues: Our warranty is limited to the replacement of defective units only and does not cover labor or any other expenses. This warranty extends to the application under normal use, and does not apply to any of the following: submersion, deliberate abuse, broken drive-gears, that are broken or tampered with during installation, or involved in attempted improper installations. Any tampering or dismantling, grinding, drilling, removing or addition of parts, or any action that alters the original design of the unit, will immediately render this warranty null and void.

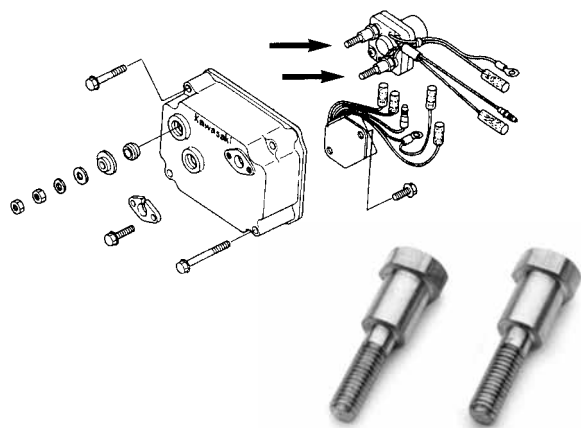

KAWASAKI BATTERY SOLENOID POST

Our solenoid post allows placement of corroded post without replacing the expensive solenoid on all Kawasaki Jet Ski with small electrical box.

Description	Part No.
Solenoid Post 2 per set	55-3350



MSD EXTERNAL STARTER RELAY

This 12 volt relay is a heavy duty unit designed to mount outside the electrical box. Moisture and chemicals resistant. The large copper terminals assure good solid contacts. The stainless steel base plate allows the relay to be mounted in any position. Rated at 65 amps.

Description	Part No.
MSD External Starter Relay	M4390

FOUR STROKE
INTAKE SYSTEMS
ENGINE/GASKETS
EXHAUST
DRIVE LINE HANDLING
ELECTRICAL
WATERLINE /BLIGE
STEERING & CONTROLS
BODY
ACCESSORIES
SERVICE TOOLS /HARDWARE
CHEMICAL

FOUR STROKE
INTAKE SYSTEMS
ENGINE/GASKETS
EXHAUST
DRIVE LINE HANDLING
ELECTRICAL
WATERLINE /BILGE
STEERING & CONTROLS
BODY
ACCESSORIES
SERVICE TOOLS /HARDWARE
CHEMICAL



STATOR COILS / PULSING COILS

Yamaha	OEM No.	Part No.
Wave Jammer 500 1987-88	6GO-85580-70	004-154
Wave Runner 500 1987-89	6GO-85580-70	004-154
SJ/WR/WRA 650 1990-93	6M6-85580-00	004-153
WRB 650VXR 1991-95	6M6-85580-00	004-153
WB701 1993	6M6-85580-00	004-153
WRB Pro VXR 701 1993	6M6-85580-00	004-153
Kawasaki		
440 1984-92	59026-3008	004-163
550 1982-95	59026-3008	004-163



SEA DOO COMPLETE STATOR ASSEMBLY

Description	OEM No.	Part No.
580/650/720 95-UP	420-866-725	004-202



STATOR COILS / EXCITER COILS

Kawasaki	OEM No.	Part No.
440 1984-92	21049-3007	004-162
550 1982-95	21049-3007	004-162
All 650 1986-95	21003-3719	004-166



STATOR COILS / LIGHTING COILS

Yamaha	OEM No.	Part No.
Wave Jammer 500 1987-90	6K8-0103-40	004-152
Wave Runner 500 1987-93	6K8-0103-40	004-152
All 650 1990-96	6M6-85533-00	004-156
All 701 1993-95 except Raider	6K8-8103-40	004-156
Wave Raider	62T-85533-00	004-147



OEM REPLACEMENT COILS



STATOR COILS / CHARGE COILS

Sea Doo (Generating Coil)	OEM No.	Part No.
580 1988-90	290-866-635	004-170
580 GT 1990-91, XP/SP 1991	299-866-635	004-170
650 XP 1993-95	410-912-000	004-170
580/650/720/ 1995-up	420-866-725	004-202

Yamaha		
All 650 1990-95	6M6-85520-00	004-155
All 701 1993-95	6M6-05S20-00	004-155
Wave Raider	62T-85520-00	004-148

Kawasaki (Individual Coil For Stator Assy)		
440 1984-92	59031-3002	004-161
550 1982-95	59031-3002	004-161
All 650 1986-95	21003-3707/12/16	004-165



**IGNITION COILS
OEM Replacement**

Sea Doo	OEM No.	Part No.
580GT 1988-91	290-866-607	004-175

Yamaha		
Wave Jammer 500 1987-90	6K8-85570-010	004-150
Wave Runner 500 1987-93	6K8-85570-010	004-150
SJ650 1990-93	6R8-85570-00	004-157
WR650/III/LXR 1990-95	6R8-85570-00	004-157
FX/SJ/WB/WR/WV701 1994-95	6R8-85570-00	004-157
1100 All	63M-85570-00	004-193

Kawasaki		
750SX 92-94, SXI 95	21121-3705	004-157
900/1100 All	21121-3708/9/10	004-192

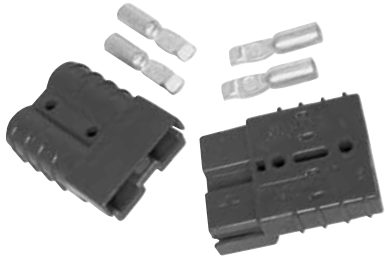

BATTERY QUICK DISCONNECT

Racers will appreciate this Quick Disconnect Battery Connector because it allows for easy removal of the battery. The connectors grip together

to form a vibration proof connection but can easily be disconnected for quick removal for charging of the battery.

Description	Part No.
Battery Quick Disconnect	4376



JUMPER CABLES

8 feet long heavy duty 8 gauge copper jumper cables are big on charging power, yet stow conveniently in the 9 x 9 inch nylon bag.

Description	Part No.
Jumper Cables	59-0530

EPOXY LINED ON THE INSIDE OF THE TUBING



EPOXY LINED HEAT SHRINK TUBING

High performance epoxy lined 1/2" id heat shrink. Just splice your wires, heat until the epoxy liquifies and your worries of possible water damage/corrosion are over! Heat shrink tubing color is Black.

Description	Part No.
Epoxy Lined Heat Shrink Tubing (4' length, 1/2" ID)	55-2032

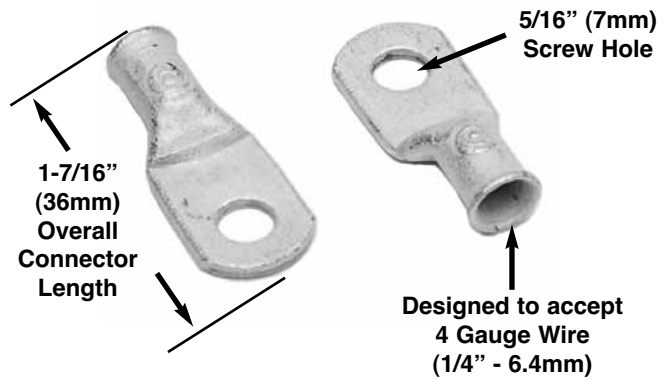

QUALITY BATTERY (LUGS) CONNECTION

Marine Grade™ lugs are manufactured from heavy duty annealed tinned copper, providing for maximum current flow. 100% tin plated copper resists corrosion from salt and moisture. Seamless barrel design allows for maximum strength when crimped. Closed end design seals out moisture so cables stay dry and corrosion free.

Descriptions	Part No.
Battery Cable Ends (2pcs/set)	55-2031



CORROSION BLOCK MULTI-PURPOSE GREASE

Liquid grease is ideal for use in electrical applications requiring grease.

Description	Part No.
Corrosion Block Liquid 1oz. Bottle	CB-20001



MAINTAINER
MODEL #CU2602
Total Amps: 0.5
Battery System: 12Volt



CHARGER
MODEL #CU2606A
Total Amps: 6
Battery System: 12Volt



CHARGER
MODEL #CU2612A
Total Amps: 10
Battery System: 12Volt

GUEST 12 VOLT MAINTAINERS AND PORTABLE BATTERY CHARGERS

AMPS	TYPE	PART/MODEL #
.5	Maintainer	CU2602
6	Portable	CU2606A
10	Portable	CU2612A

FOUR STROKE	INTAKE SYSTEMS	ENGINE/GASKETS	EXHAUST	DRIVE LINE HANDLING	ELECTRICAL	WATERLINE /BILGE	STEERING & CONTROLS	BODY	ACCESSORIES	SERVICE TOOLS /HARDWARE	CHEMICAL
-------------	----------------	----------------	---------	---------------------	------------	------------------	---------------------	------	-------------	-------------------------	----------

NO MORE SEARCHING REQUIRED! HOT PRODUCTS HAS THE SWITCH FOR YOUR APPLICATION

Hot Products PWC Waterproof Switches Imported Exclusively from



**HOT PRODUCTS
EXCLUSIVE**

3-WAY PANEL MOUNT ROTARY SWITCHES

Connects to two electronic accessories for power control. Allows the operation of one or both accessories to run at the same time. Suggested uses: Second Bilge, Ignition, etc. 12Volt/5Amp.



**Left Hand
On Position**
Use: Blue &
Red Wires

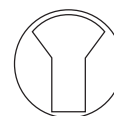

**Center Off
Position**

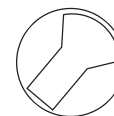

**Right Hand
On Position**
Use: White &
Red Wires



JP7043



JP7044

UNIVERSAL HANDLEBAR MOUNT SWITCHES

Mounts to handlebar or mounts to underside of most aftermarket throttle levers. Complete with 9" wire lead.

Description	Part No.	Description	Part No.
Handlebar Mount Switch	JP7043	Handlebar Mount Switch	JP7044
12Volt/6Amp push on/off switch		12Volt/5Amp 3 way rotary switch	

Description	Part No.
Panel Mount Switch	57-3020

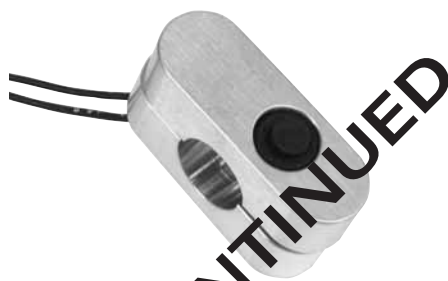

MSD HOLESHOT CONTROL SWITCH

This is a momentary push-button switch encased in a CNC machined aluminum housing that clamps around the handle bar. It comes with a 6-foot wire harness that should reach almost anywhere on your watercraft. Use this switch to activate any MSD feature.

Description	Part No.
Holeshot Control Switch	4372



CPI WATERPROOF SWITCH ONLY

This replacement safety switch fits Sea Doo's and other manufacturers.

Description	Part No.
Replacement Safety Switch (Sea Doo & other manufacturers)	57-3011



ROTARY SWITCH COVER

Protect your ultra sano BULLETPROOF Blowsion rotary bilge switch with this sanitary powder coated black aluminum switch shield. No more broken off knobs between your toes during aerials. All mounting hardware included. (Rotary Switch is sold separately)

Description	Part No.
Rotary Switch Cover	06-01-310

WATERPROOF SWITCHES AND BRACKETS

- Features waterproof on/off switch that is available with machined aluminum clamp-on or switch mounted bracket. Allows totally reliable and easy control of bilge pump operation.
- Mounting bracket is machined from billet alloy and is anodized black to prevent corrosion. Available for clamp-on bar mounting or bolts to the bottom of the OEM on/off switch assembly.
- All of the switches have a 9 ft. high grade wire lead.



Yamaha Part No. 57-3017
All

UNIVERSAL



Description Part No. 57-3006
Universal Handle Bar Mount



Kawasaki Part No. 57-3015
All 650's / 750SS-95 / XI-93



Kawasaki Part No. 57-3003
440 / 550 / 750SX / 750SXI / 800SX-R

Description Part No. 57-3009
Standard Switch with 9 feet of wire (No bracket included)



BILLET 3 SWITCH HOLDER For Aftermarket Handlebar

Description	Color	Part No.
SeaDoo	Polished	58-2004



BILLET STOP SWITCH HOLDER For Aftermarket Handlebar

Description	Color	Part No.
SeaDoo	Polished	58-2003

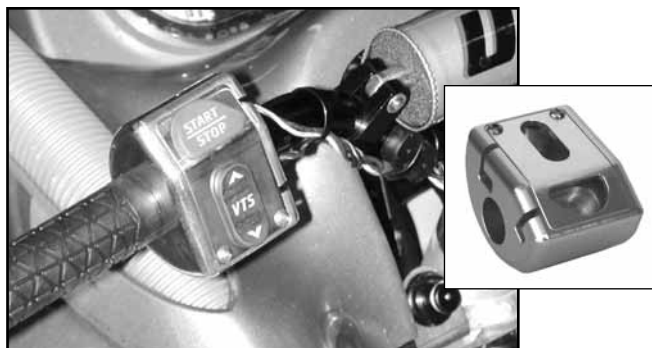

UMI RXP TRIM/SWITCH HOUSING

U.M.I.'s trim/switch housing is machined from 6061-T6 billet aluminum, replacing the stock plastic housing. Trim/switch housing uses the factory variable trim switch and start/stop switch. This housing must be used with the U.M.I. GSX/RXP (P/#58-6321) steering system, aftermarket bars and finger throttle.

Sea Doo	Part No.
RXP Silver	SD-01600-CLR



2011 JET SKI WORLD
CUP GRAND PRIX
KING'S CUP
THAILAND



FOUR STROKE	INTAKE SYSTEMS	ENGINE/ GASKETS	EXHAUST	DRIVE LINE HANDLING	ELECTRICAL	WATERLINE /BILGE	STEERING & CONTROLS	BODY	ACCESSORIES	SERVICE TOOLS /HARDWARE	CHEMICAL
----------------	-------------------	--------------------	---------	------------------------	------------	---------------------	------------------------	------	-------------	----------------------------	----------

NGK SPARK PLUGS



STANDARD PLUGS

B7ES
B7HS
B8ES
B8HS
B9ES

Sold Pk/10



(Ceramic can be removed)

RESISTOR PLUGS

BPR7ES
BR7ES
BR7HS
BPR8ES
BPR9ES
BR8ES
BR8HS
BR9ES
BR9HS

Sold Pk/10



SOLID RESISTOR PLUGS

BR8ES-SOLID
BR8HS-SOLID
BR9ES-SOLID
BR8ES-11
(For Yam GPR)
CR9EB

Sold Pk/10



Solid Terminal
(Non separable)

*Solid Terminal Nut

YAMAHA

YEAR	REG PLUG	IRIDIUM PLUG
1300	WaveRunner GP GP1300	2004-2003 BR8ES-11* -----
1200	WaveRunner III GP GP1200	1999-1997 BR8HS BR8HIX
	WaveRunnerIII GP GP1200R	2002-2000 BR8ES-11* -----
	WaveRunner SUV1200	2004-1999 BR8HS BR8HIX
	WaveRunner XA1200	1998 BR8ES BR8EIX
	WaveRunner XL1200	1998 BR8HS BR8HIX
	WaveRunner XL1200	2000-1999 BR8ES-11* -----
	WaveRunner XL1200	2004-2001 BR8ES-11* -----
1100	FX160 FX160	2004 CR9EB* -----
	WaveRaider II RA1100	1996-1995 BR8HS BR8HIX
	WaveVenture WVT1100	1997-1996 BR8HS BR8HIX
1000	WaveRunner FX140	2004-2002 CR9EB* -----
800	WaveRunner GP800	2004-1998 BR8ES* BR8EIX
	WaveRunner XL800	2001-2000 BR8ES* BR8EIX
	WaveRunner XLT800	2004-2002 BR8ES* BR8EIX
760	WaveRunner III GP GP760	2000-1997 BR8HS BR8HIX
	WaveRaider RA760	1996 BR8HS BR8HIX
	WaveBlaster II WB760	1997-1996 BR8HS BR8HIX
	WaveVenture WVT760	1997 BR8HS BR8HIX
	WaveRunner XL760	1999-1998 BR8HS BR8HIX
700	FX1 FX700	1996-1994 B8HS BR8HIX
	WaveRaider RA700	1996-1994 BR8HS BR8HIX
	WaveRaider RA700B	1997 B7HS BR7HIX
	Wave Raider Del RA700B	1996 B8HS BR8HIX
	SuperJet SJ700	1996-1994 B8HS BR8HIX
	SuperJet SJ700	2001-1997 BR7HS BR7HIX
	SuperJet SJ700	2004-2002 BR8HS BR8HIX
	WaveBlaster WB700	1996-1993 BR8HS BR8HIX
	WaveRunner III WRA700	1997-1995 BR8HS BR8HIX
	WaveRunnr Pro VXR WRB700	1994-1993 BR8HS BR8HIX
	WaveVenture WVT700	1998-1995 BR8HS BR8HIX
	Wave Runner XL700	2004-1990 BR8HS BR8HIX
650	SuperJet SJ650	1992-1990 B8HS BR8HIX
	WaveRunner WR650	1992-1990 B8HS BR8HIX
	WaveRunner III WRA650	1995-1991 BR8HS BR8HIX
	WaveRunner VXR WRB6	1995-1991 B8HS BR8HIX
500	WaveJammer WJ500	1990-1978 B7HS BR7HIX
	WaveRunner WR500	1993-1987 B7HS BR7HIX

POLARIS

YEAR	REG PLUG	IRIDIUM PLUG
	MX140	2004 PZFR6H -----
1200	Genesis	2001-1999 BR9ES* -----
	Genesis I	2002-1999 PZFR6H -----
	Pro 1200	2002-2000 BPR8ES -----
	SLX	2001-2000 BPR8ES -----
	Virage TX	2001-2000 BR9ES* BR9EIX
	Virage TXI	2002-2001 -----
1050	SLX	1999 BPR8ES -----
	SLTX	1999-1996 BPR8ES -----
	SL 1050	1998-1997 BPR8ES -----
900	SL 900	1997-1996 BPR8ES -----
780	SL 780	1997-1996 BPR8ES -----
	SLT 780	1997-1996 BPR8ES -----
	SLX 780	1997-1996 BPR8ES -----
785	SLX Pro 785	2000-1998 BR9ES* BR9EIX
777	Virage I	2002 -----
	Octane	2002 -----
	Octane	2002 BR9ES* BR9EIX
750	SL 750	1995-1994 BPR7ES -----
	SLT 750	1995 BPR7ES -----
700	Virage	2002-2000 BPR8ES -----
	SLTH	1999 BPR8ES -----
	SLH	2001-1999 BPR8ES -----
	Freedom	2002 BPR8ES -----
	SL 700	1998-1997 BPR8ES -----
	SL 700 Deluxe	1998-1996 BPR7ES -----
	Hurricane	1997-1996 BPR8ES -----
650	SL 650	1995-1994 BPR7ES -----

HONDA

YEAR	IRIDIUM PLUG
1235	Aqua Trax F-12X 2002-2004 IMR9D-9H
	Aqua Trax F-12 2002-2004 IMR9D-9H
1200	Aqua Trax R-12 2002-2004 IMR9D-9H
	Aqua Trax R-12X 2002-2004 IMR9D-9H

KAWASAKI (Jet-Ski)

YEAR	REG PLUG	IRIDIUM PLUG
1500	STX-15F JT1500-C	2004 CR9EK CR9EIX
1200	Ultra 150 (A2) JH1200-A	2002-2000 BR9ES* BR9EIX
	Ultra 150 (A1) JH1200-A	1999 R6918C-9* -----
	STX-R JT1200-A	2003-2002 BR9ES* BR9EIX
	STX-12F JT1200-B	2004-2003 CR9EK CR9EIX
	Ultra 150 JH1200-B	2004-2003 BR9ES* BR9EIX
	STX-R JT1200-C	2004 BR9ES* BR9EIX
1100	ZXI JH1100-A	2003-1996 BR9ES* BR9EIX
	Ultra 130 DI JH1100-B	2004-2001 PZFR7G-G -----
	STX JT1100-A	1997 BR9ES* BR9EIX
	STX JT1100-B	1999-1998 BR9ES* BR9EIX
	STX JT1100-C	2000 PZFR7G-G -----
	STX D1 JT1100-F	2002-2001 PZFR7G-G -----
	STX D1 JT1100-G	2003 PZFR7G-G -----
900	ZXI JH900-A	1997-1995 BR9ES* BR9EIX
	STX JT900-A	1999-1997 BR9ES* BR9EIX
	STS JT900-B	2002-2001 BR9ES* BR9EIX
	STX JT900-B	2000-1999 BR9ES* BR9EIX
	STX JT900-C	2002-2001 BR9ES* BR9EIX
	STX JT900-D	2003 BR9ES* BR9EIX
	STX JT900-E	2004 BR9ES* BR9EIX
800	800SXR 800SX-R	2004-2003 BR8ES* BR9EIX
	800SXR JS800-A	2004-2003 BR8ES* BR9EIX
750	Super Sport JH750-A	1994-1992 BR8ES* BR9EIX
	Super Sport Xi JH750-B	1995-1993 BR8ES* BR9EIX
	ZXi JH750-C	1997-1995 BR8ES* BR9EIX
	XiR JH750-D	1994 BR8ES* BR9EIX
	Super Sport JH750-E	1997-1996 BR8ES* BR9EIX
	Super Sport Xi JH750-F	1997-1996 BR8ES* BR9EIX
	Super Sport Xi JH750-G	1999-1998 BR8ES* BR9EIX
	SX JS750-A	1994-1992 BR8ES* BR9EIX
	SX JS750-B	1997-1995 BR8ES* BR9EIX
	SXi Pro JS750-C	2002-1998 BR8ES* BR9EIX
	ST JT750-A	1994 BR8ES* BR9EIX
	STS JT750-B	1997-1995 BR8ES* BR9EIX
	STS JT750-C	1999-1998 BR8ES* BR9EIX
650	Jet Mate JB650	1992-1989 BR7ES* BR7EIX
	X2 JF650-A	1995-1986 BR7ES* BR7EIX
	TS JF650-B	1996-1989 BR7ES* BR7EIX
	SC JL650	1995-1991 BR7ES* BR7EIX
	650SX JS650	1995-1991 BR7ES* BR7EIX
	650SX JS650	1990-1987 BR7ES* -----
550	550SX (C2) JS550	1995-1982 BR8ES* BR8EIX
440	440SX JS440	1992-1976 BR7ES* BR7EIX
400	400SX JS400	1975-1974 B7ES -----

BOMBARDIER (Sea-Doo)

YEAR	REG PLUG	IRIDIUM PLUG
1500	GTX 4-TEC, 4-TEC S/C	2003-2002 DCPR8E -----
950	GSX Limited	1999-1997 BR8ES* BR8EIX
	GTX	2002-1999 BR8ES* BR8EIX
	GTX DI	2003-2000 ZFR4F-11 -----
	LRV DI	2003-2002 ZFR4F-11 -----
	RX	2002-2000 BR8ES* BR8EIX
	RX DI	2003-2000 ZFR4F-11 BR8EIX
	RXX	2002-2001 BR8ES* BR8EIX
	XP	2002-1999 BR8ES* BR8EIX
780	GSX	2000-1996 BR8ES* BR8EIX
	GTX	2000-1996 BR8ES* BR8EIX
	GTX RFI	2002-1999 BR8ES* BR8EIX
	SPX	1999-1997 BR8ES* BR8EIX
	XP	2000-1995 BR8ES* BR8EIX
720	GS	2001-1997 BR8ES* BR8EIX
	GSI	1998-1997 BR8ES* BR8EIX
	GTI	2003-1996 BR8ES* BR8EIX
	GTS	2001-1997 BR8ES* BR8EIX
	HX	1997-1995 BR8ES* BR8EIX
	SP	1998-1997 BR8ES* BR8EIX
	SPX	1997-1996 BR8ES* BR8EIX
650	GTX	1995-1994 BR8ES* BR8EIX
	SPX	1995-1994 BR8ES* BR8EIX
	XP	1994-1993 BR8ES* BR8EIX
580	SP	1990-1988 BR7ES BR7EIX
	GT	1991-1990 BR7ES BR7EIX
	GTS	1997-1992 BR7ES BR7EIX
	GTX	1993-1992 BR7ES BR7EIX
	SP	1996-1991 BR7ES BR7EIX
	SPI	1997-1993 BR7ES BR7EIX
	SPX	1993 BR7ES BR7EIX
	XP	1993-1991 BR7ES BR7EIX



NGK Iridium IX SPARK PLUGS

Iridium is significantly stronger than any metal used in spark plugs today. The ignitability and durability is better than platinum. Sold pk/4.

Part No.	
BR8EIX	BKR7EIX-11
BR9EIX	BPR8EIX
BR8HIX	BPR9EIX
CR9EIX	DCPR8EIX

**All Iridium plugs are 4 per package.
Iridium plugs are gapped at NGK, if you try to gap the plugs you will damage the center electrode.



NGK RACING CABLE

High performance red silicon outer shell for maximum heat resistance and durability. Ceramic resistor (50hm) enhances protection against RFI.

Description	Part No.
90° Resistor cover 100cm, solid	CR6

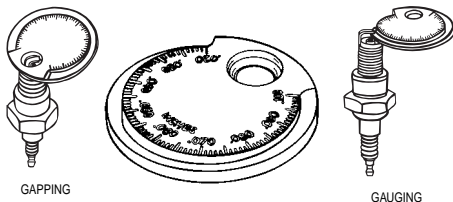

STANDARD/HIGH ENERGY SPARK PLUG GAUGE & GAPPER

Gauge and gap all types of spark plugs from .020" to .110 (.50mm to 2.53mm).

Description	Part No.
Spark Plug Gauge and Gapper	LS67870



NGK SPECIAL SPARK PLUGS FOR 4 STROKE ENGINES

Description	Part No.
K1100 STX-DI, Ultra 130 DI (PK/4)	*PZFR7G-G
Sea Doo GTX-4TEC	DCPR-8E
RXP/RXT/RXP-X/RXT-X (PK/10)	ZFR4F-11
Sea Doo GTX-DI, LRV-DI, RX-DI (PK/4)	
Yamaha FX 140/160, VX110 (PK/10)	CR9EB
Kawasaki STX 12F/15F (PK/10)	CR9EK
Kawasaki Ultra 250/260 (PK/4)	PMR9B
Polaris M140, Genesis (PK/4)	PZFR6H
Hydrospace S4 (PK/4)	BKR7EIX-11
Honda 4 Stroke (PK/4)p	IMR90-9H
FX SHO, FZR, FZS (PK/10)	LFR6A
Ultra 150 A-1	R6918C-9
Ultra 150 A-2-3	BR9ES

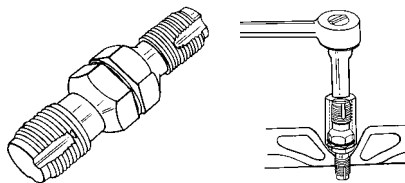

SPARK PLUG HOLE THREAD CHASER

Cleans threads in spark plug hole. Use with 13/16" spark plug socket. Double-ended for both 14mm and 18mm threads.

Description	Part No.
Spark Plug Hole Thread Chaser	LS20200

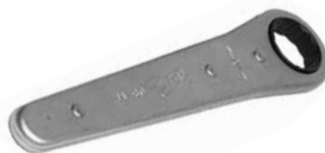

SPARK PLUG TOOLS

Description	Part No.
Ratchet Plug Wrench	59-0539



NGK RESISTOR COVER

Waterproof spark plug resistor covers for use with resistor spark plugs.

Description	Part No.
(5K OHM) 90 "T" 14mm plugs with terminal nut	TB05EM



MSD SPARK PLUG BOOT RETAINERS

There's no excuse for losing a race due to a plug wire popping off when you run MSD's Boot Retainers. These handy clamps are molded from heat resistant nylon material and will lock the boot to the spark plug.

Description	Part No.
A. Boot Retainer, 90° Spark Plug Boots & Terminal	3340
B. 90° Spark Plug Boots & Terminal Only (2 pcs.)	3311



8.5MM SUPER CONDUCTOR SPARK PLUG WIRE

See page 99 for details

Description	Part No.
Two Cylinder Wire Set	31009
One Cylinder Wire Set	31019
Three Cylinder Wire Set	31039
Bulk Wire 25 feet - Red	34019
Bulk Wire 25 feet - Black	34013

FOUR STROKE
INTAKE SYSTEMS
ENGINE/GASKETS
EXHAUST
DRIVE LINE HANDLING
ELECTRICAL
WATERLINE /BLIGE
& CONTROLS
BODY
ACCESSORIES
SERVICE TOOLS /HARDWARE
CHEMICAL